

SOT-1800

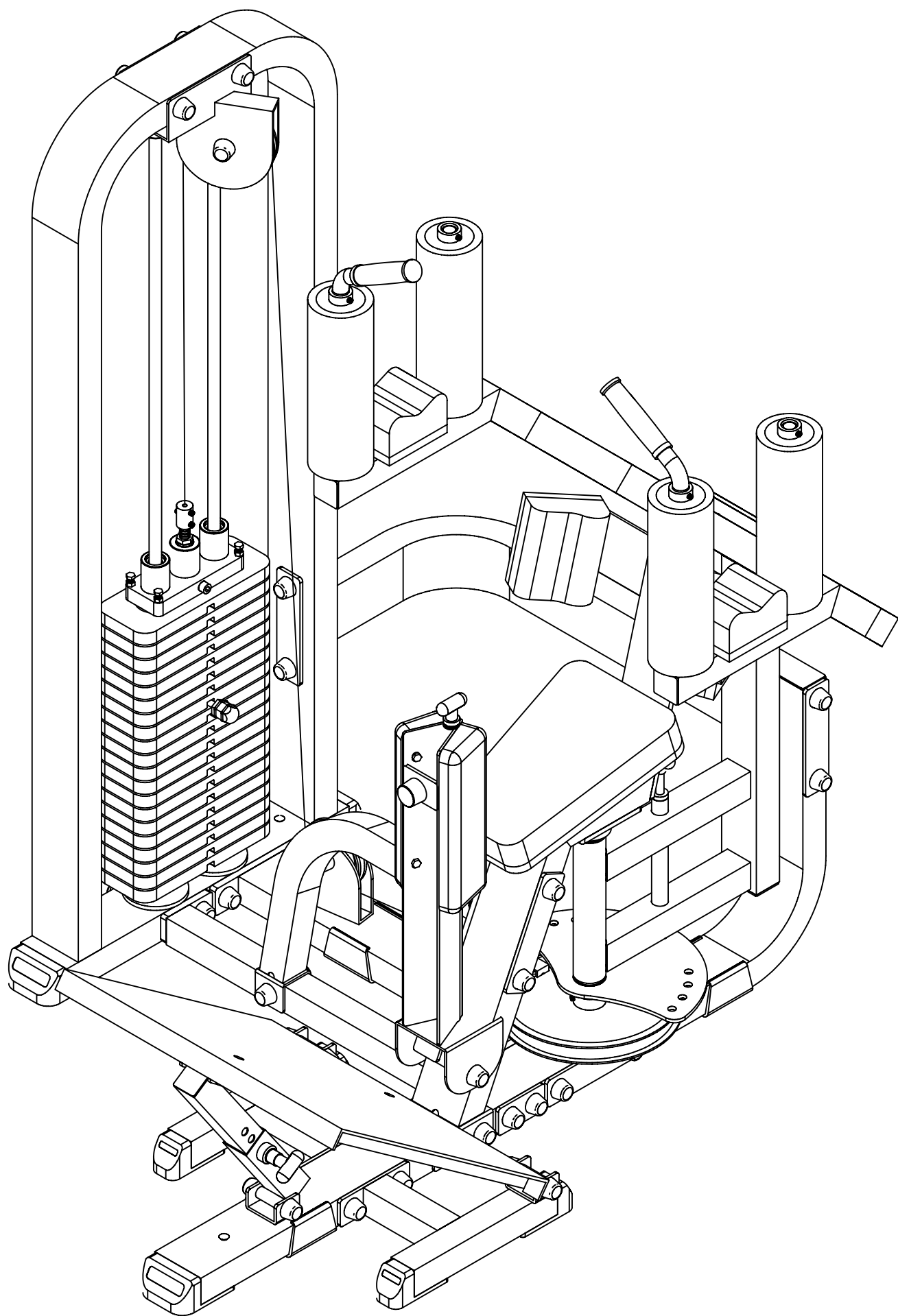

VERSION 0006

- |                                      | Qty.    |
|--------------------------------------|---------|
| A1. 1/2"X5 1/4" HEX HEAD BOLT -----  | [2PCS]  |
| A2. 1/2"X5" HEX HEAD BOLT -----      | [8PCS]  |
| A3. 1/2"X3 1/4" HEX HEAD BOLT -----  | [8PCS]  |
| A4. 1/2"X3" HEX HEAD BOLT -----      | [1PCS]  |
| A5. 1/2"X2" HEX HEAD BOLT -----      | [2PCS]  |
| A6. 1/2"X1 3/4" HEX HEAD BOLT -----  | [2PCS]  |
| A7. 1/2"X1 1/2" HEX HEAD BOLT -----  | [4PCS]  |
| A8. 5/16"X2 3/4" HEX HEAD BOLT ----- | [4PCS]  |
| A9. 5/16"X1 1/2" ROUND BOLT -----    | [1PCS]  |
| A10. 5/16"X1" HEX HEAD BOLT -----    | [12PCS] |
| A11. 5/16"X3/8" SET SCREW -----      | [3PCS]  |
| A12. 7/16"X1 1/2" ROUND BOLT -----   | [1PCS]  |
| A13. M10X16L HEX HEAD BOLT -----     | [3PCS]  |
| A14. 10LB BALL PIN -----             | [1PCS]  |
| A15. 5/8"X1 3/4" ROUND BOLT -----    | [1PCS]  |
| A16. 1/2"X22L SLEEVE -----           | [1PCS]  |
| A17. 3/8"X2 3/4" HEX HEAD BOLT ----- | [1PCS]  |
| A18. 1/2"X5 1/2" HEX HEAD BOLT ----- | [8PCS]  |
| B1. 1/2" NYLON LOCK NUT -----        | [25PCS] |
| B2. 5/8" LOCK NUT -----              | [1PCS]  |
| B3. 5/16" NYLON LOCK NUT -----       | [1PCS]  |
| B4. 3/8" NYLON LOCK NUT -----        | [1PCS]  |
| C1. 1/2" ROUND END CAP WASHER -----  | [56PCS] |
| C2. 5/16" (I.D)WASHER -----          | [16PCS] |
| C3. 5/16" SPRING WASHER -----        | [16PCS] |
| C4. M10 (I.D)WASHER -----            | [3PCS]  |

- |                                     |        |
|-------------------------------------|--------|
| C5. 1/2" (I.D)WASHER -----          | [7PCS] |
| C6. 1/2" SPRING WASHER -----        | [2PCS] |
| C7. 5/8" SPRING WASHER -----        | [1PCS] |
| C8. 3/8" ROUND END CAP WASHER ----- | [2PCS] |

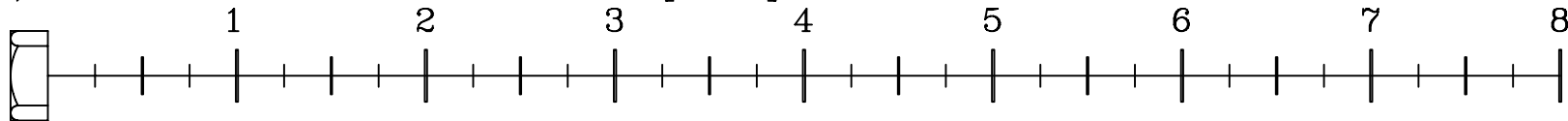
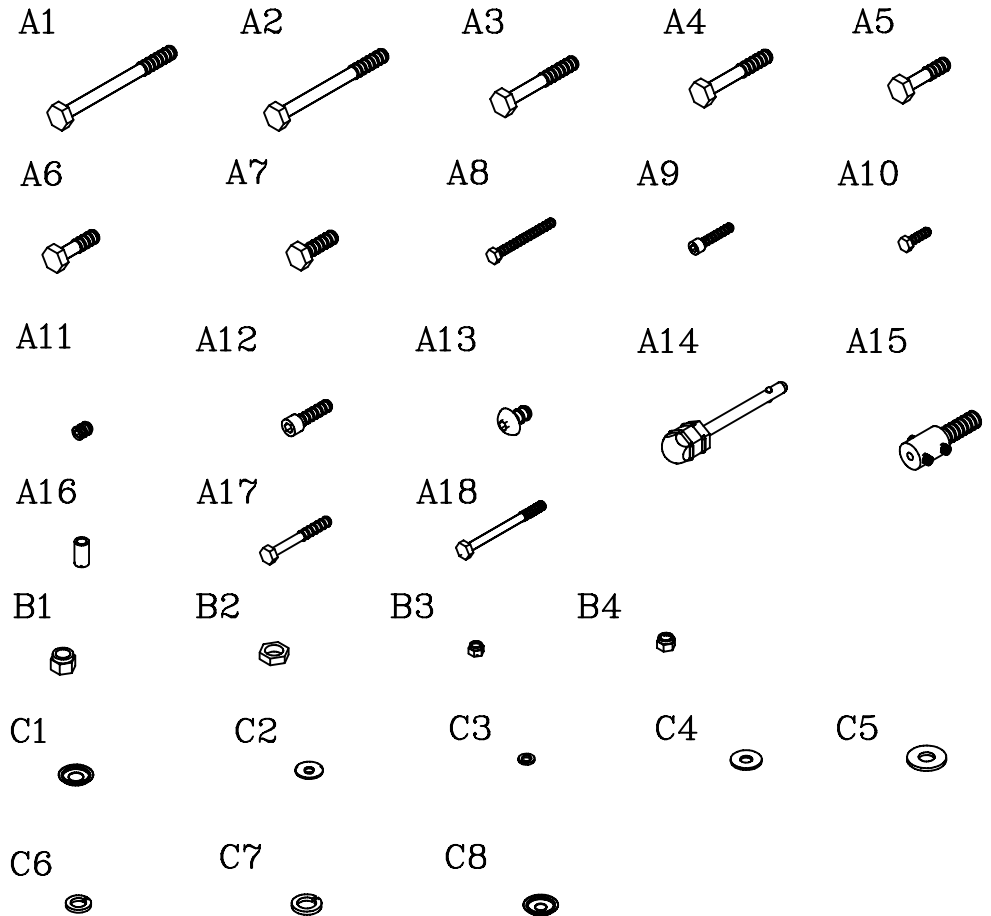

	Qty.
D1. 1/2" BOLT CAP -----	[60PCS]
D2. $\phi$ 1" SHAFT COLLAR (8130-024) -----	[4PCS]
D3. $\phi$ 3/4"X8L STEEL BUSHING (8110-014) ----	[2PCS]
D4. $\phi$ 4" RUBBER DONUT (9310-017) -----	[2PCS]
D5. $\phi$ 1"X34X135 RUBBER (9212-016)-----	[2PCS]
D6. 1 3/4"X1 3/4" END CAP (9211-004) ----	[1PCS]
D7. 2"X2"X2.5t END CAP (9211-006) -----	[2PCS]
D8. 2"X4" END CAP (9211-014)-----	[1PCS]
D9. $\phi$ 3" NYLON WASHER (9214-008)-----	[8PCS]
D10. 2"X4" FOOT CAP (9211-028)-----	[3PCS]
D11. 2"X2" FOOT CAP (9211-025)-----	[4PCS]
D12. 2"X4" RUBBER DOUNT (9212-009) -----	[3PCS]
D13. $\phi$ 3/4" SHAFT COLLAR (9211-046) -----	[2PCS]
D14. $\phi$ 4" FOAM ROLLER (9211-039) -----	[4PCS]
D15. CHROME TOP PLATE (8400-002) -----	[1PCS]
D16. WEIGHT SELECTOR BAR (8220-060) ----	[1PCS]
D17. $\phi$ 6" PULLEY (9213-009)-----	[1PCS]
D18. $\phi$ 4 1/2" PULLEY (9213-010) -----	[1PCS]
D19. BEARING (8510-009)-----	[2PCS]
D20. 2770mm STEEL CABLE -----	[1PCS]
D21. $\phi$ 5/8" ROUND END CAP (9211-015) ----	[4PCS]
D22. $\phi$ 100 PULLEY (9213-017)-----	[2PCS]
D23. 50X75 END CAP (9211-012)-----	[1PCS]

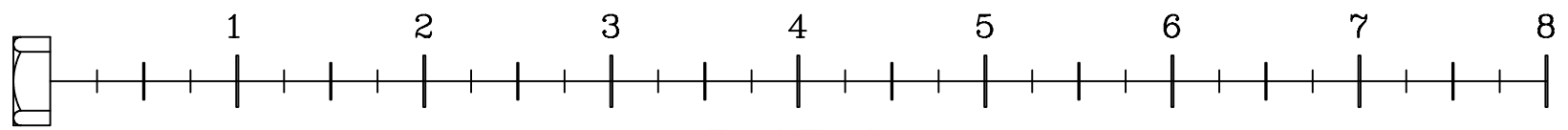
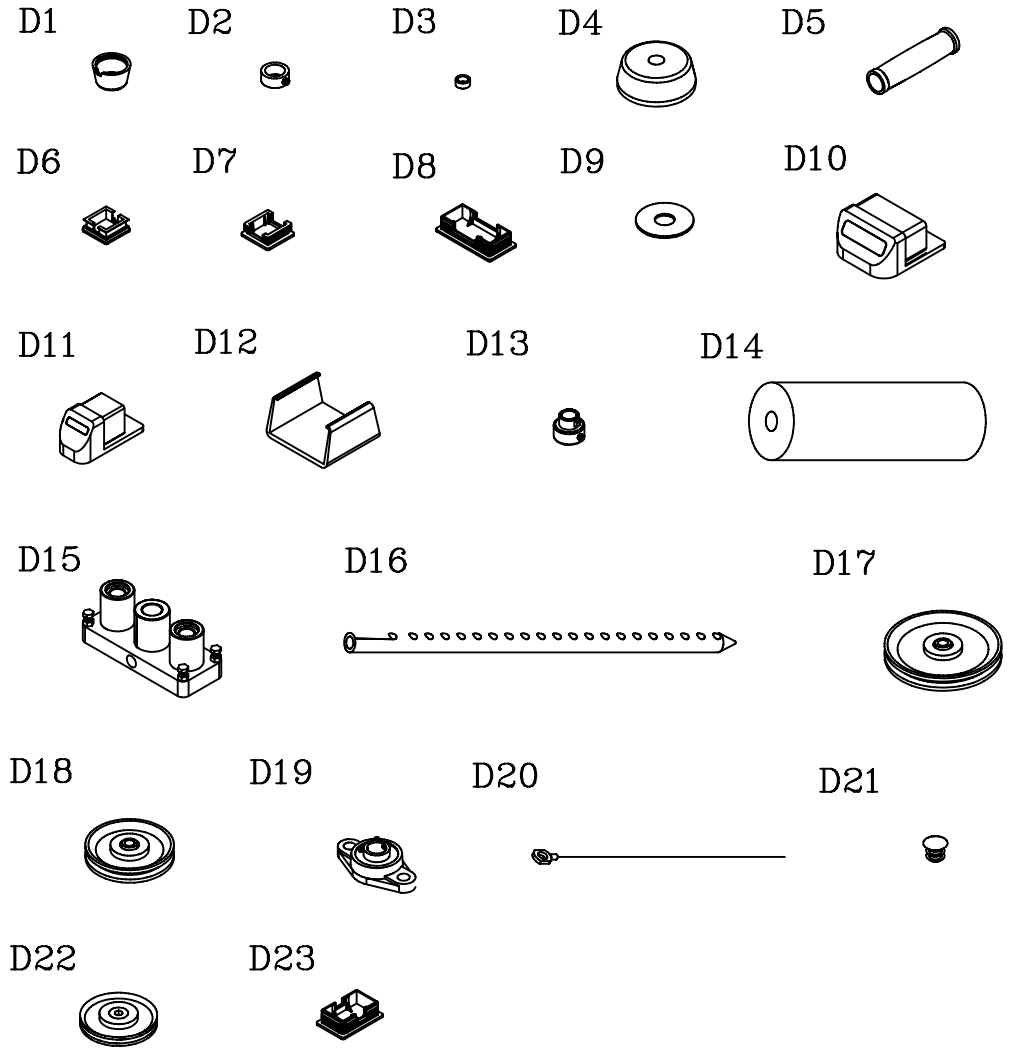

A [1PCS]

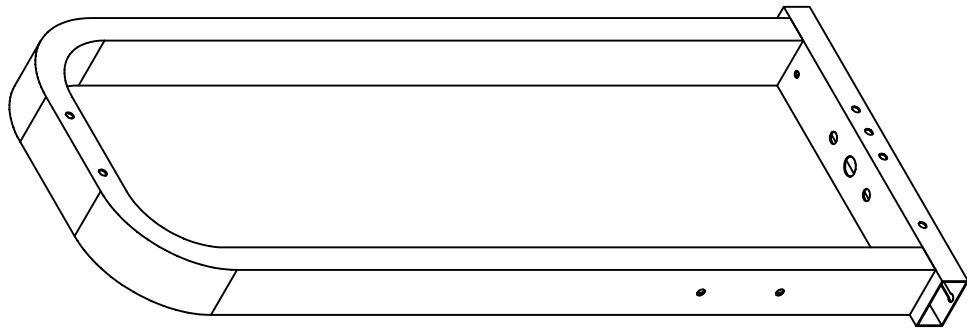

D [1PCS]

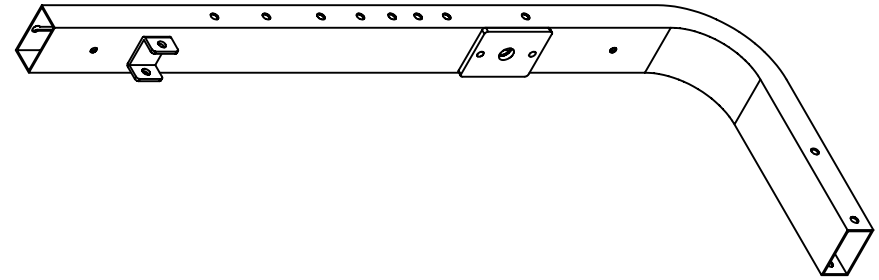

B [1PCS]

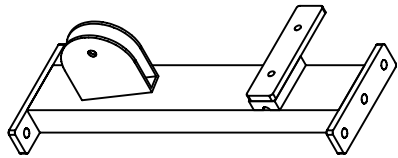

E [1PCS]

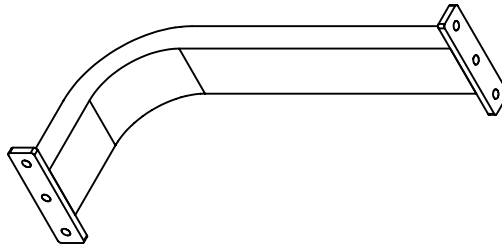

F [1PCS]

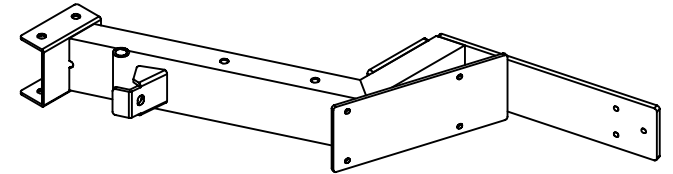

C [1PCS]

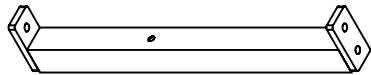

G [1PCS]

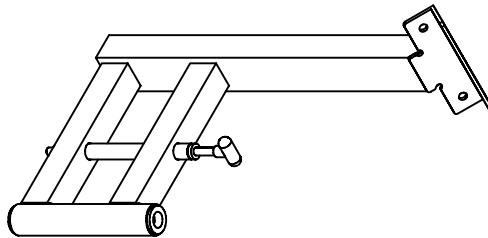

H [1PCS]

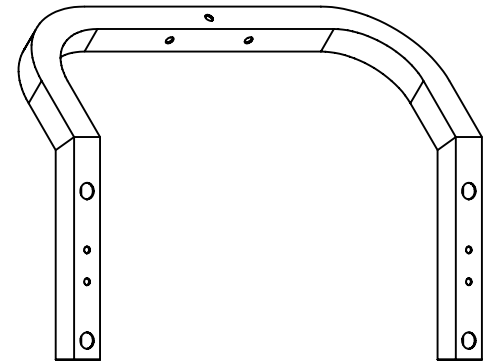

I [1PCS]

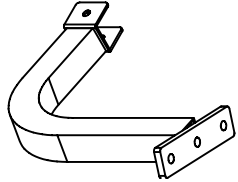

J [1PCS]

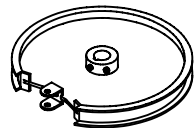

K [1PCS]

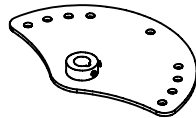

L [1PCS]

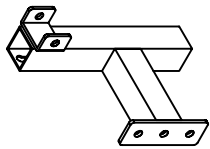

M [1PCS]

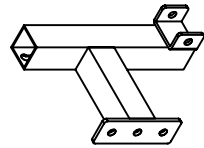

N [1PCS]

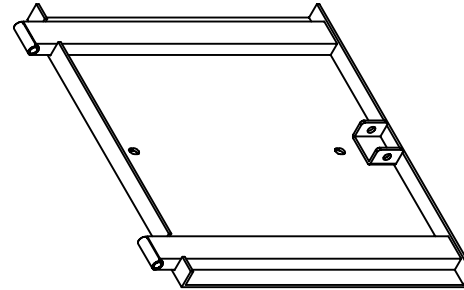

O [1PCS]



P [1PCS]

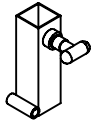

Q [1PCS]

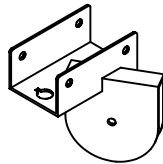

R [1PCS]

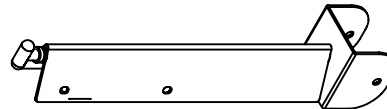

S [1PCS]

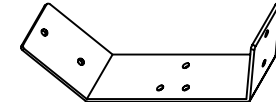

T [6PCS]

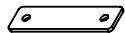

U [2PCS]



V [2PCS]

ø3/4"X1510L

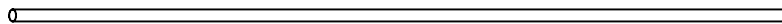

W [1PCS]

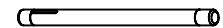

X [2PCS]

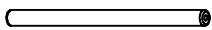

Y [1PCS]

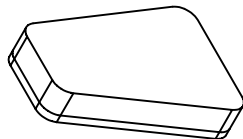

Z [2PCS]

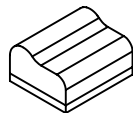

AA [2PCS]

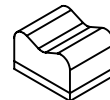

AB [2PCS]

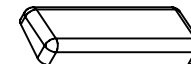

AC [2PCS]

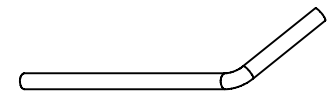



# SOT-1800

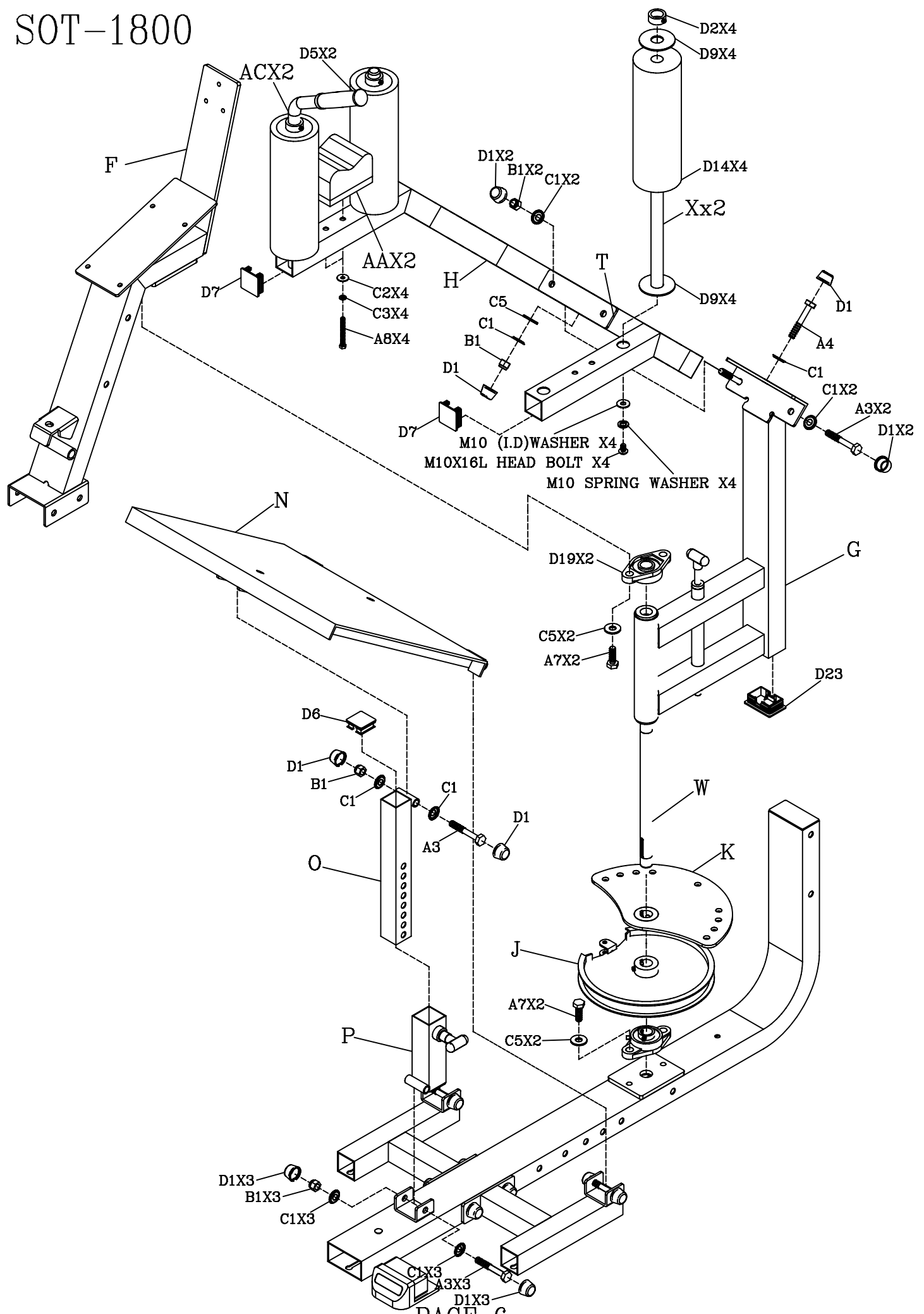

# SOT-1800

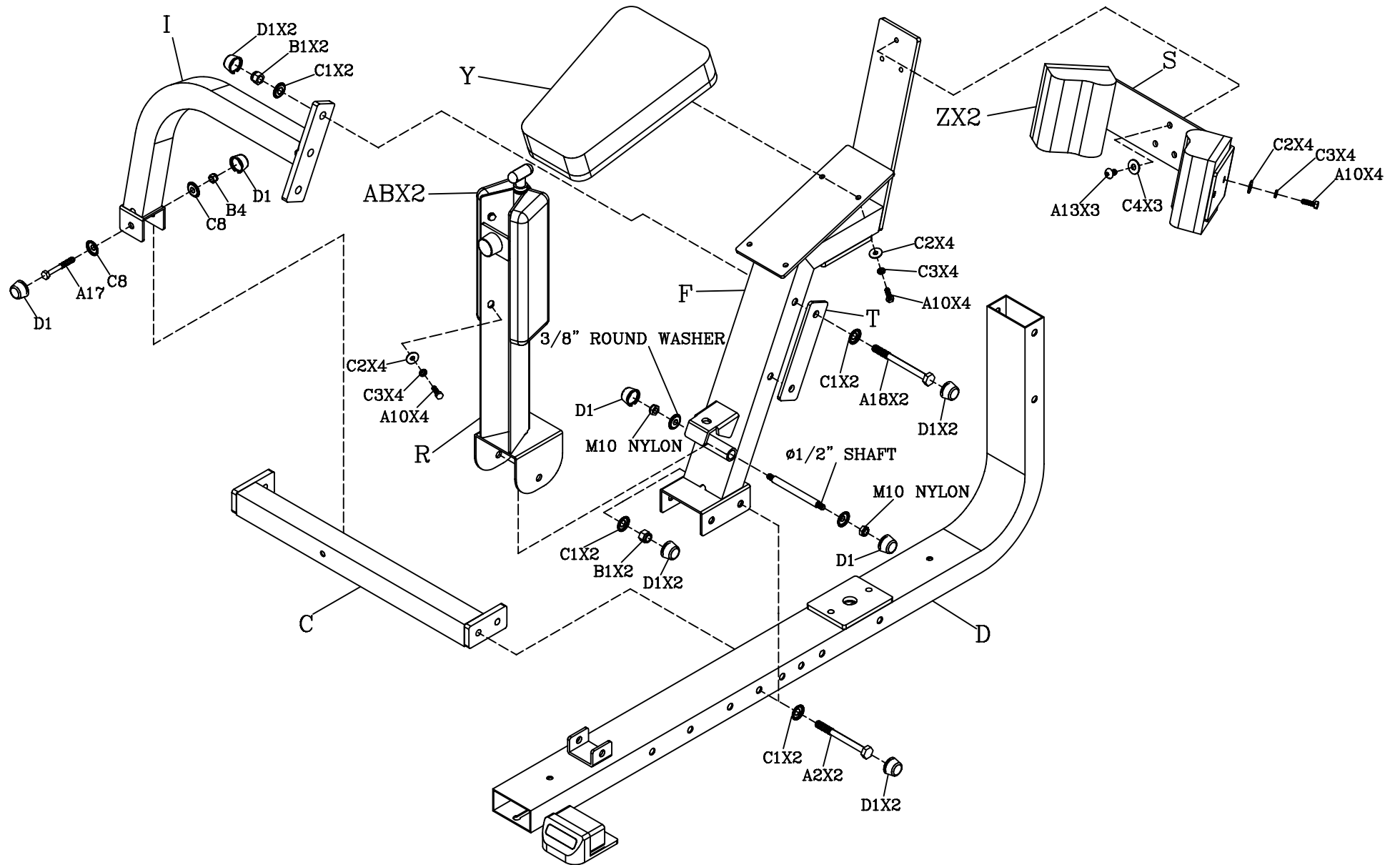



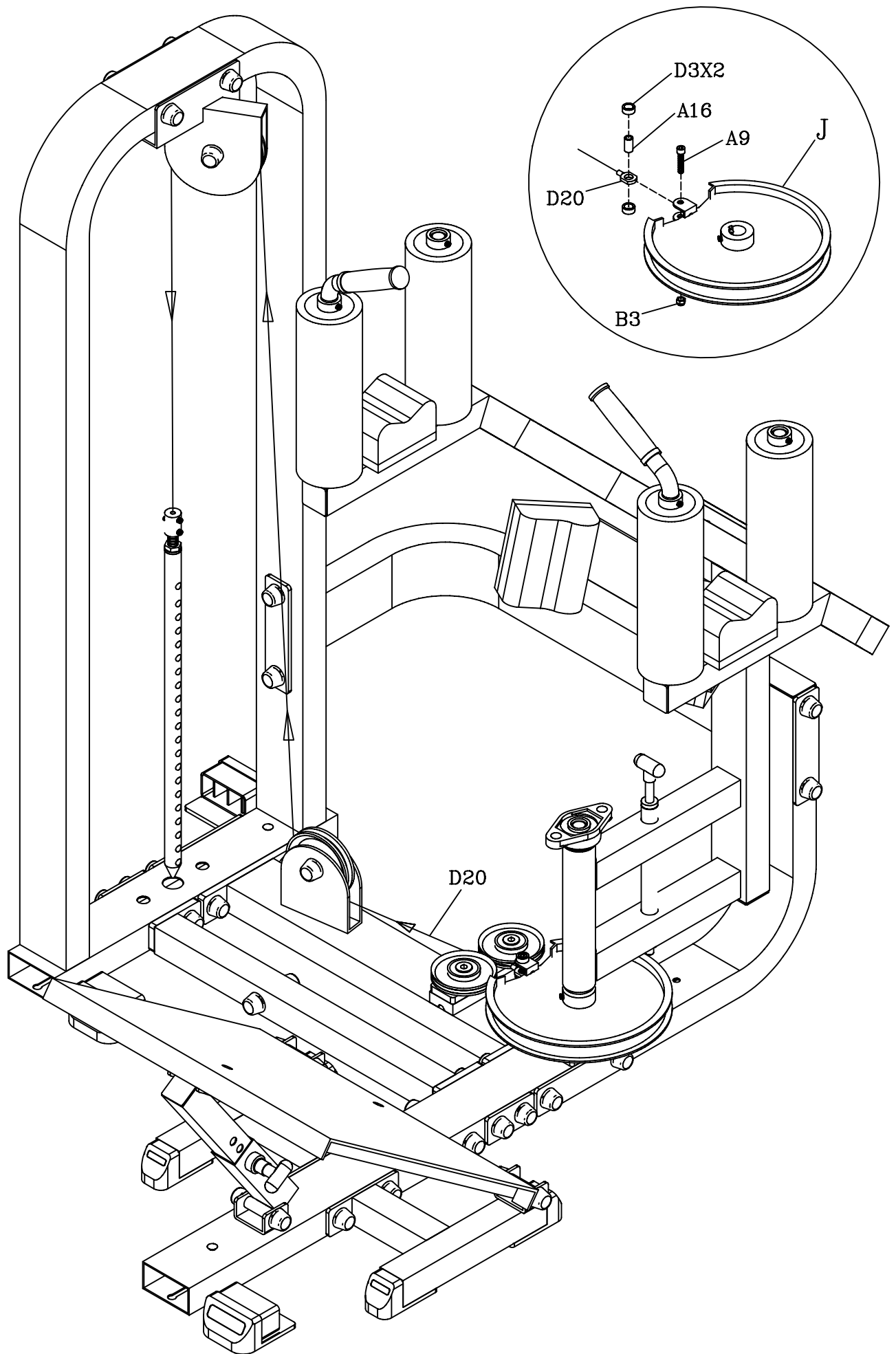

SOT-1800

