

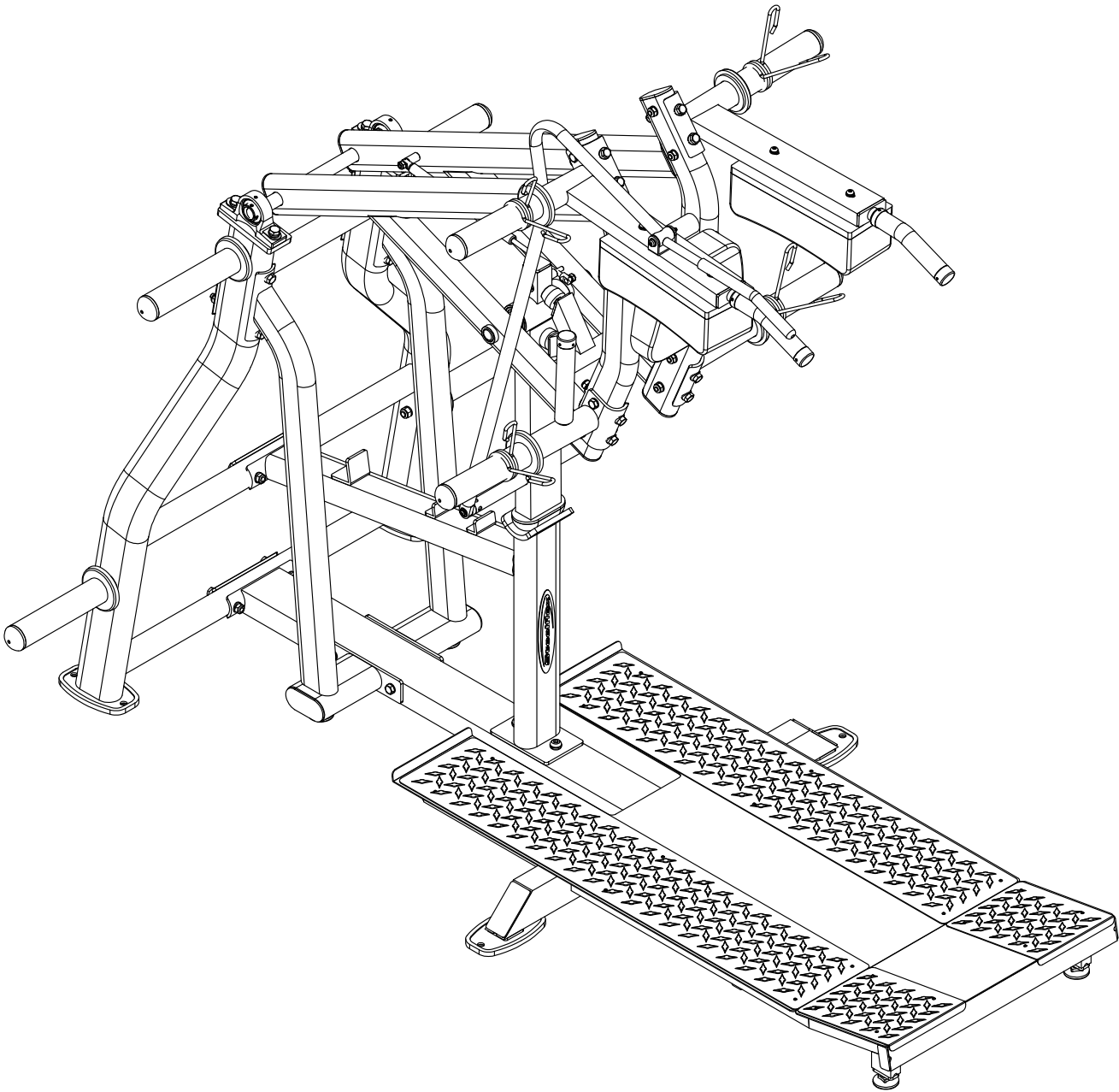

PLSS.1



Assembly & Instructions
OWNER'S & MANUAL

PLSS.1 HARDWARE
(shown in actual size)

A1. M10X75L Hex Head Bolt...4PCS

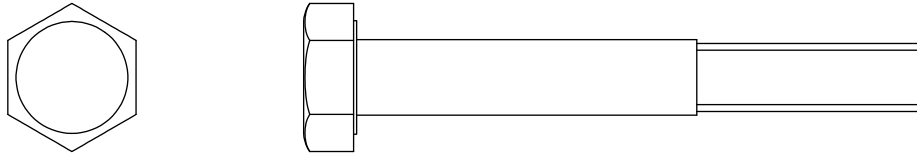

A2. M12X80L Hex Head Bolt...2PCS

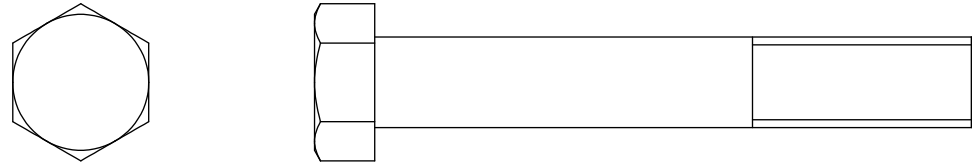

A4. M10X130L Hex Head Bolt...6PCS

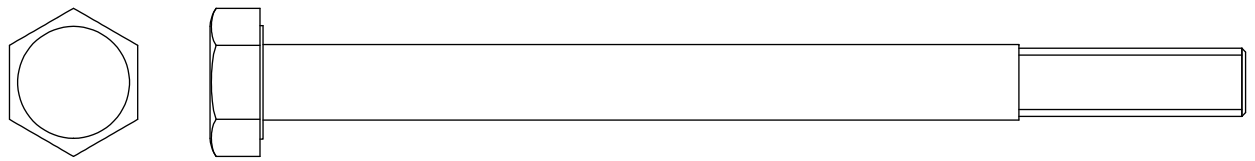

A5. M12X30L Hex Head Bolt...6PCS

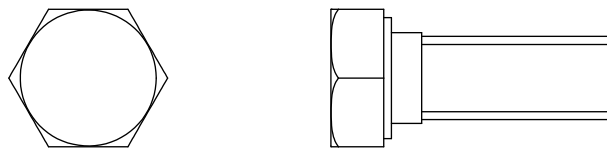

A6.M8X25L Allen Screw...4PCS



A7.M8X50L Allen Screw...4PCS

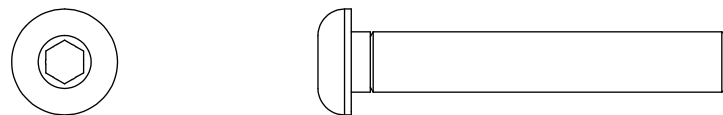

A8.M5X10L Allen Screw...2PCS

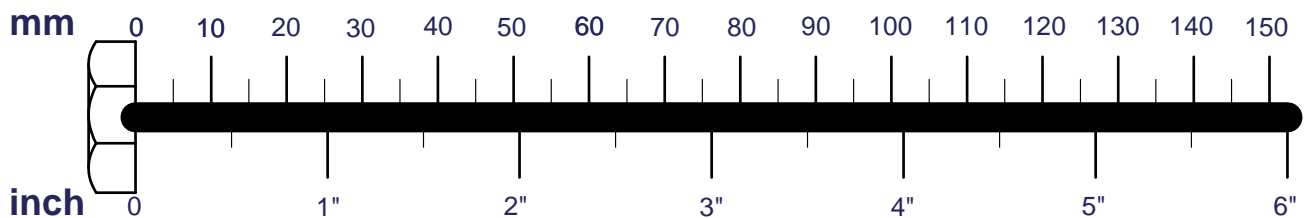

PLSS.1 HARDWARE

(shown in actual size)

A9. M8X87L Hex Head Bolt(8721-105)...2PCS

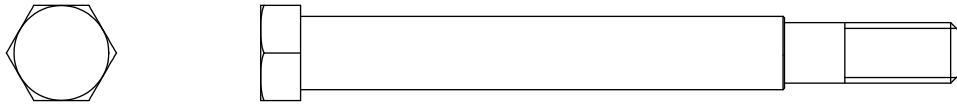

A10. M12X20L Allen Head Bolt...2PCS

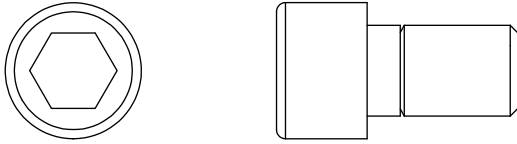

A11.MSB8X20L Equal Height Screw...2PCS

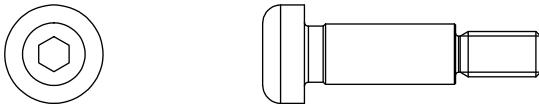

A12.MSB8X50L Equal Height Screw...2PCS

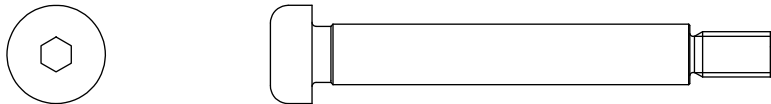

A13. M8X5L GRUB SCREW ...4PCS (Pre-installed)



A15. M5X5L GRUB SCREW ...12PCS (Pre-installed)



A16. M4 Self-plugging Rivet · Riveting Tube Length 10mm...20PCS (Pre-installed)



A17. M10X100L Hex Head Bolt...8PCS

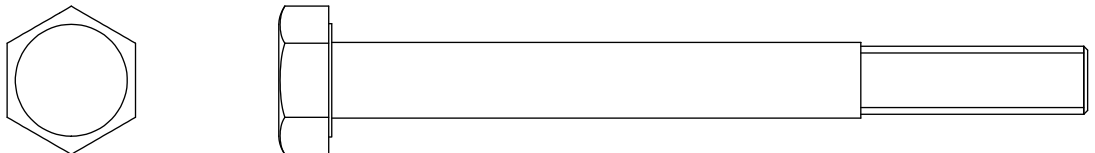

A18. M10X60L Hex Head Bolt...8PCS

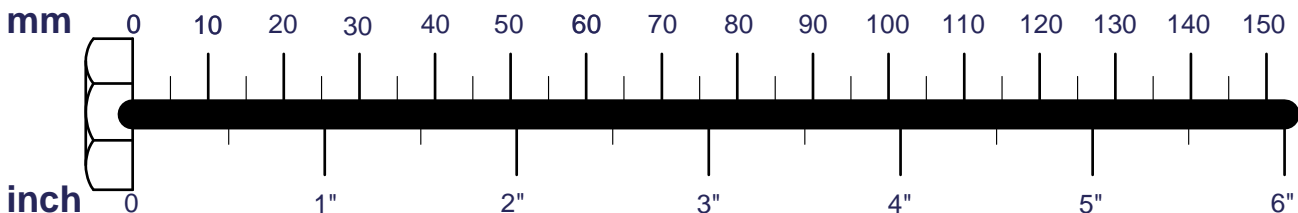
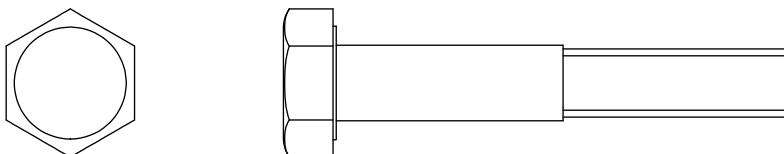

PLSS.1 HARDWARE
(shown in actual size)

C1.M10 Arc Washer...28PCS

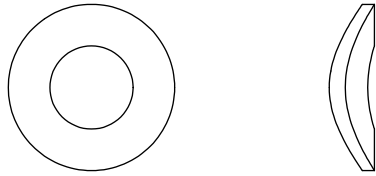

C4.M12 WASHER (Ø25)...12PCS

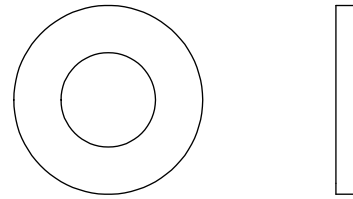

C3.M12 SPRING WASHER...8PCS

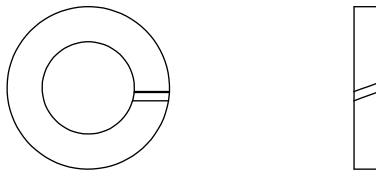

C6.M8 WASHER (Ø16)...12PCS

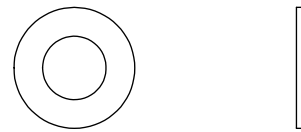

C7.M8 SPRING WASHER...10PCS



C8.M5 WASHER (Ø12)...2PCS



C9.M6 WASHER (Ø16)...4PCS

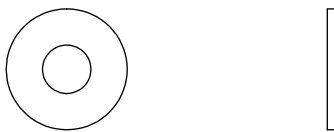

C10.M10 WASHER (Ø19)...22PCS

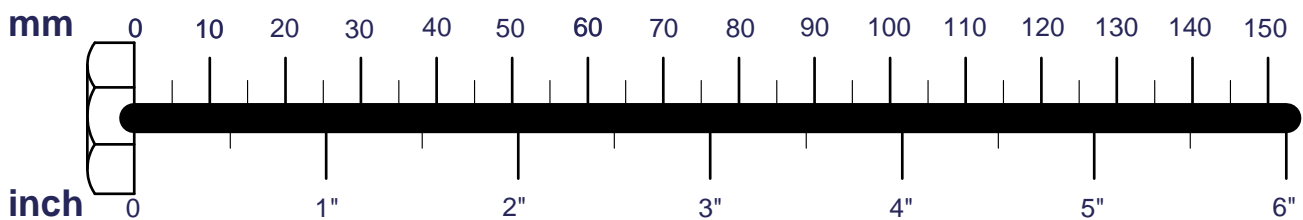
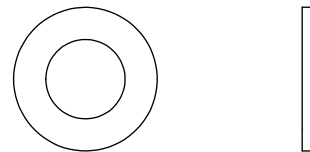

PLSS.1 HARDWARE
(shown in actual size)

B1.M10 Nylon Lock Nut...22PCS

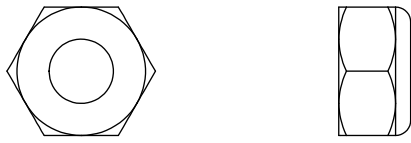

B2.M12 Nylon Lock Nut...4PCS

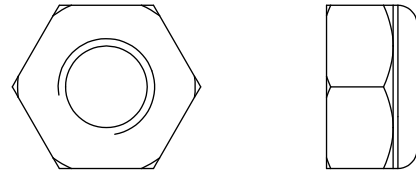

B3.M12 Nut...2PCS

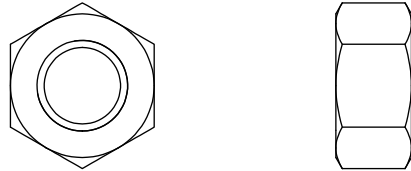

B4.M6 Nylon Lock Nut...4PCS



B5.3/8"Thin nut(7T)...2PCS (Pre-installed)

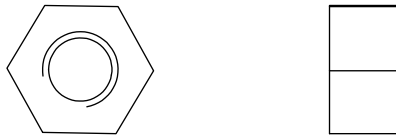

B6.M8 Nylon Lock Nut...2PCS

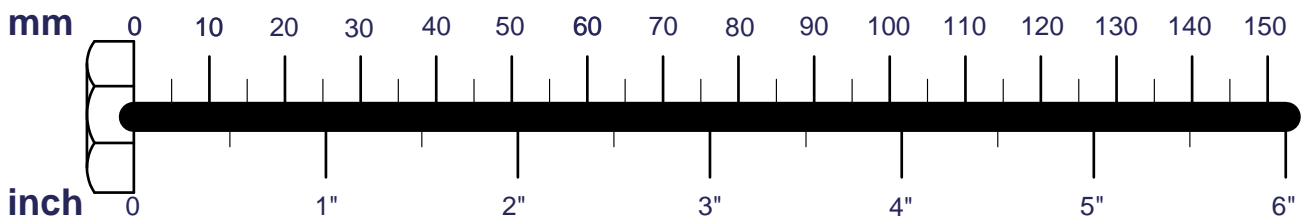

PLSS.1 HARDWARE
(shown in actual size)

A[1PCS]

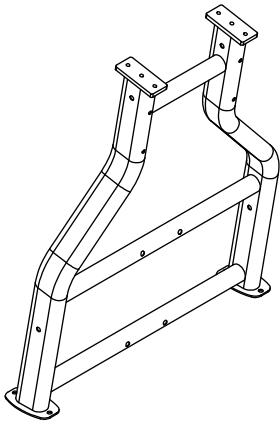

B[1PCS]

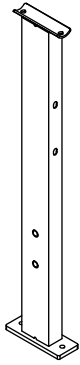

C[1PCS]

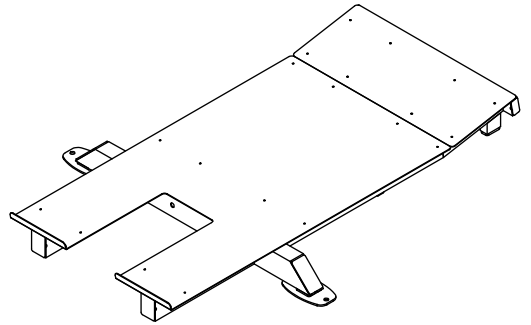

D[1PCS]

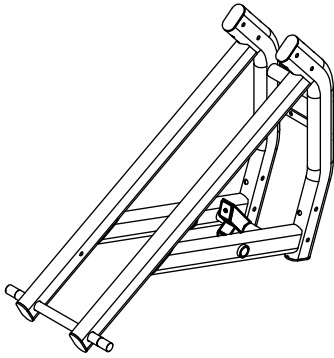

E[1PCS]

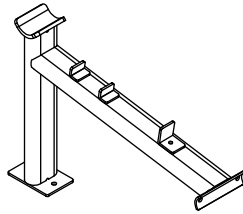

F[1PCS]

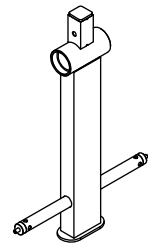

G[1PCS]

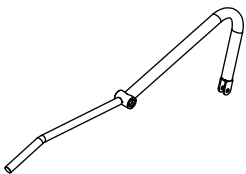

H[1PCS]

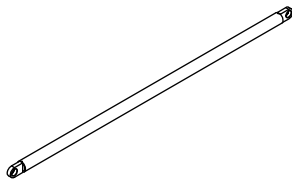

I[4PCS]

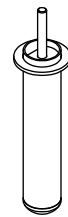

J[1PCS]

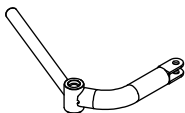

K[1PCS]

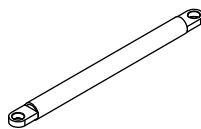

L[1PCS]

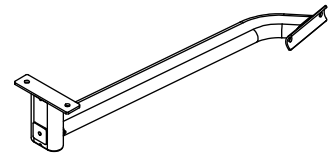

M[1PCS]

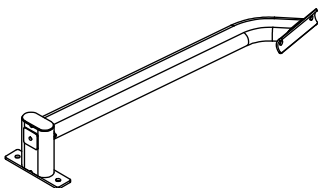

N[1PCS]

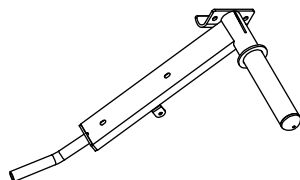

O[1PCS]

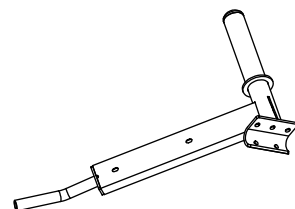

PLSS.1 HARDWARE
(shown in actual size)

P[1PCS]

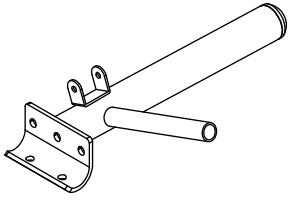

Q[1PCS]

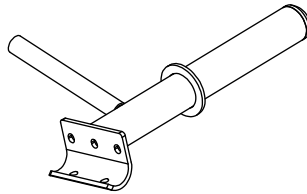

U[4PCS]
(8343-163)

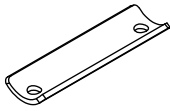

V[2PCS]
(8510-005)

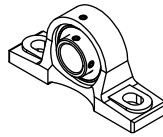

W[1PCS]
(8830-042)

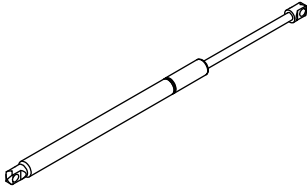

R[1PCS]
(9111-106)

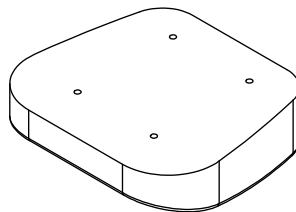

S[2PCS]
(9131-066)

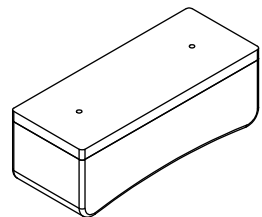

PLSS.1 HARDWARE
(shown in actual size)

D1.Rubber Insert (9310-076).....	[4PCS]
D2.Crash Pad (9214-045).....	[4PCS]
D3.Stop The Mat (9310-057).....	[1PCS]
D5.Rubber Dount (9310-016).....	[8PCS]
D6.Spring Clip (OC06)	[4PCS]
D7.Iron Set (8110-163).....	[2PCS]
D9.Cushion Mat (9310-018)(pre-installed).....	[2PCS]
D10.Chrome Collar (8130-253) (pre-installed).....	[2PCS]
D11.Foot Treadle (8313-254) (pre-installed).....	[2PCS]
D12.Foot Treadle (8333-157) (pre-installed).....	[2PCS]
D13.Bearing (8510-037) (pre-installed).....	[2PCS]
D14.Bearing (8510-064) (pre-installed).....	[12PCS]
D15.Iron set (8890-061) (pre-installed).....	[4PCS]
D16.Impregnated With Handle (9162-162)(pre-installed).....	[4PCS]
D18.Impregnated With Handle (9162-213)(pre-installed).....	[2PCS]
D19.Pole (8220-292)(pre-installed).....	[1PCS]

D1

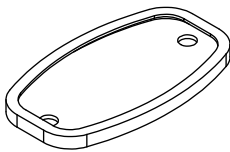

D2



D3

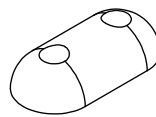

D5

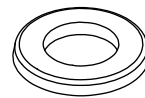

D6

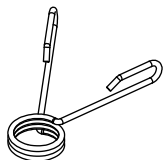

D7



D9

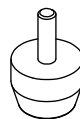

D10



D11

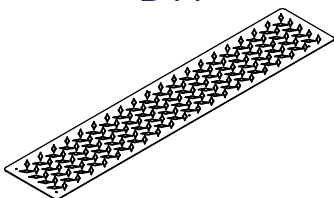

D12

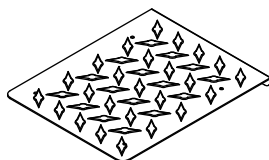

D13



D14



D15



D16

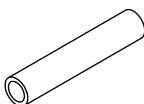

D18

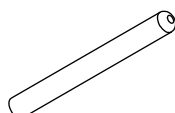

D19

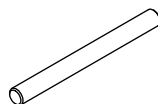

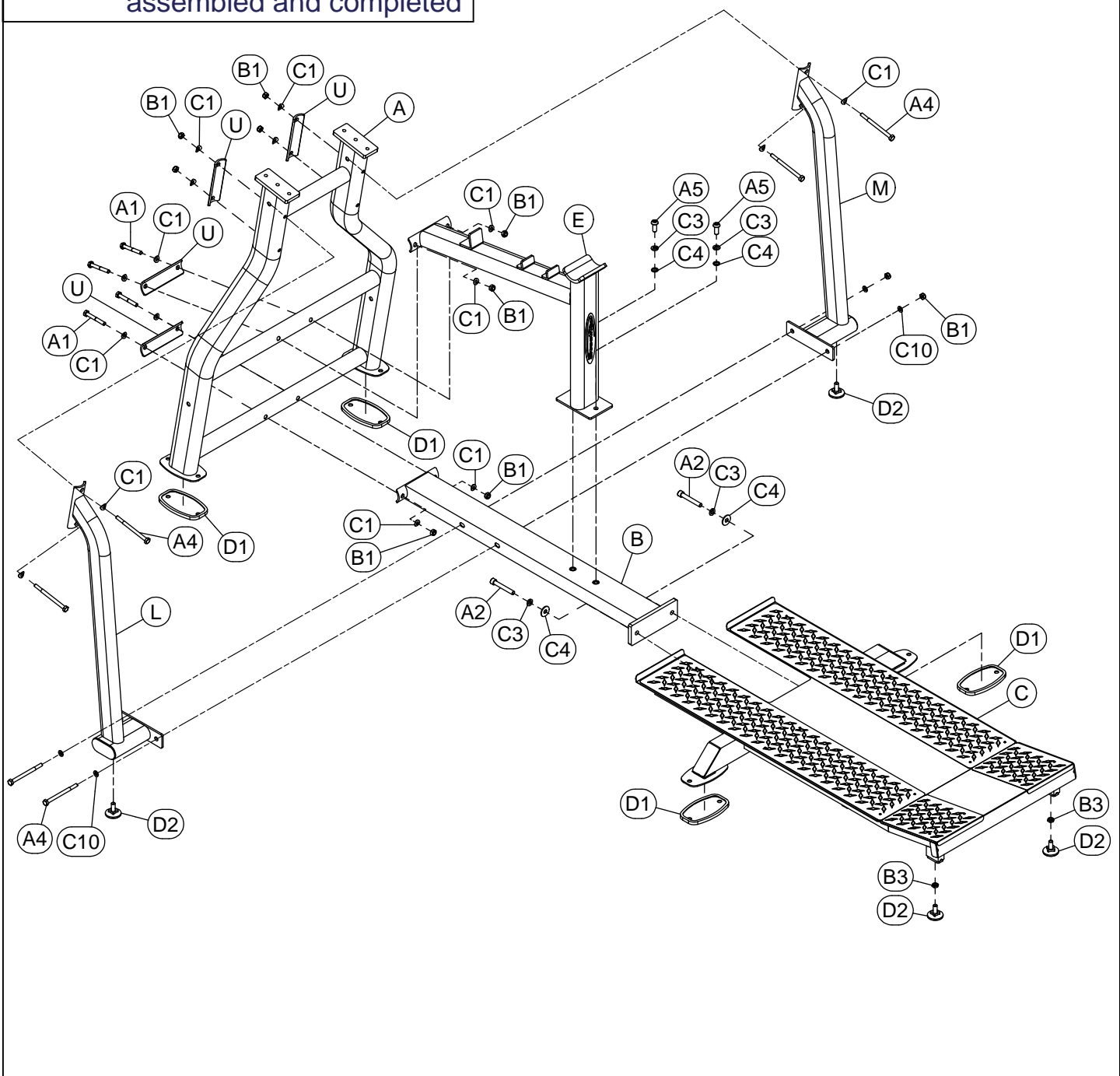
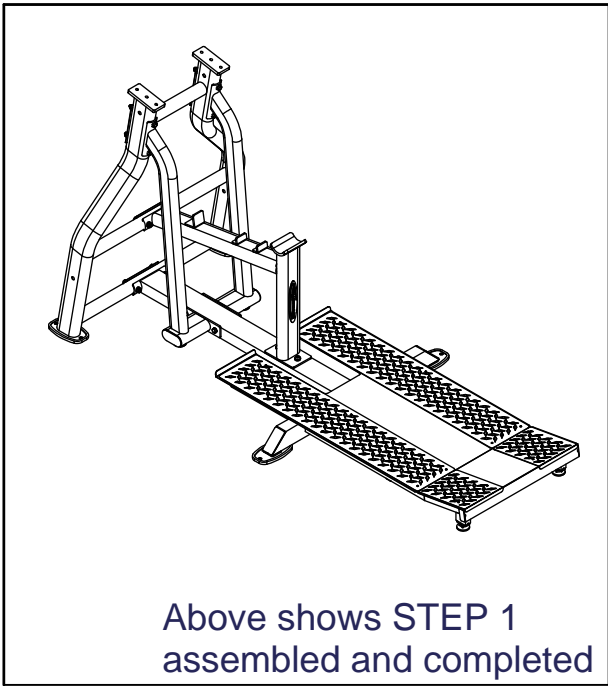

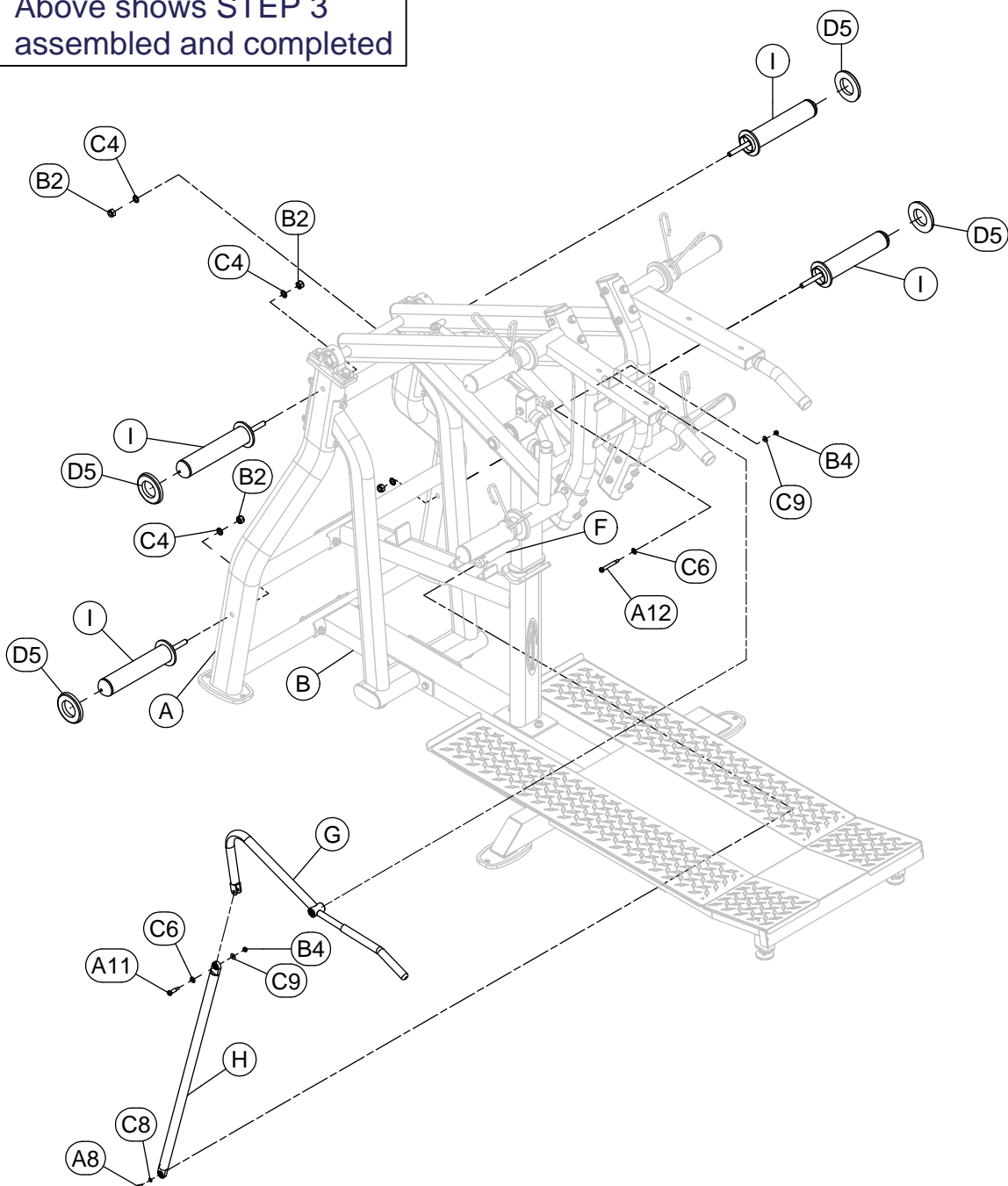
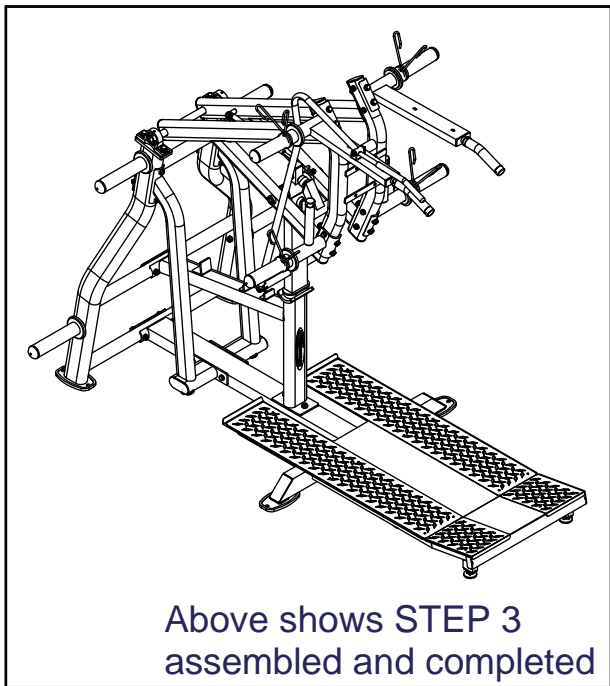

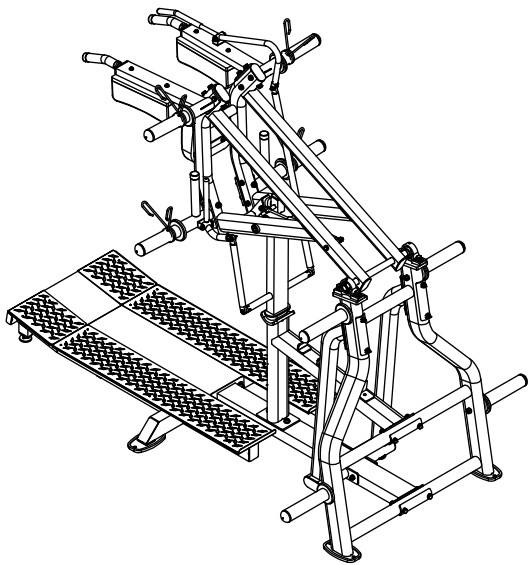

Above shows STEP 4 assembled and completed

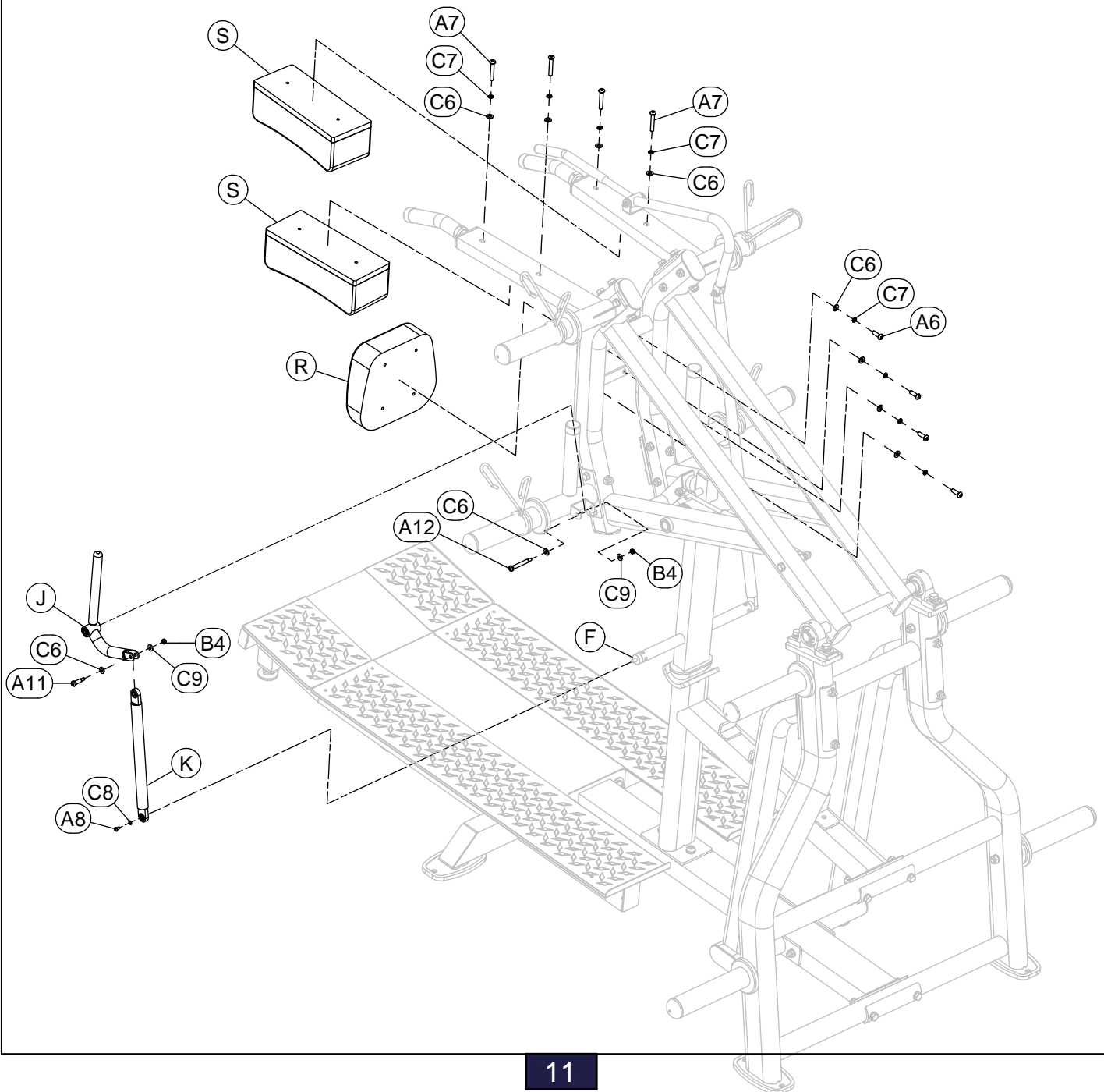

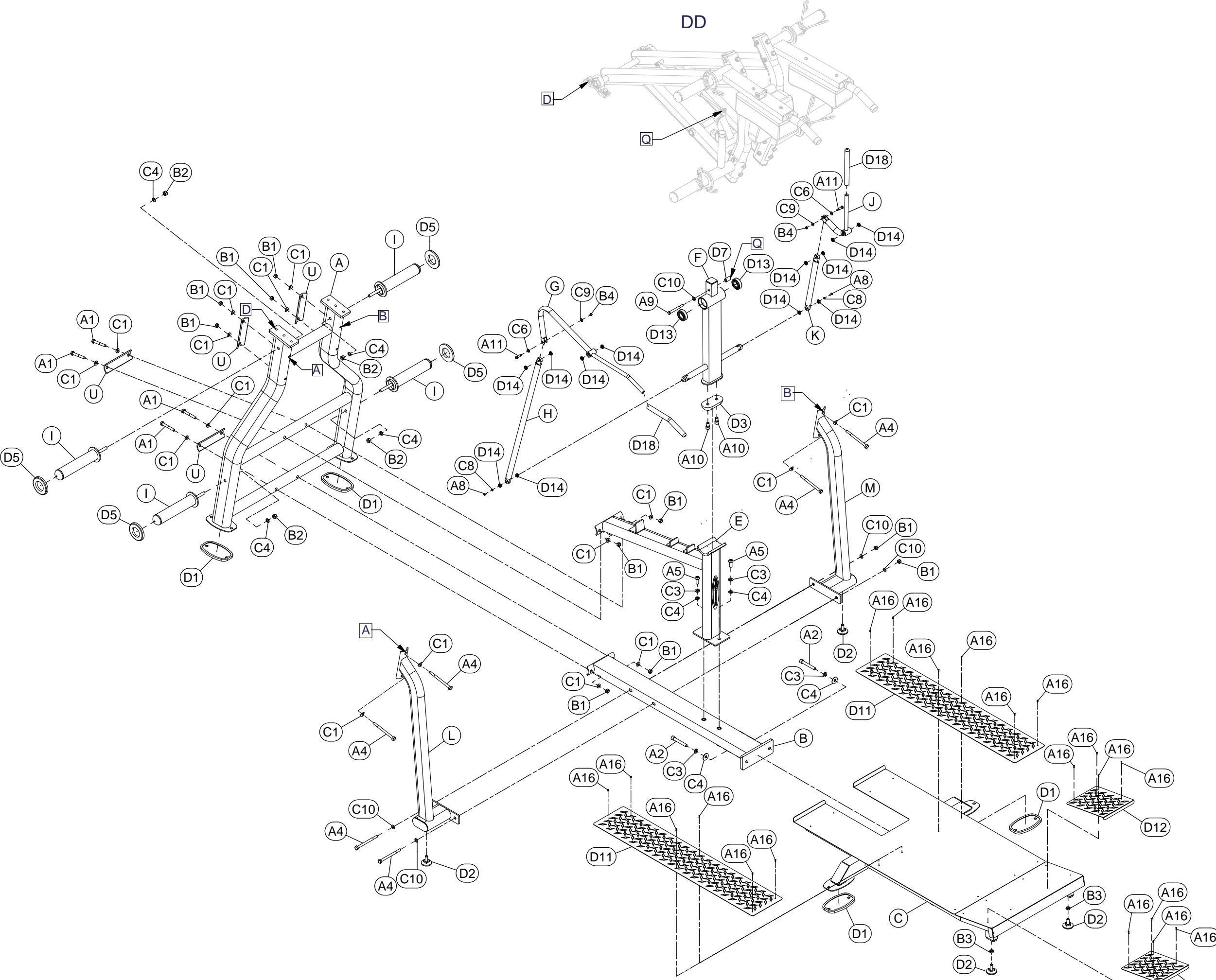

DD

Q

KEY

Match the letters inside each triangle

<input type="checkbox"/> A	connects to	<input type="checkbox"/> A
<input type="checkbox"/> B	connects to	<input type="checkbox"/> B
<input type="checkbox"/> D	connects to	<input type="checkbox"/> D
<input type="checkbox"/> Q	connects to	<input type="checkbox"/> Q