

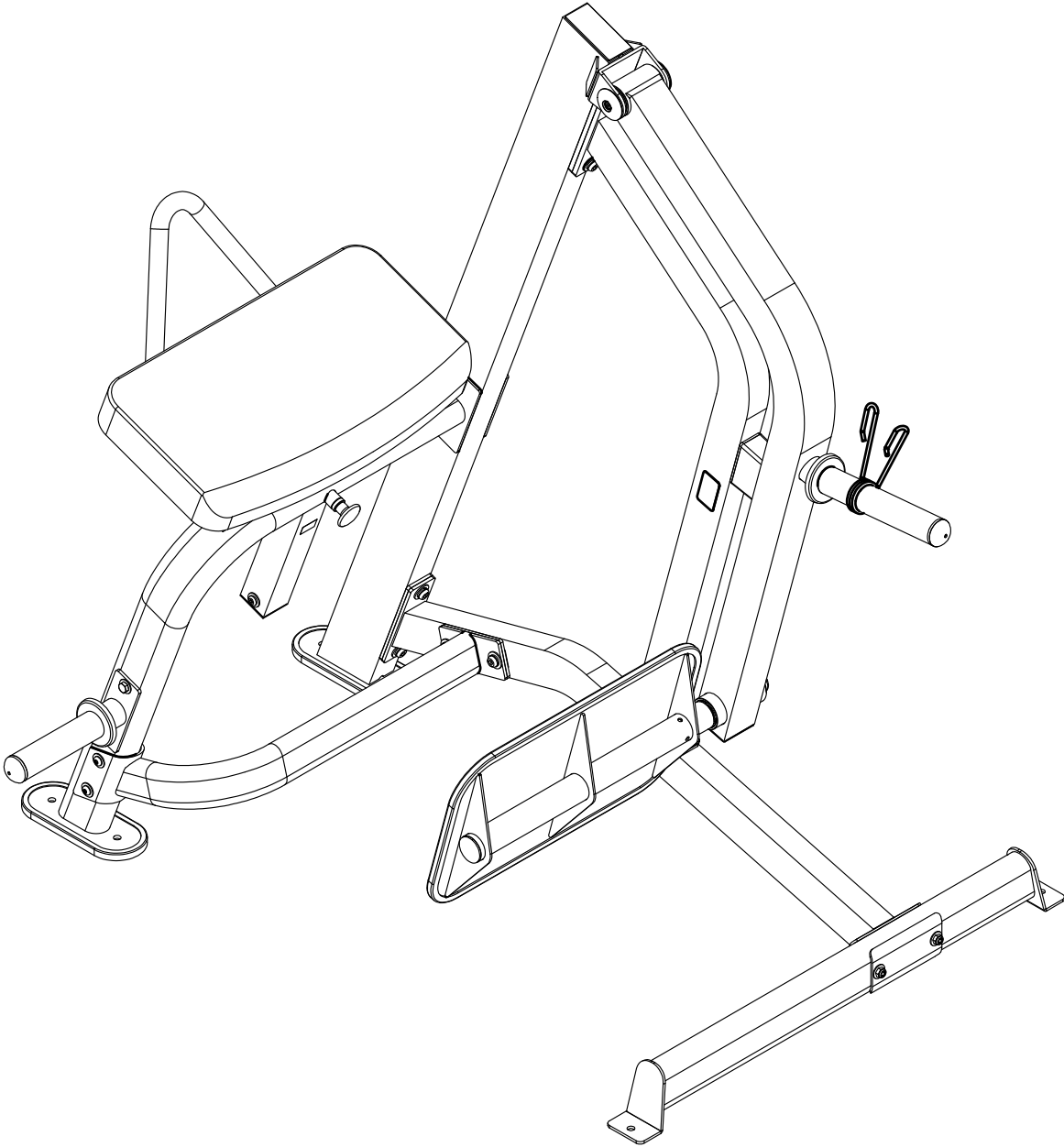

PLHE



Assembly & Instructions
OWNER'S & MANUAL

PLHE HARDWARE

(shown in actual size)

A1. M5x5L GRUB SCREW...2PCS



A2. M8x25L CAP SCREW...1PCS

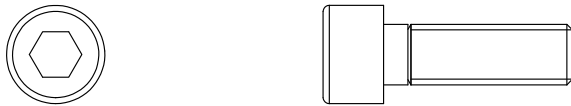

A3. M8x45L ALLEN SCREW...4PCS

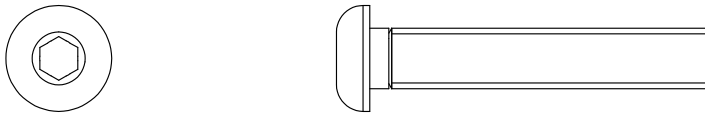

A4. M8x55L CAP SCREW...2PCS

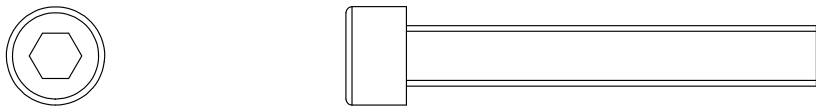

A5. M10x25L TAPER SCREW...2PCS



A6. M10x55 ALLEN SCREW...2PCS

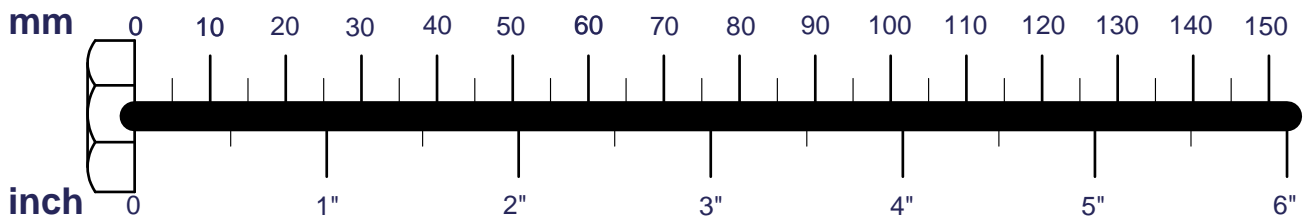
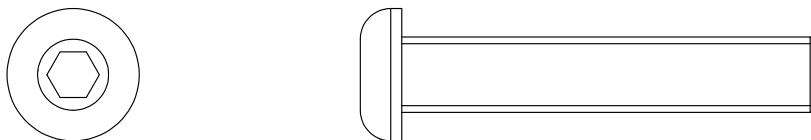

PLHE HARDWARE

(shown in actual size)

A7. M10x65L ALLEN SCREW...1PCS(Pre-installed)

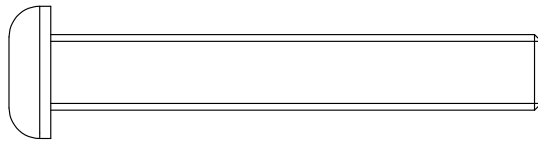
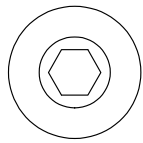

A8. M10x75L ALLEN SCREW...7PCS

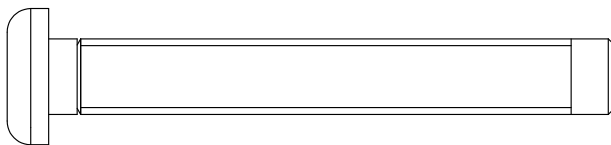
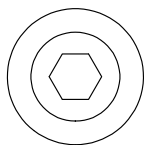

A9. M12x25L ALLEN SCREW...8PCS

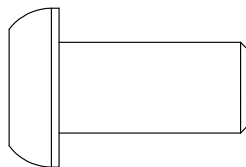
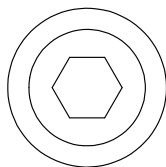

A10. M12x90 ALLEN SCREW...2PCS

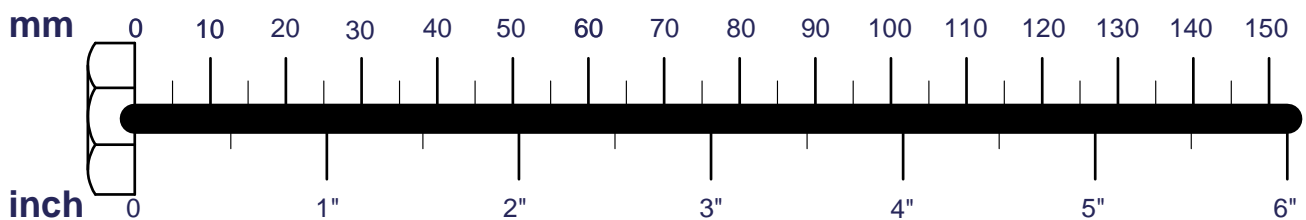
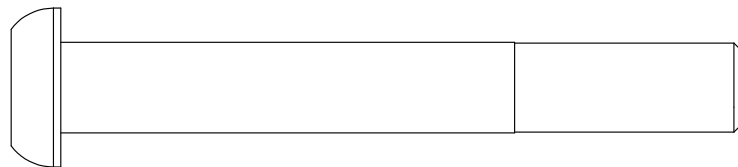
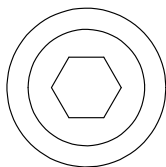

PLHE HARDWARE

(shown in actual size)

B1. M10 NUT...10PCS(1PCS Pre-installed)

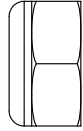
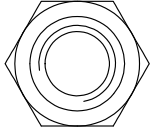

B2. M12 NUT...2PCS

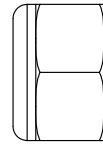
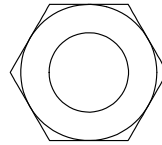

C1. M8 SPRING WASHER...6PCS

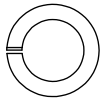

C2. M8 WASHER(Ø18)...4PCS

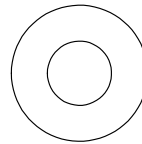

C3. M10 SPRING WASHER...2PCS

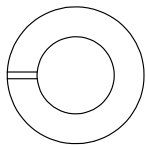

C4. M10 WASHER(Ø27)...18PCS

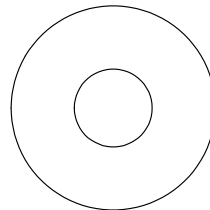

C5. M12 SPRING WASHER...8PCS

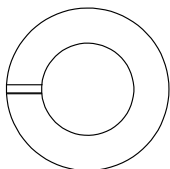

C6. M12(Ø25) WASHER...12PCS

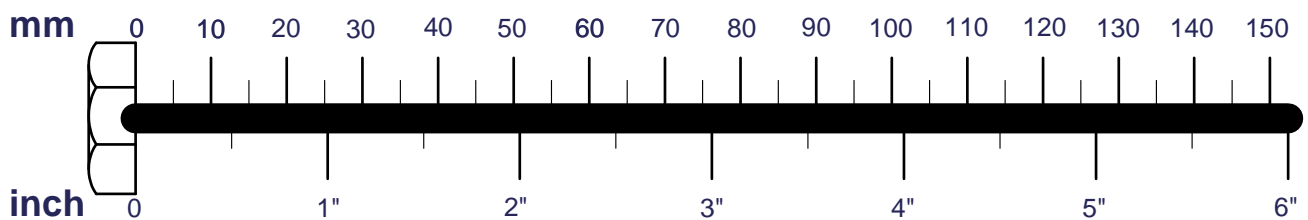
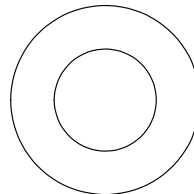

PLHE HARDWARE

(shown in actual size)

C8. Snap Link907425X1.2...2PCS(Pre-installed)

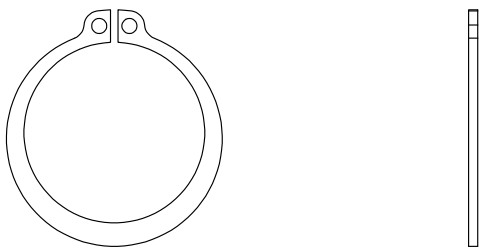

C9. Snap Link907452X1.2...2PCS(Pre-installed)

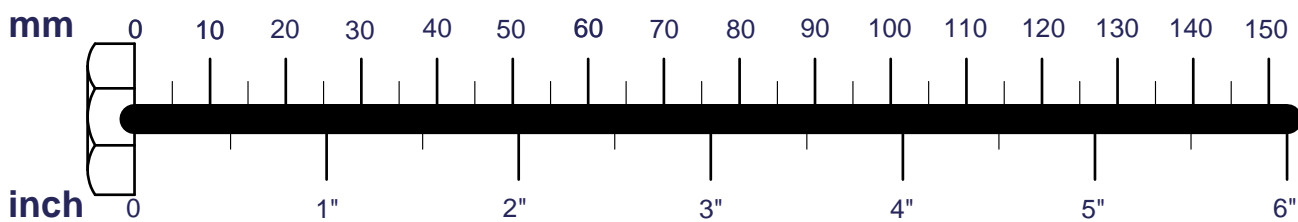
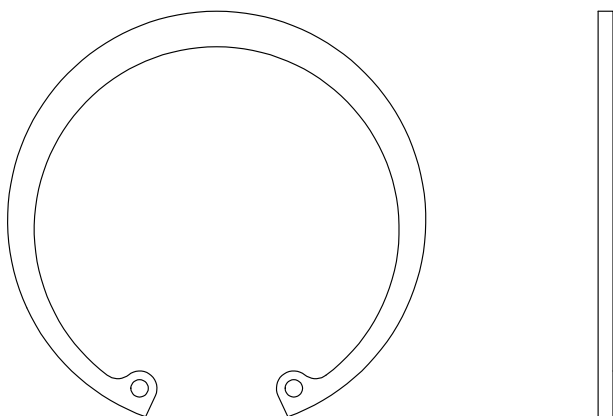

PLHE PARTS

A [1PCS]

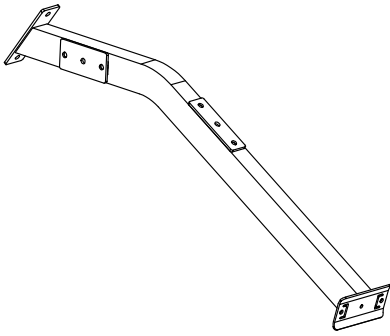

B [1PCS]

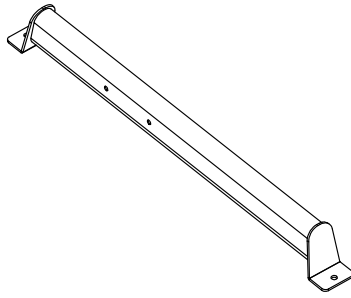

D [1PCS]

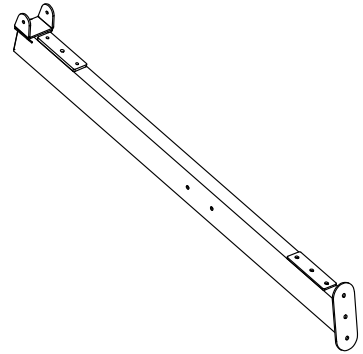

C [1PCS]

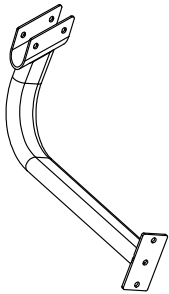

E [1PCS]

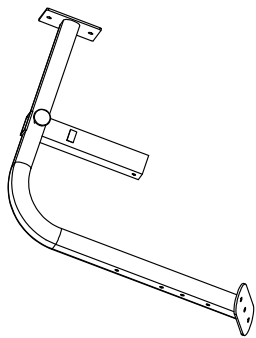

F [1PCS]

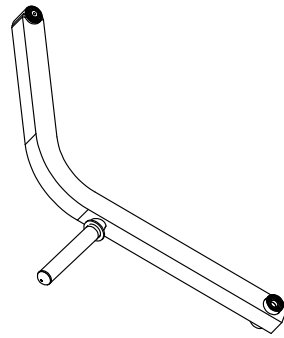

G [1PCS]

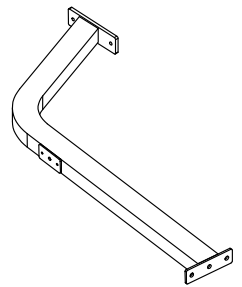

H [1PCS]

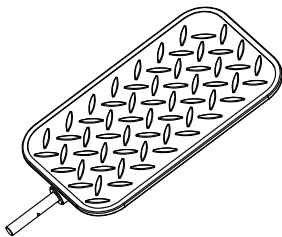

I [1PCS]

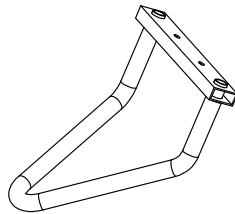

J [1PCS]

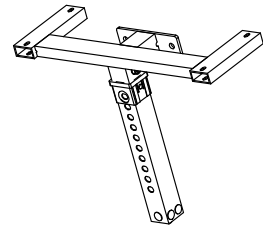

P [1PCS]
(9313-074)

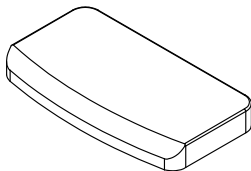

N [1PCS]
(8323-150)

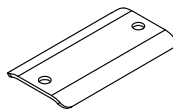

K [1PCS]

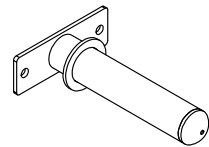

O [1PCS]
(8312-091)

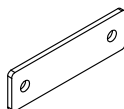

L [1PCS]
(8313-250)

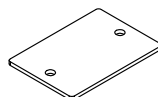

M [1PCS]
(8313-235)

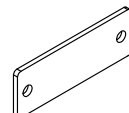

PLHE PARTS

D1. End Closure (8130-248)	2PCS
D2. Ø50 End Cap (9211-020)	2PCS
D3. Nylon Bushing (9211-009)	6PCS
D4. Rubber Dount (9310-016)	2PCS
D5. Nylon Washers(9214-001)	1PCS
D6. End Cover (9211-049)	1PCS
D7. End Cover (9211-197)	1PCS
D8. Rubber Insert (9310-075)	2PCS
D10. Iron Cover (8130-507)	2PCS
D11. Gas Spring (8830-043)(Pre-installed)	1PCS
D12. Iron Cover (8530-010)(Pre-installed).....	2PCS
D13. Pinch Cock (OC-06).....	1PCS
D14. Fenders (9310-077)	1PCS
D15. End Cover (9211-016)	2PCS
D16. Pop Pin(8250-065G)(Pre-installed)	1PCS
D17. Nylon Bushing (9211-033)(Pre-installed)	1PCS
D18. Snap Fastener (9211-036)(Pre-installed).....	6PCS
D19. Shaft Core(8220-332)(Pre-installed).....	1PCS
D20. The Bearing (8510-037)(Pre-installed)	4PCS
D21. Rubber Insert (9310-067)(Pre-installed)	1PCS
D22. Iron Cover (8130-253)	1PCS

D1



D2



D3

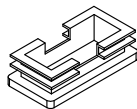

D4

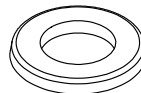

D5



D6

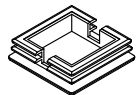

D7

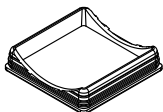

D8

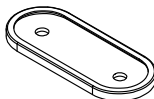

D10



D11

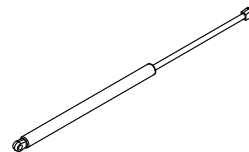

D12



D13

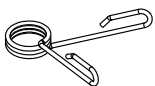

D14

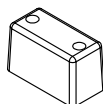

D15



D16

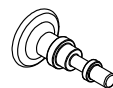

D17

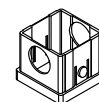

D18



D19

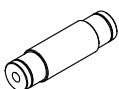

D20



D21

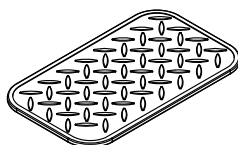

D22



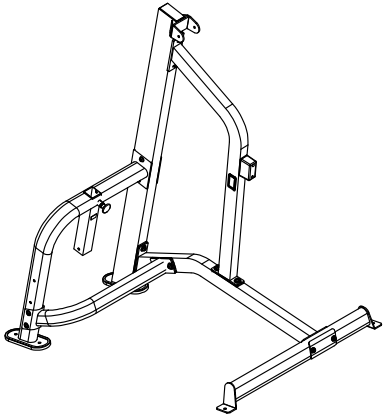

Above shows STEP 1 assembled and completed

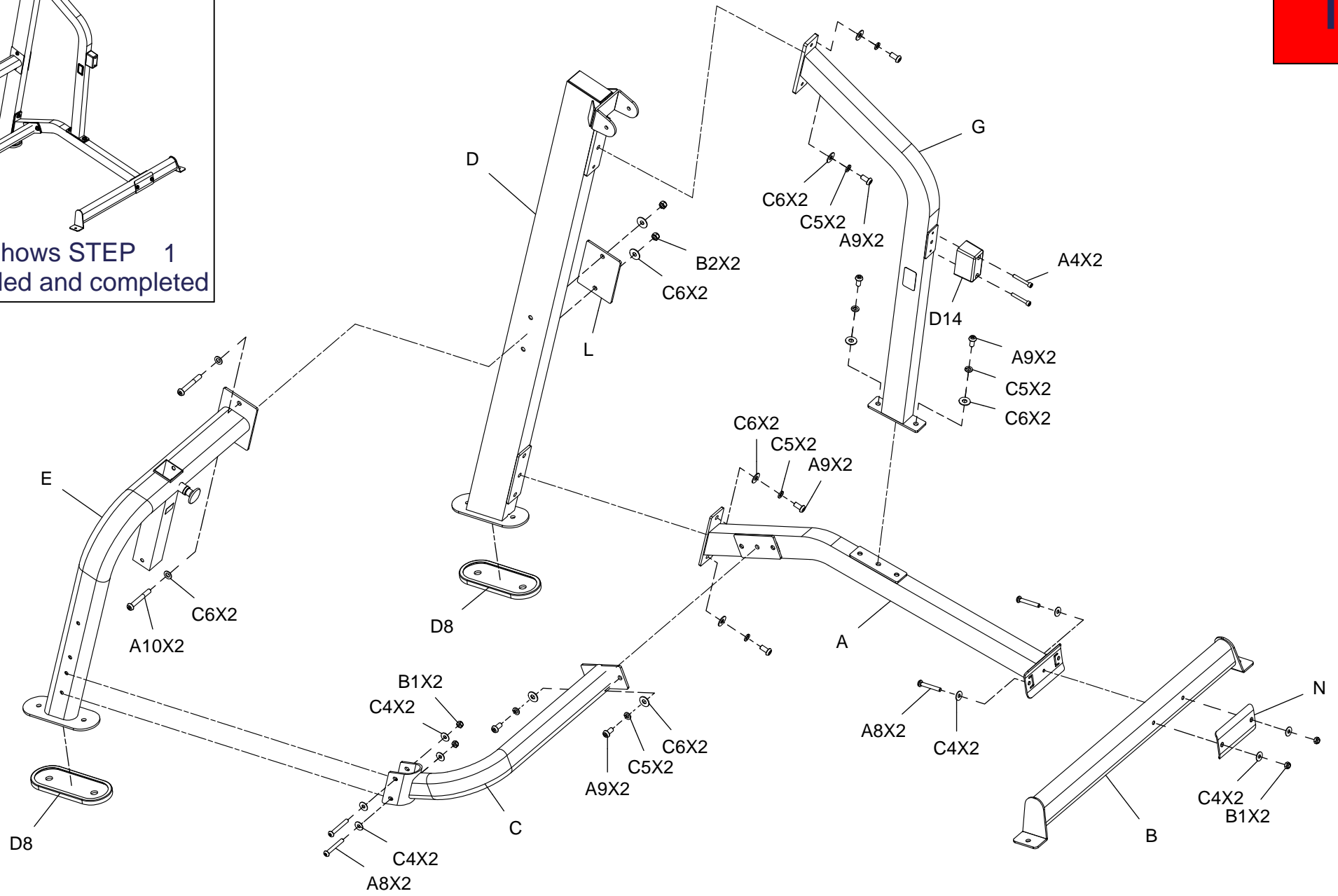

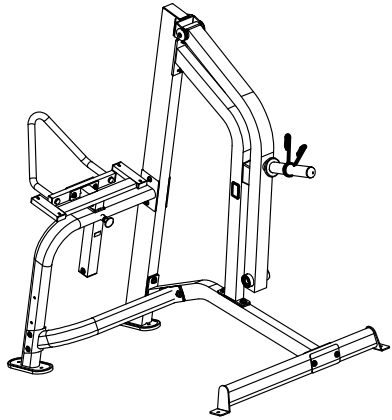

Above shows STEP 2 assembled and completed

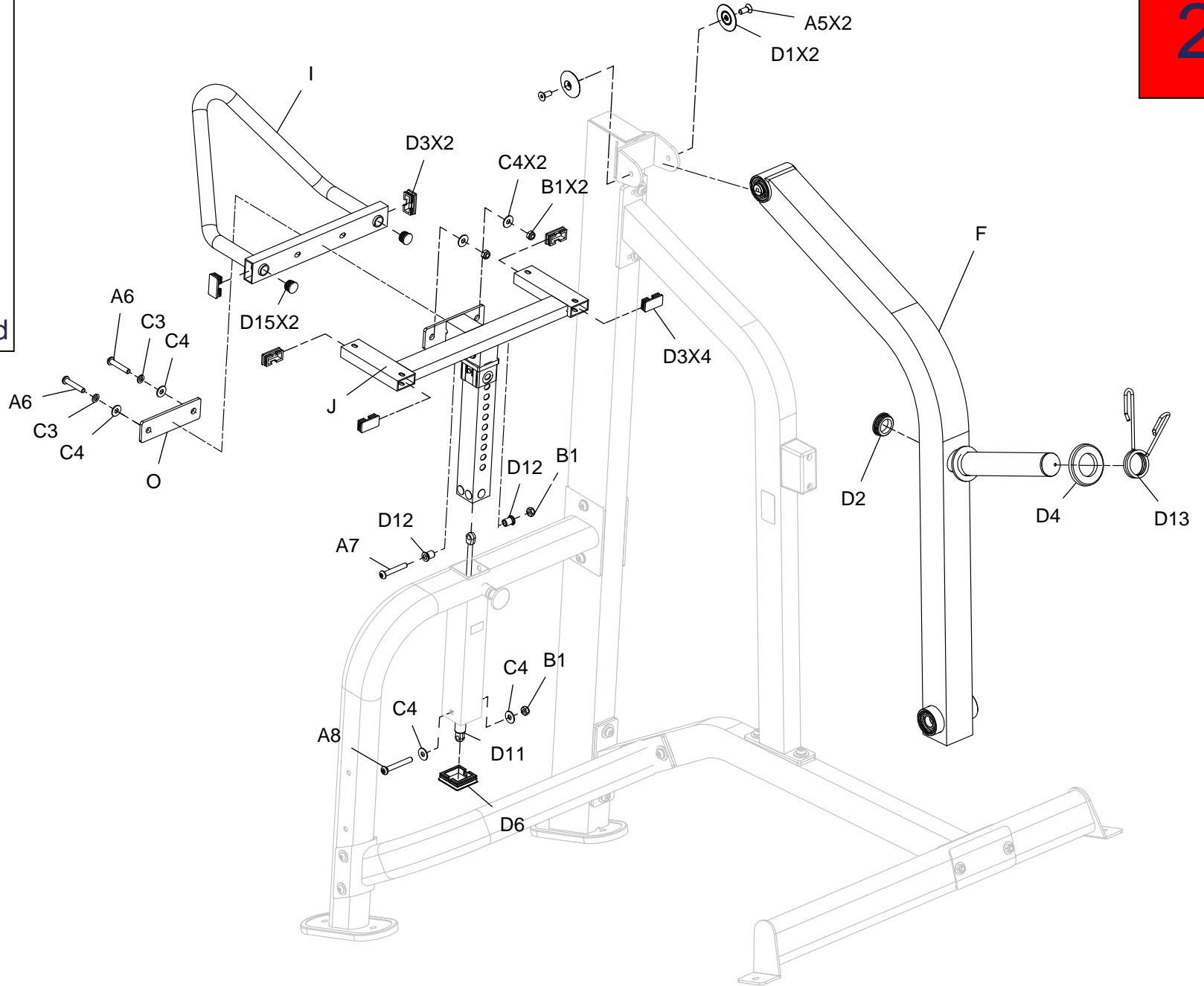

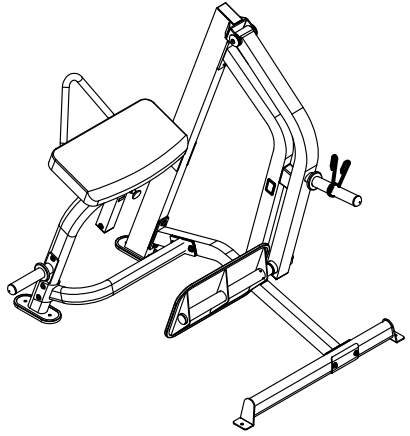

Above shows STEP 3 assembled and completed

