

# Hurom™

## HP Series

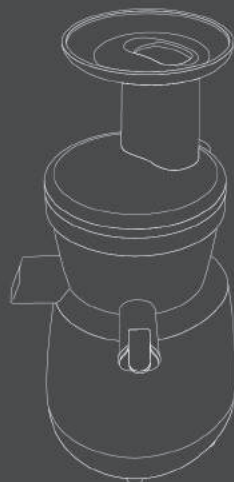

**02**

Important  
Safeguards

**03**

Cautions during  
operation

**04**

Precautions for safe  
use

**06**

Terms for parts

**07**

How to trim the  
ingredients

**08**

How to assemble

**10**

Disassemble and  
cleaning

**11**

How to use

**12**

Juice Cap

**13**

When Squeezing  
Screw stops during  
operation

**14**

Before requesting for  
repair

**16**

Product  
Specifications /  
Warranty

### **Hurom Juicer Household Use (Warranty Included)**

1. Read 'Important Safeguards' (Page 2) and use the appliance properly.
2. After finish reading the manual, keep it in a convenient location for future reference.
3. Do not use it abroad which has different power supply and voltage.
4. Any quality improvements are subject to change without notice.

# IMPORTANT SAFEGUARDS



## Cautions during operation

1. WHEN USING ELECTRICAL APPLIANCES, BASIC SAFETY PRECAUTIONS SHOULD ALWAYS BE FOLLOWED. READ ALL INSTRUCTIONS.
2. TO PROTECT AGAINST RISK OF ELECTRICAL SHOCK, DO NOT PUT THE MAIN BODY (MOTOR) IN WATER OR ANY OTHER LIQUID.
3. CLOSE SUPERVISION IS NECESSARY WHEN ANY APPLIANCE IS USED NEAR CHILDREN.
4. UNPLUG FROM OUTLET WHEN NOT IN USE, BEFORE ASSEMBLING OR TAKING OFF PARTS AND BEFORE CLEANING.
5. AVOID CONTACT WITH MOVING PARTS.
6. DO NOT OPERATE ANY APPLIANCE WITH A DAMAGED CORD OR PLUG, OR AFTER THE APPLIANCE MALFUNCTIONS, OR IS DROPPED OR DAMAGED IN ANY MANNER. RETURN APPLIANCE TO THE NEAREST AUTHORIZED SERVICE FACILITY FOR EXAMINATION, REPAIR OR ELECTRICAL OR MECHANICAL ADJUSTMENT.
7. THE USE OF ATTACHMENTS NOT RECOMMENDED OR SOLD BY THE MANUFACTURER MAY CAUSE FIRE, ELECTRIC SHOCK OR INJURY.
8. DO NOT LET CORD HANG OVER EDGE OF TABLE OR COUNTER.
9. ALWAYS MAKE SURE HOPPER IS SECURELY FASTENED IN PLACE BEFORE MOTOR IS TURNED ON. DO NOT UNFASTEN HOPPER WHILE JUICER IS IN OPERATION.
10. BE SURE TO TURN SWITCH TO OFF POSITION AFTER EACH USE OF YOUR JUICER. MAKE SURE THE MOTOR STOPS COMPLETELY BEFORE DISASSEMBLING.
11. DO NOT PUT YOUR FINGERS OR OTHER OBJECTS INTO THE JUICER WHILE IT IS IN OPERATION. IF FOOD BECOMES LODGED IN OPENING, USE FOOD PUSHER OR ANOTHER PIECE OF FRUIT OR VEGETABLE TO PUSH IT DOWN. WHEN THIS METHOD IS NOT POSSIBLE, TURN THE MOTOR OFF AND DISASSEMBLE JUICER TO REMOVE THE REMAINING FOOD.
12. DO NOT USE OUTDOORS.
13. DO NOT PLACE ON OR NEAR A HOT GAS OR ELECTRIC BURNER OR IN A HEATED OVEN.
14. DO NOT USE APPLIANCE FOR OTHER THAN INTENDED USE.

### ● Ingredients which needs caution

- Fruits with hard seeds such as persimmon, Japanese apricot, lemon, plum, peach etc. that are hard to chew with our teeth should be taken out before extraction.

- For stalk vegetables with strong fiber such as water parsleys, celery etc. should be cut into small size about 3~4cm before putting into the hopper chute.

- Do not put in sesame, coffee beans, bark of the tree, Chinese pepper, etc. which cannot be extracted.

- Do not put in fruits preserved in alcohol, sugar, honey, etc. (grapes, apricot, berries, etc) and enzymes (glasswort, houseleek, etc.). It may cause damage or failure.

● We recommend you to drink green vegetable juice and fruit juice immediately after extraction rather than keeping them for long time.

● You may use for crushing spice (garlic, red pepper), but not for grinding grain.  
It may cause damage or failure.

● Do not re-squeeze residues expelled through the pulp outlet.  
Soft fruits can be re-squeezed.

● Do not operate the appliance before putting in the ingredients.

● Do not use the appliance for more than 20 minutes continuously.  
- It may cause a failure due to overheating of the motor.  
When using continuously, stop it and give it 5 minutes of interval and then you may use it again.

● Never insert finger, fork or spoon etc. into juice outlet during the operation.  
- Inserting such as chopsticks etc. into Juice outlet during operation may cause them to stuck into the spinning brush and cause damage to the parts.

● Do not press the ingredients with anything except the pusher.  
- It may be stuck in the screw and cause injury and failure.

● Do not operate the switch with wet hands.  
- It may cause electric shock or fire. Do not put foreign objects near the switch.

● When you extract over 300ml at once, please open the control lever every 300ml to emit the pulp.  
- The hopper can't be opened or it may cause damage when the pressure in the chamber increases.

### Note

Frozen fruit or withered ingredients that have been stored in the refrigerator for a long time may give us less extracted amount or may even be impossible.

# SAVE THESE INSTRUCTIONS





## Precautions for safe use

1. You should read <Precautions for safe use>
2. You should follow <Precautions for safe use>
3. Precautions are classified as following.



**Warning** When violating the labeling requirement, it may cause serious injury or death.

- **DO NOT PLUG OR UNPLUG WITH WET HANDS.** It may cause electric shock or injury.
- **DO NOT USE OTHER THAN 120 V AC.** It may cause electric shock, fire or product failure. If the voltage is different, it may shorten the life of the motor or cause a failure.
- **PLUG THE POWER CORD CORRECTLY AND PUSH IT TIGHT IN A WALL SOCKET.** It may cause an electric shock or a fire.
- **IF THE SUPPLY CORD IS DAMAGED, IT MUST BE REPLACED BY THE MANUFACTURER OF ITS SERVICE OR SIMILARLY QUALIFIED PERSONS IN ORDER TO AVOID A HAZARD.** If the power cord is damaged, it may cause electric shock or fire.
- **NEVER ALTER THE APPLIANCE. ALSO, DO NOT DISASSEMBLE OR REPAIR THE PRODUCT BY YOURSELF. DO NOT INSERT FINGERS, FOREIGN SUBSTANCES OR OBJECTS SUCH AS PINS INTO GAPS OR HOLES IN THE BODY.** It may cause a fire, electric shock or product failure. For any technical support, contact the authorized local Customer Service Center.
- **WHEN THE POWER CORD, WIRE IS BROKEN OR DAMAGED, OR THE PLUG-IN PART BECOME LOOSE, DO NOT OPERATE IT.** It may cause electric shock, fire or injury.
- **DO NOT MOISTEN BODY OR SPLASH WATER ON THE BASE.** Be careful not to let any liquids or other substances get into the switch of the appliance.  
**DO NOT OPERATE THE SWITCH WITH WET HANDS.** It may cause an electric shock or fire.
- **FOR SAFETY, MUST DO GROUNDING CONNECTION. ALSO, DO NOT DO THE GROUNDING ON GAS PIPE, PLASTIC WATER PIPE, TELEPHONE WIRE, ETC.** It could cause electric shock, fire, malfunction or explosion. Be sure to use the electrical outlet with ground connection.
- **NEVER DISASSEMBLE THE CHAMBER SET DURING OPERATION OR INSERT FINGERS, FOREIGN OBJECTS SUCH AS FORKS, SPOONS, ETC. INTO HOPPER CHUTE OR JUICE OUTLET.** It may cause injury, accident or product failure.
- **APPLIANCES CAN BE USED BY PERSONS WITH REDUCED PHYSICAL, SENSORY OR MENTAL CAPABILITIES OR LACK OF EXPERIENCE AND KNOWLEDGE IF THEY HAVE BEEN GIVEN SUPERVISION OR INSTRUCTION CONCERNING USE OF THE APPLIANCE IN A SAFE WAY AND IF THEY UNDERSTAND THE HAZARDS INVOLVED. CHILDREN SHALL NOT PLAY WITH THE APPLIANCE. CLEANING AND USER MAINTENANCE SHALL NOT BE MADE BY CHILDREN. THIS APPLIANCE SHALL NOT BE USED BY CHILDREN. KEEP THE APPLIANCE AND ITS CORD AWAY FROM CHILDREN.**



**Caution** When violating the labeling requirement, it may cause serious injury or damage to the appliance.

- **DO NOT OPERATE WITHOUT LOCKING THE HOPPER PROPERLY.** It may cause an injury or a failure.

- **WHEN A GAS LEAK IS DETECTED, DO NOT INSERT THE POWER CORD INTO ITS SLOT. OPEN THE WINDOW IMMEDIATELY FOR AIR VENTILATION.** It may cause injury or failure.
- **NEVER PUT A FINGER, FORK OR SPOON, ETC. INTO JUICE OUTLET.** It may cause injury or failure.
- **IF SQUEEZING SCREW ROTATION IS STOPPED DURING NORMAL OPERATION, PRESS [REV] BUTTON AND HOLD FOR 3~5 SECONDS AND AFTER REVERSE OPERATION IS COMPLETELY STOPPED, PRESS [ON] BUTTON AGAIN.** If stopping continues during the operation, the parts may be damaged and performance may be deteriorated due to overheating in a motor. When the problem continues, stop the appliance immediately and contact the local Customer Service Center.
- **DURING THE OPERATION, DO NOT ATTEMPT TO MOVE THE BASE, DISASSEMBLE THE CHAMBER SET OR PARTS AND TRY TO LOCK THEM.** It may cause an injury or a failure. If any act of event needed, switch off first and unplug the power cord.
- **WHEN USING THE APPLIANCE, BE CAREFUL WITH A NECKTIE, LONG NECKLACE, SCARF, ETC. TO NOT BE ENTANGLED INTO HOPPER CHUTE.** It may cause injury, failure or breakage.
- **PLACE THE APPLIANCE ON A FLAT AND STABLE SURFACE.** It may cause injury or failure.
- **DO NOT OPERATE THE APPLIANCE FOR MORE THAN 20 MINUTES AT A TIME.** It may cause a motor failure due to overheating. Cool it down sufficiently about 5 minutes and operate it again.
- **WHEN PLACING INGREDIENTS INTO THE HOPPER CHUTE, USE ONLY THE PUSHER PROVIDED.** It may cause injury or failure.
- **DO NOT ALLOW A SEVERE SHOCK TO THE APPLIANCE OR DROP IT.** It may cause electric shock, fire or damage.
- **IF THE APPLIANCE GIVES OFF AN UNPLEASANT SMELL, EXCESSIVE HEATING, OR SMOKE, STOP USING IMMEDIATELY AND CONTACT THE LOCAL CUSTOMER SERVICE CENTER.** When using a new appliance, it gives off a smell and the smell disappears naturally over time.
- **ALWAYS UNPLUG THE APPLIANCE AFTER USE. ALWAYS DISCONNECT THE APPLIANCE FROM THE SUPPLY IF IT IS LEFT UNATTENDED AND BEFORE ASSEMBLING, DISASSEMBLING OR CLEANING. WHEN UNPLUGGING THE POWER CORD, MAKE SURE TO HOLD THE POWER CORD.** Pulling the wire to unplug may cause electric shock or fire.
- **DO NOT WASH AT HIGH TEMPERATURES OF 80°C(176°F) OR HIGHER. DO NOT PUT THE APPLIANCE IN A DISHWASHER, DRYER OR A MICROWAVE ETC.** It may cause a failure or parts deformation.
- **THE APPLIANCE WEIGHS ABOUT 4.4kg (9.7lb). WHEN MOVING THE APPLIANCE, ENSURE TO MOVE IT HOLDING GRIPS TIGHTLY AT THE BOTTOM OF BODY WITH BOTH HANDS.** By attempting to hold chamber or the edge of the body, the body may fall causing an injury or failure.



## Terms for parts

### 1 Hopper



### 2 Squeezing Screw



### 3 Strainer



### 4 Spinning Brush

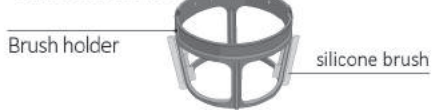

### 5 Chamber

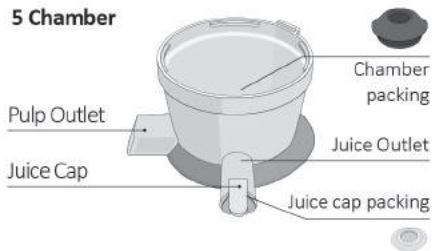

### 6 Body

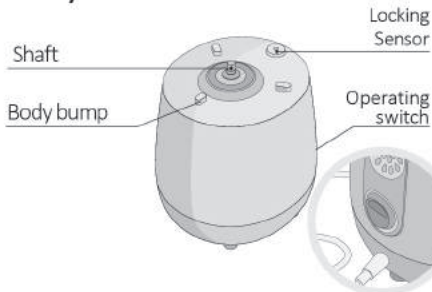

### 7 Pusher



### 8 Pulp Container



### 9 Juice Container



### 10 Cleaning Brush



### 11 Small Cleaning Brush



### <REAR>

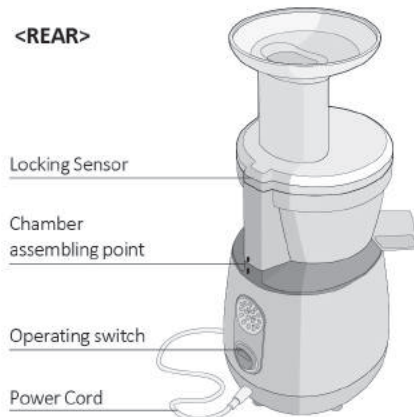

## How to trim the ingredients!

### ● Apple, pear, kiwi, oriental melon

- Juice fruits like apple, pear, kiwi, oriental melon, etc. put them with seeds and peels. However, apple seeds contain toxicity, so it better to remove them.

### ● Pomegranate, grapes

- Separate each grape from the cluster. Peel the pomegranate and use flesh only.

### ● Watermelon, orange, grapefruit

- Peel off the skin of watermelon, orange, grapefruit and cut them into right size.

### ● Mango, cherry, peach

- Fruits like mango, cherry, peach, or plum, etc. have hard seeds which are hard to swallow. Those seeds might cause stoppage or parts damage, so they must be removed before using it.

### ● Wheat, chives

- Put a handful of wheat or chives in not to be scattered.

### ● Water parsleys, angelica, celery, kale

- Cut fibrous ingredients into small sized less than 3 cm.

\* This is a reference about how to trim the ingredients, so if you have allergy please choose your own proper ingredients which agrees with you.

\* Please refer to the recipe book for the product usage of each ingredient.

# How to assemble

**1** Assemble the strainer under the groove of spinning brush just like from the picture.  
If they are not completely assembled, the chamber set will not be closed.

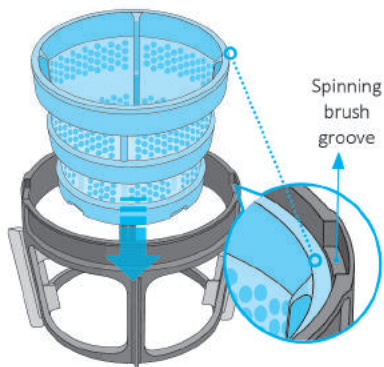

\* If the strainer is not placed below the groove, the hopper will not be locked.

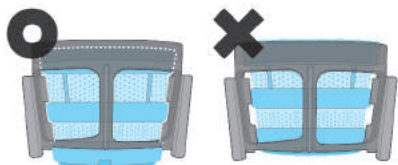
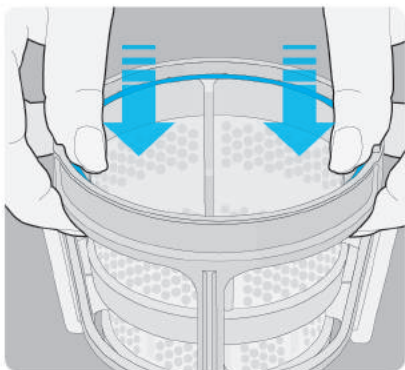

**2** Put the assembled part in proper place by moving left and right in the chamber just like the picture no.1.

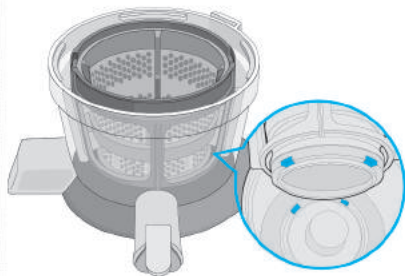
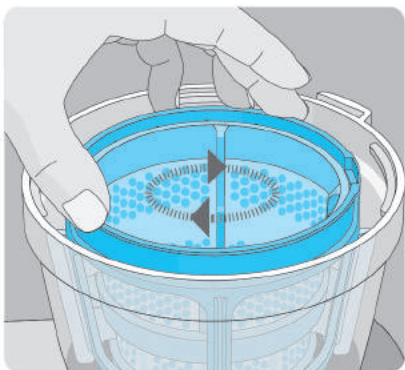
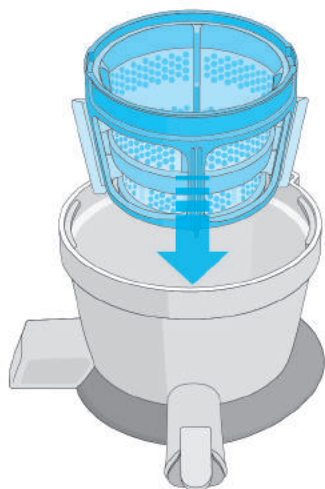

**3** Assemble the squeezing screw like the picture.  
Put the auger by turning it to fit in the spinning brush grooves.

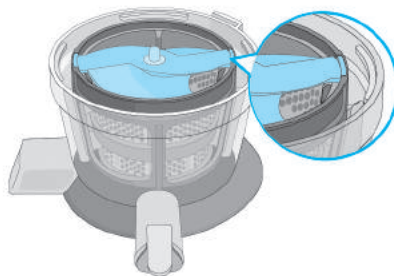
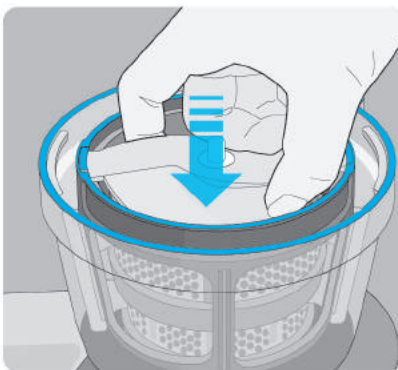
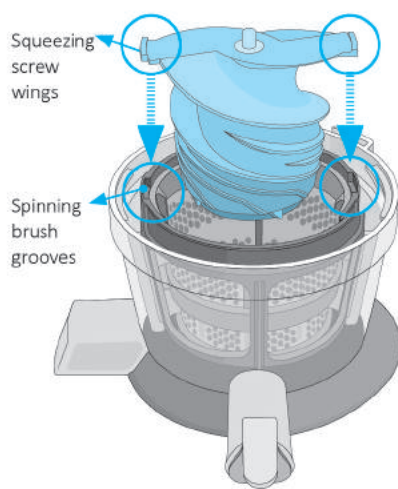

**4** After putting the hopper on the chamber, turn it clockwise until it is locked completely.

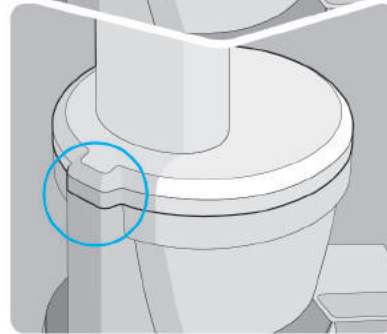
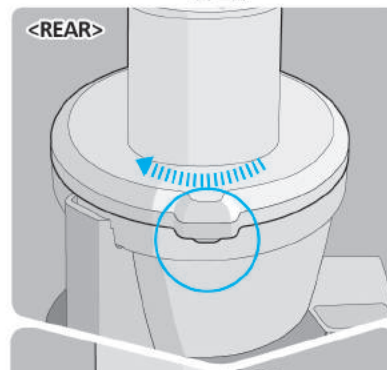

**5** Mount the chamber set on the body.  
Align the mark on the back of the body to the mark on the chamber set for correct assembly.

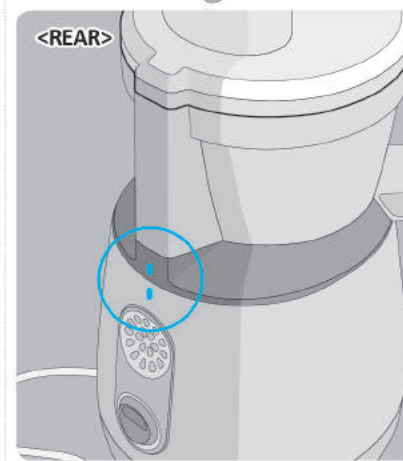
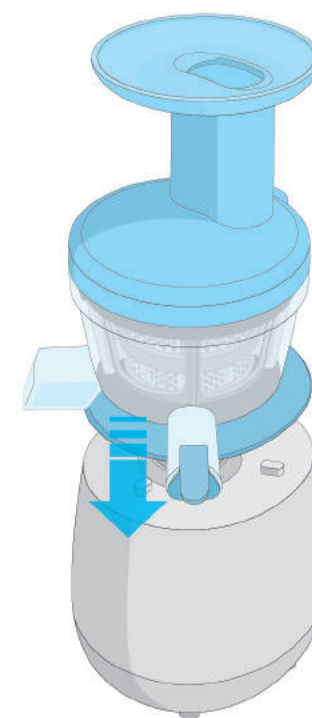



## Cleaning for parts

1. Unplug the power cord with dry hands after the unit has been completely stopped.
2. Remove the chamber set from the main body. Twist the chamber cover to open and lift up the parts in order to disassemble the unit.
3. Use a cleaning brush and wash the chamber set under running water.
4. Wipe the main body with a damp towel or a soft cloth.
5. The silicone packing can be disassembled and washed. (Including juice cap packing, chamber packing, silicone brush)
6. Soak in water diluted with one or two drops of baking soda or natural bleach for dishes for about 30 minutes to sterilize and clean.

### NOTE

1. If the unit is not cleaned immediately after use, a residue may dry and stick to the unit. This will make disassembling and cleaning difficult as well as lead to performance degradation.
2. Do not wash with hot or boiling water, an iron scrubber, abrasive material, sink solvents, or sharp cleaning tools. Do not put it in a dishwasher or dish dryer. After washing, thoroughly and naturally dry, and store in a clean area.

## Juice Cap Packing

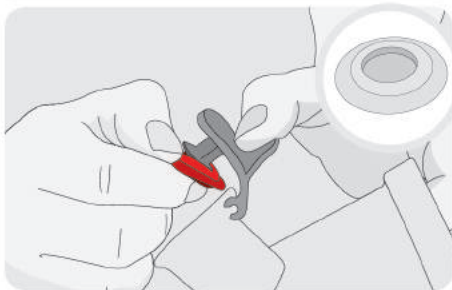

Open the juice cap, hold the chamber and juice cap with one hand, and remove the juice cap packing with your other hand to disassemble.

Please be careful not to drop or damage the juice cap and chamber when disassembling the unit.

## Chamber Packing

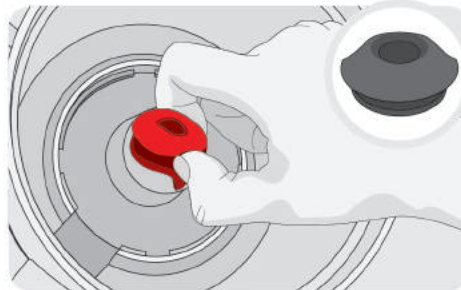

Grab the chamber packing in the chamber shaft with both hands, and lift up to remove.

Identify the upper and lower part of the chamber packing and assemble. (Refer to image)

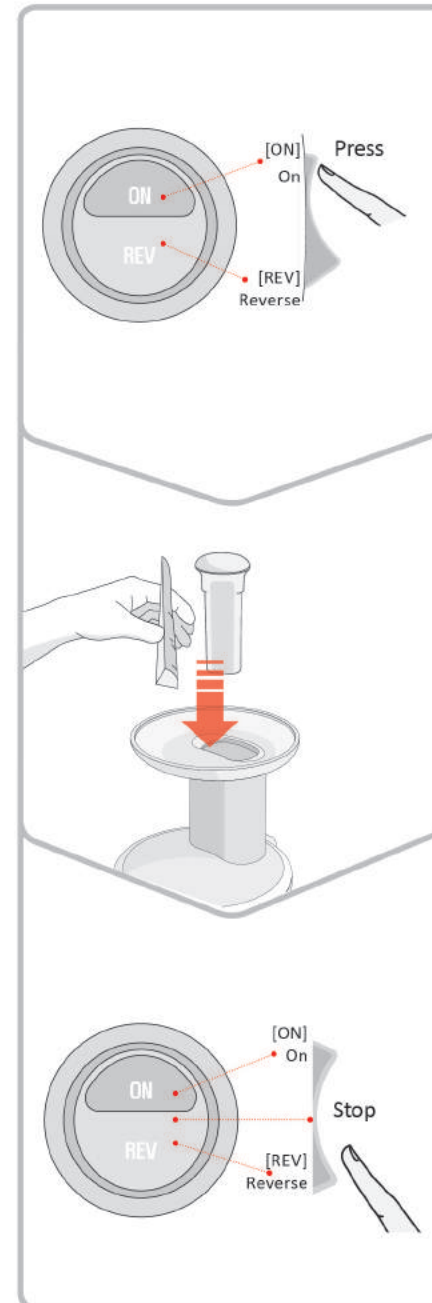
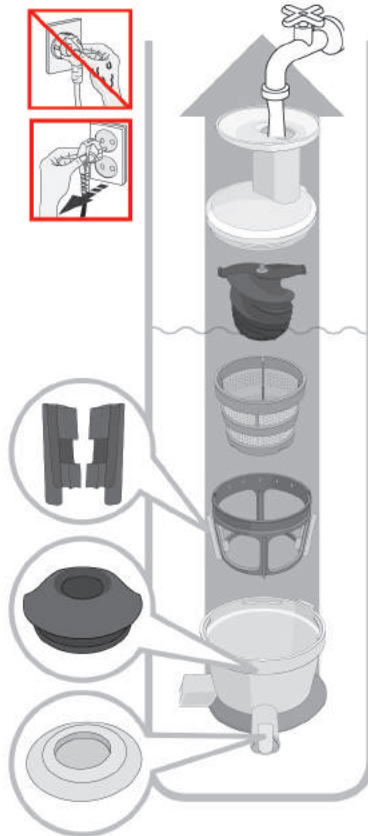

## 1 Press [ON] button to start.

\*For your safety, this unit only works when it's correctly assembled with the chamber set.

## 2 Put ingredients gradually in the hopper chute and press with the pusher.

\*Do not press the ingredients with anything except the pusher provided. Please put the ingredients as 3~4cm sizes.

\*When you use the icecream strainer, the juice can be out through outlet and it is normal operation.

\*When you extract over 300ml at once, please open the control lever every 300ml to emit the pulp.

## 3 After extraction is completed, place the switch in stop position to stop.

When using [ON] or [REV] button, make sure that the auger stops completely.

## Juice Cap

### Juice Cap

This is the cap of juice outlet from the chamber. If you close the juice cap and fill up the juice in the chamber, you can easily make mixed fruit juice or vegetable juice with various ingredients.

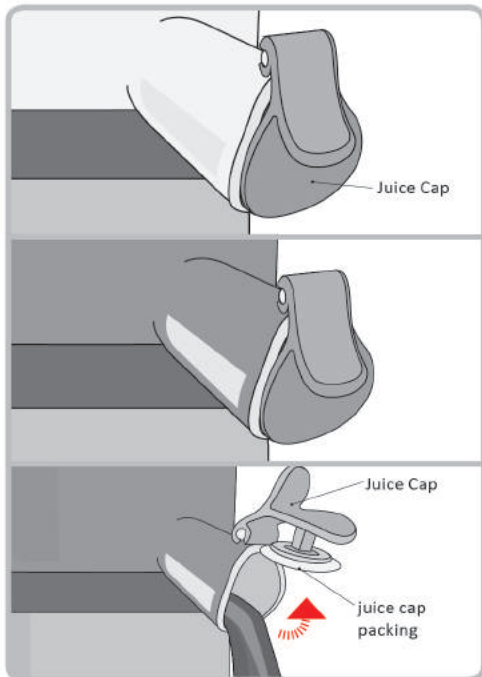

**1** Close the juice cap and press [ON] button to start.

**2** When juice starts filling up the bowl, you can mix beans, boiled sweet potato, banana, nuts etc. and liquid such as milk, etc. as well as vegetables and fruits

**3** Open the juice cap to pour as much as you need and you can close it without any drops.

### Extraction Seal

It is the pulp stopper made of silicone at the bottom of the chamber. Make sure to close the extraction seal always as shown below before use. For cleaning, open the extraction seal and start washing.

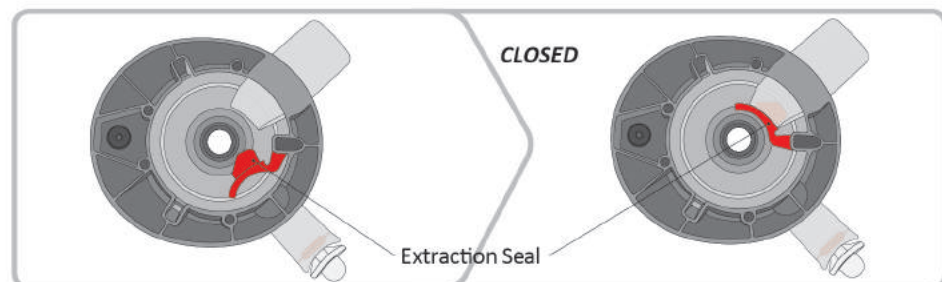

## When the squeezing screw stops during the operation

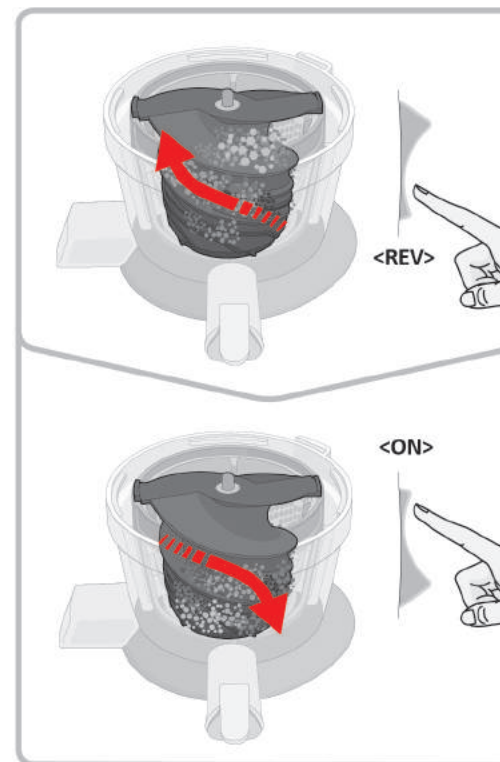

**1** Press [REV] button on the operating switch for about 3~5 seconds and stop it. Repeat this 2~3 times.

[REV] is the button to push back the ingredients upward.

[REV] only works while pressing the button, and the rotation of the squeezing screw stops if you release the button.

**2** Press [ON] button to operate after reverse operation is completely stopped.

When using [ON] or [REV] button, make sure that the squeezing screw stops completely.

### Note

Even after following the directions above and still doesn't work, please unplug the power cord and disassemble chamber set, and clean it. And try it again.

### Caution when using operation button

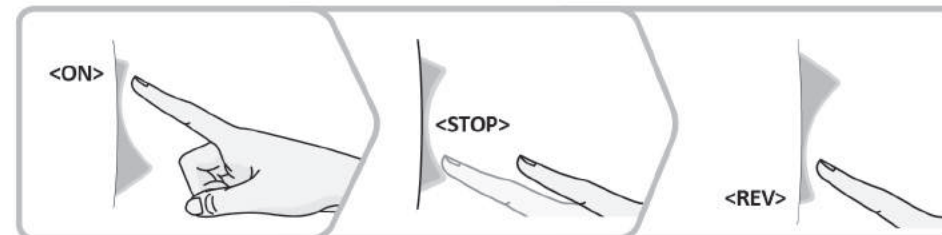

### NOTE

In case of reversing during operation, press [REV] button short, then press [REV] button for operation.

With the feature of the product, even though you stop the operation, it doesn't stop right away. It rotates slowly then stops. If the rotation stops completely, you may press the button to any direction you want. (Same as when pressing [ON] during reverse operation)



## Please check the details below before contacting Technical Support for repair.

If you need additional information, please contact your local Customer Service Center or visit [www.hurom.com](http://www.hurom.com).  
When applying for after-sales service, please have the manufacturer's serial number or bar code available.



### 1. The main body itself will not work.

For your safety, this unit only works when it's correctly assembled with the chamber set.

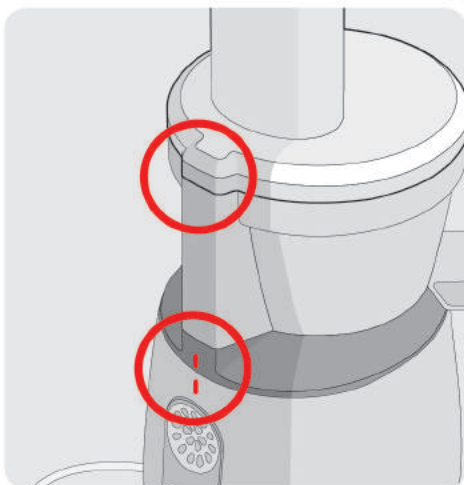

### 2. Please assemble according to the safety sensor.

For your safety, this unit only works when it's correctly assembled.

### 3. The Appliance does not work.

#### Make sure that the power cord is properly plugged in.

Check if the hopper is assembled properly.

If the hopper has not been locked into place, the appliance will not operate for safety reasons.

Check if the appliance is assembled according to the directions in the manual.

Refer to instructions for assembly in the manual or consult with your Customer Service Center for additional assistance.

### 4. The appliance stops during normal operation.

#### Have you in heavy loads or large pieces of ingredients into the appliance?

Refer to page 13 of the manual and follow the guideline for using [REV] button.

If the issue is not resolved after following the above process, please contact your local Customer Service Center.

### 5. There are fine lines or scratch marks around the squeezing screw.

These are molding marks resulting from the normal manufacturing process.

This is a normal product and there is no problem for use.



### 6. Do not insert too many ingredients at once.

If you insert an excessive amount of ingredients or thick ingredients, the unit may stop.



### 7. Do not use in ways other than pressing on the pusher in the inlet.

It may cause damage, injury, etc.

### 8. Juice leaks over the body.

#### Have you inserted a lot of ingredients into the hopper chute?

If you insert a large amount of ingredients compared to the pulp outlet, the packing is slightly pushed away, so the juice leaks out of the gap. Do not put too much ingredients by force and just put gradually for extraction.

### 9. The hopper does not open.

#### There might be a lot of residues inside.

Put the lever in half-closed position, and press [ON] button to release residues. Press [REV] button for 3~5 seconds and stop it. Repeat this process 2~3times.

#### Have you placed any foreign substances or solid objects (hard seed such as persimmon seed) in the juicer?

Press [REV] button and push the ingredients back up toward the hopper chute.

Do not attempt to open by force. Please contact your local Customer Service Center for assistance.

### 10. The Chamber shakes when squeezing.

#### Slight shaking may be caused by the motor.

Depending on the texture of the ingredient, there may be slight to more pronounced shaking of This is a normal phenomenon as auger rotates and it is not a malfunction. Hard ingredients (e.g carrot, potato, radish, beet, etc.) may cause more shaking than soft ingredients.



## Product Specifications

● <b>Product Name</b>	Hurom Slow Juicer	● <b>Cord Length</b>	1.4 m
● <b>Model Name</b>	HP Series	● <b>Motor</b>	Single-phase induction motor
● <b>Rated Voltage</b>	120 V	● <b>Fuse</b>	250 V 8 A
● <b>Rated Frequency</b>	60 Hz	● <b>Weight</b>	4.4 kg (9.7 lb)
● <b>Rated Power Consumption</b>	150 W	● <b>Outward Dimension</b>	Width 192 mm Length 176 mm Height 399 mm
● <b>RPM</b>	43 rpm	● <b>Rated Operating Hour</b>	Less than 20 minutes

## Warranty

● <b>Product name</b>	● <b>Customer name</b>	● <b>Model name</b>
● <b>Supplier</b>	● <b>Date of purchase</b>	
● <b>Address</b>	● <b>Manufacture's serial number</b>	

Important: For better protection of your purchase, fill out and mail this form to a local distributor where you purchased the appliance and keep the original receipt.

This certifies that the Hurom Slow juicer is covered under warranty by **HUROM** to be free from defects in material construction and workmanship.

Hurom provides warranty for ten (10) years for the motor and two (2) years for other parts from the date of purchase by the original purchaser. Coverage is valid only with proof of purchase from an Authorized Local Distributor. (No international warranty available)

This warranty does not apply to damages caused by accident, misuse, abuse, commercial use, alteration, failure to follow operating instructions, or damage caused by parts or service unauthorized by **HUROM**. Damages caused by transportation must be claimed with carrier. **HUROM** disclaims all responsibilities for consequential damages from incidental losses caused by use of this appliance.

Please check the bottom of your Hurom product for a sticker with a barcode. This barcode sticker helps verify a genuine Hurom product and identify the product manufacturing date. Hurom's manufacturer's warranty does not cover products with missing or damaged barcode stickers. Products are to be inspected upon receipt.

For service and assistance with technical difficulty, please contact our local customer service center.

**HUROM** Manufacture : **HUROM**  
Hurom webpage : [www.hurom.com](http://www.hurom.com)