

Exterior Weatherproof Classic Noticeboard

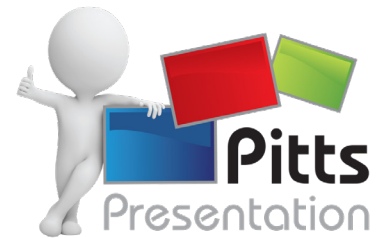

**Classic and discreet, the ideal noticeboard for public buildings and corporate offices.
Safe, secure, waterproof & lockable**

- A 58mm profile and internal clearance 42.2mm
- Portrait door for smaller sizes. Larger formats (18xA4 and 21xA4 sheets) use raising doors suspended on gas struts for easy opening and support - landscape format
- 4mm Plexichoc® vandal-resistant glazing
- Waterproof elastomer seal
- Tamperproof safety lock supplied with 2 keys, 2 locks at a height of 1350mm in height and all raising door models.
- Galvanised steel background in a white lacquered finish for use with magnets
- Full Display - 100% of the display surface visible (lock mounted on the door not the glazing)
- Hinge -free - Wear-resistant, warp-proof integrated hinge.
- Aluminium Frame in silver anodised or painted in RAL colours (bordeaux 3004, green 6005, blue 5010, brown 8017, black 9005). Also available in any RAL colour at an additional cost. Contact us for details.
- Rear painted grey RAL 7032
- Magnets supplied (1 per A4)
- 5 Year Guarantee
- All wall mounted noticeboards have predrilled holes in the back for easy fixing to the wall. No fixings supplied
- All noticeboards are maintenance free, and we would suggest the best way of cleaning the noticeboards is with a cloth and water only
- Wall or post mounting - post mounting kits available. Plus a choice of optional accessories: decorative header boards, LED lighting kits, additional magnets - contact us for details .



Code	No. of A4 sheets	Window size	External Dimensions	Door Type
506000	4	653x453mm	H 750 x 550mm	Portrait
506001	6	653x653mm	H 750 x 750mm	Portrait
506080	8	733x883mm	H 830 x 980mm	Portrait
506002	9	953x653mm	H 1050 x 750mm	Portrait
506003	12	1253x653mm	H 1350 x 750mm	Portrait
506004	16	1253x903mm	H 1350 x 1000mm	Portrait
506081	18	983x1233mm	H 1081 x 1330mm	Raising
506082	21	1033x1503mm	H 1130 x 1600mm	Raising

*replace first 5 with a 4 for painted frame e.g. 506000 becomes 406000

Post kit:

- 60mmx40mm post kit
- black top cap
- attached to the rear of the noticeboard using brushed stainless steel brackets
- contains 2 posts and 4 mounting brackets
- to be embedded into a concrete base (total height of the posts is 2600mm).

PLUS post kit also available: 1 post and 2 central brushed stainless steel mounting brackets for 2-noticeboard mounted on posts. Contact us for details

Materials and standards:

Aluminium profile: EN AW 6060 - BS EN 573-3.

Anodised profiles undergo electro-chemical treatment resulting in a 15 µ thick protective surface coating of aluminium oxide. Painted profiles are powder coated using polyester powder to 60µ then oven-baked at 180-200°C. All paint finishes are UV treated to ensure that the original colour is not lost over time.

Plexichoc glazing: transparent organic UV blocking glazing material with good shock resistance ISO 7032-2.

Security glass: tempered glass BS EN 12150-1.

Aluminium posts: EN AW 6106, EN AW 6060 and EN AW 6063 - EN 755-2, providing high mechanical strength.

Lighting kits: All the notice boards can accommodate a lighting kit, comprising 2 LED strips (one for the top & one for the bottom) with a transformer to be installed outside the notice boards. Please be aware that the LED ribbons & transformer are not factory fitted and require installation by a qualified electrician. Illuminated poster display cases and light boxes comply with European directive CE/73/23 and BS EN 60-598.



60 x 40 root fixing post sets for Tradition & Classic notice boards

Anodised posts: codes 516356 / 516358 - Painted posts: codes 416356 / 416358

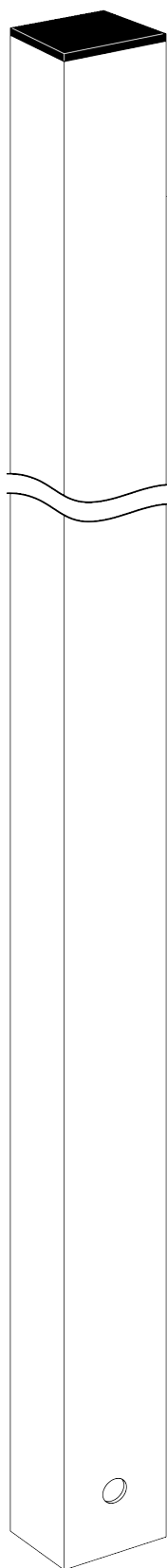

G (x2)
60x40



A (x2)
ACC 522050.02

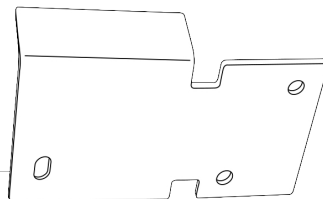

B (x2)
ACC 522050.01

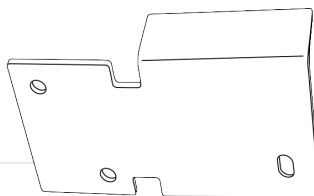

C (x8)
5.5x22
ACC 22033

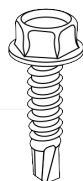

D (x4)
FHC M6 x 16
ACC 22234

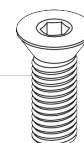

E (x4)
Hfr M6
ACC 05019



F (x4)
ø18
ACC 18097



H (x4)
M 6
ACC 18084

