

Modular Closets Installation Guide

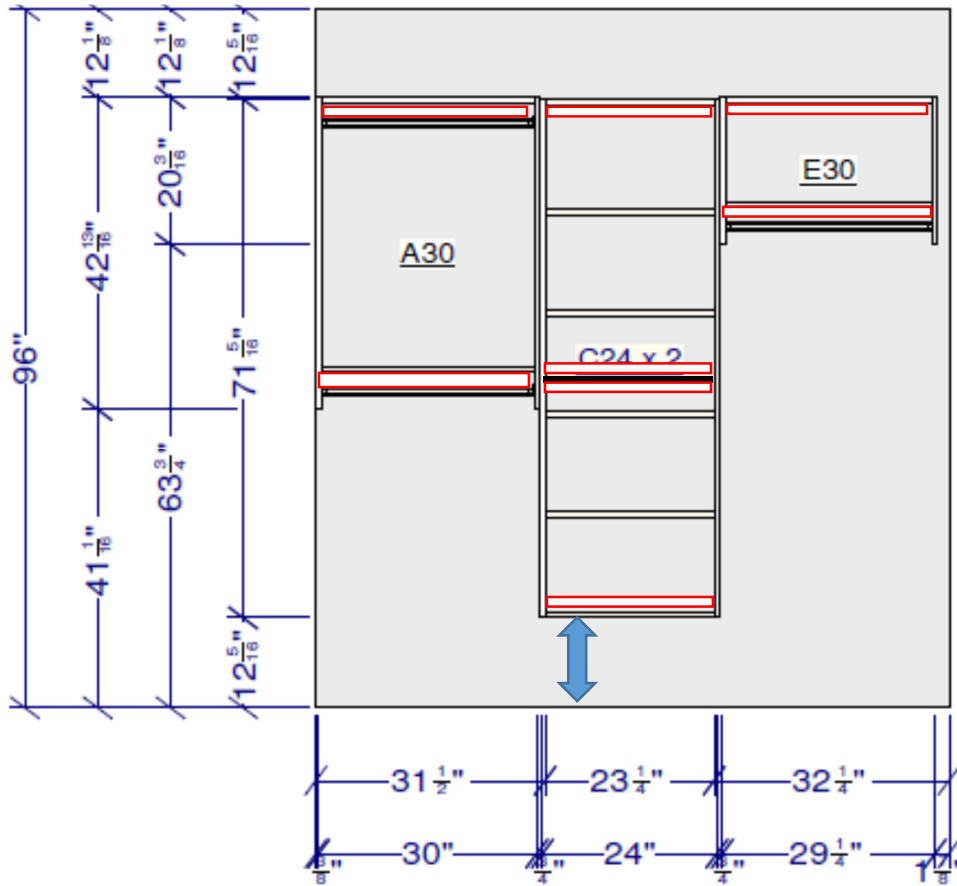

Installation Notes

- ** Each Section is installed to the wall through the rear hanging rails
- ** Bottom sections are generally lifted off the ground 12"
- ** The height of the top of the closets are generally 84" from the floor.



**** Measurements shown are approximate and for illustration purposes only.**

- ### Installation Steps
- Locate space in which section will be installed
 - Find and mark location of each beam to insure secure install
 - If space allows, begin install with the center sections first working your way out
 - On a closet that has tight space, begin install from the outer section first so that you will have room to work with.
 - On full shelving or Drawer/shelf units, the Shelf Units are mounted on top of each other or on top of a Drawer Unit, insert the dowels into the pre-drilled holes so that both sections are perfectly aligned up
 - Using 2 1/2" screws mount each section through the rear ranging rails into the wall and beam
 - You can connect the sections together from the sides using 1" – 1 1/4" screw if needed.