

Everest Elite



Crystal Mountain
www.crystalcoolers.com

Everest Elite

Inspired by the award winning Everest model, Crystal Mountain introduces the stunning Everest Elite. Innovative design features include: removable side panels, double mechanical float, and raised faucet handles. Its sleek design and upscale look is perfect for either home or office environments. Crystal Mountain proves that anything is possible when there is a drive to reach new heights!



Point of Use Dispenser



Sturdy Metal
Faucet Handles



Removable
Reservoir / Faucet Assembly



Features

- Modern, sleek and stylish design
- Ergonomic faucet height
- Removable Reservoir/faucet assembly
- Energy Star Certified
- Easily removable ABS side panels
- Maintenance friendly
- Integrated spring loaded cup dispenser (9 oz flat bottom)



Point of Use system

Features a primary float with a secondary backup in conjunction with a 1/4" quick connect fitting with cover to protect the fitting and tubing. Easily adaptable, the double mechanical float system installs easily onto the coolers.

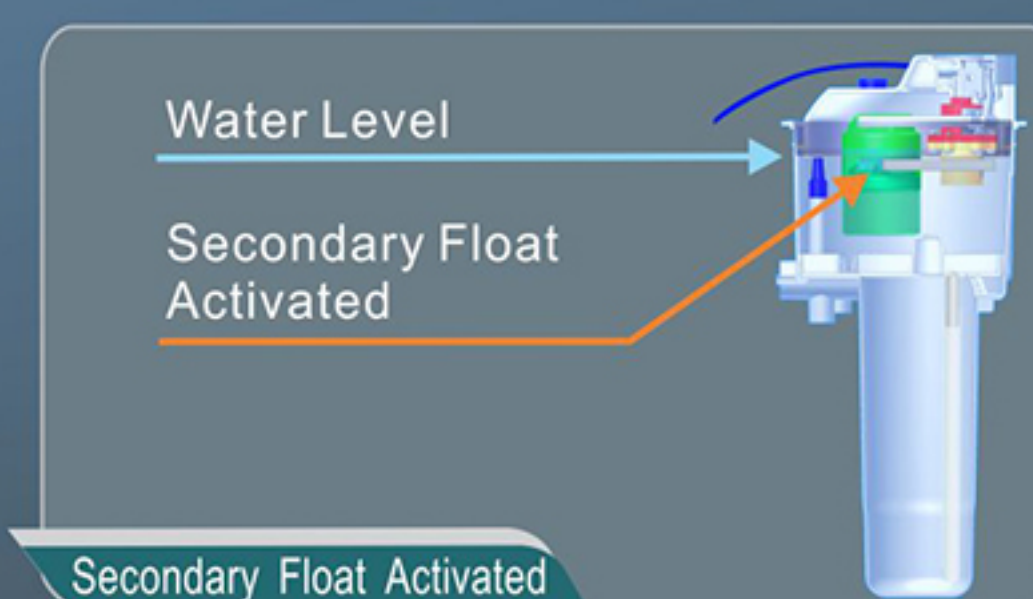
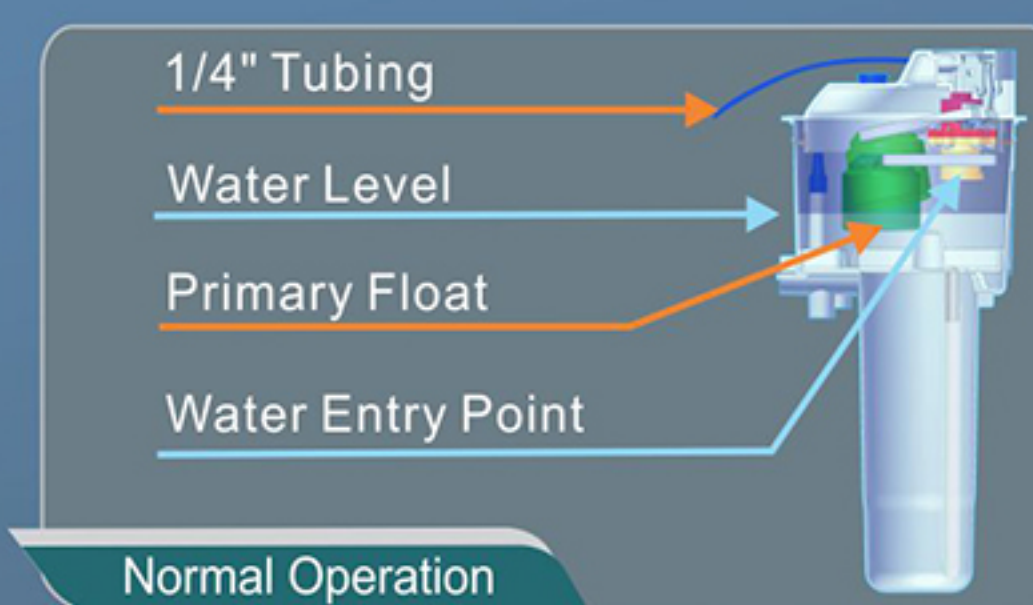
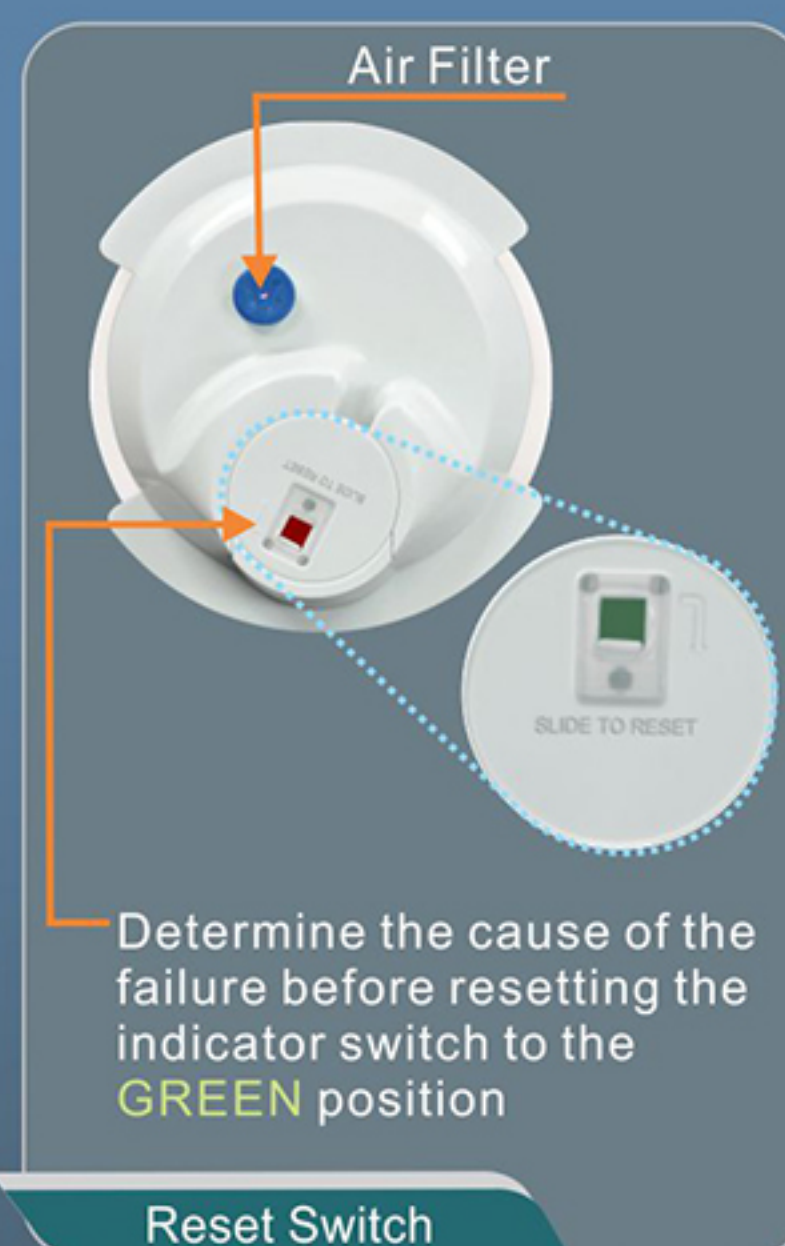

Everest Elite

Performance and Specifications

General

An air-cooled water dispenser with a compressor-driven refrigeration system and a removable reservoir for sanitizing
Available in hot and cold

Cooler Cabinet

Plastic outer panels use Higher gloss ABS. Chrome Strip
Standard color - black with chrome accent
Other colors may be available in high volume orders

Faucet Type

Mechanically operated self closing faucet made of food grade approved plastics (polypropylene and silicone)
Childproof safety faucet handle and button. LED Nightlight

Cold Water Tank Specifications

PP casing with 2.4 L (0.6 gal) volume
Cold water cooling capacity of 1.5 L (0.4 gal)/hour based on 21°C (69.8°F) room temperature

Cold Water Thermostat

Preset at factory to dispense water at temperatures from 4-10°C (39.2 - 50°F)
Adjustable cold control located at back of cabinet

Hot Water Tank

Stainless steel #304 casing with 1.1 L (0.3 gal) volume
Hot water capacity of 5.0 L (1.3 gal)/hour based on 21°C (69.8°F) room temperature
New: Sealed Bi-Metal (Auto Cutout)

Hot Water Thermostat and Heaters

Automatic thermostat set at temperature range of 74-92°C (165.2-197.6°F)
Manual thermostat reset in case of automatic thermostat failure
ON/OFF switch is located at back of cabinet
New: Silicone Reset Cover

Compressor

Hermetically sealed reciprocating compressor
(220-240VAC 50Hz) (100-115VAC 60Hz)

Noise (Sound Power Level): 44dB

Refrigerant Type: R134a

Refrigerant Charge: 30.0g (1.1 oz)

Dimensions and Freight Data

| Model Number | Products Dimensions WxDxH (mm/in.) | Box Dimensions WxDxH (mm/in.) | Product Weight (kg/lb) | Product Boxed Weight (kg/lb) | Loading Qty. | |
|--|---------------------------------------|----------------------------------|------------------------|---------------------------------|--------------|-----------|
| | | | H&C | H&C | 20FT | 40FT |
| Everest Elite POU water cooler without cup dispenser | 319x310x1058mm | 290x285x1080mm | 12.7 kg | 14.0 kg | 320 units | 640 units |
| | 12.5"x12.1"x41.7" | 11.4"x11.2"x42.6" | 28.0 lb | 30.9 lb | | |
| Everest Elite POU water cooler with cup dispenser | 319x327x1058mm | 290x285x1080mm | 13.1 kg | 14.4 kg | 320 units | 640 units |
| | 12.5"x12.9"x41.7" | 11.4"x11.2"x42.6" | 28.9 lb | 31.8 lb | | |

All performances are tested in a controlled environment, certified by a third party. To learn more about these standards, please speak to your Crystal Mountain representative.





Everest Elite



Website: www.crystalcoolers.com

Crystal Mountain Products Limited

North American Sales Office

11925 - 145th Street
Edmonton, Alberta
Canada T5L 2H4
Tel: 1 800 878 6422
Tel: 1 780 454 4545
Fax: 1 780 454 9816
E-mail: sales@crystalcoolers.com

European Sales Office

Fence House, Fence Avenue
Macclesfield, Cheshire
United Kingdom SK10 1LT
Tel: +44(0) 1625 439 111
Fax: +44 (0) 1625 502 527
E-mail: cmeurope@crystalcoolers.com

Crystal Mountain Products Inc.

US Office / Warehouse

5905 Green Pointe Drive S., Suites C-D
Groveport, OH, 43125
Tel: (614) 454 1618
Fax: (614) 409 9782
E-mail: sales@crystalcoolers.com

Crystal Mountain International Limited

Hong Kong Sales Office

Room 610, Winfield Commercial Building
6-8a Prat Avenue, Tsimshatsui
Kowloon, Hong Kong
Tel: (852) 2368 1989
Fax: (852) 3017 6727
E-mail: cmasia@crystalcoolers.com

crystalcoolers.com

Crystal Mountain has a policy of continuous development and reserves the right to change specifications without notification.