

# Yousky

✉ :service@yousky.com

🌐 :www.yousky.com

☎ :800-727-0838



@yousky



Warranty Register

# Yousky

## Handheld Pool Vacuum

### User Manual

✉ :service@yousky.com

🌐 :www.yousky.com

☎ :800-727-0838



Warranty Register



# Customer Service

For questions, comments or success stories on how the Yousky Rechargeable Handheld Pool Vacuum is working for you, please contact us.

**Email: [service@yousky.com](mailto:service@yousky.com)**

**Tel: 800-727-0838**

# Warranty

Designs and warrants its products with the intent that they are free of defects in manufacture and workmanship for a period of One (1) Year from the date of original purchase, under normal use and service. However, repair or replacement under warranty does not lead to any extension or renewal of the warranty period.

**Please activate your warranty within 15 DAYS of purchasing of your item by send email to [service@yousky.com](mailto:service@yousky.com) or click [www.yousky.com/warranty](http://www.yousky.com/warranty).**



Warranty Register

# Contents

Warnings .....	2
Package List .....	3
Installation & Operation Instruction .....	4
Charging & Maintenance And Storage .....	5
Trouble Shooting .....	6
Customer Service & warranty .....	7

# WARNINGS

1. Read carefully and understand all safety warnings before using this appliance.
2. Do not attempt to operate if the cleaner or charger appear to be damaged in any way.
3. All cautions and warnings on the equipment should be noted.
4. Never allow children to operate this product. This is NOT a toy. Children should be supervised to ensure they do not play with this product.
5. Keep the cleaner and its accessories out of reach of children.
6. This cleaner is not intended for use by persons with reduced physical, sensory or mental capabilities, or lack of experience and knowledge, unless they have been given supervision or instruction concerning the use of the appliance by a person responsible for their safety.
7. Do not use or store the charger outdoors. Charge your cleaner in a clean, dry place and only with the charger provided. Do not use a charger supplied with any other appliance.
8. The warnings, cautions, and instruction discussed in this instruction manual cannot cover all possible conditions or situations that could occur. It must be understood, the operator should always exercise intensive caution and common sense when utilizing the cleaner.
9. Do not plug or unplug charger into a power source or the appliance with wet hands.
10. Do not operate this cleaner in the presence of flammable or combustible liquids.
11. Never service the cleaner while the unit is on or connected to the charger.
12. Installation work and electrical wiring must be done by qualified person(s) in accordance with all applicable codes and standards, including fire-rated construction.
13. Use only the charger supplied with the cleaner. Never carry the charger by its cord or disconnect it from an outlet by pulling on the cord.
14. For pluggable equipment, the socket-outlet shall be installed near the equipment and shall be easily accessible.
15. Keep proper footing and balance at all times when using the cleaner. Do not overreach.
16. Please disconnect this equipment from AC outlet before cleaning. Don't use liquid or sprayed detergent for cleaning. Use moisture sheet or cloth for cleaning.

# Maintenance and Storage

1. Turn off the vacuum before cleaning, servicing and maintenance. Regularly check all components for sign of damage. Discard and replace damaged components immediately.
2. Using the installation instructions in reverse, disassemble the vacuum. Clean all the components with water, and make sure all components are thoroughly dry before storage.
3. Store the product and accessories in a dry, temperature controlled, between 0° - 40°C (32° - 104°F) storage location.
4. The original packing can be used for storage.

# Charging Instruction

TROUBLE	SOLUTION
VACUUM DOESN'T WORK	<ul style="list-style-type: none"><li>• Charge the product then turn on the unit. Ensure that the device's power button is pressed.</li><li>• Keep the vacuum body under the water.</li></ul>
LOW SUCTION	<ul style="list-style-type: none"><li>• Choose the suitable bag for filtering and install the filter bag(s) correctly.</li><li>• Check and empty the filter bag(s) regularly during and after each use.</li><li>• Check for any sand or deposits in the vacuum.</li><li>• Contact customer Service Center.</li></ul>
CHARGING FAILED	<ul style="list-style-type: none"><li>• Check the plug charger has an output voltage of 12.6v 1A</li><li>• Connect the charger into the main electrical outlet, and then connect the small end of the cable into the vacuum body charging receptacle.</li><li>• Plug in the cable tightly, the indicator light should be on.</li></ul>

# Operation Instruction

1. Firstly, press the switch to start the Handheld Pool Vacuum, and then place the vacuum in the water. See Figure 6

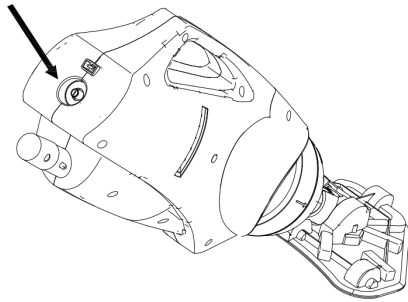
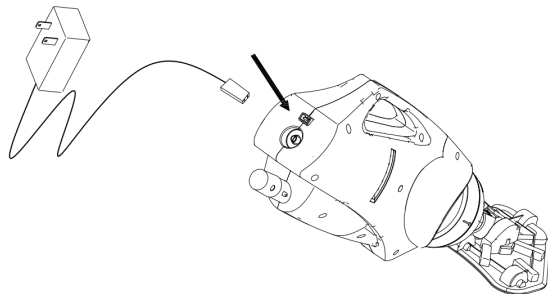

Fig 6

2. Carefully "sweep" the surface of the spa or pool to remove debris.
  3. Check and empty the filter bag/micro-filter bag regularly during and after each use.
  4. Reverse the above installation steps to remove and empty the filter bag/micro-filter bag.
- Note: Rinse vacuum body, cover and filter bags with a garden hose before reassembling.

# Charging Instruction

1. Connect the charger into the main electrical outlet
2. Connect the small end of the cable (7) into the vacuum body (1) charging receptacle. See fig 1. The indicator light will turn on. After being fully charged, the adapter indicator light turns green
3. Charger Port is 100% Waterproof



17. This cleaner contains rechargeable batteries. Do not incinerate the battery as it will explode at high temperatures. Always dispose of batteries in accordance with local law.

18. Leaks from a battery may occur under extreme conditions. If battery liquid gets on the skin, wash immediately with water. If it gets in your eyes, immediately flush your eyes with a mild solution of baking soda and water, and seek medical attention.

19. Keep hair, loose fitting clothing and all body parts away from openings and moving parts of this cleaner.

20. Use this product only for its intended purpose as described in this manual.

21. If the equipment is not in use for long time, disconnect the equipment from mains to avoid being damaged by transient over-voltage.

22. Never leave your cleaner in water when it is "OFF" or when it has run out of power.

23. Do not use your cleaner for pool openings; the cleaner is designed for routine maintenance of your pool or spa.

24. Submerge the cleaner in water immediately after turning the unit "ON" to prevent damage to the seal on the motor shaft. Failure to do so will shorten the life of the water seal and / or void the warranty.

25. Avoid picking up sharp objects as they may damage the filter. Keep all openings on the cleaner free of debris which may reduce water flow.

26. Do not place the cleaner or charger on or near hot surfaces.

27. For best results use the charger in locations where temperatures are between 50° F / 10° C and 100° F / 37.7° C.

# Packing List

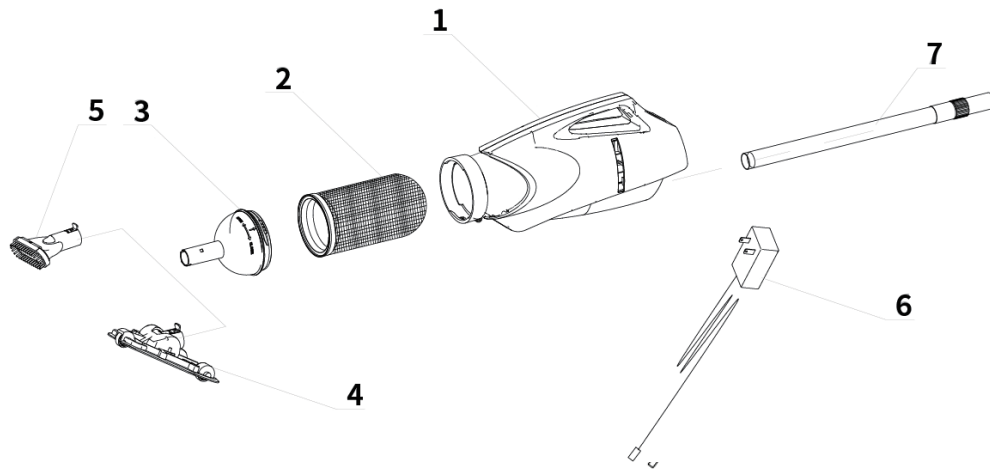

Note: Drawing for illustration purpose only. May not reflect actual product. Not to scale.

REF. No.	DESCRIPTION	QTY
1	VACUUM BODY WITH NON-REPLACEABLE BATTERY	1
2	FILTER BAG WITH GASKET	2
3	VACUUM BODY COVER	1
4	LARGE VACUUM BRUSH HEAD	1
5	VACUUM NOZZLE BRUSH	1
6	VACUUM CHARGING CABLE	1
7	TELESCOPING ALUMINUM POLE	1

# Installation Instruction

1. Insert the filter bag with gasket (2) into the vacuum body, see fig 1;
2. Install the vacuum body cover (3) onto the vacuum body (1). Turn the cover (3) clockwise to securely lock it to the vacuum body. See fig 2;

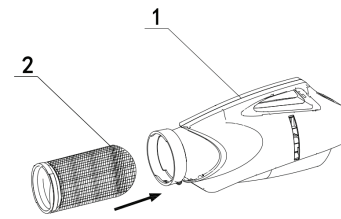

Fig 1

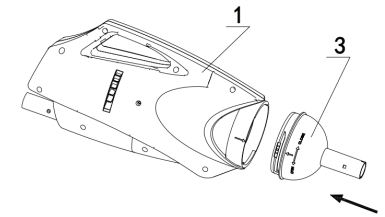

Fig 2

3. Attach the desired cleaning head accessory to the vacuum body cover. See fig 3. and 4.  
Note: The ridge on the vacuum body cover (3) matches the groove on the end of the vacuum brush head (4) or vacuum nozzle (5)

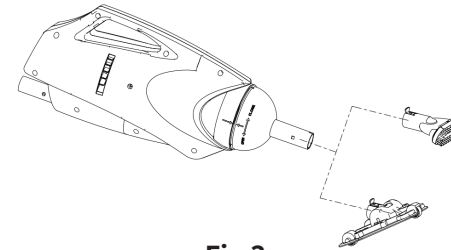

Fig 3

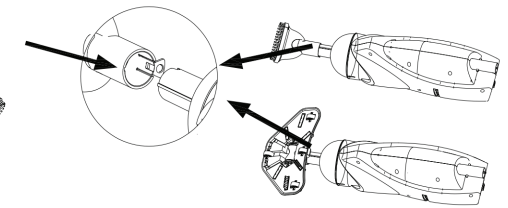

Fig 4

4. Attach the aluminum pole (9) by squeezing the spring buttons and inserting into handle of the vacuum body (1). Check the buttons “pop” into the holes. Adjust the length of the shaft by unlocking, extending and locking each section accordingly. See fig 5.

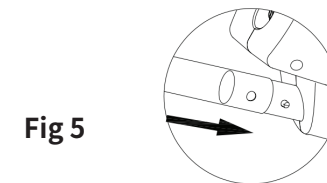

Fig 5

