

3050

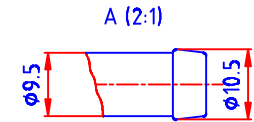
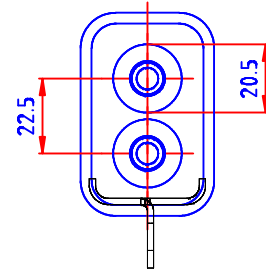
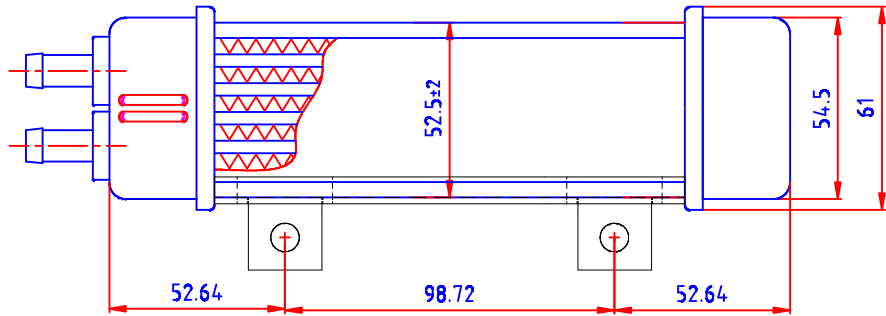
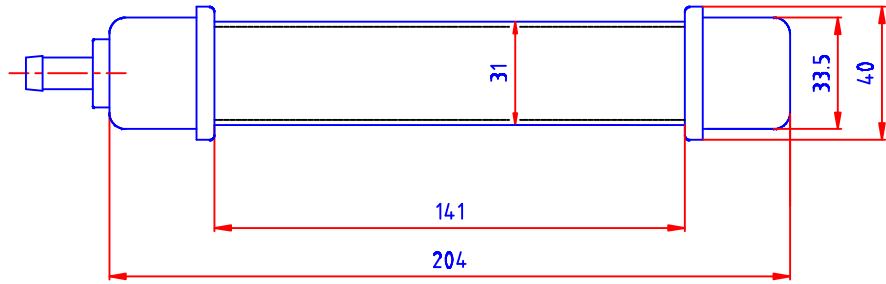

TOLERANCE CLASS: ISO 2768-v  
 PERMISSIBLE DEVIATIONS FOR  
 LINEAR DIMENSIONS EXCEPT FOR  
 BROKEN EDGES. (mm)

0.5 up to 3	over 3 up to 6	over 6 up to 30	over 30 up to 120	over 120 up to 400	over 400 up to 1000
-	±0.5	±1	±1.5	±2.5	±4

WEIGHT	C/4											
VOLUME											Al	
WORKING PRESSURE	5 bar		DRAWN	DATE/ESH	POB NO	QTY	DESCRIPTION	MATERIAL	OPERATION	REMARKS		
MAX PRESSURE	10 bar		073107	MCB								
TEST PRESSURE	4 bar		APPROVAL	DATE/ESH	ALL REQUIREMENTS REFER TO UNPAINTED OBJECT				TOLERANCES UNLESS NOT SPECIFIED			
BURST PRESSURE			ENGINEER		DESCRIPTION				14 ISLM-6 P03/8 2P			
TEST ACC TO			QUALITY		OILCOOLER				ISO2768-v			
PART	powdercoated		PROG						REPLACES			
PART THICKNESS			LOGISTICS						REPLACES BY			
CONNECTION MAX TIGHTENING TORQUE			CUSTOMER	JAGG					CONNECTED DRAWING			
COUNTERACTING SPANNER MUST BE USED WHEN TIGHTENING CONNECTIONS					Setrab				DRAWING NO			
					3050				SCALE			
					E				SINGLE			

Setrab  
 OILCOOLERS

3050