

clarity®



TL200 TV Listener

WHAT'S IN THE BOX?



TL200 headset



TL200 transmitter



power adapter and
cord (2 sets)



RCA stereo Cable
(for option 1)



headphone cable
(for option 2)

Your new Clarity TL200 TV Listener is ready to provide high quality television sound. Setup is easy and should take just a couple of minutes.

BASIC SETUP

STEP 1 Before connecting power to the transmitter, connect the transmitter to your TV, cable box, or satellite box, by choosing one of the two options below.

Option 1 (recommended, if available): Plug the red and white ends of the RCA stereo cable from the transmitter into the corresponding red and white **audio output** jacks on the back of your TV **or** on the back of your cable or satellite box. This allows you to adjust the headset volume while others can adjust the volume of the television speakers.

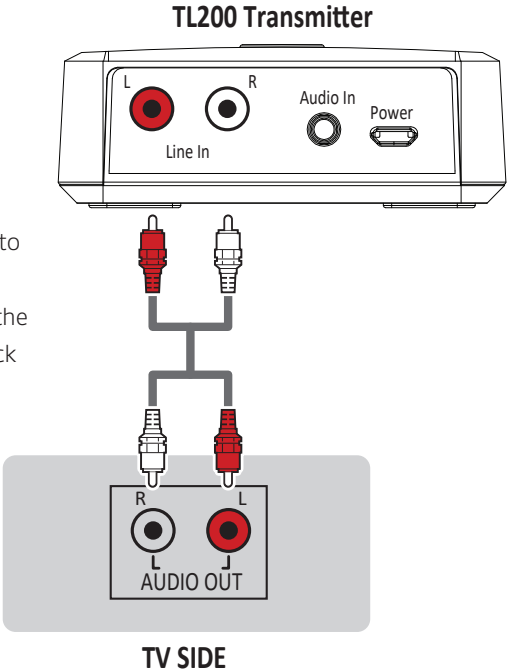

STEP 1 (continued)

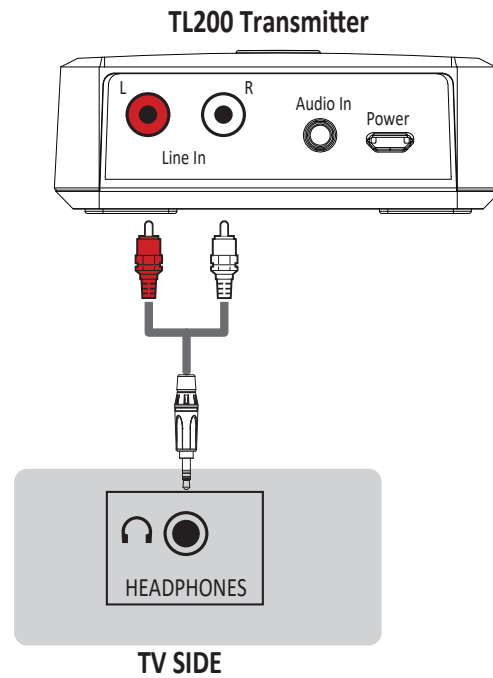

Option 2: Plug the headphone cable into the headphone jack on your TV. On most televisions, this disables the television's speakers, so this option is not ideal for multiple viewers. Check the settings on your TV for available functionality.

Note: this also works with computers.

STEP 2 Plug one of the supplied power adapters into a power outlet, then plug the loose end of the power cable in the back of the transmitter. The light atop the transmitter will blink **red** three times to indicate that it has power, then starts blinking blue (searching for the headset).

STEP 3 Please make sure the headset is within range of the transmitter (up to 30ft). Turn on the headset by pressing the power button on the right side of the headset and hold it down to start the pairing process (see page 6 to locate the power button). The headset and transmitter are pre-paired and will connect automatically within 15 seconds. The transmitter light will turn solid blue when the headset is connected.

WHAT THE TRANSMITTER LIGHT MEANS:

Blinks red and turns off –transmitter off

Steady blue – headset connected

Blinking blue – searching for headset or headset out of range

Steady purple – headset off

Using Your Headset

Identify all controls of your headset according to the diagram below.

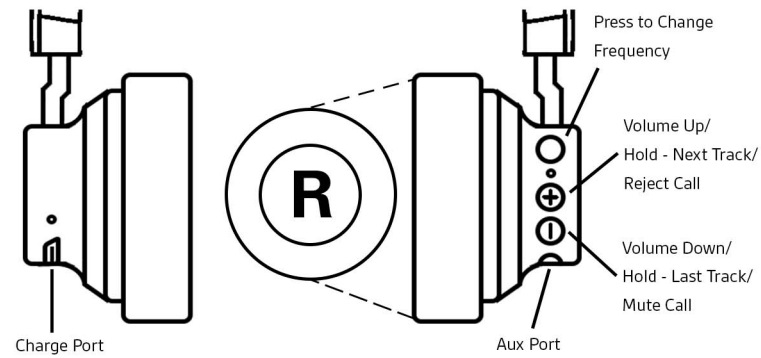

Using Your Headset

Identify all controls of your headset according to the diagram below.

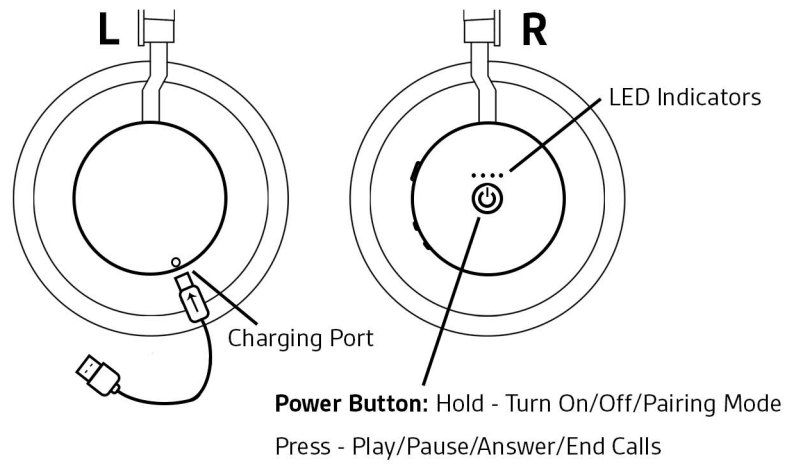

PAIRING TO YOUR MOBILE PHONE

NOTE: WILL ONLY WORK IF DONGLE IS OFF

1. Turn headset off, press and hold power button for seven (7) seconds until indicator flashes white and red.
2. Open the settings on your mobile phone so that it begins searching for new devices.
3. Select "Clarity200 Headset". If necessary, enter four zeroes (0000) for the passcode or accept the connection.
4. When headset flashes white only, it indicates that the headset is paired.

Make/Answer/End Calls While Paired to Mobile Phone Only:

1. To make a call: dial the number from the mobile phone.
2. To answer a call: you will hear an incoming call alert while listening to the TV. Press the Power button to answer. TV audio is muted during the call; streaming audio from the mobile phone is muted and paused.
3. To end a call: press the Power button to end the call. Headset returns to audio from mobile phone.
4. To decline a call: press and hold the "+" button for 2 seconds; you will resume the previous audio activity from before the incoming call.

Mute: during a call, press the "-" button.

LISTENING TO MUSIC (from mobile phone)

When you use your headset to listen to music from your mobile phone, the left headphone includes buttons for pause/play, next, and back.

IMPORTANT: In order to preserve battery charge, we recommend turning off the headset when not in use.

CHARGING

Use the second power adapter and cable to charge your headset. It takes up to 2.5 hours to fully charge your headset. The LED's turn off once charging is complete.

To check the headset's battery status, look at the visual indicators on the right ear of the headset.

TECHNICAL DETAILS

- TL200 HEADSET

- Weight: 9.1 oz.
- Up to 18 hours of wireless listening time from rechargeable battery
- Up to 21 days standby time
- High quality audio
- Multipoint technology

- TL200 TV LISTENER

- Range: up to 30 ft
- Answer mobile calls from headset (when mobile phone is paired to the headset)

en

Safety Instructions To reduce the risk of fire, electric shock, injury to persons and damage to property, read all operating instructions and the following safety instructions before using your Clarity product.

Operating, storage and charging temperature is 10°C to 40°C (50°F to 104°F).

- Only use those Clarity products and accessories designed for use with this product.
- If you experience a skin irritation after using this product, discontinue use and contact Clarity.
- CHILDREN. Never allow children to play with the product-small parts may be a choking hazard.
- Do not disassemble the product as this may expose you to dangerous voltages or other risks. Incorrect reassembly can cause electric shock or fire when the product is subsequently used.
- Unplug, discontinue use and contact Clarity if the product overheats or has a damaged outer casing, cord or plug.
- Exposure to high volume sound levels or excessive sound pressure may cause temporary or permanent damage to your hearing. Although there is no single volume setting that is appropriate for everyone, you should always use your headset/headphones with the volume set at moderate levels and avoid prolonged exposure to high volume sound levels. The louder the volume, the less time is required before your hearing could be affected. You may experience different sound levels when using your headset/headphones with different devices. The device you use and its settings affect the level of sound you hear. If you experience hearing discomfort, you should stop listening to the device through your headset/headphones and have your hearing checked by your doctor. To protect

your hearing, some hearing experts suggest that you:

1. Set the volume control in a low position before putting your headset/headphones on your ears and use as low a volume as possible.
 2. Avoid turning up the volume to block out noisy surroundings. Whenever possible, use your headset/headphones in a quiet environment with low background noise.
 3. Limit the amount of time you use headsets/headphones at high volume levels.
 4. Turn the volume down if the sound from the headset/headphones prevent you from hearing people speaking near you.
- Do not use headphones that cover both ears while driving or riding a bicycle. Such use is unlawful in many regions and will impair your ability to hear sounds around you, creating a hazard for you and others.

Charging Warnings

- Use only the charger supplied by Clarity to charge the product and follow the charging instructions provided. Do not use the charger for any other purpose. Ensure that the voltage rating corresponds to the power supply you intend to use.

Battery Warnings

- This product has an embedded, non-replaceable battery; do not attempt to open the product or remove the battery as this may cause injury and/or damage the product.
- Do not dispose of the product in a fire or heat above 40°C (104°F).
- RECYCLING The product must be recycled or disposed of properly. Contact your local recycling center for battery removal and proper disposal.

fr

Consignes de sécurité Pour réduire les risques d'incendie, de décharge électrique, de blessure corporelle et de dommages à la propriété, lisez toutes les instructions d'utilisation et les consignes de sécurité qui suivent avant d'utiliser votre produit Clarity.

- Pour le fonctionnement, le rangement et le chargement de votre produit, maintenez-le à des températures comprises entre 10° C et 40 °C (50°F à 104°F).
- Utilisez uniquement des produits et accessoires Clarity conçus pour votre produit.
- Si une irritation de la peau se manifeste après avoir utilisé ce produit, cessez de l'utiliser et communiquez avec Clarity.
- ENFANTS. Ne laissez pas les enfants jouer avec le produit; ils risqueraient de s'étouffer avec les petites pièces.
- Ne démontez pas le produit; il peut vous exposer à des tensions dangereuses ou à d'autres risques. Un mauvais remontage de l'appareil pourrait causer une décharge électrique lors d'une utilisation ultérieure du produit.
- Si votre produit surchauffe ou si la prise ou le câble de celui-ci est endommagé, débranchez-le, cessez de l'utiliser et communiquez avec Clarity.
- L'exposition à une pression sonore excessive ou à un volume élevé peut endommager votre audition de manière temporaire ou permanente. Même si aucun réglage de volume n'est approprié pour tous, vous devez toujours régler le volume d'écoute à une intensité modérée et éviter d'utiliser un volume élevé de façon prolongée. Plus le volume est élevé, plus vous risquez d'endommager rapidement votre audition. Le volume de l'écouteur peut varier en fonction de l'appareil avec lequel il est utilisé. L'appareil que vous

utilisez ainsi que ses paramètres modifient le volume. Si vous ressentez une gêne auditive, arrêtez d'utiliser l'appareil avec les écouteurs et consultez un médecin. Pour protéger votre audition, voici ce que des experts en matière d'audition recommandent :

1. Réglez le volume à bas niveau avant de placer les écouteurs sur vos oreilles et conservez le niveau sonore le plus bas possible lorsque vous l'utilisez.
 2. Évitez d'augmenter le volume pour vous isoler des bruits qui vous entourent. Utilisez, si possible, les écouteurs dans un endroit tranquille, sans trop de bruits de fond.
 3. Limitez le temps d'utilisation à volume élevé.
 4. Baissez le volume si le son provenant des écouteurs vous empêche d'entendre les personnes qui parlent autour de vous.
- Ne pas utiliser des écouteurs qui couvrent les deux oreilles pendant la conduite ou une bicyclette. Une telle utilisation est illégale dans de nombreuses régions et nuire à votre capacité à entendre les sons autour de vous, créer un danger pour vous et les autres.

Avvertissements relatifs au chargement

- Utilisez l'adaptateur d'alimentation fourni par Clarity pour le chargement du produit. Suivez les instructions sur le chargement. N'utilisez l'adaptateur à aucune autre fin. Vérifiez si la tension nominale convient à la prise électrique utilisée.

Avvertissements concernant les piles

- Ce produit dispose d'une batterie non remplaçable intégré; ne tentez pas d'ouvrir le produit ou retirer la batterie, car cela peut causer des blessures et / ou endommager le produit.

- Ne jetez pas le produit au feu et ne l'exposez pas à une chaleur excédant 40 °C (104 °F).
- RECYCLAGE Le produit doit être recyclé ou mis au rebut de façon appropriée. Contactez votre centre de recyclage local pour l'enlèvement de la batterie et l'élimination appropriée.

Registering Your Product

Visit <http://clarityproducts.com/product-registration/> to register your product online so we can provide you with the best service and technical support.

Limited Warranty

Clarity offers a one (1) year limited warranty. For warranty details, conditions and technical assistance, please visit our website: www.clarityproducts.com/warranty.

clarity®

Clarity

6131 Preservation Dr.
Chattanooga, TN 37416
United States

©2019 Clarity Products LLC. All rights reserved. Clarity and TL200 are trademarks of Clarity Products LLC.
(RevA - 03.14.2019 pn4956.001)

NEED MORE HELP? CALL 800-426-3738