



Dolphy Australia
The sign of quality

HAIR DRYER OPERATION INSTRUCTION

Wall-Mounted Hair Dryer

DPHD0002

Wall-mounted hair dryer comes from European classical design luxury and beauty, fashionable variety, high quality, Safe and Reliable. It could be regard as skin dryer , skin dryer after Shampoo, soft wind, wouldn't hurt the hair quality. It is the first choice for bathroom, and a must of star hotel.

NOTICE

Before installation, please read the following instructions carefully to avoid operation or use undeserved cause unnecessary injury and product damage.

This hair dryer must be fixed in the place where the bath and shower can't contact.

Appliance installation fixed handheld part must ensure that all straight, then a bath and shower can't contact

1. Please do not make the product and the power plug contact with water.
2. Make sure that you use the voltage consistent with the product indicate the rated voltage.
3. Please don't use the product in the places that is full of water bath crock, takes a shower, washes plate and high humidity.
4. Be careful not to make hair be involved in to the draught in using, do not insert objects into the air outlet and outlet. if the air outlet or outlet is blocked in using, maybe the ram parts overheat and damage. if appear the kind of circumstance, please immediately stop using, then remove the plug, remove the clog of outlet.
5. Please pay attention to the toward the hair dryer, outlet and the hair keep more than 3cm.
6. Do not directly to the air blow to the eyes or other sensitive areas.
7. After the hair dryer is used, the temperature will be very high, the wind should avoid direct contact with the wind.
8. Do not pull on the power cord, damage or refit the power cord privately in using.
9. Please avoid fall or make products by strong knocked.
10. When clean product surface, need only can wipe gently with towel dry water, do not use banana oil, gasoline, cleaner and the corrosive liquid to wipe

PRODUCT FEATURE

- 1.Imported plastic materials refined, not easy to overheating deformation。
2. Cold and heat wind is set, any choice。
3. Handle with micro switch button to set, lift the handle and electricity work, loose the power button is stop working。
4. Mute design, beautiful and delicate, especially energy saving。
5. Dual power protection, prevent overheating。
6. Strong hanging safety support, strong and durable。
7. With 110V, 220Vneed shaver socket。
8. common model。

PRODUCT ASSEMBLY DEFINITION

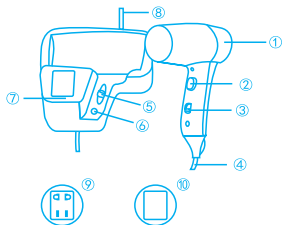

- | | |
|-----------------------|------------------|
| 1. RAM | 6. Screw hole |
| 2. Micro power switch | 7. Bottom case |
| 3. Cold/heat cotton | 8. Power line |
| 4. Spring line | 9. Shaver socket |
| 5. Total power switch | 10. Common model |

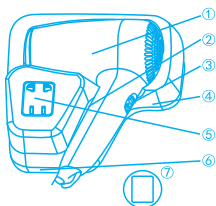

- | | |
|-----------------------|---------------------|
| 1. RAM | 5. The razor socket |
| 2. Micro power switch | 6. After the shell |
| 3. Toggle switch | 7. Common model |
| 4. Spring line | |

THE SPECIFICATION

Rated power	1220W-1400W
Rated frequency	50Hz
Voltage	220V~
Protection electric shock	□

INSTALLATION METHOD

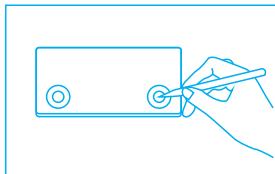

HOOK INSTALLATION STEP ONE

Take with the hook on the installation position, marked, so that the drill mounting holes.

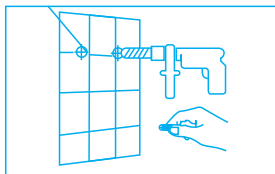

HOOK INSTALLATION STEP TWO

Installed electric drill in the position drill hole, and make into random attached to the piston

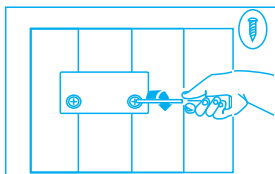

HOOK INSTALLATION STEP THREE

Tighten with screw hook on the installation location

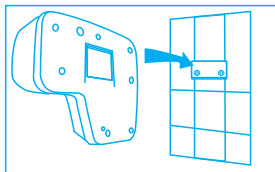

HOOK INSTALLATION STEP FOUR

Machine foundation jockey for position aimed at hook wall-mounted, make machine and hook fix

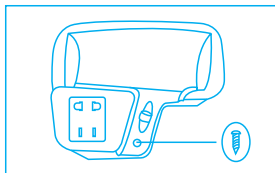

HOOK INSTALLATION STEP FIVE

Fixed well the machine with screws