

# INSTRUCTION OF USE

(Automatic Hand Dryer)

## 1. Technical data

Voltage rating: 110V-130V , 220-240V / 50/60Hz

Power rating: 1200W

Temperature of wind:  $60^{\circ}\text{C} \pm 20^{\circ}\text{C}$

Weight: 1.2Kg

Vilocity of wind:  $>30\text{m} / \text{sec}$

Acting distance:  $>140\text{mm}$

Delay time:  $<12\text{sec}$

## 2. Method of installation

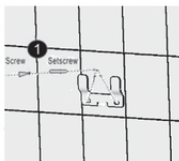

1. Install the screws and bracket.

2. Hang up the hand dryer.

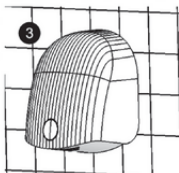
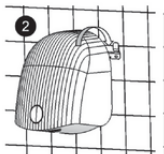

3. Finish hanging up the hand dryer.

4. Scew the nut in the hole.

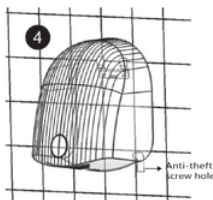

## Instructions for use



### **3. Method of usage**

- 1、 After installing the hand dryer, turn the power supply on, it will be on the work ground.
- 2、 When put the hands nearby the vent the hole within 15cm, the dryer will work automatically, and vent the hot wind.
- 3、 After several seconds when the hands left the dryer, it will stop working.

Quality Warranty: 1Year