

Operation and Maintenance Manual

W Series



Congratulations!

You are moments away from fresher, cleaner indoor air. Your new AllerAir unit will combat many of the chemicals, gases, odors and particles responsible for poor indoor air quality (IAQ). Poor IAQ may cause or worsen allergies, asthma, multiple chemical sensitivities (MCS) and sick building syndrome. We recommend proper maintenance of your unit to keep it running efficiently for years to come.

Operation:

All units except D and DX models are shipped fully assembled and ready for use. (D and DX model owners may refer to their additional instruction sheet for filter installation, or refer to Page 3 of this booklet.)

Note:

As original packaging is required for warranty returns, new AllerAir owners are advised to keep boxes and shipping materials.

Model No. _____

Serial No. _____

WARNING!

- No user serviceable parts inside.
- Risk of fire, electric shock, or injury to persons through misuse.
- This is an electrical appliance. It is not intended for use by persons (including children) with reduced physical, sensory or mental capabilities, or lack of experience and knowledge, unless they have been given prior instructions concerning use of the appliance or they are being supervised by a person responsible for their safety.
- Children should be supervised to ensure that they do not play with the appliance.
- Do not operate any unit with a damaged cord or plug. Discard unit or return to AllerAir for examination and/or repair.
- Do not run cord under carpeting and do not cover it up in any way. Do not place cord under furniture or appliances. Arrange cord away from high-traffic areas and do not make it a tripping hazard.
- Refrain from poking or sticking any object into the unit's air vent discharge.
- Do not use any parts, attachments or filters not recommended by AllerAir.

GETTING STARTED

- Keep packaging in case of warranty returns
- Wipe the unit with a soft damp cloth to remove any dust which may have accumulated during shipping
- Check the inlet opening for extra prefilters if ordered. (Bottom of unit)
- Place the unit on its casters and plug it into a 120-volt outlet with ground
- Run the unit on TURBO for a few minutes to re-adjust the airflow patterns in the room
- Depending on your interior conditions, you may choose to run the unit on HIGH during the day and on LOW at night*
- Running the unit on LOW is energy-efficient and increases the amount of air dwell time in the cleansing chambers

*Depending on interior dust conditions. For VOC's, chemicals, smoke or odors we suggest operating continuously on the low setting to allow for the longest dwell time and adsorption.

REPLACING OR CLEANING THE PRE-FILTER

We recommend changing or cleaning pre-filters every one to two months.

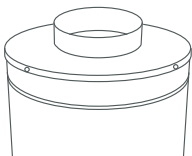

STEP 1

Turn the unit off, unplug it, and gently lay it on its side.

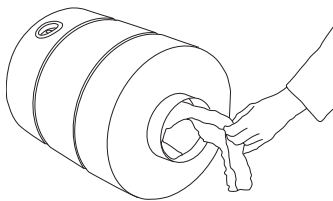

STEP 2

Slowly remove the dirty pre-filter to avoid dispersing its contents.

To clean: Carefully vacuum both sides of the filter.

To discard: Gently insert into a plastic bag and discard.

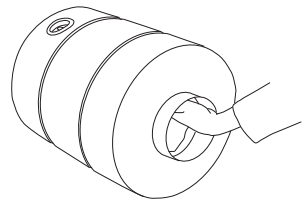

STEP 3

To install: Gently press the pre-filter flat against the inner walls of the innermost filter. Return the unit to an upright position.

PRE-FILTER ORDER REFERENCE NUMBERS*

To order a new pre-filter, call AllerAir toll-free at 1-888-852-8247 during regular business hours (EST), or send an e-mail to info@allerair.com

| Models | Prefilters | AirMedic Pro 4 | AirMedic Pro 5 | AirMedic Pro 6 | Notes |
|--------------|-----------------|----------------|----------------|----------------|-----------------|
| Exec, Vocarb | Poly Prefilters | A4FMP006 | A5FMP009 | A6FMP012 | packs of 4 or 8 |

*Please use the above part numbers when ordering your replacement parts.

FILTER ASSEMBLY

The model you have selected is shipped in 2 separate boxes to protect certain components. The filter comes in one box, and the outer shell of the unit, containing the motor and the fan, comes in another. Filters must be installed before turning the unit on in order for it to work. AllerAir technicians recommend removing the base, installing the filter, and replacing the base according to steps 1 - 4 and 12 - 16 of the following procedure.

REPLACING superHEPA and/or CARBON FILTERS

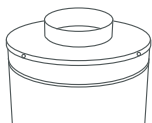

STEP 1

Make sure the unit is set to **"Off"** and the unit is **unplugged**. Place the unit upside down, so that the wheels face up.

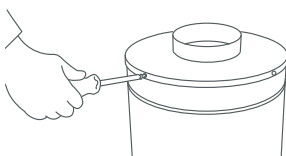

STEP 2

Using a #2 Philips screwdriver, remove the four screws that hold the base onto the unit.

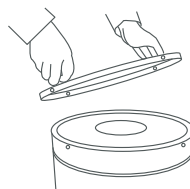

STEP 3

Grasp the wheels. Remove the base by pulling gently on the wheels.

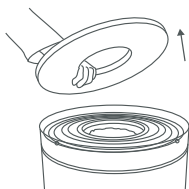

STEP 4

Reach inside the unit, and remove felt pad.

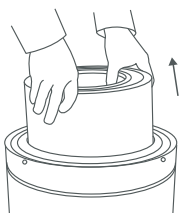

STEP 5

Remove the carbon filter along with the 0.1 micron superHEPA filter. (pull up gently by placing thumbs on the inner side of the filter)



STEP 6

Remove the used 0.1 micron superHEPA filter.



STEP 7

Replace with a new 0.1 micron superHEPA.



STEP 8

Position metal bar on the edge of overlap after wrapping the superHEPA around the outside of the carbon canister.



STEP 9

Place "hook" side of the velcro strap on the inside and start wrapping the strap around the edge of the filter.



STEP 10

While wrapping the strap around the filter make sure to exert a reasonable amount of tension on the strap so it is not loose once the loop is complete.



STEP 11

Procedure ended successfully - metal angle exerts pressure on the edge of the superHEPA. Straps keep the material in contact with filter's edges.



STEP 12

Gently insert the new carbon filter into the unit, either end up. **See page 6 for instructions on replacing carbon filling.**



STEP 13

Put back the felt pad removed in **STEP 4**.

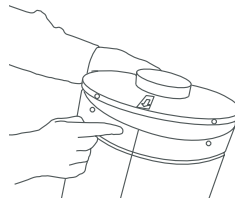

STEP 14

Replace the base, making sure the arrow on the gold sticker lines up with unit's rear seam.

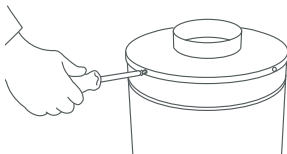

STEP 15

Replace the four screws.



STEP 16

Turn the unit back onto its wheels. It is now ready for use.

HEPA & CARBON FILTERS ORDER GUIDE

- These replacement filters will extend the life of your AllerAir unit. Please be sure to follow the instructions for changing the filters in your unit.
- We recommend changing pre-filters every two months, HEPA filters every three to five years, and carbon filters every two years.

ORDER REFERENCE NUMBERS

Please use the numbers in the following charts when placing your order. Call AllerAir at 1-888-852-8247 during regular business hours (EST) or send an e-mail to info@allerair.com.

Microparticulate superHEPA Filter Order Guide

| Models | AirMedic Pro 4 | AirMedic Pro 5 | AirMedic Pro 6 |
|--------------|----------------|----------------|----------------|
| Exec, Vocarb | A4FSH642 | A5FSH942 | A6FSH1242 |
| D Models | A4FSH645 | A5FSH945 | A6FSH1245 |
| DX Models | A4FSH648 | A5FSH948 | A6FSH1248 |

Please use the following part numbers when ordering your replacement parts.

This is the filter that wraps around any carbon filter.

Replacement Carbon Filter Order Guide

| Models | AirMedic Pro 4 | AirMedic Pro 5 | AirMedic Pro 6 |
|-----------------------|----------------|----------------|----------------|
| Exec Models 2"*** | A4FCW320 | A5FCW320 | A6FCW320 |
| Exec Models 2.5"*** | A4FCW325 | A5FCW325 | A6FCW325 |
| Vocarb Models 2"*** | A4FCW220 | A5FCW220 | A6FCW225 |
| Vocarb Models 2.5"*** | A4FCW225 | A5FCW225 | A6FCW225 |
| D Exec Models 3" | A4FCW330 | A5FCW330 | A6FCW330 |
| D Vocarb Models 3" | AA4FCW230 | A5FCW230 | A6FCW230 |
| DX Exec Models 3.5" | A4FCW335 | A5FCW230 | A6FCW335 |
| DX Vocarb Models 3.5" | A4FCW235 | A5FCW235 | A6FCW235 |
| DS Models 3" | A4FCW630 | A5FCW630 | A5FCW630 |
| MCS Models 2" | A4FCW120 | A5FCW120 | A6FCW120 |
| DXS 3.5" | – | A5FCW635 | A6FCW635 |

Please use the following part numbers when ordering your replacement parts.

If you have ordered a special blend of carbon in the past please let us know about it when ordering the replacement.

**Please refer to your carbon filter depth when ordering a replacement.

REFILLING THE CARBON CANISTER

- Your AllerAir unit contains a refillable carbon filter. You may choose to refill it* or simply purchase a new filter. **Tools Required:** Philips screwdriver, garbage bag large enough to hold all of the old carbon, rubber mallet.

*When changing the carbon filter, it should be placed on a newspaper or protective surface as it may leak some carbon particles.
- AllerAir makes a special funnel to evenly refill carbon filters. Call 1-888-852-8247 during regular business hours (EST) or send an e-mail to info@allerair.com.



STEP 1

Remove the carbon filter from the unit by pressing thumbs against the inner rim and pulling up.

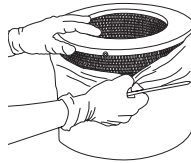

STEP 2

Gently pull back the pre-filter to access the four screws at the top of the filter. Remove the screws with a Philips screwdriver and take off the lid of the filter.

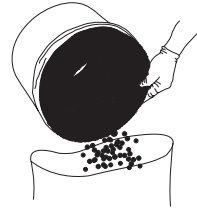

STEP 3

Discard all of the old carbon. Pour it into a garbage bag of adequate size and tie the bag shut.

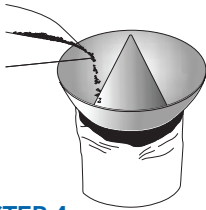

STEP 4

Pour in the new carbon, using a funnel if desired. As you pour, tap the sides of the filter with the rubber mallet to help settle the carbon granules.

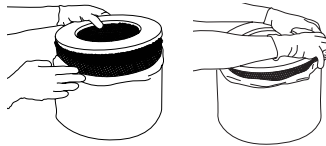

STEP 5

When the filter is full, replace the lid and its screws. Adjust the pre-filter, and gently slide the filter back into the unit.

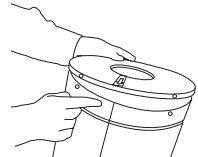

STEP 6

Replace the felt gasket. Replace the top of the unit. Align the arrow on the gold sticker with the unit's seam, and replace the four screws with a Philips screwdriver.

Empty Carbon Canisters Order Guide

| Models | AirMedic Pro 4 | AirMedic Pro 5 | AirMedic Pro 6 | Notes |
|-----------------|----------------|----------------|----------------|---------------------------|
| 2" Canister** | A4FC0500 | A5FC0500 | A6FC0500 | Exec & Vocarb; MCS models |
| 2.5" Canister** | A4FC1500 | A5FC1500 | A6FC1500 | Exec & Vocarb models |
| D Models | A4FC2500 | A5FC2500 | A6FC2500 | - |
| DX Models | A4FC3500 | A5FC3500 | A6FC3500 | - |

Please use these part numbers when ordering your replacement parts.

**Please refer to your carbon filter depth when ordering a replacement.

Bulk Carbon Order Guide

| Models | AirMedic Pro 4 | AirMedic Pro 5 | AirMedic Pro 6 |
|-------------------|----------------|----------------|----------------|
| Exec Mix | AM000911 | AM000911 | AM000911 |
| Vocarb Mix | AM000912 | AM000912 | AM000912 |
| Tobacco Smoke Mix | AM000912 | AM000912 | AM000912 |
| MCS Mix | AM000901 | AM000901 | AM000901 |
| Special Blend Mix | Please Call | | |

Please use these part numbers when ordering your replacement parts.

REPLACING UV BULB AND BALLAST

WARNING!

ALWAYS UNPLUG UNIT FROM POWER SOURCE BEFORE PERFORMING ANY MAINTENANCE.

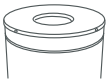
**STEP 1**

Turn the unit "Off" and unplug it.

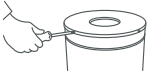
**STEP 2**

Using a #2 Philips screwdriver, remove the four screws that hold the top onto the unit.

**STEP 3**

Gently grasp the top, and remove the lid by pulling gently.

**STEP 4**

Remove the felt pad.

**STEP 5**

Remove the filter(s) according to the indicated directions.

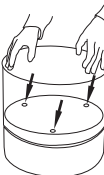
**STEP 6**

Remove the three screws in the filter end plate, and remove the end plate.

7A

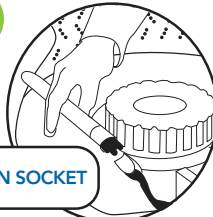

4 PIN SOCKET

7B

WING NUT

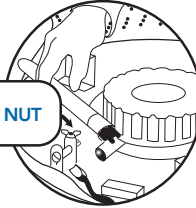
**STEP 7**

For a 10-watt bulb:

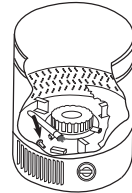

- Unplug the four-pin socket from the bulb.
- Loosen the wing nut that holds the bulb in place.
- Carefully remove the bulb.

7A

NYLON WRAP

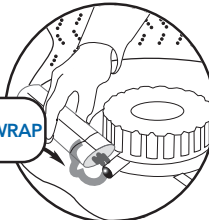

7B

4 PIN SOCKET

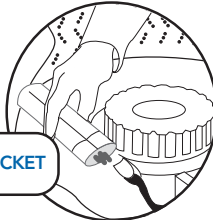
**STEP 7**

For a 20-watt bulb:

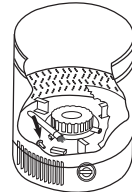

- Carefully cut the band of nylon that holds the UV bulb in place (for shipping purpose only).
- Unplug the four-pin socket.
- Carefully remove the bulb.

STEP 8

Place the new bulb in the holder. Make sure it is horizontal. Make sure it is not touching any of the other components.

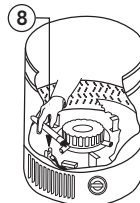
**STEP 9**

Replace the four-pin socket.

STEP 10

Replace the filter end plate. Replace the screws, filter(s) and top with the 4 screws.

IMPORTANT!

UV SYSTEMS NOT AVAILABLE IN CALIFORNIA.

TEN YEAR LIMITED WARRANTY

Your AllerAir unit comes with a 10-year limited warranty excluding expendable parts such as pre-filters and filters. This warranty provides for the repair of any defective components and labor for 5 years from the date of delivery. An additional 5-year warranty is provided on parts. This product is not covered against damage resulting from misuse. This warranty does not cover damage, fault or failure due to alteration or repairs made by anyone other than AllerAir or the use of supplies and accessories other than those manufactured by AllerAir. This warranty is provided to the original purchaser and may not be transferred. A return authorization number is required for warranty repairs. Please contact AllerAir at 1-888-852-8247 for more information.

THE ALLERAIR AIR FILTRATION SYSTEM

ACTIVATED CARBON

Your AllerAir air purifier contains activated carbon that permanently traps dangerous airborne chemicals, gases and odors. This vital filter should be changed approximately every two to three years, depending on the environment in which the unit is operating. You can also upgrade your Exec, Vocarb or D unit at any time to accommodate a larger and deeper carbon filter suitable for removing heavier concentrations of chemicals, gases and odors.

PRE-FILTER

The pre-filter included with your unit removes larger particles and helps prolong the life of your HEPA filter. The pre-filter should be vacuumed or replaced every three months.

SUPER-HEPA*

HEPA filters are widely recommended by allergists, doctors and indoor air quality experts for home and office use. The robust and flexible Super-HEPA in AllerAir units traps 99.9% of fine particles at 0.1 microns in size, including dust, hair, pollen and even some bacteria and viruses. Depending on the particle level in the environment in which the unit is used, your HEPA filter should be replaced every three to five years.

*Note that a pleated HEPA filter is also available. Contact AllerAir or check our website for more information.

THE ALLERAIR ADVANTAGE

- Our units offer complete air filtration removing airborne chemicals, gases, odors and particles.
- Our deep bed, activated carbon filters last longer than the average thin filter which is generally carbon sprayed onto a synthetic material.
- Our units do not use dangerous ozone technology
- Our units are manufactured to clean your air and therefore are not made with a plastic housing, or other materials which may off-gas chemicals.
- Our units are powered by American-made motors that are energy efficient and cost only pennies a day to operate.

IMPORTANT NOTICE!

PLANNING ON PAINTING YOUR HOME? READ THIS FIRST:

Particles from paint may clog your HEPA filter, therefore we recommended that users unplug their units and remove the HEPA filter, storing it off-site until the paint job is complete. Due to the serious toxic nature of paint it is also recommended that your carbon filter be replaced or refilled in the weeks after the paint job is complete. See, Replacing HEPA and/or carbon filters, for instructions on how.

