

Delicato™ 6732 Freestanding Bathtub

Letter	Description	Soaking
-	Drain Location	Center Drain
-	Equipment Location	--
-	Cutout Template	--
-	Total Weight	1,047 lbs (475 kg)
-	Floor Loading	70 lb/ft ² (342 kg/m ²)
-	Operating Gallons	82 Gal (310 L)
-	Product Weight	116 lbs (53 kg)
-	Soaking Depth	17.9" (455 mm)
L	Outer Length	67" (1702 mm)
W	Outer Width	32" (813 mm)
H	Overall Height	24" (610 mm)
A	Overflow Height	18.2" (462 mm)
B	Long Edge to Drain Center	16" (406 mm)
C	Short Edge to Drain Center	33.5" (851 mm)
D	Drain Shoe Length	--
E	Flange Height	--
F	Deck Width*	2.5" (64 mm)
G	Service Access Dimensions	No Service Access
I	Floor Cutout for Drain	4" x 4" (102 mm x 102 mm)
J	Interior Dimensions Bottom of Bath (L x W)	49.7" x 19.3" (1262 mm x 490 mm)
K	Interior Dimensions Top of Bath (L x W)	64.0" x 27.0" (1626 mm x 656 mm)
L2	Interior Depth - Drain End	20.7" (526 mm)
M	Backrest Angle	15.0°

NOTE

The overall dimensions are nominal with a tolerance of +0 and -.25" (6 mm).

CAUTION: The integral overflow cover is not removable. The warranty will be voided if attempted.

KEY DIMENSIONS

*Deck width reflects only area indicated on detail.

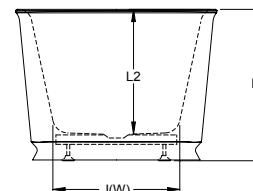
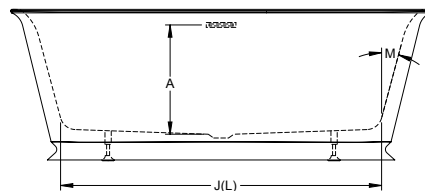
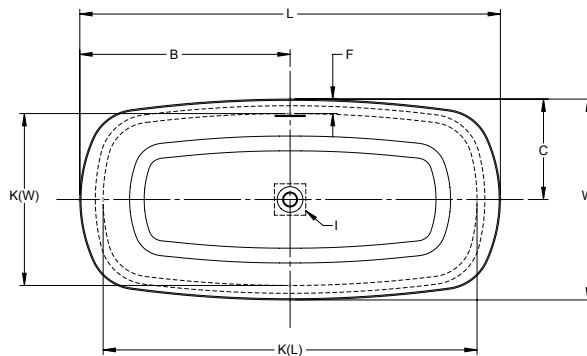

©2018 Jacuzzi Luxury Bath • For additional information, call Customer Service 800-288-4002 • www.jacuzzi.com/baths
Refer to installation instructions included with fixture before beginning installation. Please confirm product availability and specifications before commencing with any installation work.

PRODUCT SPECIFICATIONS AND AVAILABILITY ARE SUBJECT TO CHANGE WITHOUT NOTICE