

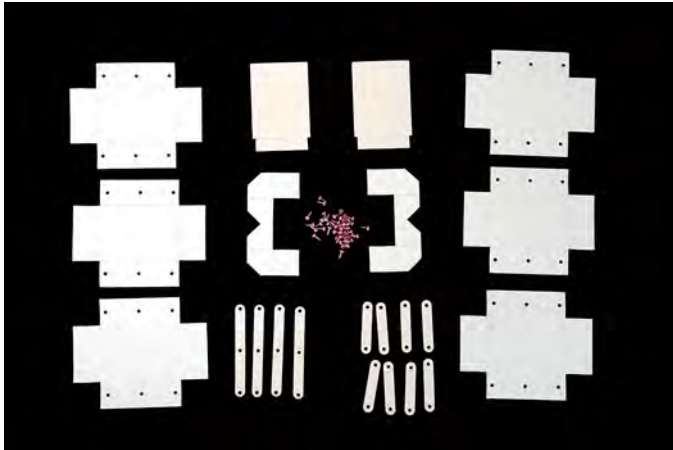

660768 Sizzix® ScoreBoards™ XL Die - Box, Cantilever Sewing Box by Eileen Hull®

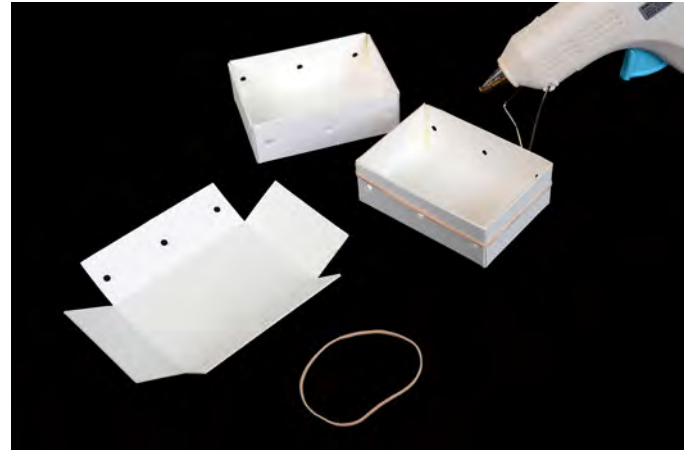

1. Die-cut from mat board. Twenty-eight small brads will be used to assemble the constructed pieces.



2. Build drawers using hot glue or another strong adhesive. A rubber band makes a great clamp for holding sides in place while glue is drying or cooling.



3. Build a total of six drawers.



4. Adhere legs to bottom set of drawers as shown. At this stage, you may also desire to hand-cut a piece of mat board 2 1/8" x 6" to cover the bottom of both drawers together. This will increase the strength of the bottom layer of drawers and keep it from sagging in the middle. Once the drawers are glued together, attach the legs.



5. Using brads, attach four long hinges to the four outside corners. Attach four short hinges to the four center holes.



6. Attach the long and short hinges to the second row of drawers as shown. Attach the final four small hinges to the outside corners of the second row of drawers. Attach both the small and large hinges to the final row of drawers as shown.

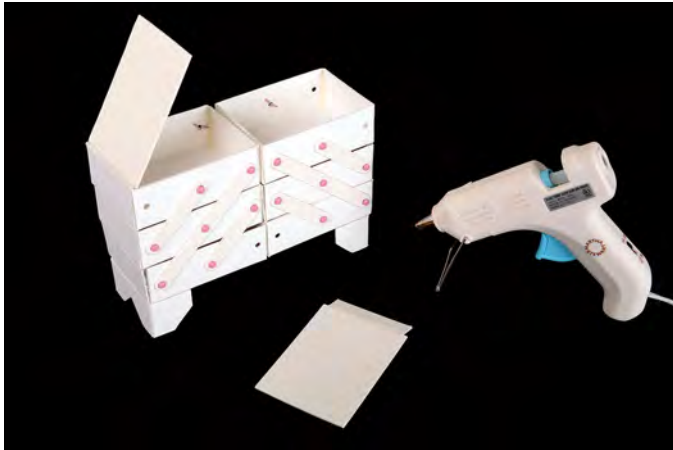

7. Adhere the lids to the top set of drawers.



8. Fill and embellish as desired.