

'Dolgochification' kit  
 Fletcher Jennings  
 NPC-017  
 TR N<sup>g</sup>2

**Product Info**

This kit has been developed to enable owners of the Bachmann 'Thomas & Friends' Rheneas narrow gauge locomotive to retrofit a realistically profiled cab, chimney, smokebox door, front wheel splashers and other detail parts to make a more realistic representation of the Talylyn Railway's No.2 Dolgoch. We highly recommend that the builder researches the loco in the numerous publications available and/or searches online, and studies photos of the loco so that they can build & finish the loco depending on the era they are

aiming for. Parts are included to build the cab entrances in pre & post rebuilt condition, ditto the placement of the name and works plates as they have changed positions over the years.

**About the kit**

This kit is comprised of a 3D printed plastic cab, fret of etched nickel silver parts as detail overlays and lost wax brass detail castings. Minimal fettling will be required to these parts and they can all be glued in place. We recommend sparing use of liquid superglue or fast curing epoxy resin for assembly, ideally using a

bottle with a thin applicator nozzle. Due to the nature of the 3D printing process, some support material may still be present on the body. This waxy residue has been cleaned during our checking process, but it can be a good idea to submerge the 3D printed parts in white spirit, agitated gently with an old tooth brush and leave to dry. Carefully remove each part from the fret as required using a sharp knife on a board, dressing the tags with a file.

Please note this is a scale model for adult collectors and not intended for children under 14 years of age

Thank you for purchasing this Narrow Planet kit, we hope you enjoy building and operating it. Please read through the instructions thoroughly before beginning assembly.

**Component list**

- 3D printed cab shell, splashers, smokebox door & air pump
- Nickel silver etched details
- Narrow Planet nameplate and works plate set
- Brass detail castings
- Handrail knobs (2) & wire

**Tools Required**

- Razor saw
- Tweezers
- Craft Knife
- Small Phillips type screwdriver
- Twist drills & pin vice
- Needle files/emery boards
- Superglue or 5-minute epoxy

**Required to complete**

- Bachmann USA item #58602:
- 'Thomas & Friends' Narrow Gauge Rheneas

**Construction Notes**

**Loco disassembly** • The *Rheneas* model needs partial disassembling. Before disassembly, check the model runs fine as you will void any warranty by proceeding. Referring to the exploded diagram supplied with the model unscrew & remove the 3 fixings as indicated and gently pull the body away from the chassis; cab first as the front of the body clips into the footplate. Be careful as you remove the fixings near the motion as you could unwittingly bend one of the rods. Remove the 2 fixings at the rear of the chassis to release the footplate.

Separate the plastic cab from the diecast body. This can be done by using a pulling, rocking and twisting action to break the bond of the factory adhesive.

At this point we would recommend that the factory finish is removed from the metal body, as the loco will need a complete repaint after all the modifications in this kit are carried out. This can be done by immersing in a paint stripper (eg Nitro Mars) or acetone overnight. Ensure the body completely stripped and free from adhesive from the cab area. Remove the chimney and base which should be gently filed back to the curvature of the smokebox. A 1.5mm hole will need to be drilled into the smokebox on the centre line and in the middle to locate the replacement chimney.

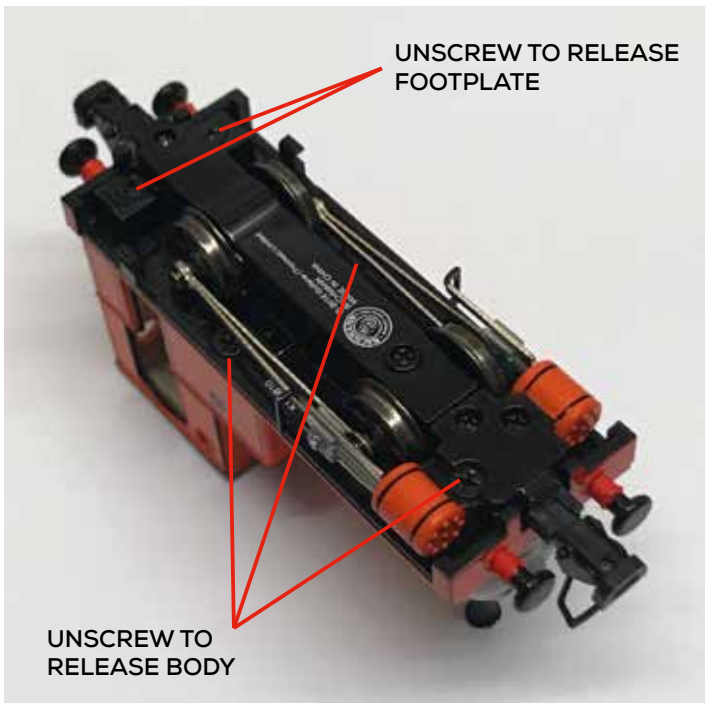
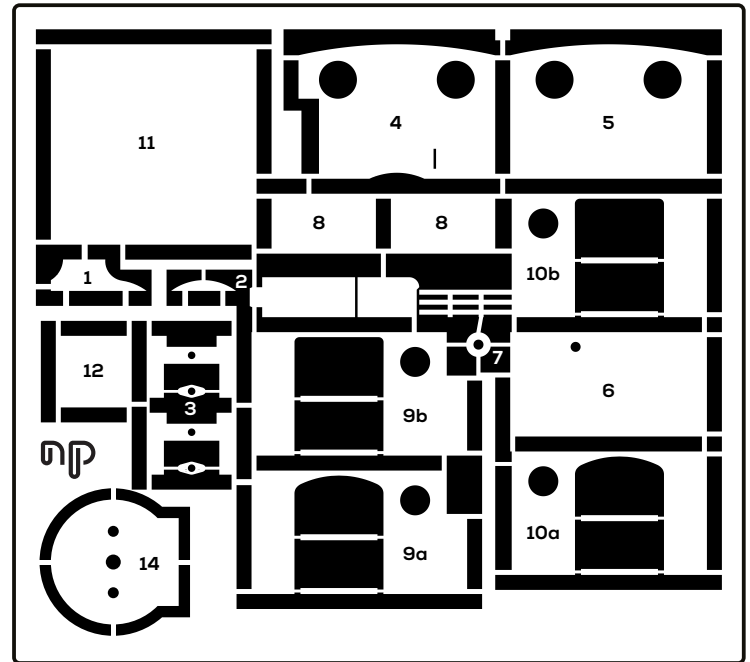

**Footplate** • Cut off the front splashers and file back the material flush with the top of the running plate. The left splasher sits directly on top of the footplate, whilst the right hand splasher is recessed within the footplate – the alignment of this part is critical so that it clears the driving wheels (be mindful that the clearance is close between the inside faces of the splashers and the main body unit). Fit the etched detail parts **(1 & 2)** to the outside faces of the splashers. Optional buffer beam strapping detail parts are provided **(3)**, to fit these the moulded hooks need removing without damage (bon chance!).

**Cab** • The 3D printed cab has been degreased for you, but will require the surfaces to be burnished to enable the etched overlays to be successfully bonded to the print. Remove the parts nested within the cab and store in a safe place. Trial fit the cab to the metal body – this may be a tight fit requiring the locating lugs to be gently fettled.

The bulge in the right hand side of the cab will foul the coal load in the bunker. This side of the bunker does not have coal in it as per prototype and ought to be filed flat to the top of the beading, alternatively file away the bulge so that the cab can sit home fully. Fix the etched overlays **(4 - 12)** to the cab in sequential order with the rivet/bolt detail facing outwards (see diagram for alignment). The rebuilt style cab side **(10B)** features an extended coal bunker which will require folding to shape to 90 degrees on the inside of the half etch lines, the back part of which locates in a slot in the front cab sheet. Ensure any excess adhesive is wicked off before it cures. Cut off the bracing within the cab and on the upper cab overlays and gently dress the edges. Fit the water filler **(13)** to the back of the cab with the filler pointing upwards.

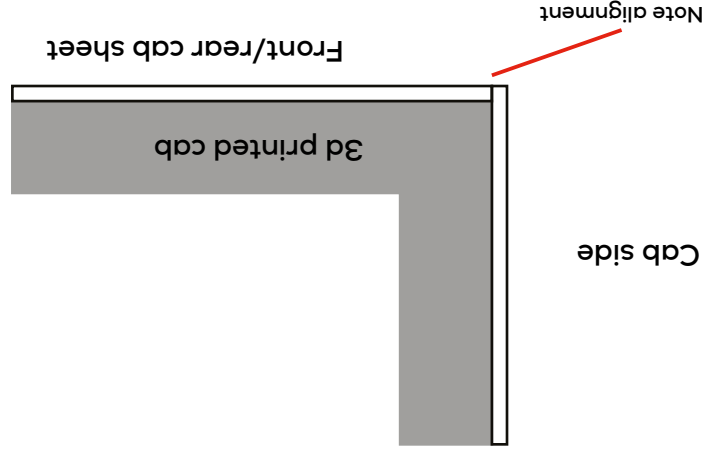

## Contact Details

www.narrowplanet.co.uk  
info@narrowplanet.co.uk

Narrow Planet, PO Box 297  
Bexhill-on-Sea, TN40 9HF

NPC-017 • first issue • April 2017

## About Narrow Planet

**Main body** • Fix the smokebox front overlay **(14)** followed by the door, which hinges from the left-hand side of the loco, and then the brass door handle **(15)**. Fix the chimney **(16)** to the smokebox ensuring it's upright in all planes, if needed trim the locating spigot to be no longer than 2mm as it will otherwise interfere with the chassis on re-assembly. Drill 0.7mm holes in the boiler for the brass cast cack valves **(17)** and upper boiler fittings **(18)** to locate into as per prototype. The pipes are to be formed to shape and trimmed to length so that they fit against the running plate – this is best done after the main body/foot plate/chassis is reassembled. Fit the brass whistle assembly **(19)** to the dome and enlarge the holes for the boiler hand rail knobs, fit the air pump to the running plate in front of the right-hand tank if desired.

Narrow Planet was founded in 2010 and offers a custom etching service for unique nameplates, works plates and number plates for your model railway locos and stock. In any size or shape from 2mm:ft to 16mm:ft scales. Many manufacturers' styles are available, our full range and ordering information can be found on our website.

This kit was designed and developed by Stuart Brewer and Mark A. Greenwood. If you have any queries about the model or instructions please get in touch.