

Artista™ Potter's Wheel

OWNER'S MANUAL



FOR THE Speedball® Artista™ POTTER'S WHEEL

Updated November 2017

Thank you!

Thank you for your purchase of a Speedball® Artista™ Potter's Wheel. **Combining convenience with quality, power and capacity, the Artista™ Potter's Wheel has it all!** To ensure that you enjoy your Artista™ Wheel to the fullest, we encourage you to read this Owner's Manual immediately. It explains all of the features, controls and performance characteristics of your wheel and it also provides important instructions, troubleshooting and safety information.

A separate Warranty Information Card is included in the contents of your shipment and at the conclusion of this Owner's Manual. **Please complete all fields listed on this Card (NOTE: Only one card needs to be completed and submitted. Second Warranty Card was provided for additional convenience.) and return to Speedball® Art Products Company at the address listed below within 30 days of purchase.** You may also choose to complete the warranty registration process online. To do so, simply visit http://speedballart.com/warranty_form2.php and complete all included fields. **Once submitted, please print a confirmation of the Registration Form's submittal for your records.**

Speedball® Art Products Company
Pottery Wheel Warranty Department
2301 Speedball Road
Statesville, NC 28677

Artista™
Potter's Wheel

Table of Contents

select a topic below to be redirected to the appropriate page

<u>Safety Tips</u>	1
<u>Unpacking your Artista™ Wheel</u>	2
<u>Package Contents</u>	2
<u>Wheel Operation</u>	3-4
<u>Using your Artista™ Wheel</u>	3
<u>Splash Pan</u>	3
<u>Bats</u>	3
<u>Cleaning the Artista™ Wheel</u>	3
<u>Optional Accessories for the Artista™</u>	4
<u>Wheel Diagrams / Diagram Legend</u>	5/6
<u>Artista™ Control Board Diagram</u>	7
<u>Artista™ Parts List</u>	8
<u>Artista™ Warranty Overview</u>	9
<u>Artista™ Warranty Card</u>	10
<u>Artista™ Online Warranty Information</u>	10
<u>Additional Ceramics Products by Speedball® Art Products</u>	11-12
<u>Speedball® Glazes and Underglazes</u>	11
<u>Speedball® Bats</u>	11
<u>Speedball® Screen Printing & Block Printing</u>	12
<u>Speedball® Metal Leaf</u>	12

PLEASE READ ALL SAFETY TIPS PRIOR TO USE

Safety Tips

- If you experience any malfunctions with your Artista™ Wheel, discontinue use immediately. Contact Speedball® Customer Service to assist in troubleshooting before conducting any repair or modification to your Artista™ Wheel. See “Artista™ Warranty/Repair Procedure” for more details.
- Immediately discontinue operation of your Artista™ Wheel if you see or smell smoke or if the wheel begins to make unusual noises. If this occurs, turn off the power, unplug the power cord from the wall outlet and contact Speedball® Customer Service for assistance.
- Unplug your Artista™ Wheel before attempting any adjustment or inspection of the wheel or its parts.
- Do not overload the wheel head with clay (clay weight should not exceed recommended weight for your Artista™ Wheel) or force it to stop. Doing so may shorten the life of the motor.
- Plug electrical power cord directly into electrical wall outlet and do not run cord under carpets or cover cord with rug or runners. Unplug the power cord from wall outlet during electrical storms to prevent accidental damage.
- Do not leave wheel running unattended and keep out of the reach of small children.
- Use caution when operating the wheel to not get long hair, jewelry or loose clothing caught in the moving wheel head.
- Do not attempt to move or hold the wheel during use.
- Always turn off your Artista™ Wheel prior to cleaning. To clean your wheel, hand wash with water or clean with air hose only. Do not hose off or pressure wash your wheel as this may result in the damage of wheel motor and/or bearings.
- Do not let the wheel stand in water.
- Artista™ Capacity: 25lbs.
- Artista™ Voltage: 110V (for 220V, transformer and adaptor are required)



Artista™
Potter's Wheel

Unpacking Your Artista™ Wheel

- If you received your Artista™ Wheel in a carton that was damaged during shipment, be sure to make a full description of the breakage and/or damage as soon as possible. Contact the delivery company immediately and make arrangements for an inspection or return of the entire wheel to their claims department.
- If possible, save all shipping containers in case you should ever have to return the wheel for service.
- Be sure to complete your Artista™ Potter's Wheel Warranty Card within 30 days of receipt.

PACKAGE CONTENTS:



Artista™ Wheel



Instructional DVD



(2) Bats (B75, B12)



Bat Pins
Warranty Card



Wheel Operation

Using your Artista™ Wheel

Once your Artista™ wheel is unpacked, you may begin using your wheel by plugging the wheel's six foot power cord into a nearby power source. Your wheel has been electrically-grounded for your protection, however, you must complete the grounding at the outlet. If you are plugging the wheel into a three-holed outlet, your wheel will be grounded automatically. If you have a two-hole outlet, you will need to plug the wheel into a three-holed adapter.

NOTE: to protect the electronics in your wheel from power surges, the use of a surge protector is recommended.

Using the Artista™ Hand Control

Always check that the hand control knob is turned to the "off" position before starting your Artista™ Wheel. To increase the speed of your Artista™ Wheel, rotate the hand control knob clockwise (away from you). Rotate the hand control knob counterclockwise (towards you) to slow the wheel or to bring it to a stop. Do not force the hand control beyond the stops as damage may occur. **NOTE:** The direction of the Artista™ Wheel Head cannot be changed. Instead, it is available in right- and left-handed models.

Splash Pan

The Artista™ Splash pan is a two-piece unit. The rear portion of the splash pan has two catch hooks that lock the two pieces of the pan together. To install, the front piece of the pan must slide under the bracket to lock the splash pan into place.

When operating your Artista™ Wheel, the splash pan must either be locked into place or removed completely. To avoid the risk of injury or damaging the splash pan, do not attempt to remove the splash pan while the wheel is in operation or with any bat larger than 11" in place. The smaller (rear piece) of the splash pan pieces must be removed prior to being able to remove the larger part of the splash pan. Any bat larger than 11" must also be removed prior to removing the splash pan.

Bats

The Artista™ wheel possesses 10" spacing (center to center) for bat pins. While the Artista™ wheel will accept up to a 14" bat, it is recommended to remove the splash pan for use with any bat larger than 12" to minimize the chance of injury to your hands.

NOTE: Bat pins are used to hold a bat on the wheel head and should be removed if you are not using a bat to avoid injury.

Cleaning the Artista™ Wheel

Prior to cleaning the wheel, be sure to turn the hand control to the "off" position and unplug the wheel. Do not use running water or submerge the wheel, instead, use a soft cloth or sponge. Avoid using too much water on the bottom of the wheel or around the electrical components. Be sure not to scrub too hard when cleaning, as the clay may scratch or abrade the wheel head or wheel if too much vigorous pressure is applied when cleaning. The splash pan may be removed and cleaned under running water and/or submerged. No parts/components of the Artista™ wheel, including splash pan, are suitable for placement in the dishwasher.

Optional Accessories for Artista™ Potter's Wheel

Artista™ Foot Pedal

The Artista™ Foot Pedal allows the standard Artista™ Potter's Wheel to be converted from a hand-operated wheel to a foot-powered wheel. This optional feature may be plugged in at the port located on the opposite side of the power cord attachment and power switch.



Artista™ Static Legs Set

Manufactured from steel, this legs set takes the Artista™ Potter's Wheel from the tabletop to a comfortable 22" height from the floor for sturdy, stable, seated throwing.



Artista™ Folding Legs Set

Designed to offer the ultimate portability and storage convenience, this set of foldable, aluminum legs is easily attached to the Artista™ for seated throwing.



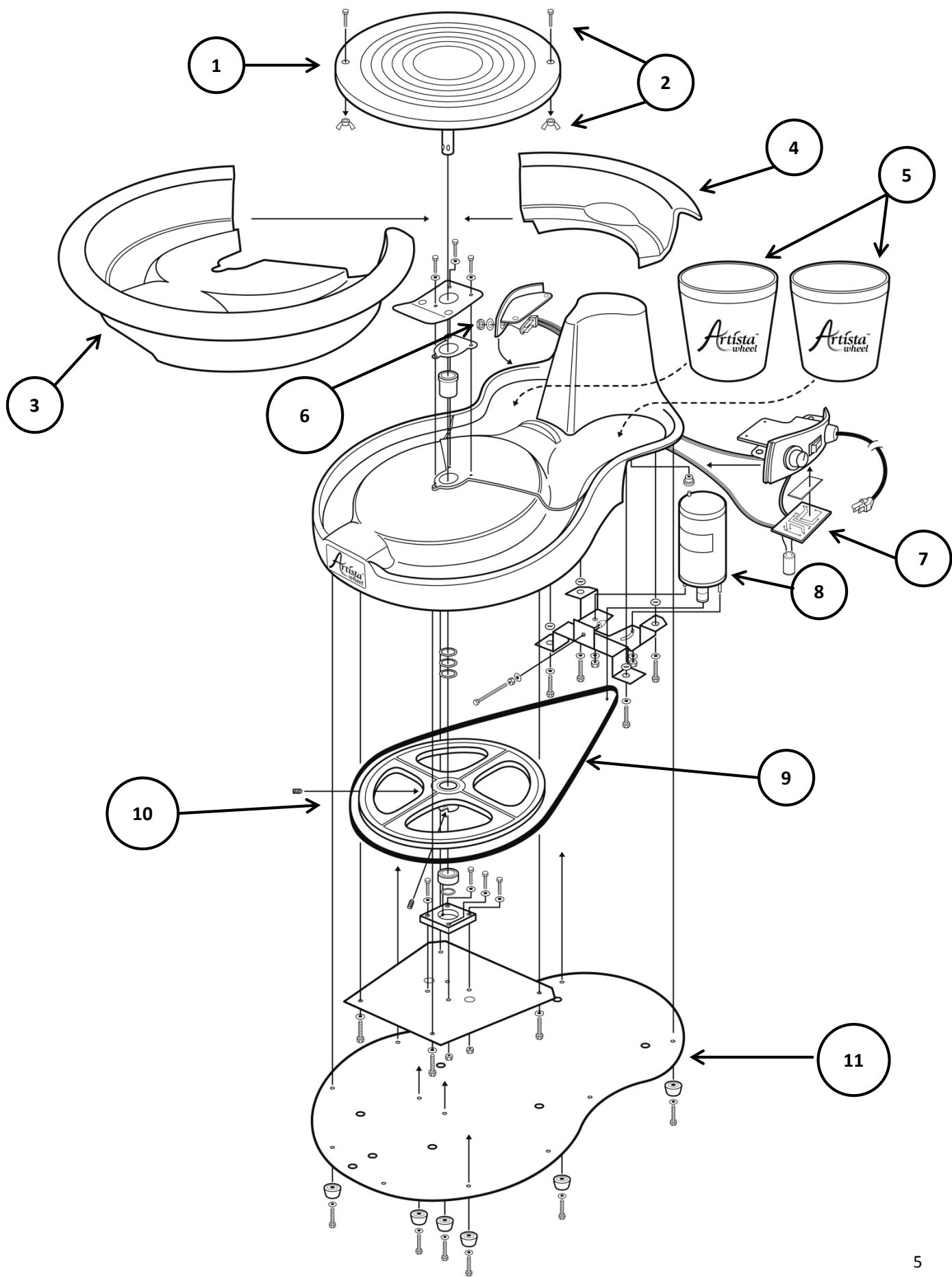

Artista™ DIAGRAM LEGEND

1. Wheel Head
2. Bat Pins (2)
3. Splash Pan (front)
4. Splash Pan (back)
5. Buckets (2)
6. Jack for (optional) Foot Pedal
7. Control Board
8. Motor
9. Belt
10. Wheel Head Pulley
11. Base Plate

See page 8 for full Artista™ Parts List.

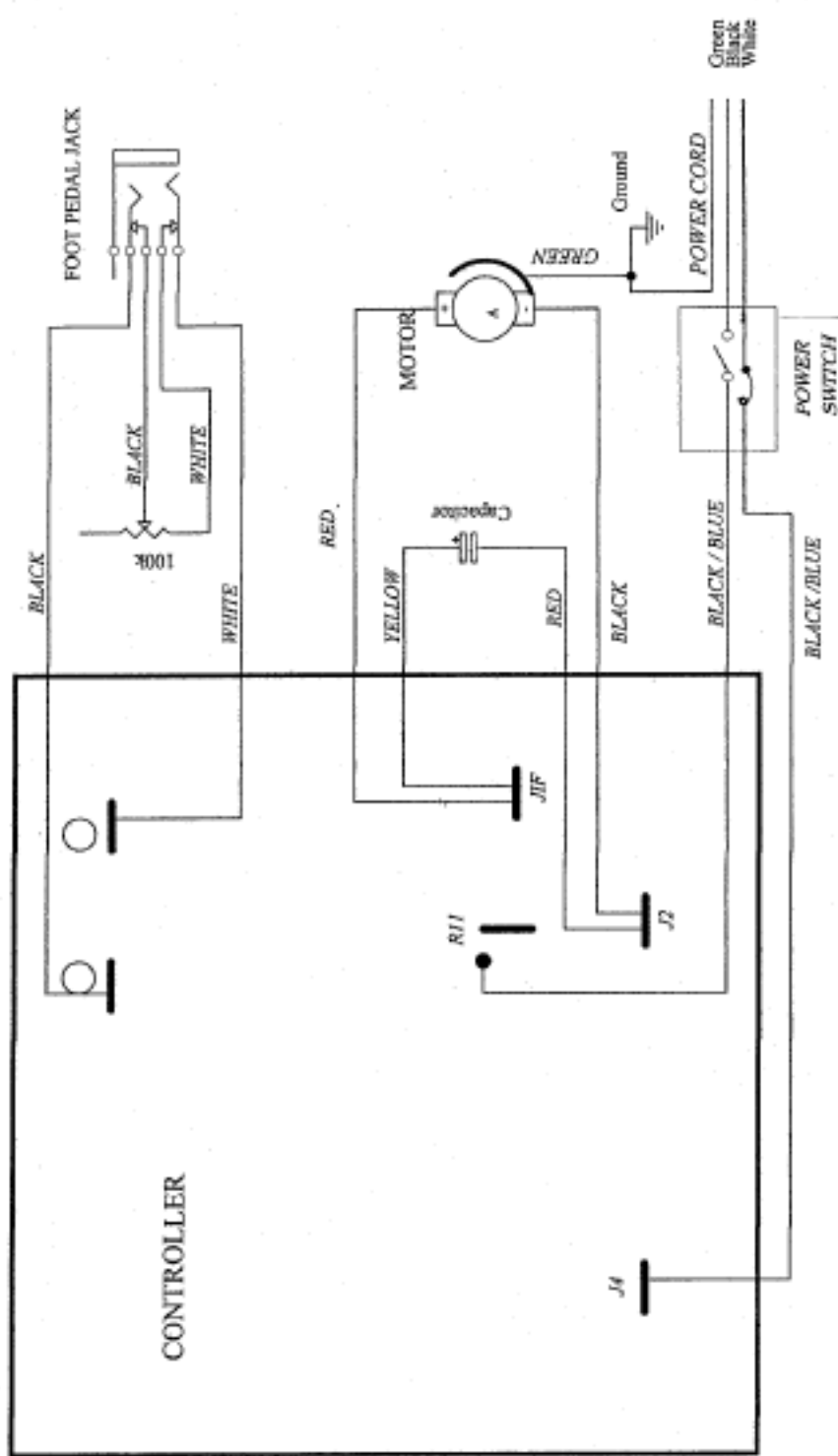

Title ARTISTA 06.30.14

Size	Number	Revision
A4	1A 401	
Date	4/1/2013	Sheet of
File	CT	

Parts List

For questions or help ordering any of the parts listed below, contact Speedball® Customer Service at **800.898.7224, Monday-Friday, 8:00am-5:00pm EST** (closed Saturdays and Sundays).

MOTORS	
Part #	Part Description
1A404N	Motor
CONTROLLERS	
1A280	Control System (Control Update)
1A407	Pot Knob
1A403	Hand Pot
1A401	Control Board
BELTS	
1A106	Belt
LEGS SETS	
STATIC_LEGS	Static Legs Set
FOLDING_LEGS	Folding Legs Set
MISCELLANEOUS	
BUCKET	Bucket
1A402	Switch

Artista™ Warranty Overview

Your Artista™ Potter's Wheel comes complete with a **2-YEAR WARRANTY** (100% parts & labor when labor performed at Speedball® Factory). Speedball® Art Products Company warrants this Speedball® pottery wheel to be free from defects in materials and workmanship under normal use and service, that would affect its operation for a period of 2 (two) years from the date of purchase.

This wheel must be registered within 30 (thirty) days of the date of purchase to make the warranty effective.

Registration can be performed either by completion of the physical Warranty Card included in wheel's shipment or online at http://speedballart.com/warranty_form2.php. The obligation of this warranty shall be limited to repairing or replacing any part of the wheel which, **at the discretion of the Company**, shall be proven defective in materials or workmanship under normal use and service during the time period commencing with the date of purchase. Full wheel replacement will be at the discretion of the Company and will only be considered for claims initiated within 30 (thirty) days of purchase.

This warranty does not apply to: (a) damage caused by accident, abuse, mishandling or dropping; (b) units which have been subject to unauthorized repair; (c) units not used in accordance with direction; (d) damage exceeding the cost of the product; (e) damage by flood, lightning or natural disaster, war declared or undeclared.

In no case shall the Company be liable for any incidental or consequential damages for breach of this or any other warranty, express or implied, whatsoever.

The limit of this warranty includes the product only and not any loss of work time or contract due to inability to use the wheel.

Parts in need of repair shall be returned by the customer, shipping prepaid, to:

**Speedball® Art Products
Repairs Department
2301 Speedball Road
Statesville, NC 28677**

After any repair or replacement, Speedball® Art Products Company will return under normal working schedule and by UPS/FedEx Ground Service (for customers in the Continental United States). Rush repair orders are accepted by purchase order and credit card payment or COD charges. Shipping charges for rush returns other than UPS/FedEx Ground Service must be prepaid via credit card or COD. No U.S. Postal returns. Be sure to wrap the product or parts securely when shipping to avoid shipping damage.

Policy Statement for Speedball® Potter's Wheel Warranties:

1. Warranty card must be on file at Speedball® Art Products Company
2. Customer must contact Speedball® Art Products Company for Return Authorization Number prior to returning the wheel. Please write the number clearly on the outside of the box.
3. Parts for warranty repair must be shipped prepaid to Speedball® Art Products Company.
4. Send entire system as a unit control box, motor, foot pedal and all power with no cut cords. Experience has shown that by sending the entire system, repairs are made the first time, made correctly and with less time and trouble for all parties concerned. Full wheel shipments for repair or replacement must be shipped in original packaging.
5. Enclose a brief description of the problem, along with your name, UPS address, phone number, email address and personal address.
6. Speedball® Art Products Company will pay UPS/FedEx Ground Service shipping back to customer.
7. Any extra charges due to a request by the customer to rush shipment are to be paid by the customer.
8. For your convenience, troubleshooting can also be conducted by phone with one of our trained Customer Service Representatives at 800.898.7224, Monday-Friday, 8:00am-5:00pm EST.

Artista™ SERIES TWO-YEAR WARRANTY

2 YEAR 100% PARTS & LABOR WARRANTY (AT THE FACTORY)

Speedball Art Products warrants this Speedball pottery wheel to be free from defects in materials and workmanship under normal use and service, that would effect its operation for a period of five years from the date of purchase.

This wheel must be registered within 30 days of date of purchase to make the warranty effective. The obligation of this warranty shall be limited to repairing or replacing any part of the wheel which, at the discretion of the company, shall be proven defective in materials or workmanship under normal use and service during the time period commencing with the date of purchase.

This warranty does not apply to: (a) damage caused by accident, abuse, mishandling, or dropping; (b) units which have been subject to unauthorized repair; (c) units not used in accordance with directions; (d) damage exceeding the cost of the product; (e) damage by flood, lightning or natural disaster, war declared or undeclared.

In no case shall the company be liable for any incidental or consequential damages for breach of this or any other warranty express or implied whatsoever.

The limit of this warranty includes the product only and not any loss of work time or contract due to inability to use the wheel.

Parts in need of repair shall be returned by customer, shipping prepaid, to Repairs Speedball Art Products, 2301 Speedball Road, Statesville, NC 28677. After any repair or replacement, Speedball Art Products will return normal working schedule and by UPS/FedEx ground service. Rush repair orders are accepted by purchase order and credit card payment or COD changes. Shipping charges for rush returns other than UPS/FedEx ground service must be prepaid via credit card or COD. No U.S. Postal returns. Be sure to wrap the product or parts securely when shipping to avoid shipping damage.

Date Purchased: _____ Serial Number: _____
KEEP THIS PORTION FOR YOUR RECORDS.

TWO-YEAR ARTISTA WARRANTY CARD - PLEASE PRINT CLEARLY

NAME/COMPANY: _____
 ADDRESS: _____
 CITY: _____ STATE: _____ ZIP: _____
 DAYTIME PHONE: () _____ DATE PURCHASED: _____
 E-MAIL ADDRESS: _____
 PURCHASED FROM: _____
 CITY: _____ STATE: _____ ZIP: _____

Please fill out this warranty card and return to Speedball Art Products within 30 days of date of purchase.

PLACE SERIAL NUMBER LABEL HERE:

PLACE
 STAMP
 HERE



Speedball.
 Pottery Equipment

2301 Speedball Road
 Statesville, NC 28677

POLICY STATEMENT FOR POTTERS' WHEEL WARRANTIES:

- Warranty card must be on file at Speedball Art Products (SAP)
- Customer must contact SAP for a Return Authorization Number prior to returning the wheel. Please write the number clearly on the outside of the box.
- Parts for warranty repair must be shipped pre-paid to Speedball Art Products.
- Send entire system as a unit control box, motor, foot pedal and all power with no cut cords. Experience has shown that by sending the entire system, repairs are made the first time, made correctly, and with less time and trouble for all parties concerned.
- Include a brief description of the problem, your name, UPS address, phone number and day time phone number, e-mail address and personal address.
- Company will pay ground shipping back to customer.
- Any extra charges due to a request by the customer to rush shipment are to be paid by the customer.
- For your convenience a trouble-shooting guide can be located on line at <http://www.speedballart.com> all 1-800-898-7224.

Date Purchased: _____ Serial Number: _____

KEEP THIS PORTION FOR YOUR RECORDS.



Speedball.
 Pottery Equipment

Rather complete online?
 Go to http://speedballart.com/warranty_form2.php

Additional Ceramics Products by Speedball® Art Products

At Speedball® Art Products, we're about more than *just* manufacturing high quality pottery wheels at a value—we're about offering a full range of professional grade ceramics glazes, tools & accessories at an unbeatable price!

Speedball® Glazes & Underglazes

Used exclusively by a range of internationally renowned and emerging artists alike, Speedball's Earthenware and Underglaze lines offer the same high quality experience of the top glazes on the market at an unmatched value. Ideal for any studio or classroom,

Speedball® Glazes & Underglazes:

- Work well on a wide range of surfaces and across techniques;
- Are lead-free and carry the AP Seal (all colors);
- Create reliable and consistently stunning results;

In addition, our high quality lines offer artists an unprecedented value. When compared to other popular brands of glazes & underglazes:

- Speedball® Earthenware Glazes will save artists and teachers an average of nearly 45%
- Speedball® Underglazes save artists and teachers an average of nearly 30%



*Works by Kevin Snipes (left),
Jessica Putnam Phillips (right), & Theo Uliano (bottom)*
Created with Speedball Speedball® Glazes & Underglazes

Additional Ceramics Products by Speedball® Art Products

At Speedball® Art Products, we're about more than *just* manufacturing high quality pottery wheels at a value—we're about offering a full range of professional grade ceramics glazes, tools & accessories at an unbeatable price!

Speedball® Plastic Bats

You won't believe what your studio's been missing! Offering artists the ultimate in performance, organization and convenience, our multi-colored plastic bats are a must-have for any potter's studio. **Available in three sizes** (7.5" square, 12" round and 14" round) across five colors (Red, Orange, Blue, Green, Brown), Speedball® Bats suit a wide range of projects and their universal bat pin spacing ensures a solid fit, no matter the wheel. **Speedball® Bats' "Easy Lift Rim™" allows them to be removed from the wheel head in one fluid, slip-free motion**, keeping your artwork undisturbed. A heavy-duty plastic construction **eliminates warping, wearing and molding**, and the unique ribbed design **increases strength**. In addition, the line's multiple colors allows artist and educators to keep like-clay bodies organized to avoid firing mishaps while affording maximum space efficiency in storage.



Speedball® Wooden Bats

Using the same formula combining high quality with value, Speedball is proud to offer a new line of **Masonite® & Medex® bats**. **Masonite® Bats** offer the most affordable alternative to other types of bats (e.g. plaster & bisque) while still allowing artists to easily remove projects from the wheel head and after drying. (All sizes shown below are 1/4" thick). **Medex® Bats** offer the greatest durability of all wooden bats with very limited warping or chipping. This bat is an ideal alternative for potters who prefer to work on wooden bats, but who enjoy the longevity offered by plastic bat alternatives. (All sizes shown below are 3/8" thick)

Masonite™
available in
12", 14" and
15" round



Medex™
available in
12", 14" and
16" round



Artista™ Potter's Wheel



www.speedballart.com