

SSV KIT - Rear Winch Bumper

Part number (SKU) : 715003782,715004130,715005123

Product:	SSV
Project no:	487802239
Instruction Sheet P/N:	487802239
Revision no:	
Revision date:	
Item covered:	Rear Winch Bumper

INSTALLATION INSTRUCTIONS



REAR WINCH BUMPER

DISCLAIMER

We stand behind all products fabricated by S3 Power Sports. We are not responsible nor do we accept liability for breakage or failure of parts as a result of rugged off-road use. Vehicle modifications are done at your own risk, and we do not accept any responsibility for damages caused by vehicle modifications. Modification and some aftermarket parts may void factory warranty. S3 Power Sports is not liable for damages to user or equipment as a result of vehicle modifications. Modifications to vehicles may create dangerous situations and are done at the risk of the user. The user hereby expressly assumes all risks associated with any such modifications made by or parts sold by S3 Power Sports. S3 Power Sports and parts sold by S3 Power Sports are for off-road use only.

⚠ WARNING

- For safety reasons, this kit must be installed by an authorized BRP dealer.
- This kit is designed for specific applicable models only (authorized BRP dealers will confirm model(s)). It is not recommended for units other than the one (those) for which it was sold.
- Torque wrench tightening specifications must strictly be adhered to.
- Should removal of a locking device (e.g. lock tabs, self-locking fasteners, etc.) be required when undergoing disassembly/assembly, always replace with a new one
- Some components may be HOT. Always wait for engine to cool down before performing work.
- Always wear EYE PROTECTION AND APPROPRIATE GLOVES when using power tools.
- Unless otherwise specified, engine must be OFF when performing any operation on the vehicle.
- Always be aware of parts that can move, such as wheels, transmission components, etc.
- Rear bumper will limit cargo bed dump angle depending upon tire diameter and hitch ball mounting.
- DO NOT operate vehicle while cargo bed is in dump position in conjunction with this rear bumper.

NOTE: The illustrations in this document show typical construction of the different assemblies and may not reproduce the full detail or exact shape of the parts; however, they represent parts that have the same or similar function.

Installation time is approximately 1.0 hours.

FASTENER TYPE	TIGHTENING TORQUES TO BE USED WHEN TORQUES ARE NOT SPECIFIED IN TEXT			
	5.8 GRADE	8.8 GRADE	10.9 GRADE	12.9 GRADE
M4	1.8 ± 0.2 N•m (16 ± 2 lbf•in)	2.8 ± 0.2 N•m (25 ± 2 lbf•in)	3.8 ± 0.2 N•m (34 ± 2 lbf•in)	4.5 ± 0.5 N•m (40 ± 4 lbf•in)
M5	3.3 ± 0.2 N•m (29 ± 2 lbf•in)	5.0 ± 0.5 N•m (44 ± 4 lbf•in)	7.8 ± 0.7 N•m (69 ± 6 lbf•in)	9.0 ± 1.0 N•m (80 ± 9 lbf•in)
M6	7.5 ± 1.0 N•m (66 ± 9 lbf•in)	10.0 ± 2.0 N•m (89 ± 18 lbf•in)	12.8 ± 2.2 N•m (113 ± 19 lbf•in)	16.0 ± 2.0 N•m (142 ± 18 lbf•in)

FASTENER TYPE	TIGHTENING TORQUES TO BE USED WHEN TORQUES ARE NOT SPECIFIED IN TEXT			
	5.8 GRADE	8.8 GRADE	10.9 GRADE	12.9 GRADE
M8	15.3 ± 1.7 N•m (135 ± 15 lbf•in)	24.5 ± 3.5 N•m (18 ± 3 lbf•ft)	31.5 ± 3.5 N•m (23 ± 3 lbf•ft)	40.0 ± 5.0 N•m (30 ± 4 lbf•ft)
M10	29 ± 3 N•m (21 ± 2 lbf•ft)	48 ± 6 N•m (35 ± 4 lbf•ft)	61 ± 9 N•m (45 ± 7 lbf•ft)	73 ± 7 N•m (54 ± 5 lbf•ft)
M12	52 ± 6 N•m (38 ± 4 lbf•ft)	85 ± 10 N•m (63 ± 7 lbf•ft)	105 ± 15 N•m (77 ± 11 lbf•ft)	128 ± 17 N•m (94 ± 13 lbf•ft)
M14	85 ± 10 N•m (63 ± 7 lbf•ft)	135 ± 15 N•m (100 ± 11 lbf•ft)	170 ± 20 N•m (125 ± 15 lbf•ft)	200 ± 25 N•m (148 ± 18 lbf•ft)
M16	126 ± 14 N•m (93 ± 10 lbf•ft)	205 ± 25 N•m (151 ± 18 lbf•ft)	255 ± 30 N•m (188 ± 22 lbf•ft)	305 ± 35 N•m (225 ± 26 lbf•ft)
M18	170 ± 20 N•m (125 ± 15 lbf•ft)	273 ± 32 N•m (201 ± 24 lbf•ft)	330 ± 25 N•m (243 ± 18 lbf•ft)	413 ± 47 N•m (305 ± 35 lbf•ft)

PARTS LIST

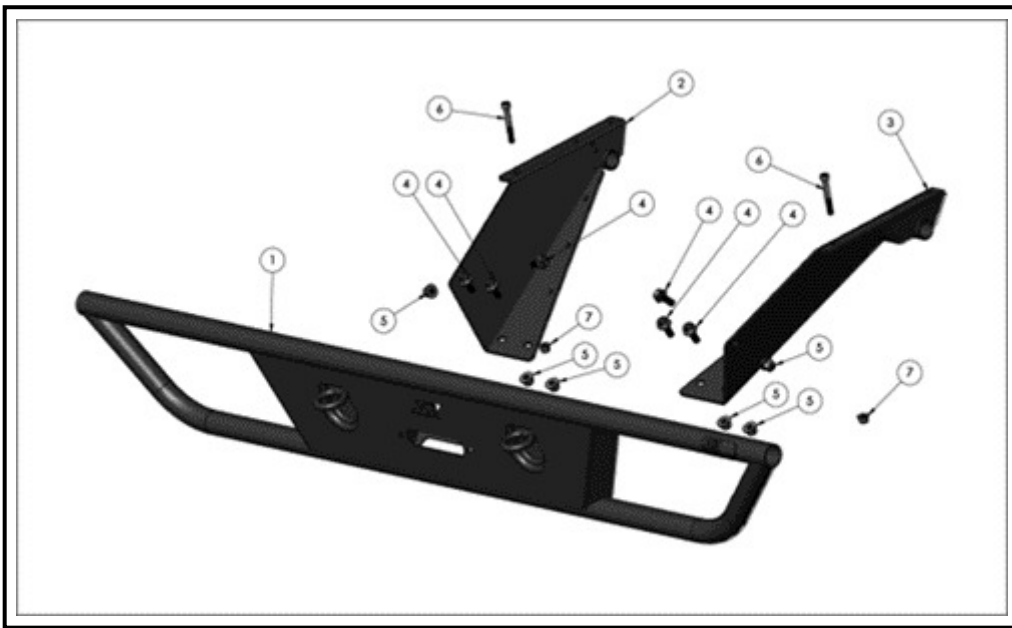

ITEM	DESCRIPTION	QTY
01	Tube Bumper Rear	1
02	Left Flat Plate Bumper Mount	1
03	Right Flat Plate Bumper Mount	1
04	Bolt Kit	
05	10 x 1.5 x 25 10mm Flange Bolt	6
06	10 x 1.5 Nylock Flange Nuts	6
07	8 x 1.25 x 60mm Allen Head Bolts	2
07	8mm x 1.25 Nylock Flange Nuts	2

TOOLS REQUIRED:

- Drill
- Drill bits (1/2" & 5/16")
- 17mm socket
- 17mm wrench
- 3/8" ratchet
- 13mm socket
- 1/4" allen wrench

INSTALLATION

1. Start by tilting the bed up and removing the factory bed support. Lower the bed back down and latch into place. Remove the four 13mm nuts holding the bed to the frame. Lift the bed up and slide the swivel bracket off the frame mount. Repeat this process for the other side.
2. Install the left bumper bracket (02) by lifting the bed and placing the bracket into position. Repeat this process for the other side (03). Tighten the factory hardware to secure the bed.

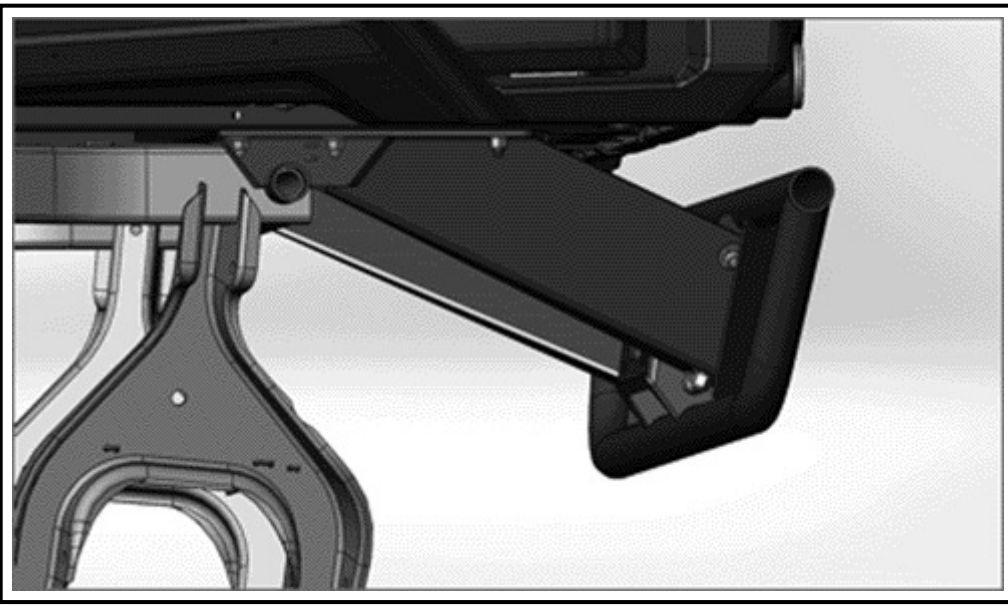

FIGURE A

3. Figure B - Install winch before moving on to the next step.

4. Figure B - Place the back section of the bumper (01) onto the previously installed brackets, securing the 10-25mm (04) bolts on each side with 10 x 1.5 nylock flange nuts (05). The previously installed brackets should be on the outside of the bracket on the back bumper section.

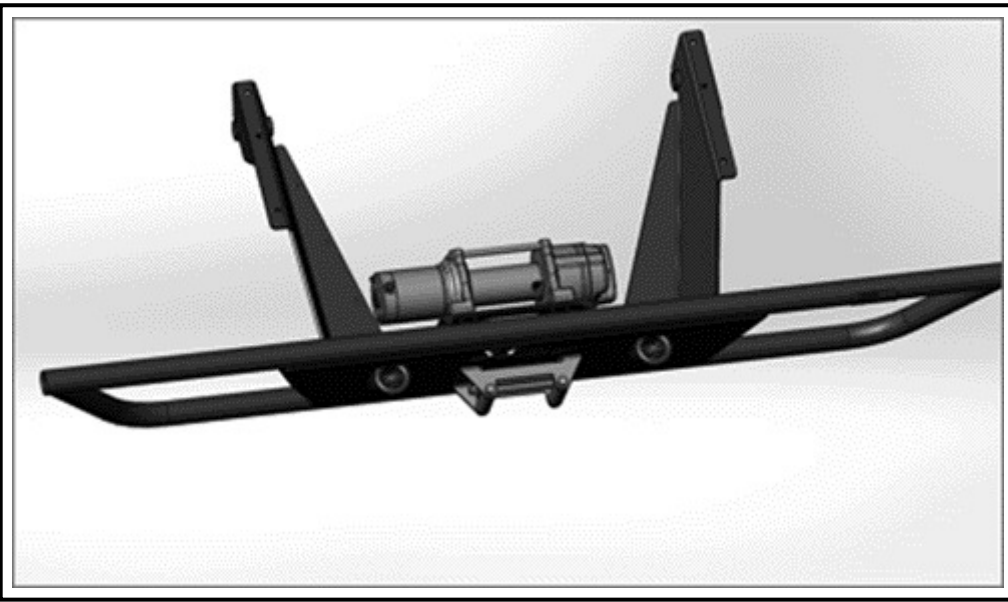

FIGURE B

5. Figure C (same as A) - Locate the back bumper bracket hole on the brackets connected to bed. Using a 5/16" drill bit, create a pilot hole. Take a 1/2" drill bit from the topside of the bed and drill through the plastic floor BUT NOT THE FACTORY BED FRAME RAILS. This allows access to install the socket head bolts (06) with the 8mm 1.25 nylock flange nuts (07). Tighten all bolts to ensure proper strength. Reattach the bed support.

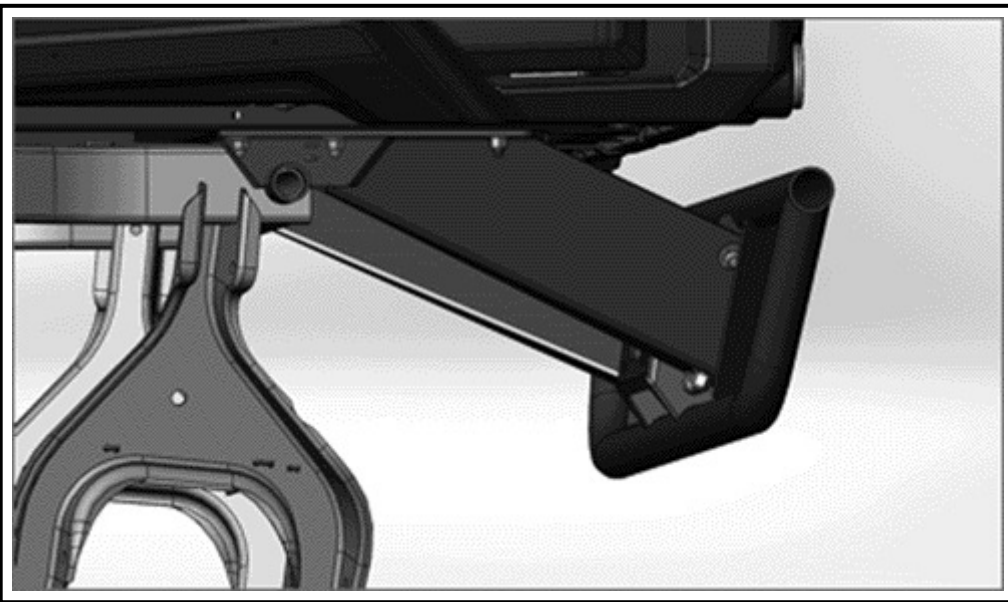

FIGURE C



FIGURE D

