

Thank you for purchasing this fine quality made in America product. When properly assembled and installed, your racking will complement your wine collection for many years to come. To ensure proper assembly please ascertain that all necessary parts have been included and follow the instructions closely. If you have any questions or problems please call us (845)658-7181, Monday through Friday 9am to 5 pm EST.

#### Tools For Assembly:



If you are planning to stain or finish your racking we recommend you do so BEFORE assembly for best results.



## PARTS LIST

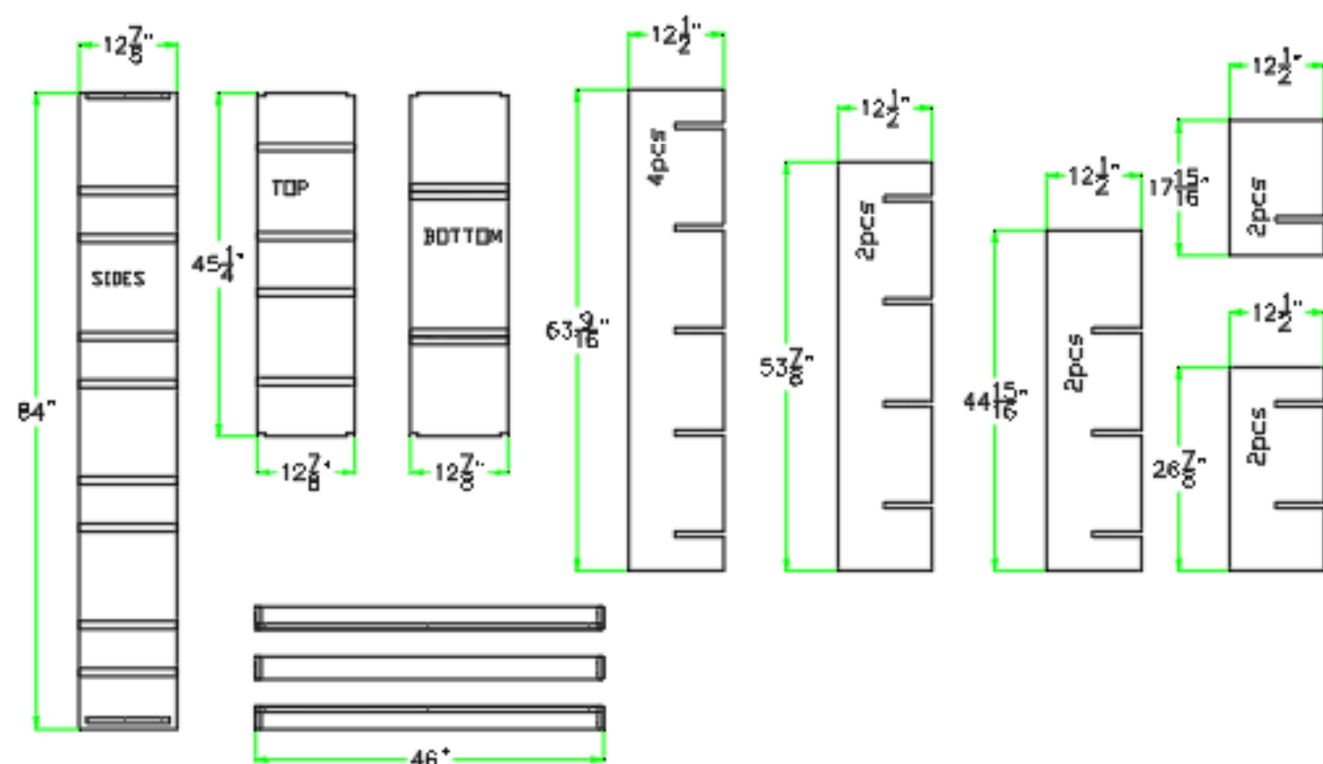

# PACKAGE CONTENTS

SKU	PRODUCT NAME	SIDES	SHELVES	CLEATS	SCREWS
6_5-251-4600-8400-D	Retail Compound Diamond Bin	2	14	10	134

\*Note: Please verify that you have the correct number of parts before proceeding.

## PLEASE FOLLOW WRITTEN INSTRUCTIONS CAREFULLY

1. Find an open, flat area in which to assemble your racking. Carefully remove all components from the box and check all parts to verify package contents.

2. Attach the sides to the top and bottom using supplied screws. Be sure to align them correctly so the shelves can be installed.

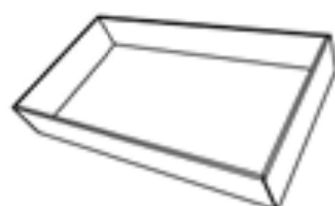

3. On one side, install the back cleats using screws provided. Top & bottom or left and right cleats fit against top & bottom or sides. Flip over when done.

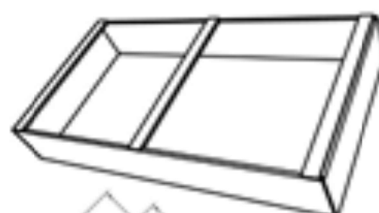

4. On opposite side, install lattice shelves. The shelves are sized to have a snug fit.

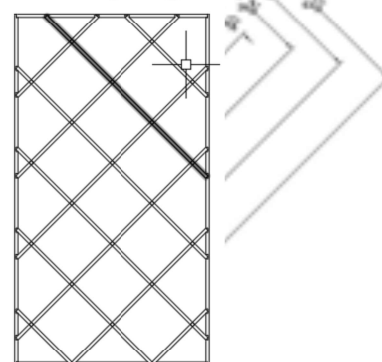
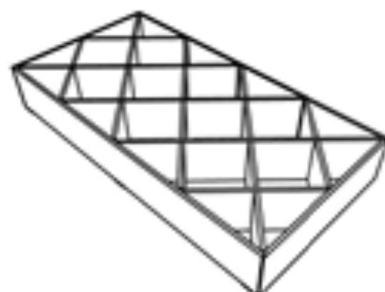

5. Assemble and install display shelves.



TO ASSEMBLE SINGLE DISPLAY SHELVES, SCREW SUPPORT TRIANGLE TO SHELF SIDE USING PROVIDED SCREWS. REAR OF TRIANGLE SHOULD BE FLUSH WITH REAR OF SHELF.

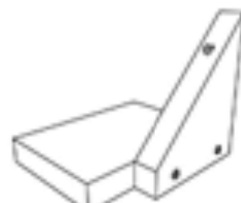

TO ATTACH TO THE RACK, SCREW THE ASSEMBLED SHELF TO THE DESIRED RAIL THROUGH THE PILOT HOLE, USING PROVIDED SCREWS. THE SHELF SHOULD LAY ON TOP OF THE SPACER BAR AND MAY BE NAILED OR SCREWED IF GREATER SUPPORT IS NEEDED.

6. If purchased, finish rack by attaching face trim and stand.

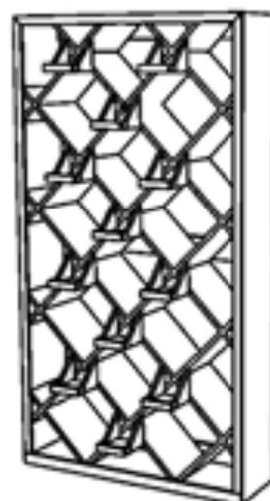

\* Tip: Use glue sparingly

\*Note: For more stability attach racks to wall.