

NOTES: UNLESS OTHERWISE SPECIFIED

- 1. CLEARANCE REQUIRED FOR FREE MOTION OF SYSTEM.
 - 2. O-RING USED FOR SEALING SYSTEM TO MOUNTING STRUCTURE. STANDALONE UNIT MEETS IPX6 SEALING SPECIFICATION. MINIMUM MOUNTING SURFACE FLATNESS OF 1.5mm [0.060in] OVER SYSTEM DIAMETER REQUIRED FOR O-RING USE. WHEN MOUNTING TO IRREGULAR SURFACES, USE OF BEDDING COMPOUND RECOMMENDED.
 - 3. USE WITH FLIR MOUNTING HARDWARE KITS
 - 4. USE LOCTITE 262 WITH ALL METAL TO METAL THREADED CONNECTIONS THAT DO NOT HAVE LOCKING PATCHES.
 - 5. **WARNING**
DO NOT BOTTOM FASTENERS IN BASE.
BOLT LENGTH NOT TO EXCEED 6MM INTO BASE.
ELECTRONICS WILL BE DAMAGED BY BASE PENETRATION - VOIDING WARRANTY.
BOLT TORQUE NOT TO EXCEED 4.5N-m [3.3 lb-ft].
 - 6. **NON-STANDARD PAINT NOTICE:** FOR CUSTOMERS WHO CONSIDER SECONDARY PAINTING OF THE CAMERA ASSEMBLY BE AWARE OF THE FOLLOWING CONCERNS:
 - A. SECONDARY PAINT PUTS THE CAMERA WARRANTY AT RISK. SINCE THE CAMERA PAINT IS PART OF THE CAMERA DESIGN, A CHANGE IN PAINT IS A CHANGE IN CAMERA DESIGN WHICH MAY AFFECT CAMERA PERFORMANCE AND RELIABILITY.
 - B. PAINT COLOR CAN SIGNIFICANTLY AFFECT CAMERA INTERNAL TEMPERATURE. DARKER COLORS GENERALLY ABSORB HEAT TO A GREATER DEGREE COMPARED TO LIGHT COLORS. INTERNAL CAMERA TEMPERATURES AFFECT PERFORMANCE AND RELIABILITY.
 - C. FOR THOSE WHO STILL CHOOSE TO PAINT THE CAMERA, INSURE SECONDARY PAINT DOES NOT BLOCK AIRFLOW AROUND THE FLIR LOGO. THERE ARE MOISTURE BARRIER, PRESSURE RELIEF VALVES UNDER THE LOWER FLIR ICONS WHICH SHOULD MAINTAIN AIRFLOW PATHWAYS FOR PROPER FUNCTION.
- ANY FURTHER CONCERNS IN THIS REGARD CONTACT FLIR TECHNICAL SUPPORT.

M400

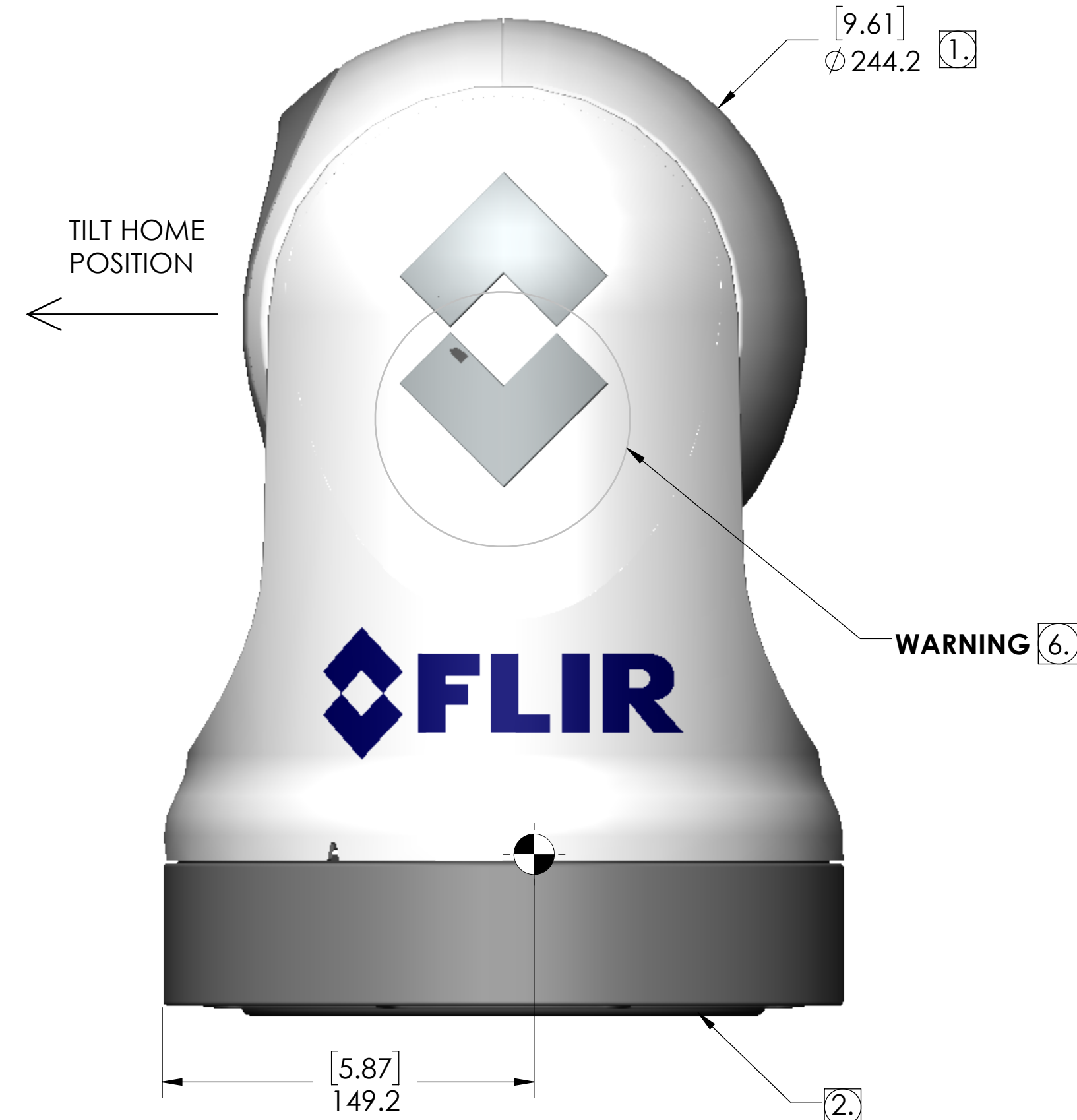
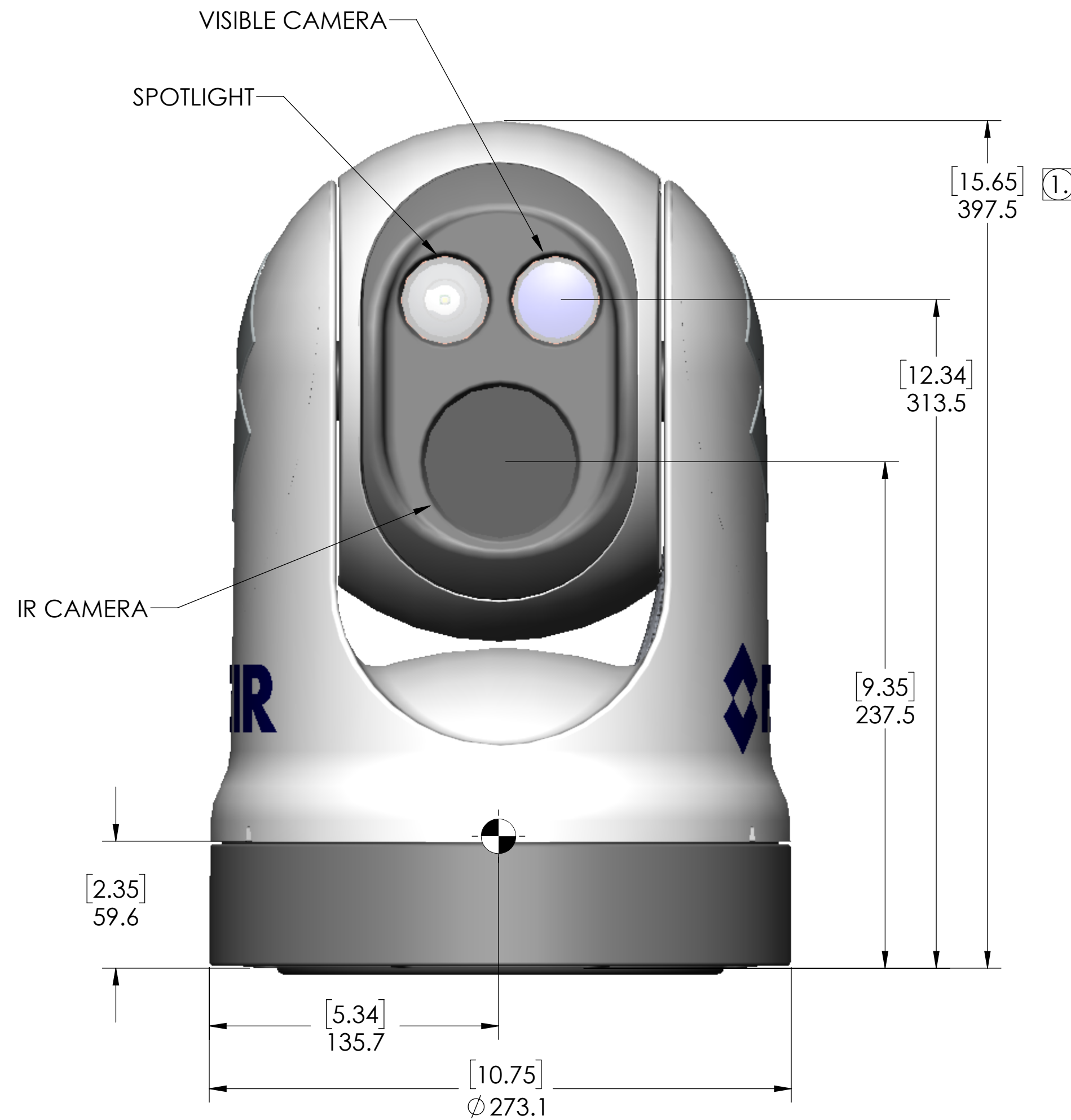

AS568A-436 EPDM O-RING
[5.85in ID x .275in DIA]
149mm ID x 7mm DIA

AS658A-444 EPDM O-RING
[7.72in ID x .275in DIA]
196mm ID x 7mm DIA

[8.86] 225.0 MIN BASE PLATE DIAMETER FOR EFFECTIVE O-RING SEAL

6X M6X1.0 10 3

WARNING 5

CABLE PORT DIMENSIONS DEPEND ON MOUNTING SOLUTION AND CABLE TYPE. SEE SHEETS 2 AND 3 FOR DETAILS.

[7.09] 180.0 BOLT CIRCLE

WARRANTY VOID IF SCREWS REMOVED

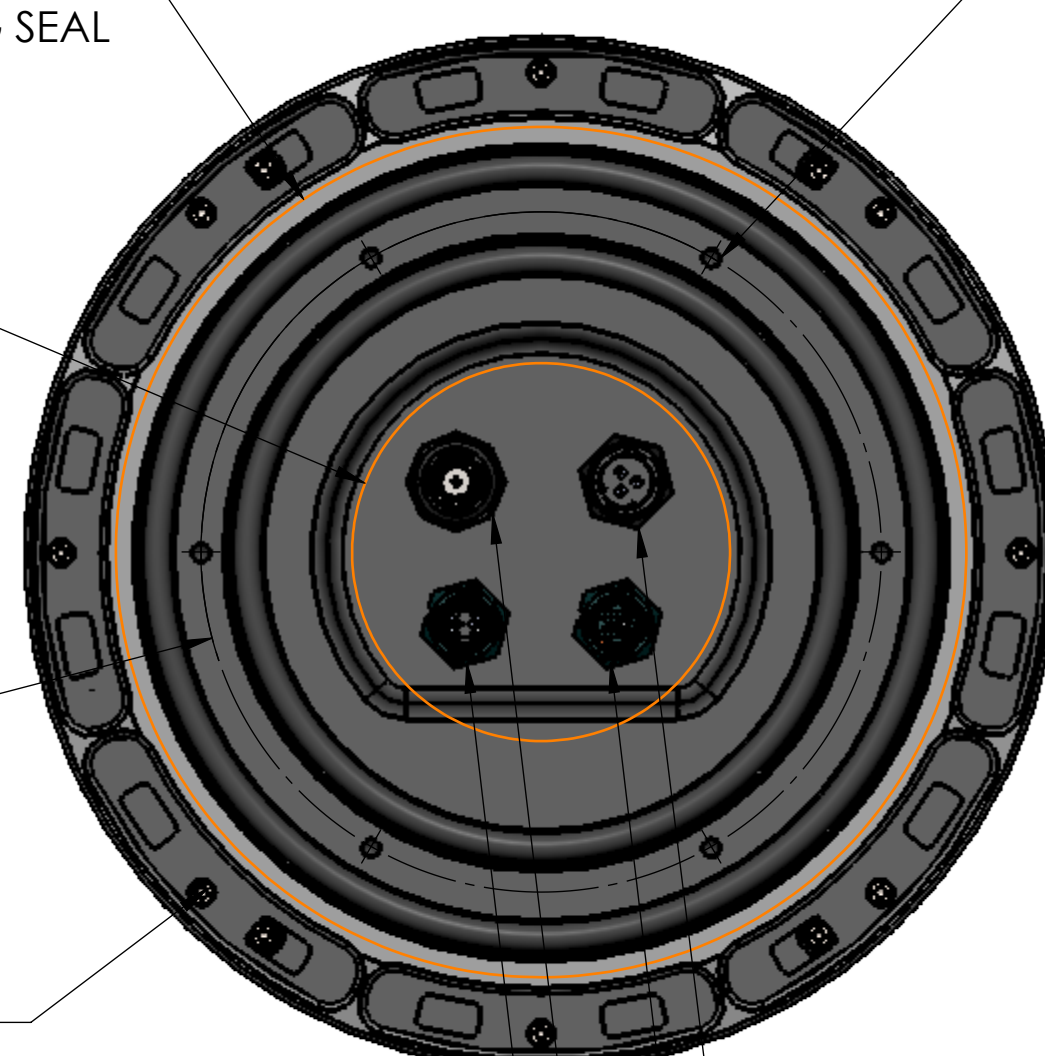

- POWER CONNECTOR
- ANALOG VID AND SERIAL CONNECTOR
- HD/SDI BNC CONNECTOR
- ETHERNET CONNECTOR

PAN HOME POSITION

PARALLEL TO BASE CUP FLAT

THIRD ANGLE PROJECTION		THIS DOCUMENT DOES NOT CONTAIN EXPORT-CONTROLLED INFORMATION			
		<small>© 2020 FLIR Systems, Inc. All rights reserved worldwide. No parts of this manual, in whole or in part, may be copied, photocopied, translated, or transmitted to any electronic medium or machine readable form without the prior written permission of FLIR Systems, Inc. Names and marks appearing on the products herein are either registered trademarks or trademarks of FLIR Systems, Inc. and/or its subsidiaries. All other trademarks, trade names, or company names referenced herein are used for identification only and are the property of their respective owners. This product is protected by patents, design patents, patents pending, or design patents pending. The contents of this document are subject to change.</small>			
METRIC INTERPRET DRAWING PER ASME Y14.5M-1994 UNLESS OTHERWISE SPECIFIED SURFACE ROUGHNESS 0.8um X = ±.25 XX = ±.13 ANGULAR = ±.5° FILLET RADII = .13 MAX		MATERIAL N/A	PROJECT NO. APPROVALS DATE DWN K. MONCINO 5/7/2015 CHK		FLIR Systems, Inc. 6769 Hollister Drive Goleta, CA 93117
		FINISH N/A	TITLE M400 ICD	SIZE D 064Y2	DWG NO. 432-0012-XX-19 REV 100
		UNLESS OTHERWISE SPECIFIED ALL MEASUREMENTS ARE IN MM. ALL DIMENSIONS IN () ARE INCHES. DO NOT SCALE DRAWING.	DSGN ENG APP	SCALE 1:1 PRINTED: 9/18/2020 SHEET 1 OF 10	SOLIDWORKS MODEL: 432-0012-XX-YY TOP LEVEL ASSEMBLY, M400 MODEL REVISION: J
		CALC WT: 24668.290 g GRAMS			

IMPORNTANT NOTE:

PAPER SIZE: 22x34in
TEMPLATE SHOULD PRINT 1:1

DUE TO VARIATION IN SOFTWARE AND PRINTERS, PLEASE
VERIFY SCALE BELOW BEFORE MODIFYING MOUNTING
SURFACE.

ENSURE PRINTER MARGINS ARE SET TO ZERO AND SCALE
IS 100%

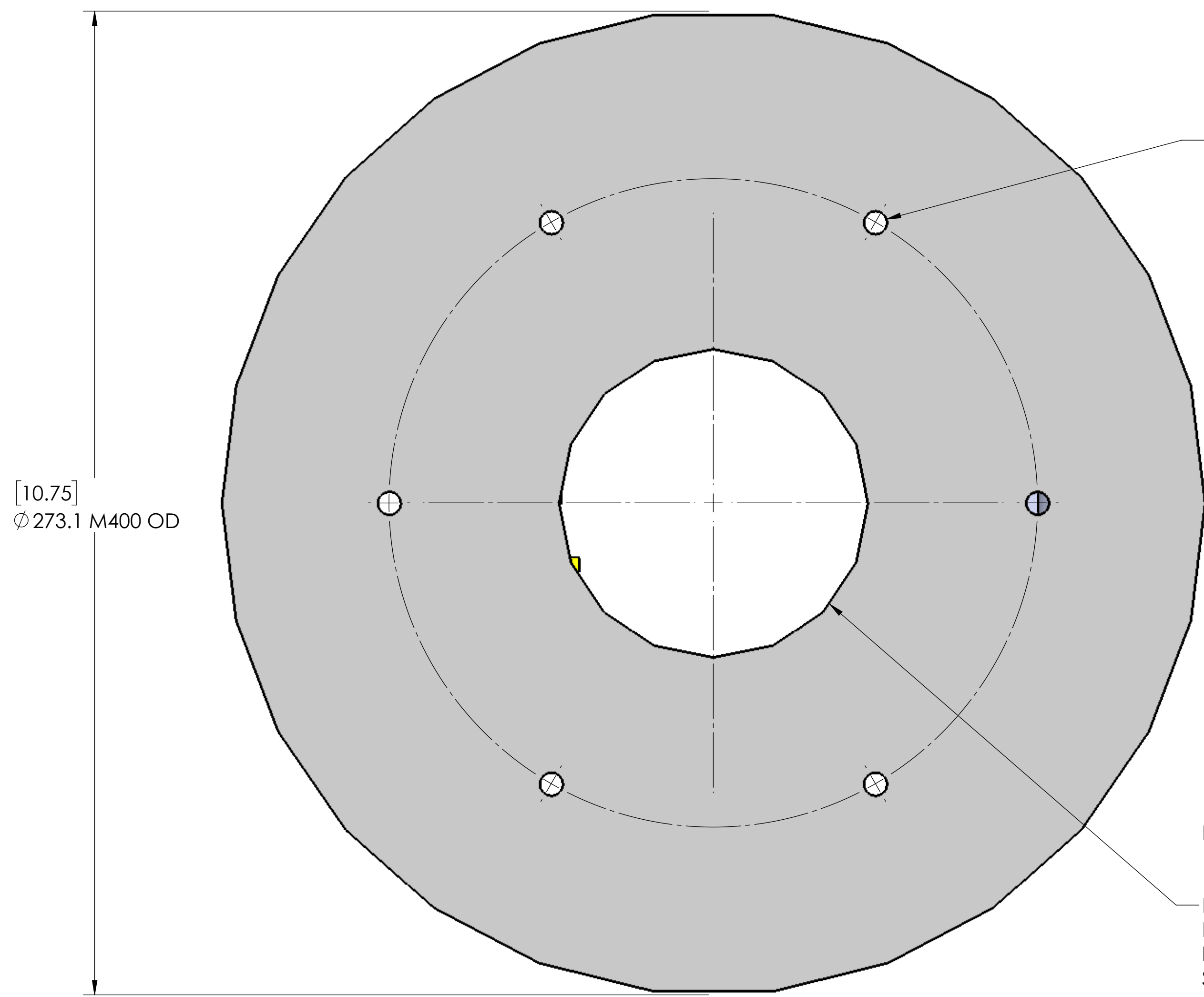
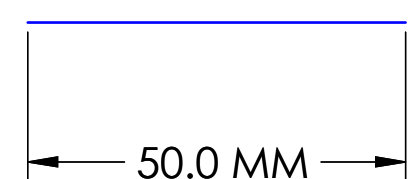
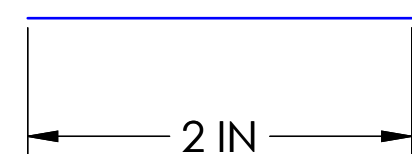

[.25]
6X ϕ 6.4 THRU HOLE
EQUALLY SPACED ON
 ϕ 180 [7.09] BOLT CIRCLE

DECK PORT CABLE CLEARANCE
 ϕ 85.7 [3 3/8] MIN
 ϕ 130.0 [5.12] MAX
RIGHT ANGLED CABLES NOT RECOMMENDED
FOR MOUNTING SURFACES >10MM THICK.
IF MOUNTING SURFACE IS >10MM THICK, USE
STRAIGHT CABLES OR MOUNT TO TOP DOWN RISER

[10.75]
 ϕ 273.1 M400 OD

D

D

C

C

B

B

A

A

BASE CUP MOUNTING TEMPLATE

M400 ICD

METRIC

© 2020, FLIR Systems Inc. - All Rights Reserved



FLIR Systems, Inc.
6769 Hollister Ave.
Goleta, CA 93117

SIZE D	CAGE 064Y2	PIECE PART 432-0012-XX-19	REV 100
SCALE 1:1	PRINTED 9/18/2020	SHEET 2 OF 10	

SOLIDWORKS MODEL: 432-0012-XX-YY TOP LEVEL ASSEMBLY, MARLIN
MODEL REVISION: J

IMPORNTANT NOTE:

PAPER SIZE: 22x34in
TEMPLATE SHOULD PRINT 1:1

DUE TO VARIATION IN SOFTWARE AND PRINTERS, PLEASE
VERIFY SCALE BELOW BEFORE MODIFYING MOUNTING
SURFACE.

ENSURE PRINTER MARGINS ARE SET TO ZERO AND SCALE
IS 100%

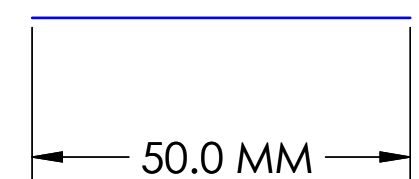
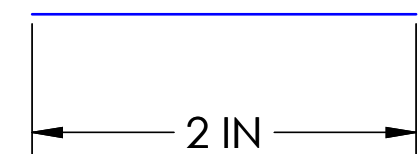

[12.74]
Ø 323.7
TOP DOWN RISER O.D.

[5.88]
R149.2
TOP DOWN RISER BOLT CIRCLE

[.32]
6X Ø 8.2 RISER CLEARANCE HOLES
RECOMMENDED:
M8 SOCKET HEAD CAP SCREWS, OR
5/16" - 18 SOCKET HEAD CAP SCREWS, OR
5/16" - 18 HEX HEAD SHEET METAL SCREWS
TYPE AND LENGTH DEPENDANT ON MOUNTING SURFACE
316 STAINLESS STEEL
APPLY THREAD LOCKER (LOCTITE 262 OR EQUIVALENT)

[4.79]
Ø 121.6 RISER CABLE CLEARANCE HOLE
RECOMMENDED DECK PORT:
Ø 30.0 [1.18] MIN
Ø 130.0 [5.12] MAX

[7.09]
Ø 180.0
MARLIN BASE CUP HOLE CIRCLE

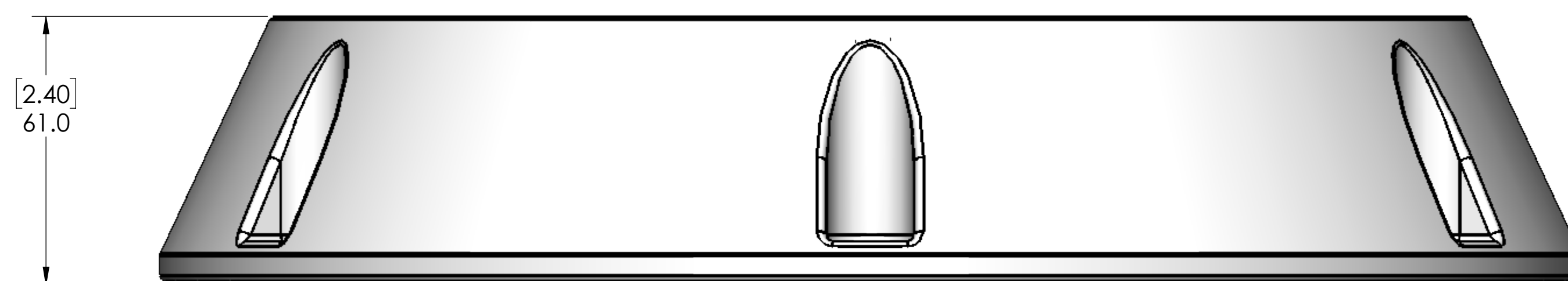

TOP DOWN RISER MOUNTING TEMPLATE

M400 ICD

METRIC

© 2020, FLIR Systems Inc. - All Rights Reserved



FLIR Systems, Inc.
6769 Hollister Ave.
Goleta, CA 93117

SIZE D	CAGE 064Y2	PIECE PART 432-0012-XX-19	REV 100
SCALE 1:1		PRINTED: 9/18/2020	SHEET 3 OF 10

SOLIDWORKS MODEL: 432-0012-XX-YY TOP LEVEL ASSEMBLY, MARLIN
MODEL REVISION: J

D

C

B

A

D

C

B

A

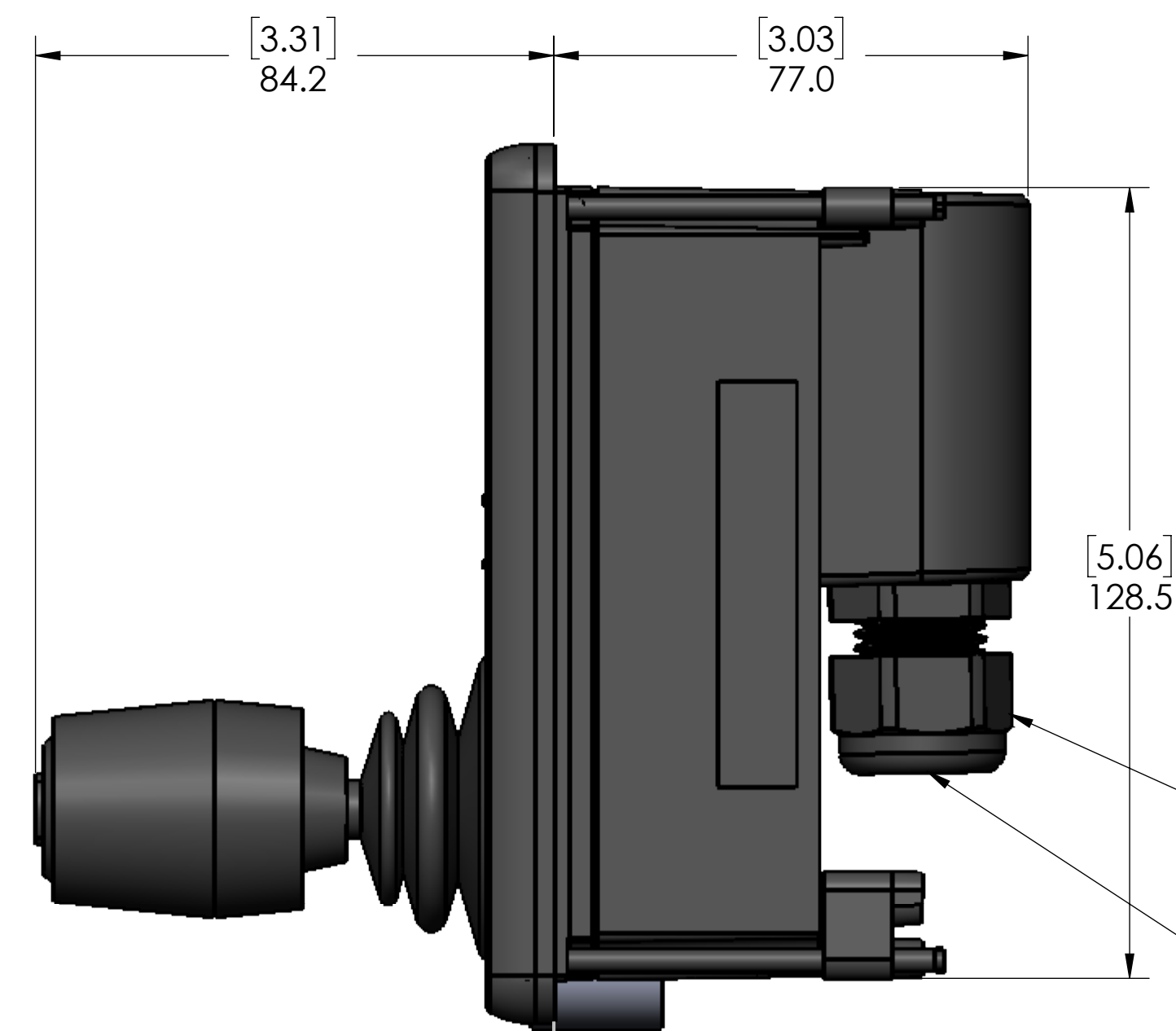
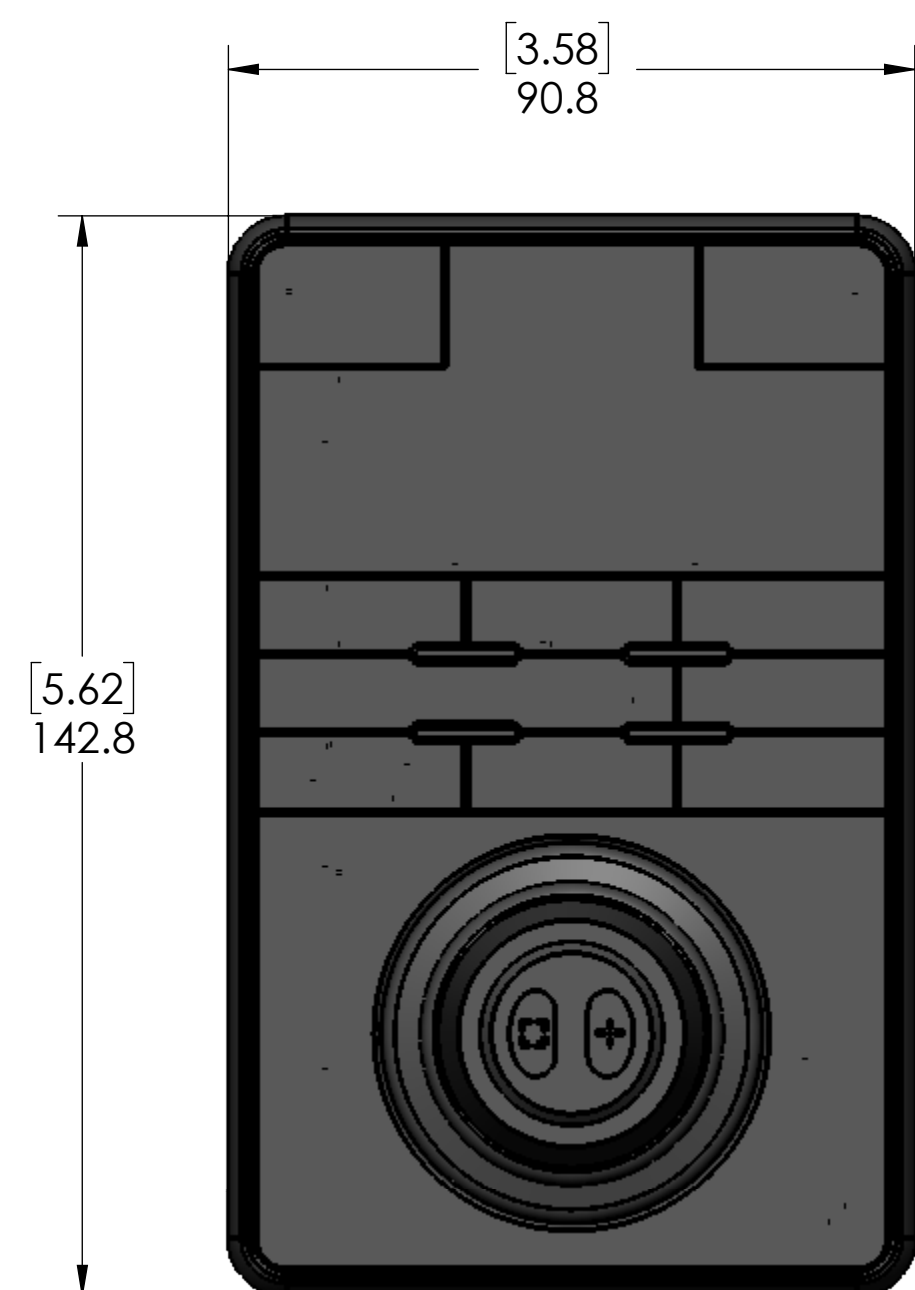

IP66 RATED ABOVE GASKET.

IP64 RATED BEHIND GASKET.

WITH CABLE INSTALLED, TURN NUT 1/4 TURN BEYOND HAND TIGHT.

GLAND SEAL DESIGNED FOR USE WITH DOUBLE SHIELDED CAT 5 ETHERNET CABLE. USE OF SINGL SHIELDED CABLE MAY REQUIRE THE USE OF ADDITIONAL SEALANT SUCH AS SILICON OR RTV TO ENSURE SEALING OF ENCLOSURE

INSERT NETWORK CABLE RJ45 THROUGH GLAND NUT AND SEAL BEFORE INSTALLING

APPLY ADHESIVE SIDE OF GASKET TO JCU BODY.

MOUNTING PANEL THICKNESS RANGE 1.6-45 [0.036-1.750]. WHEN MOUNTING TO PANEL LESS THAN 6.3 [0.25] REVERSE PADDLES.

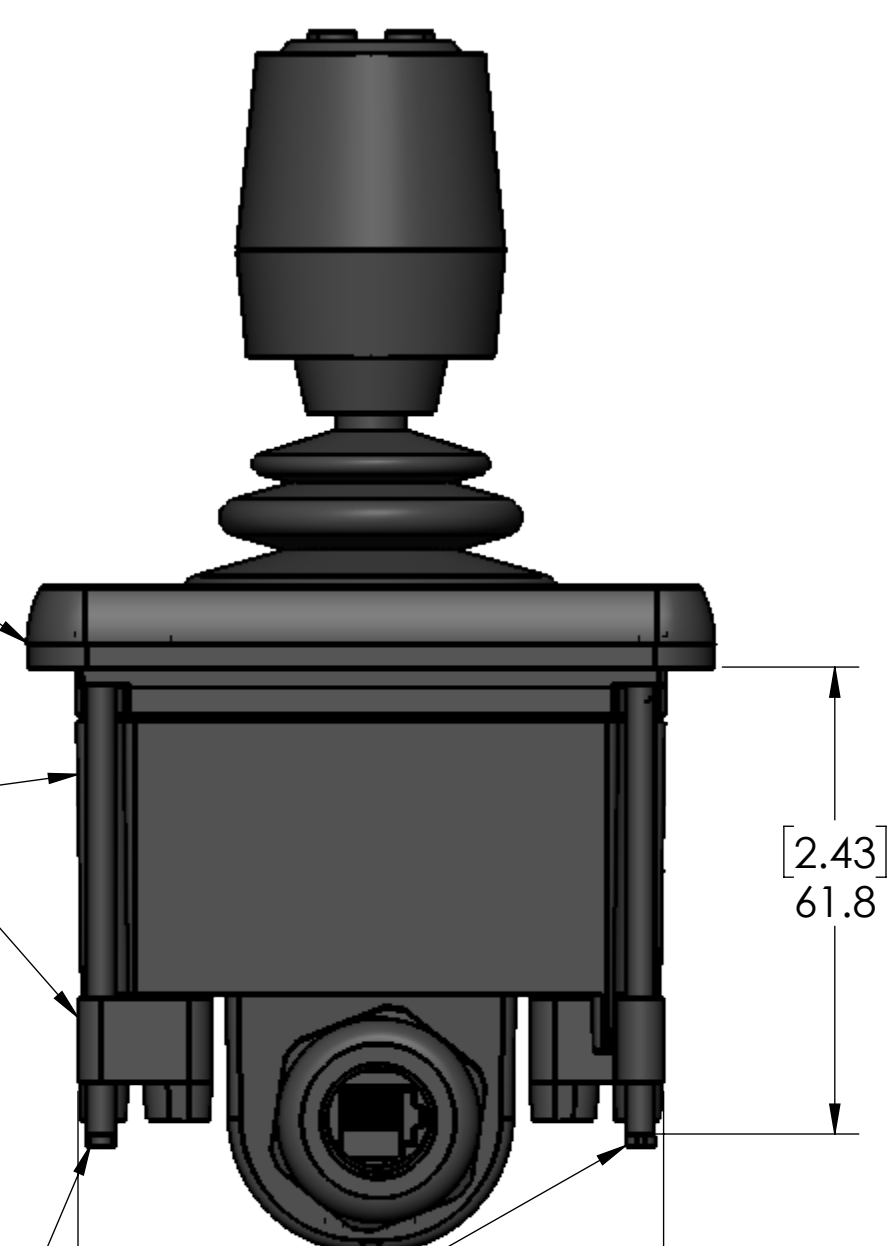

DURING INITIAL TIGHTENING, ENSURE MOUNTING TABS ON SCREWS SWING FREE OF REAR OUSING. WITH TABS RUN UP AGAINST REAR OF INSTRUMENT PANEL, TIGHTEN 1/4 - 1/2 TURN BEYOND HAND TIGHT.



500-0398-10 MARITIME JCU

M400 ICD

METRIC

© 2020, FLIR Systems Inc. - All Rights Reserved



FLIR Systems, Inc.
6769 Hollister Ave.
Goleta, CA 93117

SIZE D

CAGE 064Y2

PIECE PART 432-0012-XX-19

REV 100

SCALE 1:1 PRINTED: 9/18/2020 SHEET 4 OF 10

SOLIDWORKS MODEL: 432-0012-XX-YY TOP LEVEL ASSEMBLY, MARITIME MODEL REVISION: J

IMPORNTANT NOTE:

PAPER SIZE: 11x17in
TEMPLATE SHOULD PRINT 1:1

DUE TO VARIATION IN SOFTWARE AND PRINTERS, PLEASE
VERIFY SCALE BELOW BEFORE MODIFYING MOUNTING
SURFACE.

ENSURE PRINTER MARGINS ARE SET TO ZERO AND SCALE
IS 100%

CORNERS SHALL
BE SHARP.

[2.85]
72.3
OPTIONAL
DRILL GUIDE

[4.85]
123.1
OPTIONAL
DRILL GUIDE

[5.10±.05]
129.5±1.3
CUTOUT

[5.57]
141.4
OUTSIDE
OF JCU

[.25]
Ø 6.4

[3.10±.05]
78.7±1.3
CUTOUT

[3.56]
90.4
OUTSIDE
OF JCU

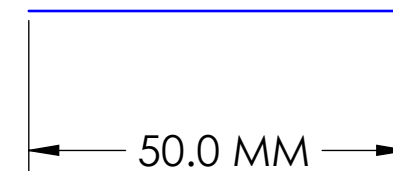
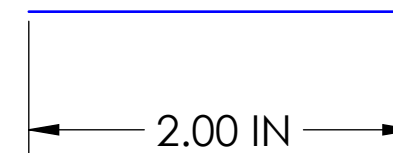

**500-0398-10 MARITIME JCU
MOUNTING PATTERN**

M400 ICD

© 2020, FLIR Systems Inc. - All Rights Reserved			
SIZE B	CAGE 064Y2	DWG NO. 432-0012-XX-19	REV 100
SCALE 1:1	PRINTED: 9/18/2020	SHEET 5 OF 10	

NOTE: CABLE CONFIGURATIONS SHOWN ARE FOR SHORT CABLES INCLUDED WITH EACH UNIT. LONG ACCESSORY CABLES ARE AVAILABLE WHERE NO IN-LINE COUPLING IS NECESSARY. FOR MORE INFORMATION, SEE SHEET 9

M400

JCU

JCU

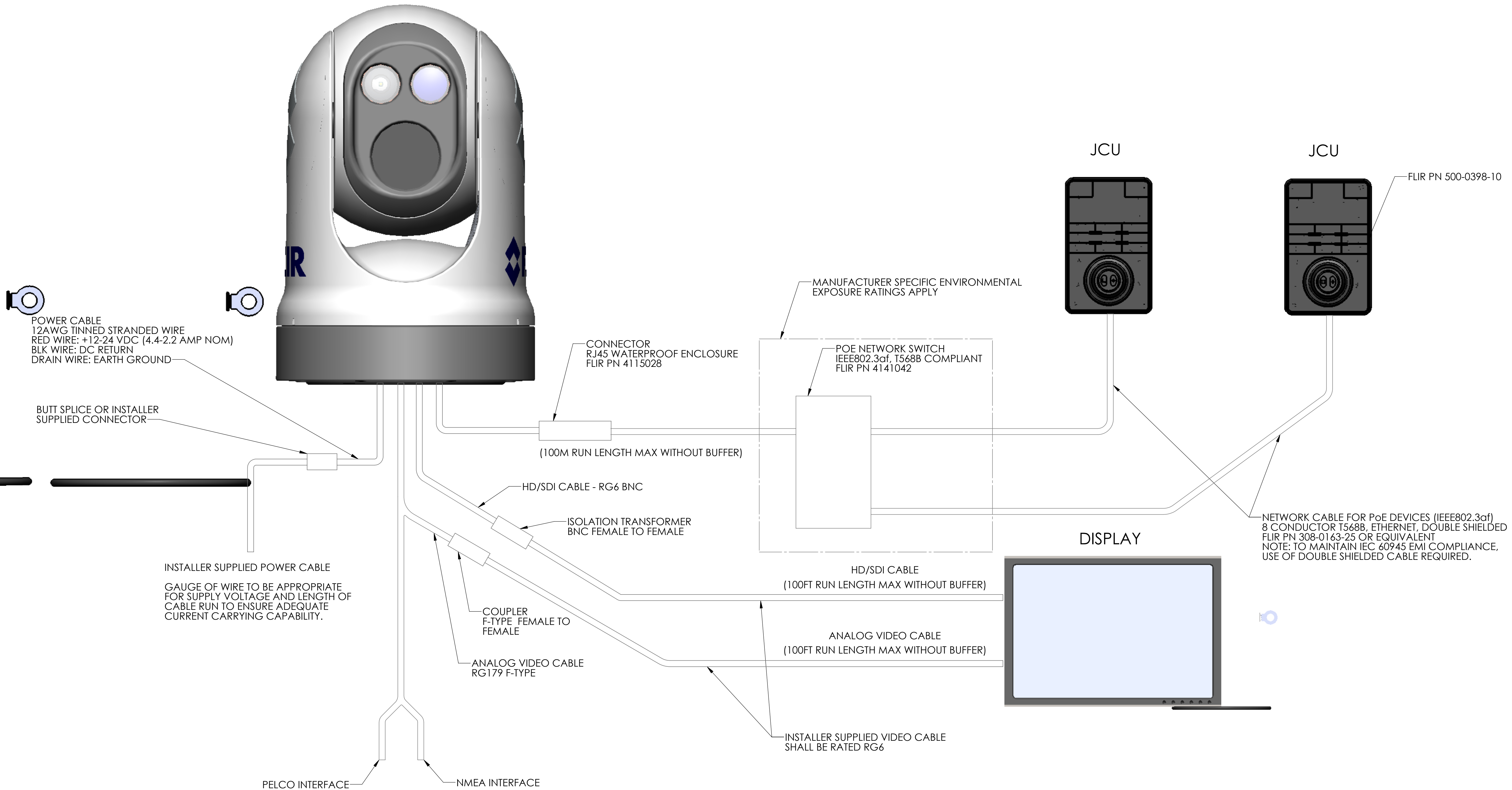

POWER CABLE
12AWG TINNED STRANDED WIRE
RED WIRE: +12-24 VDC (4.4-2.2 AMP NOM)
BLK WIRE: DC RETURN
DRAIN WIRE: EARTH GROUND

BUTT SPLICE OR INSTALLER
SUPPLIED CONNECTOR

INSTALLER SUPPLIED POWER CABLE
GAUGE OF WIRE TO BE APPROPRIATE
FOR SUPPLY VOLTAGE AND LENGTH OF
CABLE RUN TO ENSURE ADEQUATE
CURRENT CARRYING CAPABILITY.

CONNECTOR
RJ45 WATERPROOF ENCLOSURE
FLIR PN 4115028

HD/SDI CABLE - RG6 BNC

ISOLATION TRANSFORMER
BNC FEMALE TO FEMALE

COUPLER
F-TYPE FEMALE TO
FEMALE

ANALOG VIDEO CABLE
RG179 F-TYPE

PELCO INTERFACE

NMEA INTERFACE

MANUFACTURER SPECIFIC ENVIRONMENTAL
EXPOSURE RATINGS APPLY

POE NETWORK SWITCH
IEEE802.3af, T568B COMPLIANT
FLIR PN 4141042

(100M RUN LENGTH MAX WITHOUT BUFFER)

HD/SDI CABLE
(100FT RUN LENGTH MAX WITHOUT BUFFER)

ANALOG VIDEO CABLE
(100FT RUN LENGTH MAX WITHOUT BUFFER)

INSTALLER SUPPLIED VIDEO CABLE
SHALL BE RATED RG6

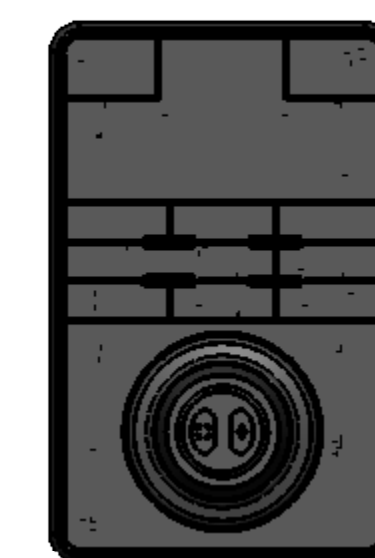

FLIR PN 500-0398-10



NETWORK CABLE FOR PoE DEVICES (IEEE802.3af)
8 CONDUCTOR T568B, ETHERNET, DOUBLE SHIELDED
FLIR PN 308-0163-25 OR EQUIVALENT
NOTE: TO MAINTAIN IEC 60945 EMI COMPLIANCE,
USE OF DOUBLE SHIELDED CABLE REQUIRED.

DWG NO. 432-0012-XX-19 SH 6 REV 100

M400 ICD

METRIC

INTERCONNECT DIAGRAM
MULTIPLE JCU - POE SWITCH



© 2020, FLIR Systems Inc. - All Rights Reserved
FLIR Systems, Inc.
6769 Hollister Ave.
Goleta, CA 93117

SIZE
D

CAGE
064Y2

PIECE PART
432-0012-XX-19 REV 100

SCALE 1:1 PRINTED: 9/18/2020 SHEET 6 OF 10

SOLIDWORKS MODEL: 432-0012-XX-YY TOP LEVEL ASSEMBLY, MARLIN MODEL REVISION: J

NOTE: CABLE CONFIGURATIONS SHOWN ARE FOR SHORT CABLES INCLUDED WITH EACH UNIT. LONG ACCESSORY CABLES ARE AVAILABLE WHERE NO IN-LINE COUPLING IS NECESSARY. FOR MORE INFORMATION, SEE SHEET 9.

M400



JCU

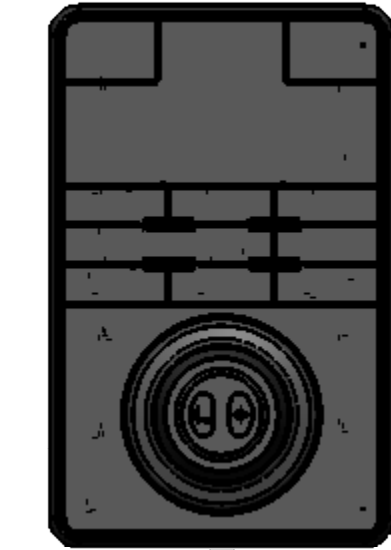

JCU

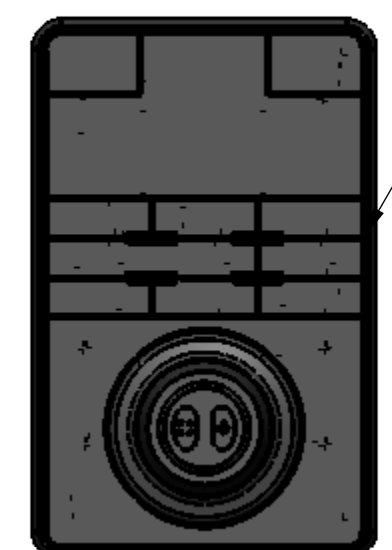

FLIR PN 500-0398-10

POWER CABLE
12AWG TINNED STRANDED WIRE
RED WIRE: +12-24 VDC (4.4-2.2 AMP NOM)
BLK WIRE: DC RETURN
DRAIN WIRE: EARTH GROUND

BUTT SPLICE OR INSTALLER SUPPLIED CONNECTOR

INSTALLER SUPPLIED POWER CABLE
GAUGE OF WIRE TO BE APPROPRIATE FOR SUPPLY VOLTAGE AND LENGTH OF CABLE RUN TO ENSURE ADEQUATE CURRENT CARRYING CAPABILITY.

CONNECTOR
RJ45 WATERPROOF ENCLOSURE
FLIR PN 4115028

(100M RUN LENGTH MAX WITHOUT BUFFER)

HD/SDI CABLE - RG6 BNC

ISOLATION TRANSFORMER
BNC FEMALE TO FEMALE

COUPLER
F-TYPE FEMALE TO FEMALE

ANALOG VIDEO CABLE
RG179 F-TYPE

PELCO INTERFACE

NMEA INTERFACE

MANUFACTURER SPECIFIC ENVIRONMENTAL EXPOSURE RATINGS APPLY

NETWORK SWITCH, NON PoE
INSTALLER SUPPLIED

POE INJECTOR POWER REQUIREMENT
+9-36VDC (12V/1.85A - 24V/0.90A)

POE INJECTOR
IP20, RJ45 FEMALE
FLIR PN 4113746

DISPLAY

HD/SDI CABLE
(100FT RUN LENGTH MAX WITHOUT BUFFER)

ANALOG VIDEO CABLE
(100FT RUN LENGTH MAX WITHOUT BUFFER)

INSTALLER SUPPLIED VIDEO CABLE
SHALL BE RATED RG6

NETWORK CABLE FOR PoE DEVICES (IEEE802.3df)
8 CONDUCTOR T568B, ETHERNET, DOUBLE SHIELDED
FLIR PN 308-0163-25 OR EQUIVALENT
NOTE: TO MAINTAIN IEC 60945 EMI COMPLIANCE,
USE OF DOUBLE SHIELDED CABLE REQUIRED.

M400 ICD

METRIC

INTERCONNECT DIAGRAM
MULTIPLE JCU - POE SWITCH

© 2020, FLIR Systems Inc. - All Rights Reserved



FLIR Systems, Inc.
6769 Hollister Ave.
Goleta, CA 93117

SIZE D	CAGE 064Y2	PIECE PART 432-0012-XX-19	REV 100
SCALE 1:1	PRINTED: 9/18/2020	SHEET 7 OF 10	

SOLIDWORKS MODEL: 432-0012-XX-YY TOP LEVEL ASSEMBLY, MARLIN MODEL REVISION: J

CABLE OPTIONS		
	FLIR PART NUMBER	CABLE DESCRIPTION
INCLUDED WITH EACH M400 UNIT	308-0261-01-00	CABLE - ETHERNET RA TO RJ45, 1M
	308-0263-01-00	POWER CABLE - RA 12 AWG, 1M
	308-0265-01-00	CABLE - AV AND SERIAL RA, 1M
	308-0267-00	CABLE - HD/SDI, 1M
AVAILABLE AS ACCESSORIES	308-0260-01-00	CABLE - ETHERNET TO RJ45, 1M
	308-0262-01-00	POWER CABLE - 12 AWG, 1M
	308-0264-01-00	CABLE - AV AND SERIAL, 1M
	4141864	CABLE - HD/SDI, 100FT
	308-0251-30-00	CABLE - ETHERNET TO RJ45, 100ft, LSZH
	308-0252-30-00	CABLE - ETHERNET RA TO RJ45, 100ft, LSZH
	308-0253-30-00	CABLE - POWER, 12 AWG, 100ft, LSZH
	308-0254-30-00	CABLE - POWER, RA, 12 AWG, 100ft, LSZH
	308-0255-30-00	CABLE - AV AND SERIAL, 100ft, LSZH
	308-0256-30-00	CABLE - AV AND SERIAL RA, 100ft, LSZH

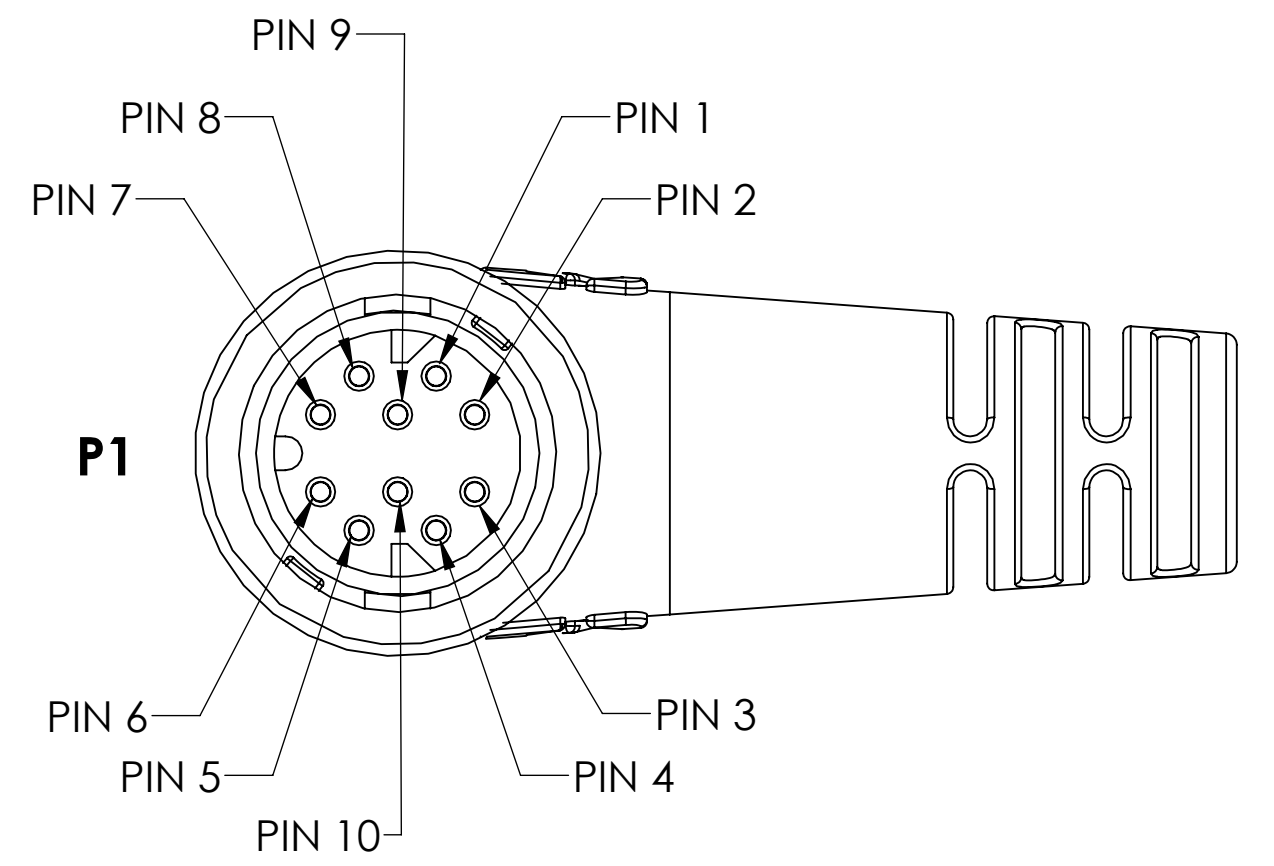
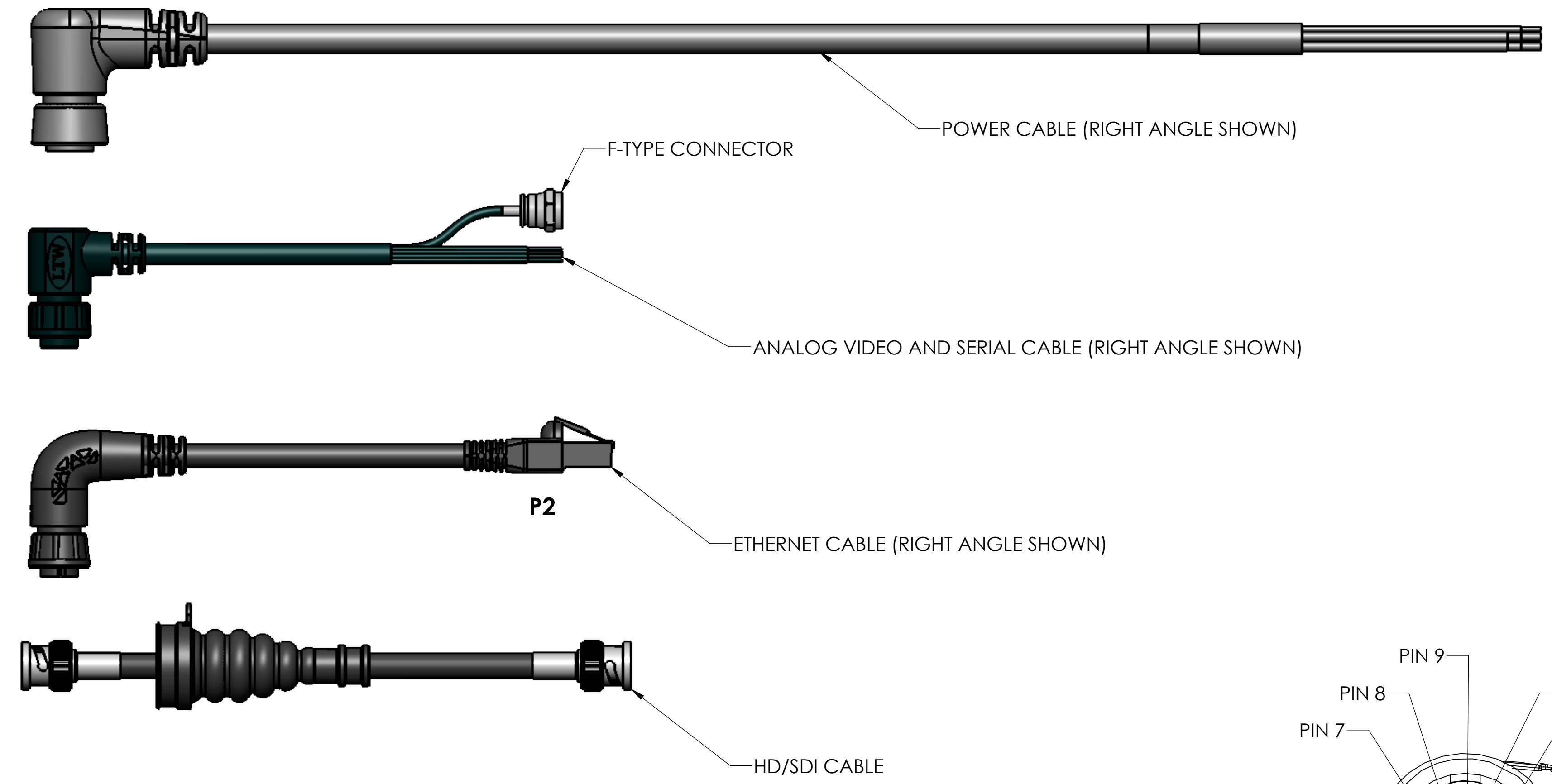

ETHERNET CABLE CONNECTOR PINOUT

RJ45 CONNECTOR (P2)
PINOUT IN ACCORDANCE
WITH 802.3af STANDARD B

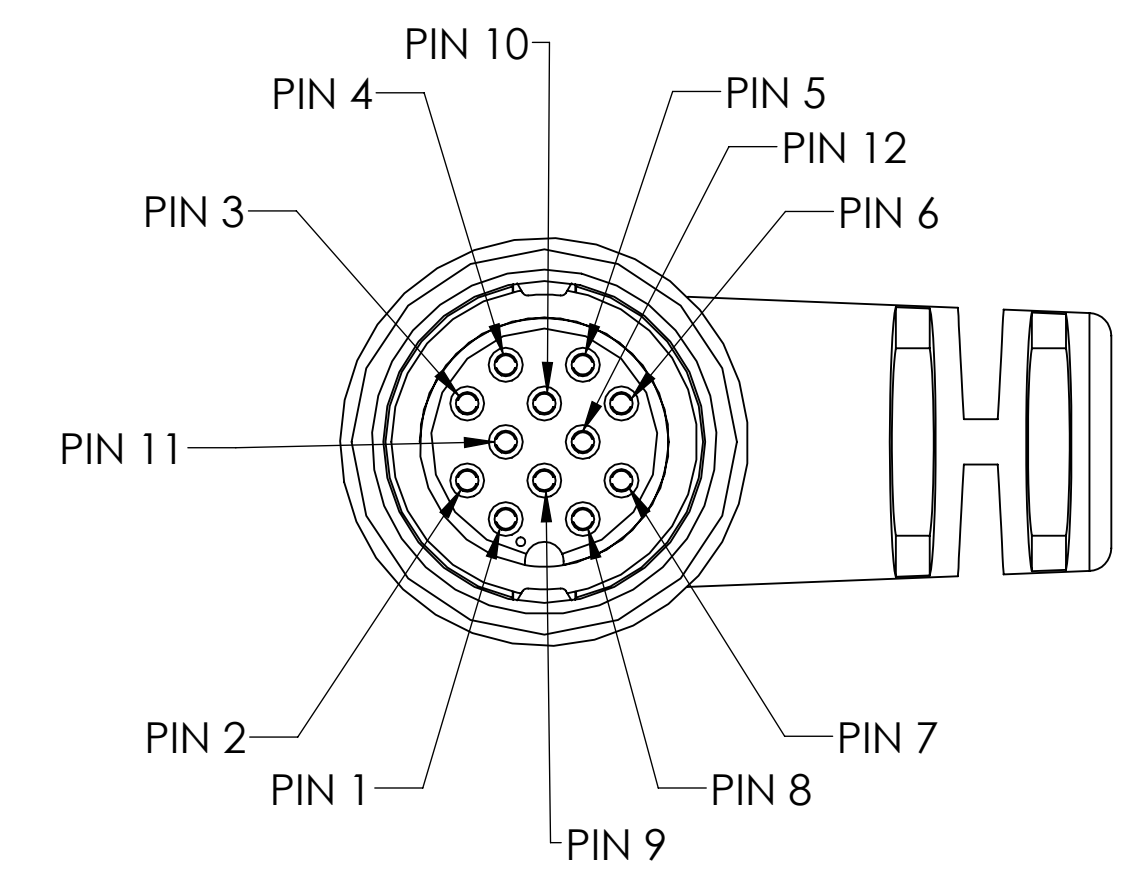

A/V AND SERIAL CABLE CONNECTOR PINOUT

ANALOG VIDEO AND SERIAL CABLE PINOUT TABLE		
WIRE COLOR	NAME	PIN NUMBER
GREEN	NMEA TX-P	1
GREEN/WHITE	NMEA TX-N	2
RG179	ANALOG VIDEO OUT	3
NATURAL	ANALOG VIDEO RETURN	4
BROWN/WHITE	PELCO RX-N	5
BROWN	PELCO RX-P	6
BLUE	PELCO TX-P	7
ORANGE/WHITE	NMEA RX-N	8
ORANGE	NMEA RX-P	9
DRAIN	PELCO SHIELD	10
DRAIN	NMEA SHIELD	11
BLUE/WHITE	PELCO TX-N	12

ETHERNET CABLE PINOUT TABLE				
P1	WIRE COLOR	NAME		P2
1	ORANGE/WHITE	TXRX A+		1
2	ORANGE	TXRX A-		2
3	BLUE	TXRX C+	DC+	4
4	BLUE/WHITE	TXRX C-	DC+	5
5	GREEN/WHITE	TXRX B+		3
6	GREEN	TXRX B-		6
7	BROWN/WHITE	TXRX D+	DC-	7
8	BROWN	TXRX D-	DC-	8
9	NA	NA		
10	DRAIN	DRAIN		SHELL

IMPORTANT: CHASSIS GROUND WIRE TO BE TIED SECURELY TO THE NEGATIVE BATTERY TERMINAL

POWER CABLE PINOUT TABLE	
WIRE COLOR	SIGNAL NAME
RED	BATT +
BLACK	BATT -
DRAIN	CHASSIS GROUND

M400 ICD

D

C

B

A

D

C

B

A

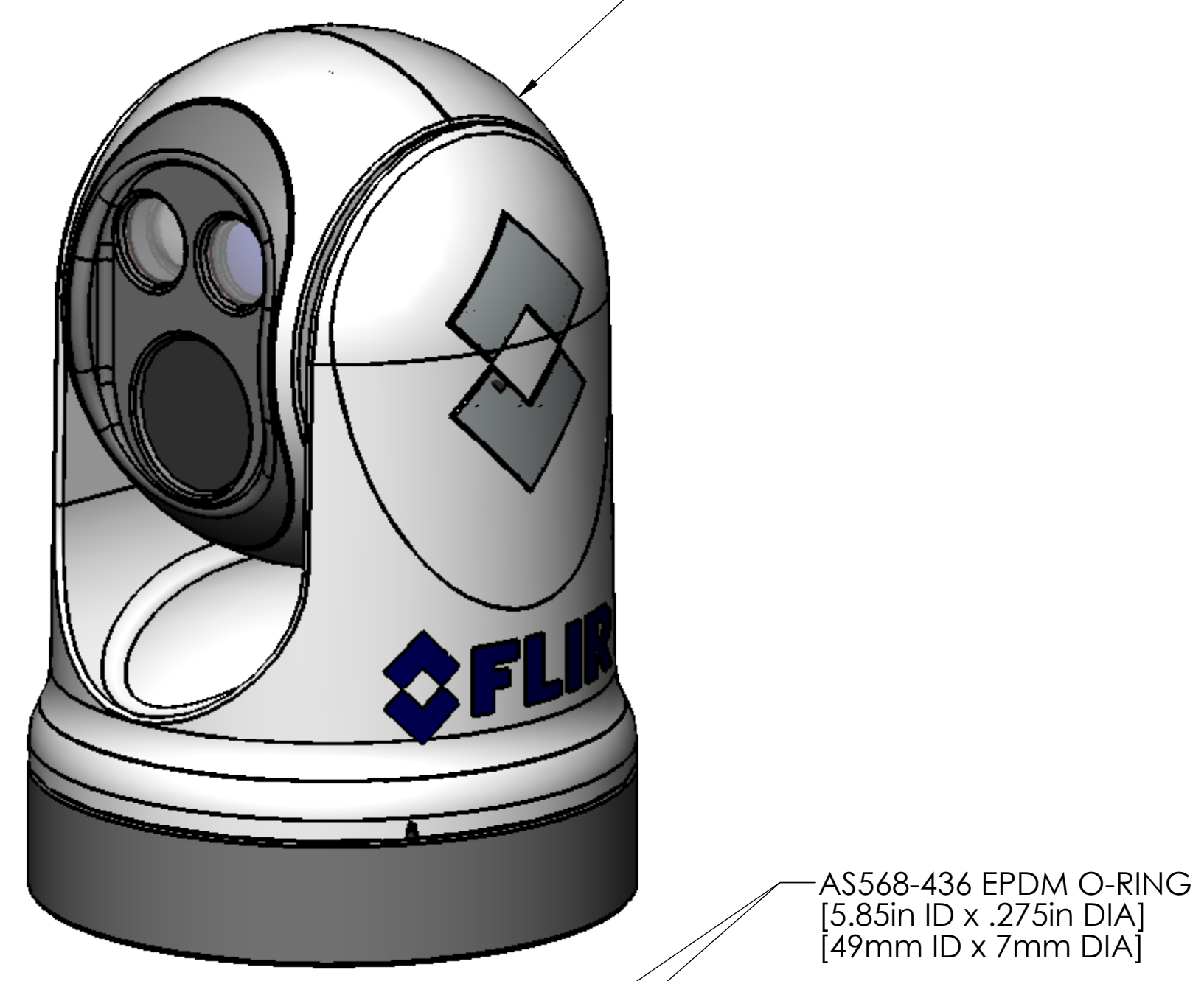

CUSTOMER DECKING, OR OTHER STRUCTURE.
MAX DECK THICKNESS FOR RIGHT ANGLED CABLES WITHOUT TOP DOWN RISER: 10mm

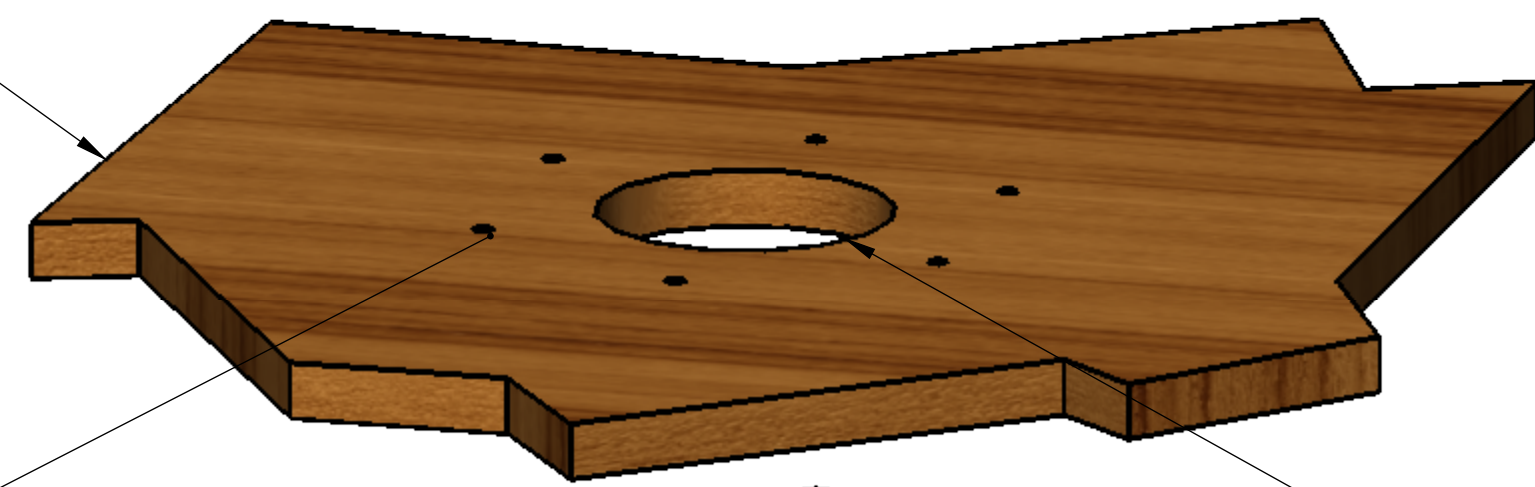

AS568-436 EPDM O-RING [5.85in ID x .275in DIA] [49mm ID x 7mm DIA]
AS568-444 EPDM O-RING [7.72in ID x .275in DIA] [96mm ID x 7mm DIA]

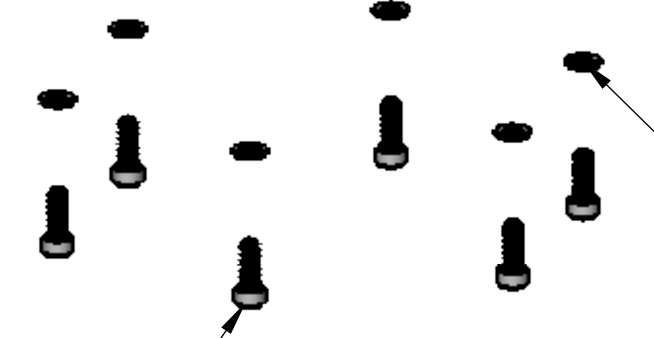

CABLE PORT FOR DIMENSIONS SEE SHEETS 2 AND 3

WASHER, OPTIONAL M6 316 STAINLESS STEEL

WARNING 5

HIDDEN CABLE MOUNTING SCHEME:

MOUNTING DIRECTLY THROUGH CUSTOMER DECKING, OR OTHER SURFACES STRUCTURE OPPOSITE M400 TO BE A SEALED ENCLOSURE AND A DRY SPACE CAMERA SHOWN IN BALL UP CONFIGURATION

SOCKET HEAD CAP SCREW WITH LOCKING PATCH M6 X 1.0 LENGTH: 6mm + THICKNESS OF CUSTOMER DECKING 316 STAINLESS STEEL 6 PLACES APPLY CORROSION INHIBITOR (USS TEF-GEL) TORQUE TO 4.5 N-m (3.3 lb-ft)

WARNING 5

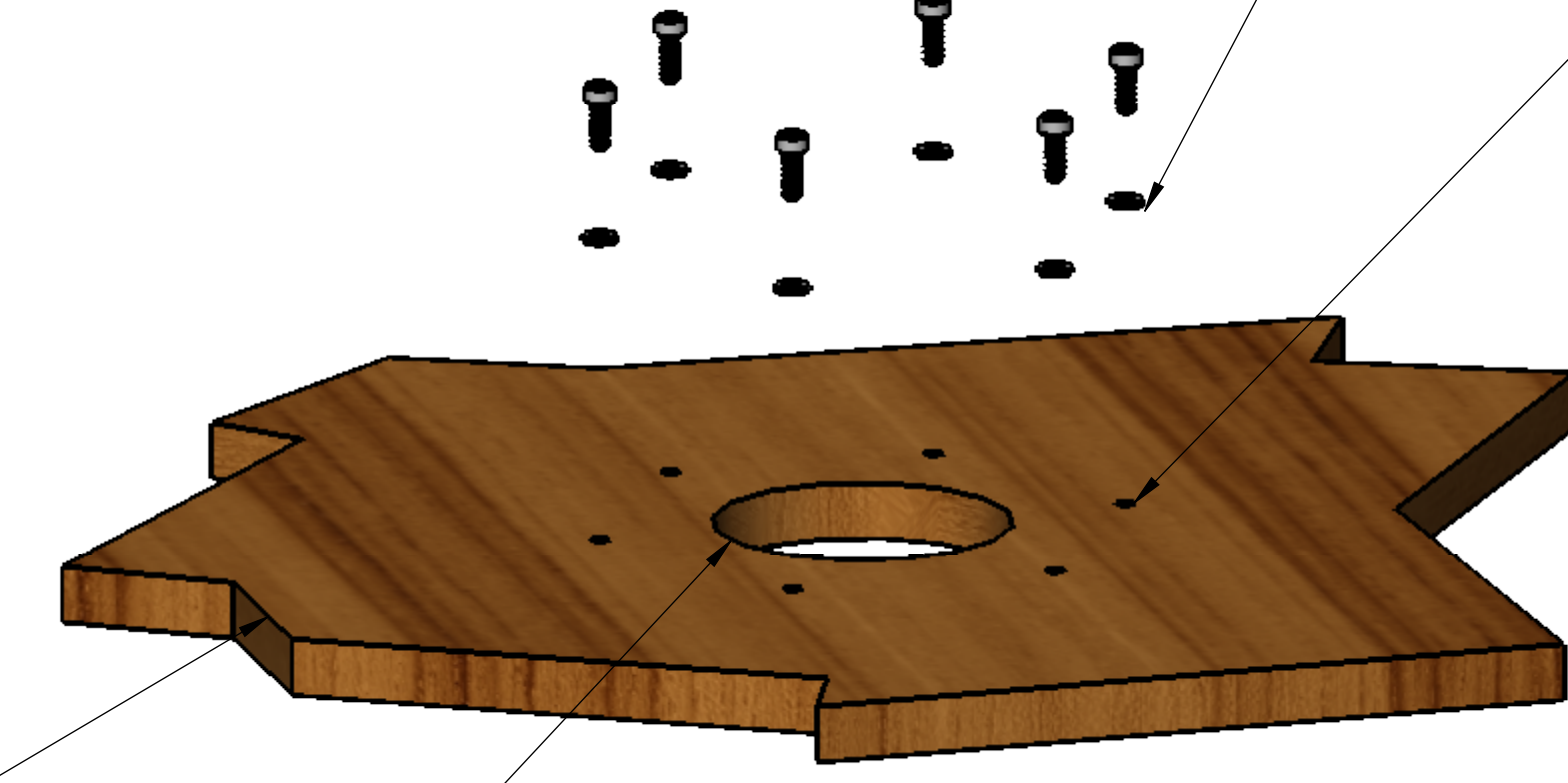

CUSTOMER DECKING, OR OTHER STRUCTURE.
MAX DECK THICKNESS FOR RIGHT ANGLED CABLES WITHOUT TOP DOWN RISER: 10mm

CABLE PORT FOR DIMENSIONS SEE SHEETS 2 AND 3

HOLES, MOUNTING 6.4 mm DIAMETER 6 PLACES

AS568-436 EPDM O-RING [5.85in ID x .275in DIA] [49mm ID x 7mm DIA]
AS568-444 EPDM O-RING [7.72in ID x .275in DIA] [96mm ID x 7mm DIA]



HIDDEN CABLE MOUNTING SCHEME:

MOUNTING DIRECTLY THROUGH CUSTOMER STRUCTURE. ACTUAL STRUCTURES MAY VARY. STRUCTURE OPPOSITE M400 TO BE A SEALED ENCLOSURE AND A DRY SPACE CAMERA SHOWN IN BALL DOWN CONFIGURATION

M400 ICD

METRIC



FLIR Systems, Inc. 6769 Hollister Ave. Goleta, CA 93117

SIZE D	CAGE 064Y2	PIECE PARTS 432-0012-XX-19	REV 100
SCALE 1:5	PRINTED: 9/18/2020	SHEET 9 OF 10	

© 2020, FLIR Systems Inc. - All Rights Reserved

SOLIDWORKS MODEL: 432-0012-XX-YY TOP LEVEL ASSEMBLY, MARLIN MODEL REVISION: J

D

C

B

A

D

C

DWG NO. 432-0012-XX-19 SH 10 REV 100

A

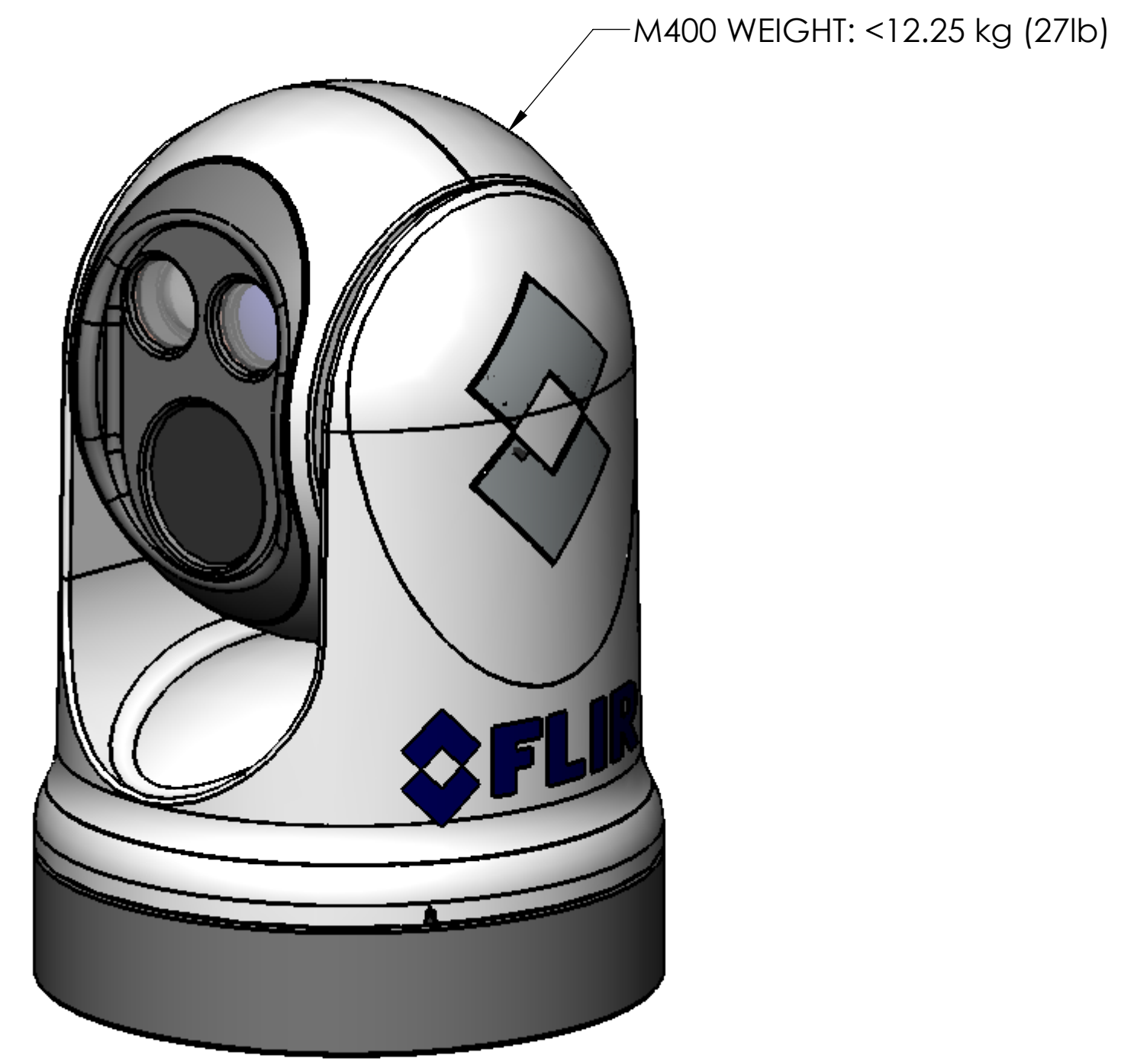

TOP DOWN RISER
FLIR PN 4141973

HIGHLY RECOMMENDED FOR INSTALLATIONS ONTO METAL SURFACES

SOCKET HEAD CAP SCREW WITH LOCKING PATCH
M6 X 1.0
LENTGTH: 16mm
316 STAINLESS STEEL
6 PLACES
APPLY CORROSION INHIBITOR (USS TEF-GEL)
TORQUE TO 4.5 N-m (3.3 lb-ft)

WARNING 5.

GASKET, TOP DOWN RISER
INCLUDED IN TOP DOWN RISER KIT
FLIR PN 4141973

CUSOMTER DECKING, OR
OTHER STRUCTURE.

MAX DECK THICKNESS FOR
RIGHT ANGLED CABLES WITHOUT
TOP DOWN RISER: 10mm

MOUNTING HOLES AS
DETAILED ON PAGE 3

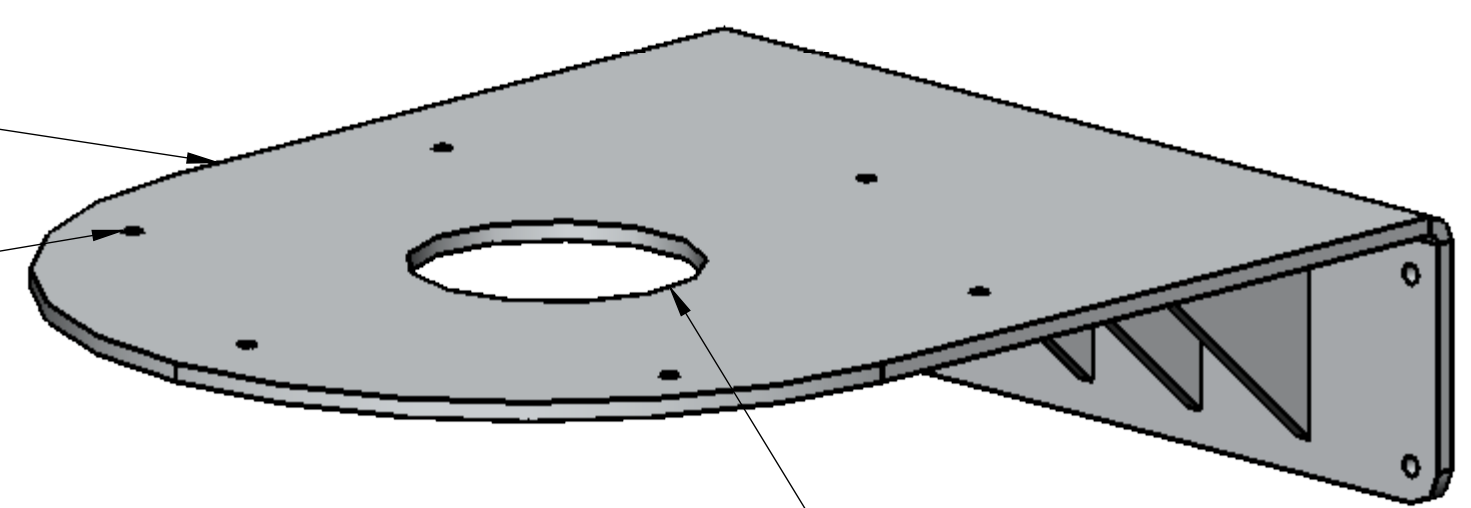
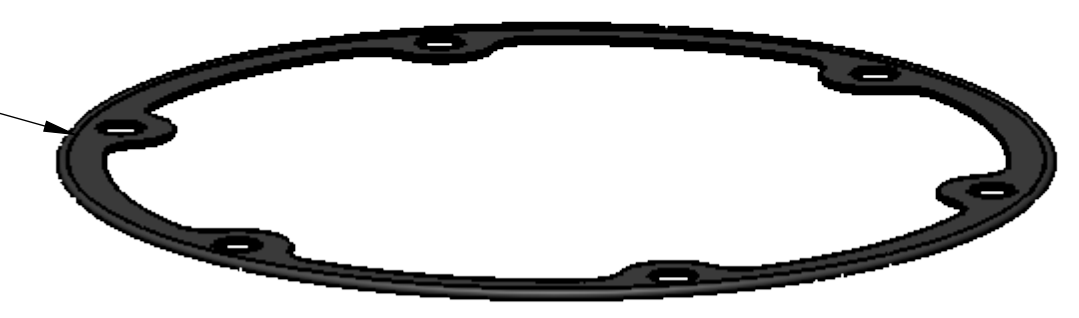
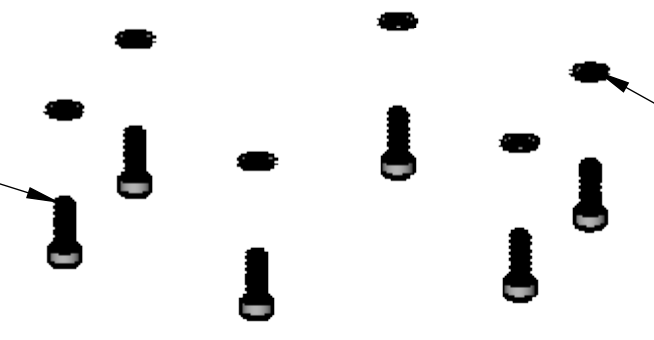
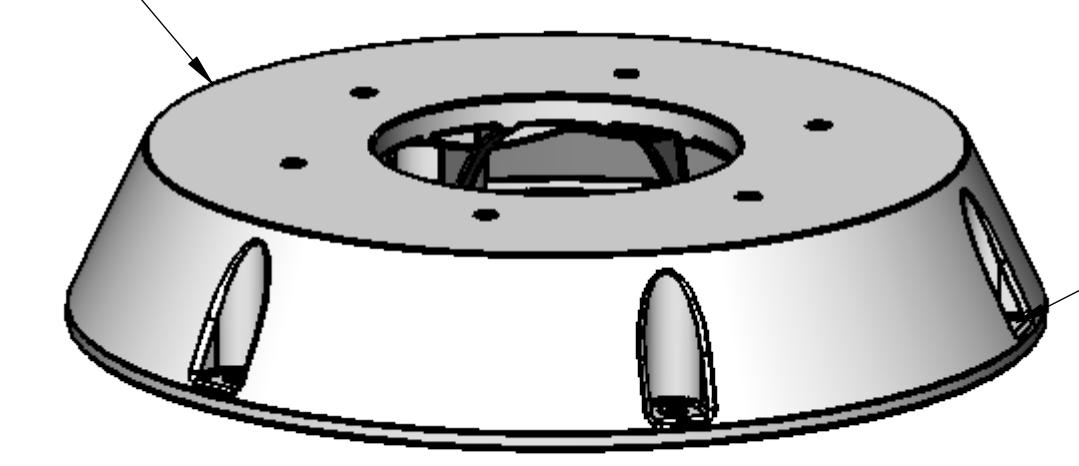

CABLE PORT
FOR DIMENSIONS SEE
SHEETS 2 AND 3

FASTENERS BETWEEN TOP DOWN
RISER AND MOUNTING SURFACE
TO BE SUPPLIED BY THE INSTALLER.
RECOMMENDED FASTENERS
DETAILED ON PAGE 3.

WASHER
M6
316 STAINLESS STEEL

EXPOSED CABLE MOUNTING SCHEME:

CUSTOMER SUPPLIED MOUNTING BRACKET/SURFACE
BALL UP CONFIGURATION SHOWN

CABLE PORT
FOR DIMENSIONS SEE
SHEETS 2 AND 3

MOUNTING HOLES AS
DETAILED ON PAGE 3

WASHER
M6
316 STAINLESS STEEL

AS568-436 EPDM O-RING
[5.85in ID x .275in DIA]
[49mm ID x 7mm DIA]

AS568-444 EPDM O-RING
[7.72in ID x .275in DIA]
[96mm ID x 7mm DIA]

EXPOSED CABLE MOUNTING SCHEME:

CUSTOMER SUPPLIED MOUNTING BRACKET/SURFACE
BALL DOWN CONFIGURATION SHOWN

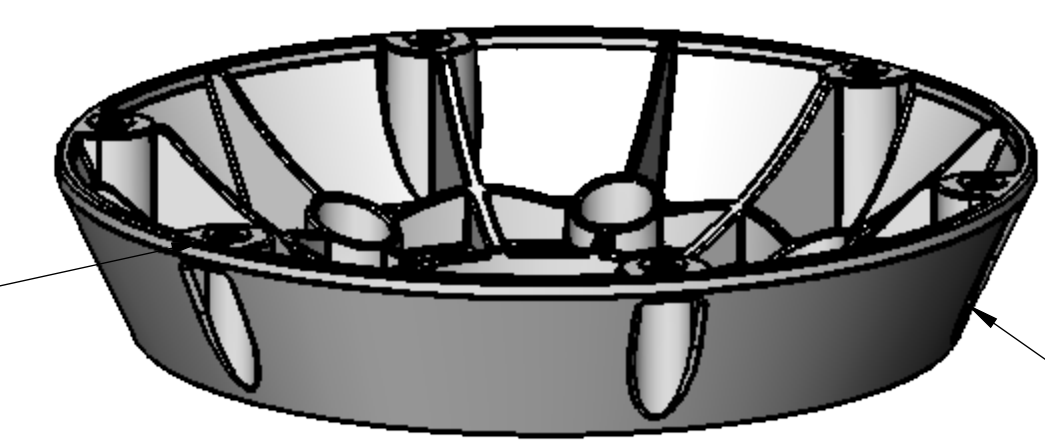
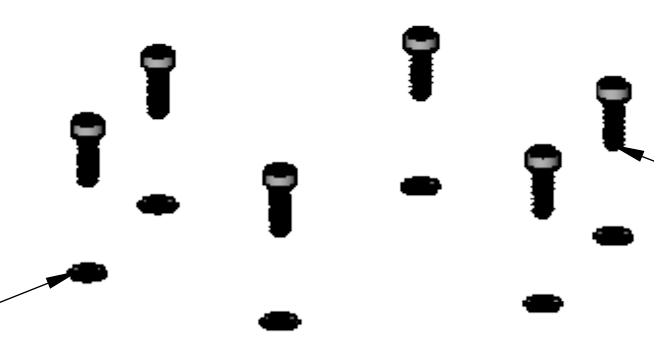
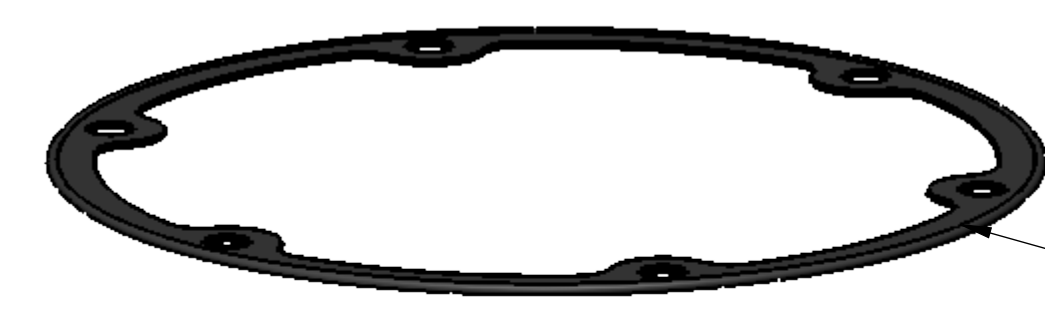
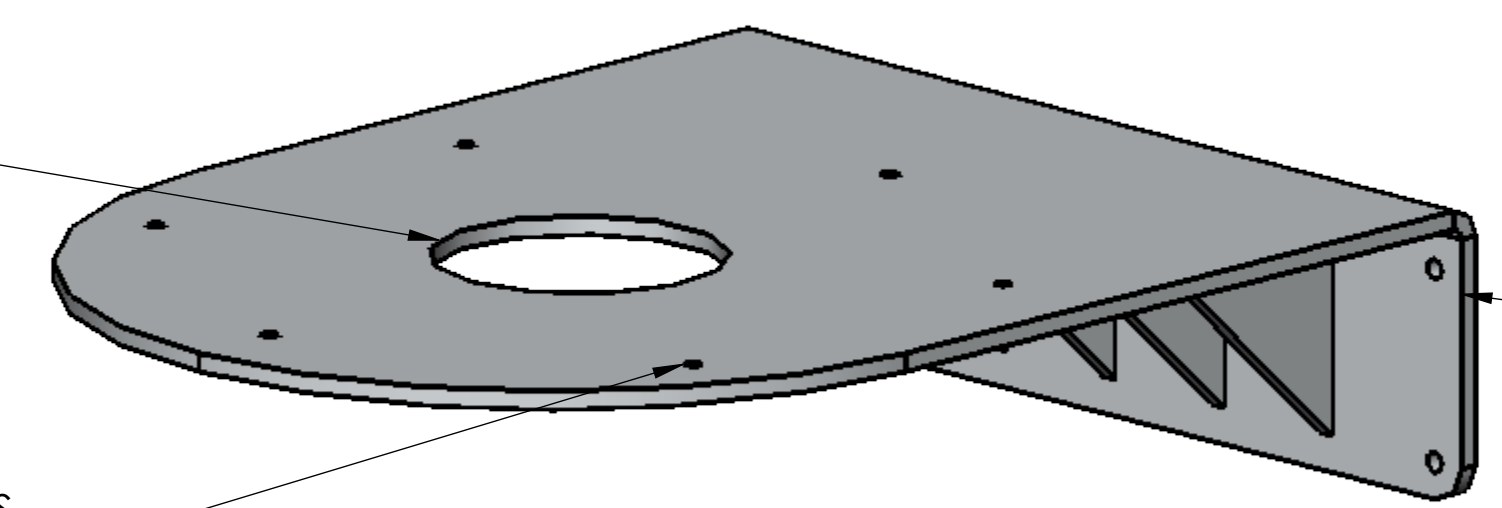

CUSOMTER DECKING, OR
OTHER STRUCTURE.

MAX DECK THICKNESS FOR
RIGHT ANGLED CABLES WITHOUT
TOP DOWN RISER: 10mm

GASKET, TOP DOWN RISER
INCLUDED IN TOP DOWN RISER KIT
FLIR PN 4141973

SOCKET HEAD CAP SCREW WITH LOCKING PATCH
M6 X 1.0
LENTGTH: 16mm
316 STAINLESS STEEL
6 PLACES
APPLY CORROSION INHIBITOR (USS TEF-GEL)
TORQUE TO 4.5 N-m (3.3 lb-ft)

WARNING 5.

TOP DOWN RISER
FLIR PN 4141973

HIGHLY RECOMMENDED FOR INSTALLATIONS ONTO METAL SURFACES

M400 WEIGHT: <12.25 kg (27lb)

M400 ICD

METRIC

© 2020, FLIR Systems Inc. - All Rights Reserved



FLIR Systems, Inc.
6769 Hollister Ave.
Goleta, CA 93117

SIZE D	CAGE 064Y2	PIECE PART 432-0012-XX-19	REV 100
SCALE 1:5	PRINTED: 9/18/2020	SHEET 10 OF 10	

SOLIDWORKS MODEL: 432-0012-XX-YY TOP LEVEL ASSEMBLY, MARLIN
MODEL REVISION: J