

# VLF 2.1

## METAL DETECTOR

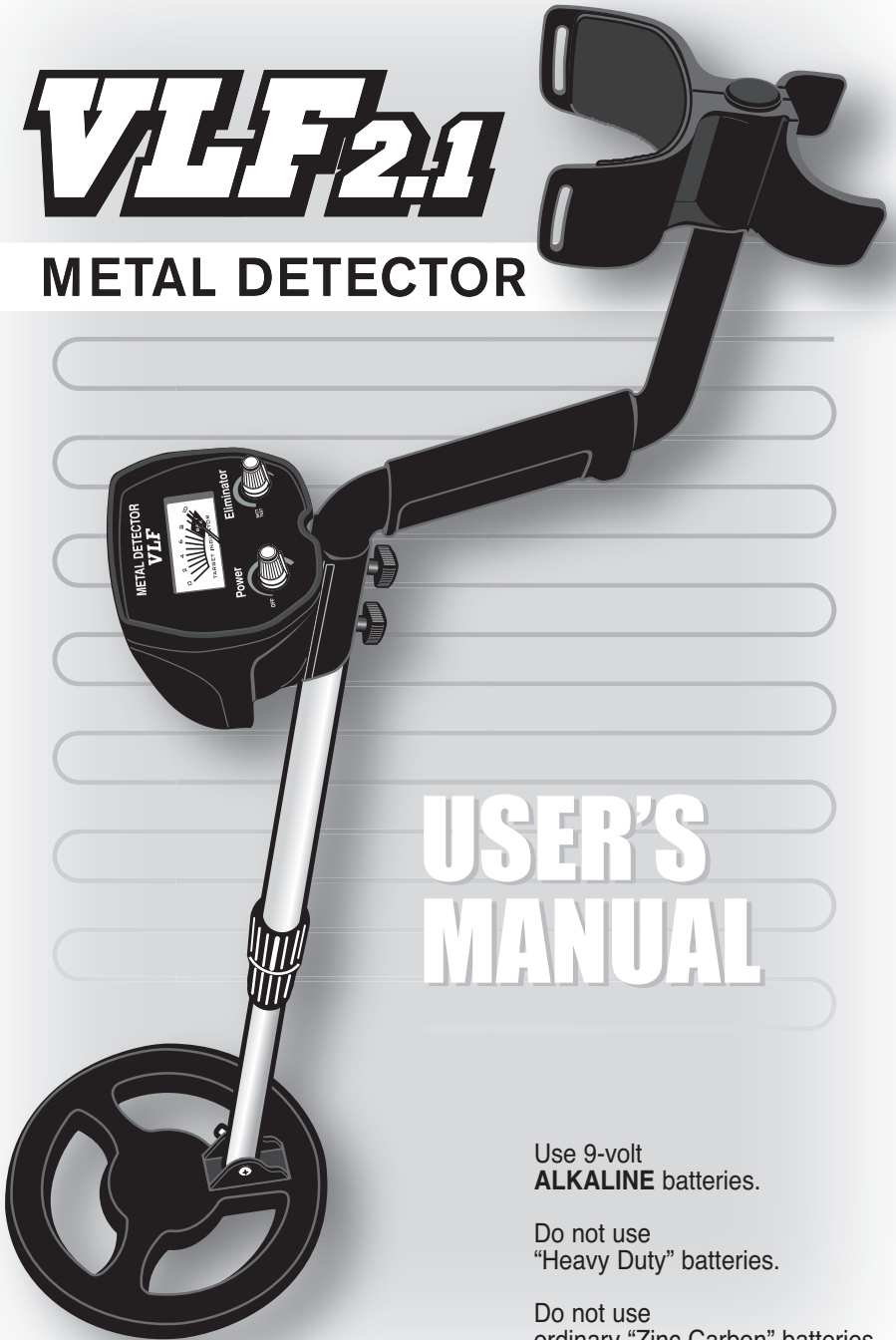

# USER'S MANUAL

Use 9-volt  
**ALKALINE** batteries.

Do not use  
"Heavy Duty" batteries.

Do not use  
ordinary "Zinc Carbon" batteries.

# Index

Introduction . . . . .	3
Installing Batteries . . . . .	4
Assembly . . . . .	5
Quick Start Demo . . . . .	6
Adjusting Length . . . . .	7
Battery Test . . . . .	8
Practicing Outside . . . . .	8
Sensitivity & Target Elimination . . . . .	9
Operation in the Field . . . . .	10
Pinpointing . . . . .	10
Treasure Hunter's Code of Ethics . . . . .	11
Warranty . . . . .	11

# VLF 2.1

## METAL DETECTOR

### INTRODUCTION

To get the most enjoyment from your Metal Detector, we suggest you do the following:

1. Use 9-volt **ALKALINE** batteries only.
  - Do not use Heavy Duty batteries.
  - Do not use ordinary Zinc-Carbon Batteries.
2. Make sure the right knob is clicked on (i.e. not in battery-test position).
3. Use your detector **OUTDOORS** only.
  - Large metal objects inside the home may interfere with the detector's operation. Floors and walls of most homes contain metal.
  - Electrical appliances inside the home, like microwave ovens, televisions, and some light fixtures, emit electromagnetic energy which can interfere with the detector's operation.
  - Do not place coins on the floor of your home and try to detect.  
Try this test outside only.
  - If conducting an indoor demonstration, hold searchcoil off ground and wave coins over searchcoil.

# Installing Batteries

Use 9-volt **ALKALINE** batteries only!

1. Remove the Battery Compartment Cover from the top of the control housing.
2. Pull out the two battery connectors.
3. Snap on two 9-volt **ALKALINE** batteries.  
Do not use Heavy Duty or ordinary Zinc Carbon batteries.
4. Slide batteries into position as illustrated below.
5. Replace the Battery Compartment Cover.  
Slide over until it shuts securely in place.

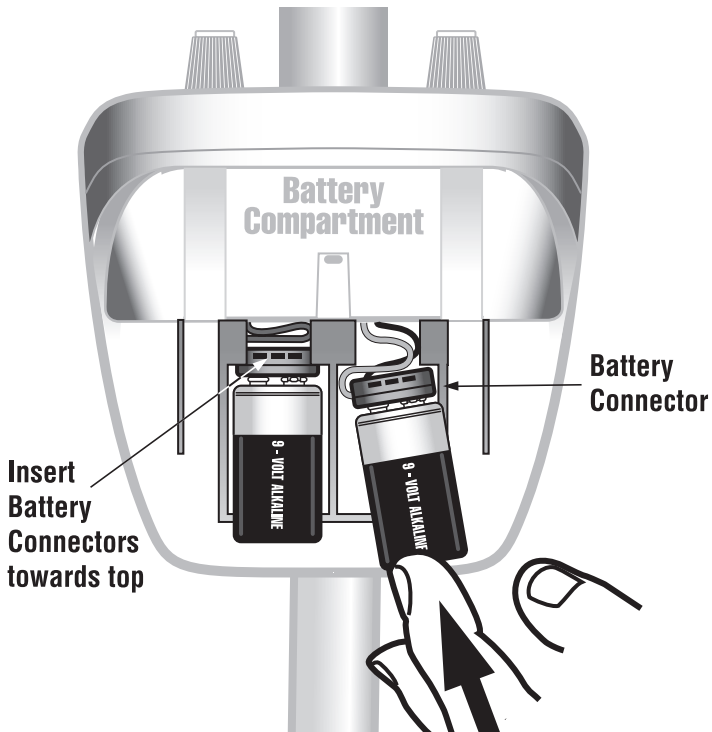

## WARNING

- Never mix old and new batteries.
- Never mix alkaline, standard (carbon-zinc), rechargeable (nickel-cadmium) batteries.
- Never dispose of batteries in fire, as they may explode.
- Never attempt to charge non-chargeable batteries.
- Always remove exhausted batteries from metal detector.

# Assembly

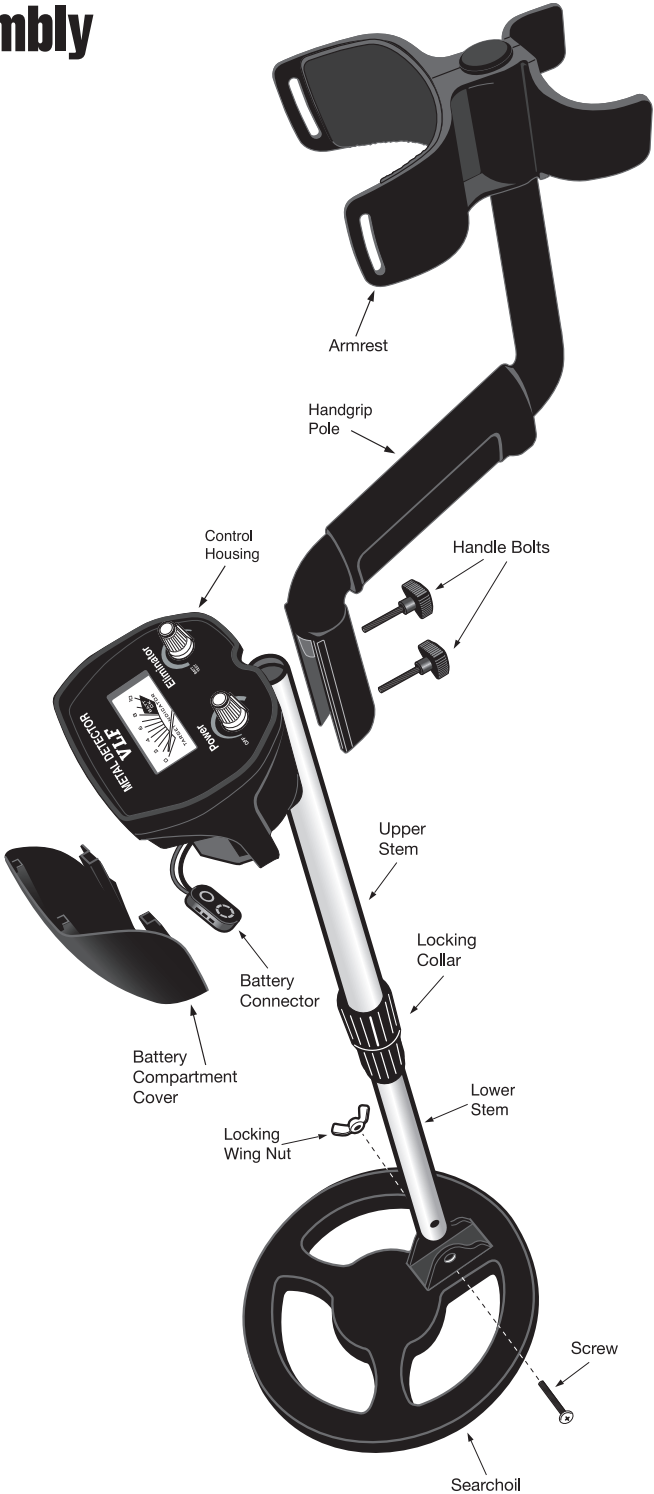

# Quick-Start Demo

Try this quick way to demonstrate the basic features of your metal detector:

## I. Supplies Needed

- a. A nail
- b. A zinc penny (pennies dated after 1982 are made of zinc)
- c. A quarter

## II. Position Your Detector

Keep the detector away from floors, walls, and metal objects. One person holds the detector still, so that another can sweep coins under the coil. Sweep coins under the bottom of the searchcoil.

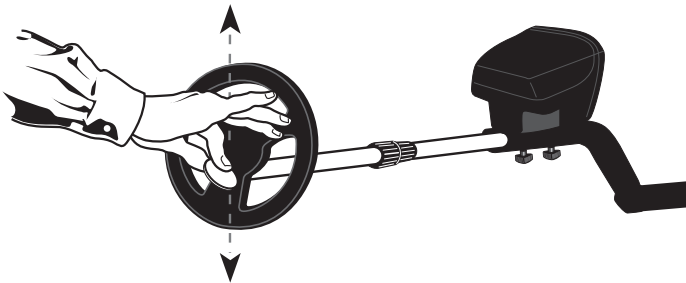

## III. Beginning Settings

- a. Left Knob: At 6:00 position
- b. Right Knob: Click on, but keep counterclockwise



## IV. Detecting All Types of Metals

- a. Wave each object over the searchcoil. Notice the tone is loudest as the object passes over the center.
- b. Pass each object at varying distances from the searchcoil. Notice that the sound gets louder as the object moves closer to the searchcoil. Also notice that beyond a certain distance, the object is no longer detected.

## V. Eliminating Some Metals

- a. Wave the nail and slowly turn the right knob to the right.
  - Notice where the nail is eliminated from detection
- b. Wave the penny and keep turning the right knob until the penny is eliminated from detection
- c. Wave the quarter
  - Notice that the quarter is never eliminated from detection.

# Adjusting Length

Loosen the tube Locking Collar 1/4 turn:

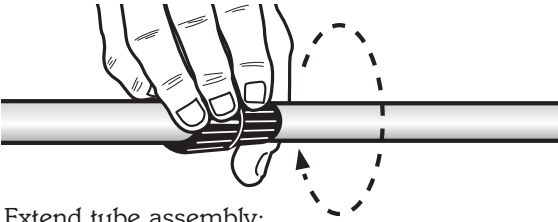

Extend tube assembly:

1. Grasp the top tube with one hand.
2. Grasp the searchcoil with the other hand.
3. Pull two sections apart to slide the bottom tube out of the top tube.

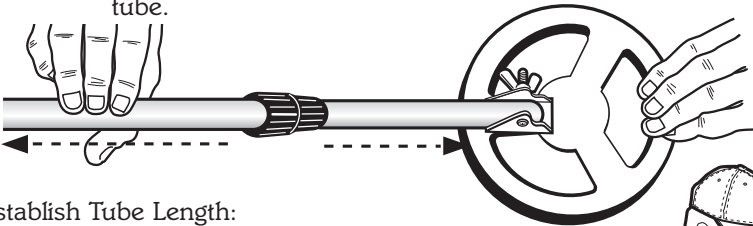

Establish Tube Length:

1. Pivot the searchcoil perpendicular to the tube.
2. Place detector in user's hand, with arm extended.
3. Adjust tube length so that searchcoil rests on the ground, close to the user's feet.
4. Align the coil to the detector body.
5. Tighten the tube clamping nut, while holding the searchcoil in place on the ground to prevent twisting of the tube assembly while tightening.

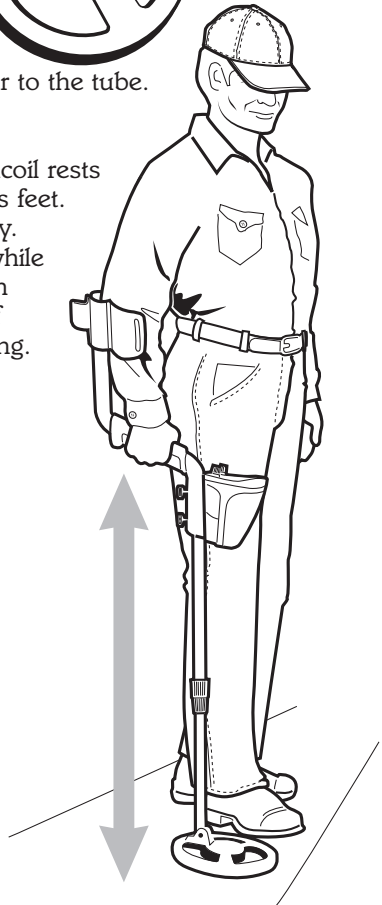

# Battery Test

Click the right knob fully counterclockwise (all the way to the left), in order to test the batteries.

If the batteries are good, the needle will move to the right and enter the green zone on the indicator label.

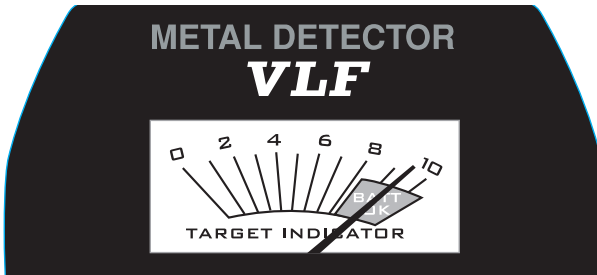

If the needle does not enter the green zone, replace the batteries.

## Practicing Outside

1. Turn the detector on
  - a. Rotate **left knob** clockwise to a high sensitivity setting.
  - b. Click **right knob** on to exit the "battery test" mode.
  - c. Maintain **right knob** in counterclockwise position, but do not click into the "battery test" mode.
2. Find a clear area in the grass

Sweep the searchcoil around the grass to find an area where the detector does not beep. In order to test your detector, you must first find an area free of metal objects.
3. Toss these metal objects on the ground
  - a. A nail or other iron object like a small screwdriver
  - b. A zinc penny (dated after 1982)
  - c. A quarter
4. Keep the objects spaced apart on the ground
5. Sweep the searchcoil over each of the objects
  - a. **You must keep the searchcoil moving.**
  - b. Notice that the sound is loudest when the metal object is under the center of the searchcoil.
  - c. While sweeping back and forth, slowly raise the searchcoil several inches off the ground.

Notice that the sound is louder when the searchcoil is closer to the objects.
6. Turn the **right knob** progressively to the right while passing the searchcoil over each of the objects

The nail (or small iron object) is eliminated from detection with the right knob in approximately the 3:00 position.  
The zinc penny (pre-1982) is eliminated from detection with the right knob in approximately the 6:00 position.



# Sensitivity and Target Elimination

## Adjusting Sensitivity

The **left knob** clicks on to power the detector on.

After turning on, the left knob is used to control the detector's sensitivity level. In the 100% clockwise position, the detector is at maximum sensitivity. At this level, the detector will detect a coin-sized object, like a quarter, up to 5" away from the coil. Very large metal objects will be detected up to one and one-half feet from the searchcoil at maximum sensitivity.

**Reduce the sensitivity if the detector chatters or emits false signals; your detector is probably reacting to electromagnetic interference.**

## Target Elimination

The **right knob** is used to eliminate unwanted metals from detection.

For instance, you may be searching for coins, and want to eliminate objects like nails, bolts, or pull-tabs from detection.

As you turn the right knob clockwise, you progressively eliminate different types of metals from detection. As you rotate the right knob, you first eliminate iron objects from detection. Iron objects include nails, bolts, old cans, and tools. Next, you eliminate nickels, pull-tabs, and finally zinc pennies.

Gold is also eliminated from detection with the right knob. First smaller gold objects are eliminated; as you rotate the knob further, larger gold objects are eliminated. Silver objects, like high-value coins, are not eliminated from detection.

Refer to this scale for the relative positions at which different types of metals are eliminated from detection:

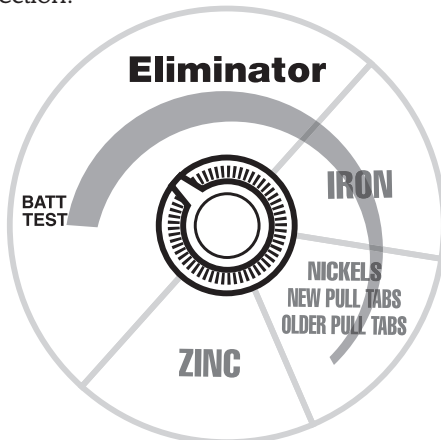

# Operation in the Field

Sweep the searchcoil from side to side, in slow, overlapping motions.

Keep the searchcoil parallel to the ground.

Keep searchcoil 1/2" off the ground and try not to make contact with the ground.

Try not to lift the searchcoil at the end of your sweeps. This may be difficult for younger children, but the closer the searchcoil is to the ground throughout the sweep, the more likely you are to find buried metal objects.

Keep the left knob in the maximum sensitivity setting possible.

Click the right knob on and start searching with it in the fully counterclockwise position.

You may want to move the right knob during your search, depending on what you find. For instance, if you start searching with the right knob to the left (but not in battery test mode), you will detect all types of metal objects. If you find that you are in a trashy area, and wish to eliminate unwanted objects from detection, sweep the searchcoil over an undesirable object while turning the knob. Find the knob setting at which certain types of metals are eliminated, and adjust your settings accordingly.

**CAUTION:** Gold rings can be eliminated from detection along with pull-tabs.

Be aware that some desirable objects, like nickels and gold, are eliminated from detection in the middle of the range. Gold rings have a metallic signature similar to pull-tabs; nickels have a metallic signature similar to some newer pull tabs. It requires practice and patience to understand what types of objects are eliminated at each setting.

## Pinpointing

*Accurate pinpointing takes practice and is best accomplished by "X-ing" the suspected target area.*

1. Once a buried target is identified by a good tone response, continue sweeping the coil over the target in a narrowing side to side pattern.
2. Take visual note of the place on the ground where the "beep" occurs as you move the coil slowly from side to side.
3. Stop the coil directly over this spot on the ground.
4. Now move the coil straight forward and straight back towards you a couple of times.
5. Again make visual note of the spot on the ground at which the "beep" occurs.
6. If needed, "X" the target at different angles to "zero in" on the exact spot on the ground at which the "beep" occurs.

**REMEMBER:** The detector will beep just as the searchcoil passes over the buried object.

If you have difficulty pinpointing very strong signals, try lifting the coil higher off the ground until a weaker, but more concise, signal is heard. For very weak signals, try moving the coil in short quick sweeps, closer to the ground.

# TREASURE HUNTER'S CODE OF ETHICS:

- Always check Federal, State, County and local laws before searching.
- Respect private property and do not enter private property without the owner's permission.
- Take care to refill all holes and leave no damage.
- Remove and dispose of any and all trash and litter found.
- Appreciate and protect our inheritance of natural resources, wildlife and private property.
- Act as an ambassador for the hobby, use thoughtfulness, consideration and courtesy at all times.
- Never destroy historical or archaeological treasures.
- All treasure hunters may be judged by the example you set; always conduct yourself with courtesy and consideration of others

## FIRST TEXAS PRODUCTS, LLC 1-YEAR LIMITED WARRANTY

This detector is warranted against defects in workmanship or materials under normal use for one year from date of purchase to the original user. Liability in all events is limited to the purchase price paid. Liability under this Warranty is limited to replacing or repairing, at our option, any detector returned, shipping cost prepaid, to First Texas Products, LLC. Damage due to neglect, accidental damage or misuse of this product is not covered by this warranty.

**Proof of purchase is required to make a claim under this warranty.**

### **NOTE TO CUSTOMERS OUTSIDE THE U.S.A.**

This warranty may vary in other countries, check with your distributor for details.  
Warranty does not cover shipping costs

According to FCC part 15.21 Changes or Modifications made to this device not expressly approved by the party responsible for compliance could void the users authority to operate this equipment.

This device complies with FCC Part 15 Subpart B Section 15.109 Class B.

Copyright© 2014 by First Texas Products, L.L.C.

All rights reserved, including the right to reproduce this book, or parts thereof, in any form.  
Published by First Texas Products, L.L.C.

**[www.detecting.com](http://www.detecting.com)**

First Texas Products, L.L.C.  
1120 Alza Drive  
El Paso, TX 79907  
(915) 633-8354  
Fax: (915) 633-8529

**Made in China**

Designed in the U.S.A. by First Texas Products  
and manufactured to First Texas Products Bounty Hunter® Specifications.

# ACCESSORIES

## Bounty Hunter® Padded Carry Bag

Rugged double stitched construction. Includes handy exterior pocket for extra batteries or small accessories. *CBAG-W*



## Bounty Hunter® Pouch & Digger Combo –

Pouch with 2 large pockets & 9” heavy duty digging tool. *TP-KIT-W*



## Pin Pointer

Pinpoints the exact location of buried metal objects. Audio signal indicator and vibrator. Runs on 1 – 9-Volt Battery. *PIN POINTER-W*



## Bounty Hunter® Sand Scoop

Large scoop with filtering holes. Made of strong plastic. *SAND SCOOPBH*



## 9” Heavy-Duty Digging Tool

Metal blade with comfortable plastic handle and depth gauge. *TROWEL-2*



## Digging Tool –

Light and practical plastic, wide blade digging tool. *TROWEL-W*

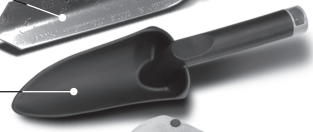

## Bounty Hunter® Baseball Cap –

One size fits all, with Bounty Hunter® logo. *BHCAP*



## Bounty Hunter® T-Shirt –

100% cotton with Bounty Hunter® Logo. Sizes – S, M, LG, XL & XXL. *BHSHIRT*



## Gold Prospecting Kits

### Items Included:

	<b>Gold Kit</b> PART NUMBER: GOLDKIT1	<b>Deluxe Kit</b> PART NUMBER: GOLDKIT2	<b>Hardrock Kit</b> PART NUMBER: GOLDKIT3
10 ½” Gold Pan	x	x	x
14” Gold Pan	x	x	x
Classifier		x	x
2 – Shatterproof Vials	x	x	x
Snuffer Bottle	x	x	x
Black Sand Magnet		x	x
Treasure Scoop		x	x
Tweezers			x
Magnifier			x
Crevice Tool			x
Rock Pick			x
Instruction Booklet	x	x	x
Backpack		x	x



FOR COMPLETE DETAILS VISIT [WWW.DETECTING.COM](http://WWW.DETECTING.COM) • 1-800-413-4131