



CLICK & GROW™

# WALL FARM

ASSEMBLY MANUAL



## List of items:

Unit	Quantity
Button head 3.5x12 mm	28x
Countersunk 3.5x12 mm	17x
Countersunk 3.5x20 mm	6x
Cord clamps (1,3,4-way)	4x
Cross Head Bolt M6x8	6x
Hinges	2x
Lamps	3x
Magnet sets	2x
Plant trays	3x
Plywood frame	1x
Power box	1x
Rafix 20 bolt	36x
Rafix 20 connectors	36x
Refills	54x
Stopper	1x
Thermal plate	2x
Tray holders	6x
Water level sensor	3x
Wire fastener	1x
Tool set	1x

Number of people required to assemble: 2x

Tools required to assemble: 1x

Wear protective gloves



M6x8

**A**



Rafix 20 Bolt

**B**



CS 3.5x12

**C**



CS 3.5x20

**D**



Button head 3.5x12

**E**

- 1 Attach the (B) bolts (anchors) to both of the side panels.

 x 12 (B) per 1 side panel

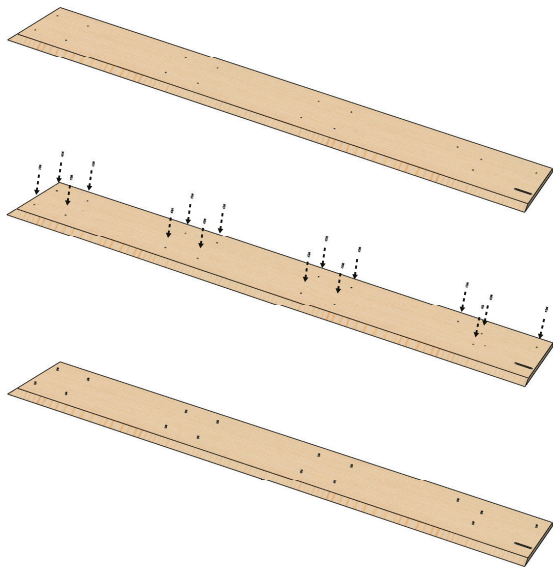
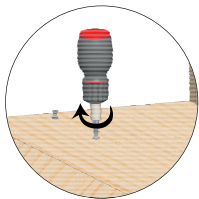

- 2 Attach the hinges to the corresponding cavities on the side panels and on the lower front panel. Hammer them to a tight fit and then use the (C) screws.

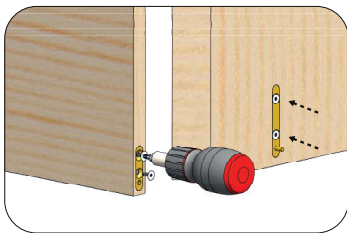
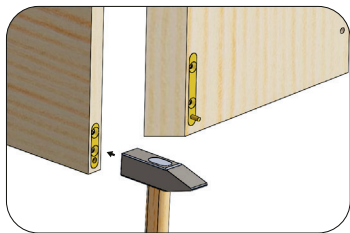
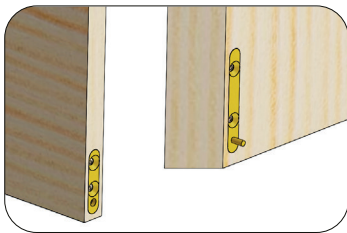
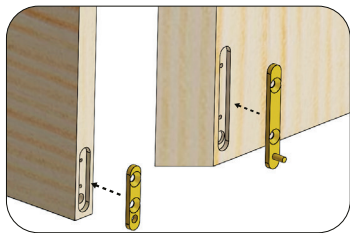

- 3 Attach the Rafix 20 connectors and anchors to the lower panel.  
**Note:** the connectors opening has to be perfectly aligned with the edge of the panel, or it might not fit properly with the anchors. Attach the Rafix connectors to the rest of the panels.

 x 4 per panel

 x 3 (B) per lower panel

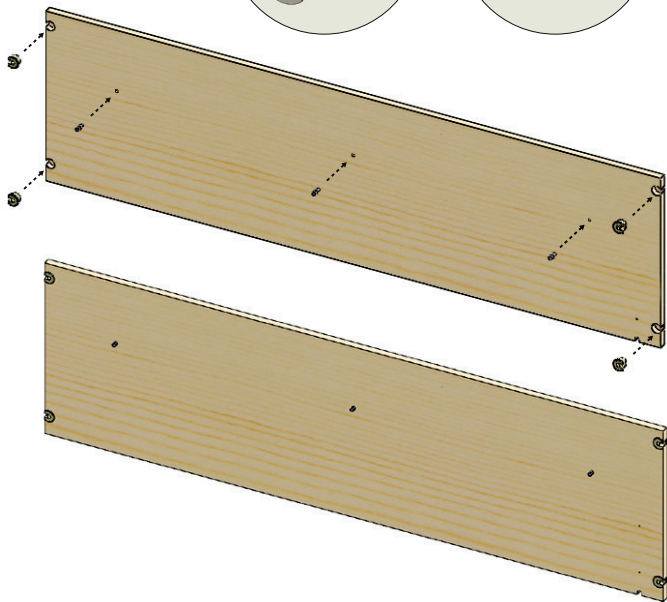
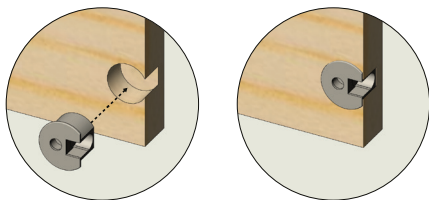

- 4 Attach the lower rear panel to the left side panel with connectors. Attach the connectors with the screwdriver to the anchors by tightening the screws (fix all connectors like this).

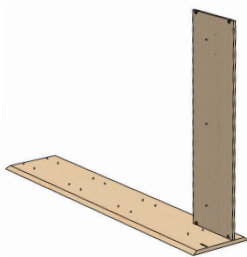
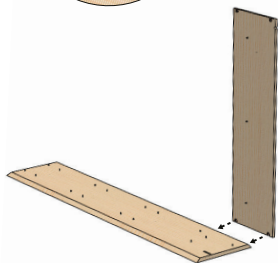
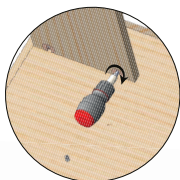

- 5 Attach two edge panels to the left side panel, as shown below. Make sure that these screw holes are at the bottom side of the edge panels.

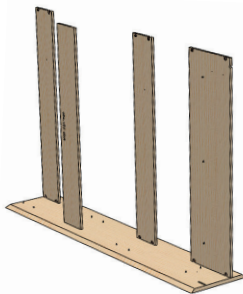
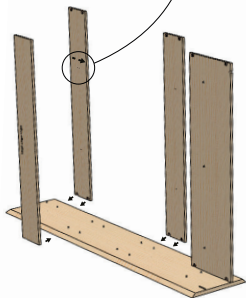

- 6 Attach the tray brackets to the edge panels. Install the power supply box.

 x 4 (E) per bracket

 x 4 (E)

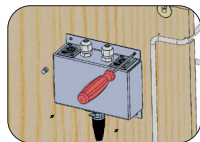
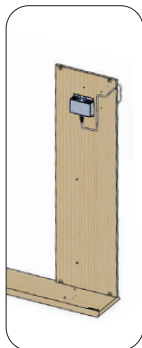
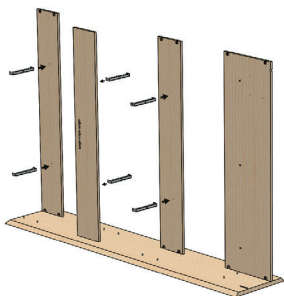

- 7 Attach the lower front, second side and the bottom panel.

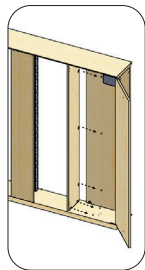
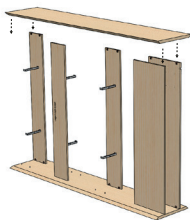
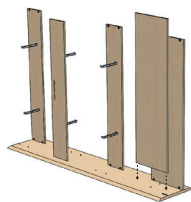



- 8 Attach the power cord fastener.

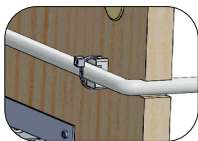
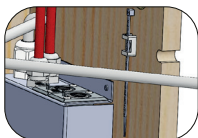
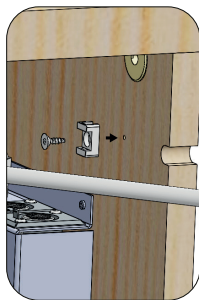

 x 1 (C)

- 9 Attach the magnets to the first tray holder. Attach the magnet knobs to the lower front panel with a hammer. You can regulate the magnet with a regular screwdriver.

 x 2 (C) per magnet

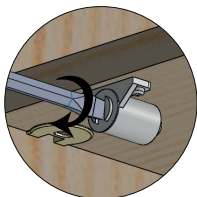
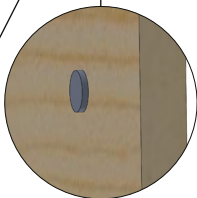
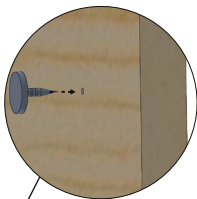
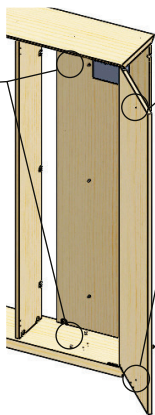
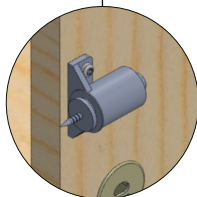
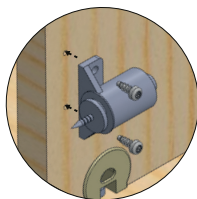

- 10 Attach one end of the stopper to the lower front panel.

 x 2 (C)

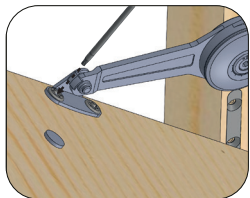

Attach the other end of the stopper to the side panel.

 x 2 (C)

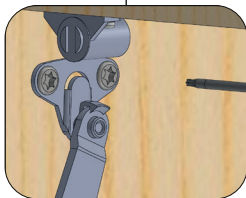
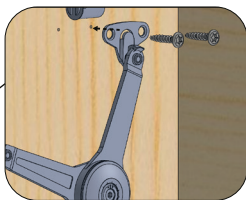
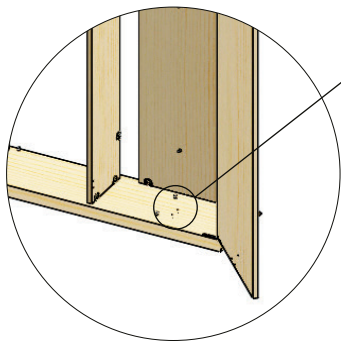

- 11 Lift the Wall Farm into a upright position and attach the rest of the panels.

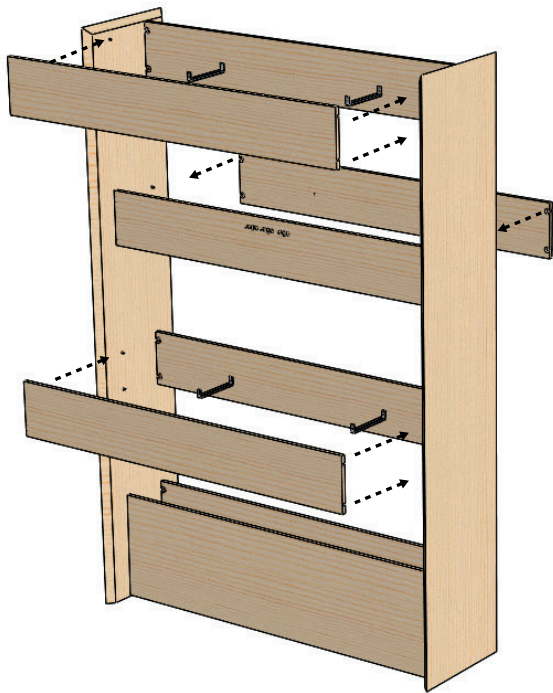

## 12 Attach the lamps and wires.

Connect the lamps using the (A) bolts. Connect the wires to the powerbox.

**Note:** Connect the wires before you completely fix the lamps in their final position. You might want to move them a bit to get the best result. Make sure the wires are not tautened too tight as this might damage them after a while.

 x 2 (A) per lamp

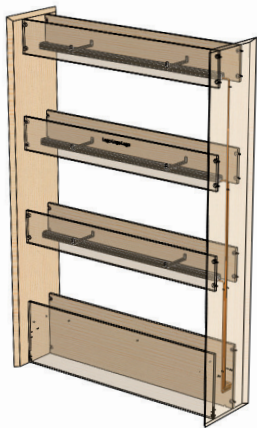
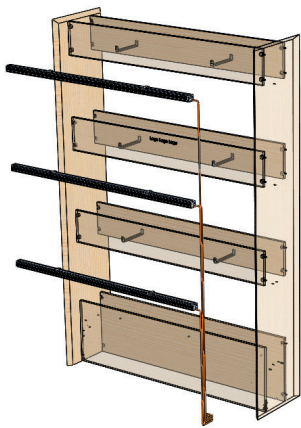
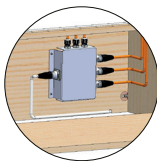
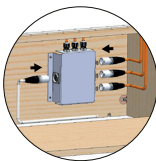
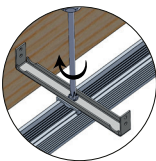
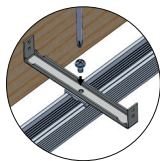

- 13 Place the thermal panels on top of the lower lights.

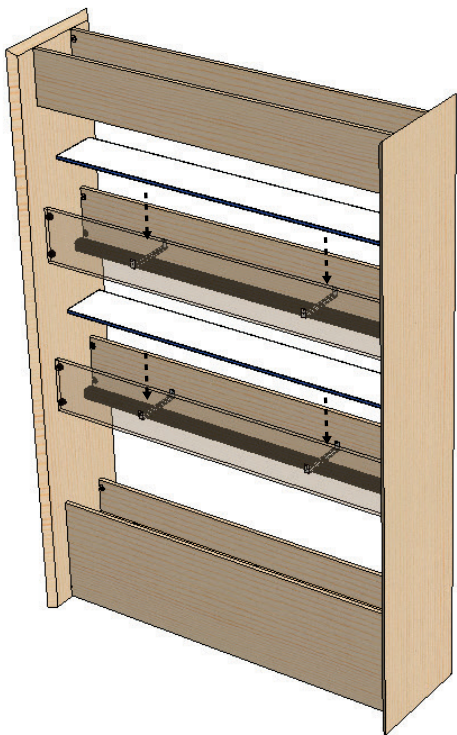

- 14 Attach the water level sensors to the trays. You can tighten it by hand.

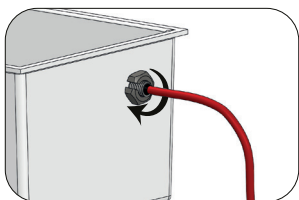
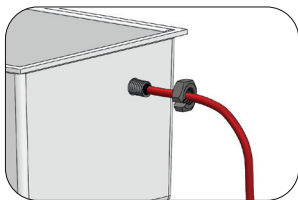
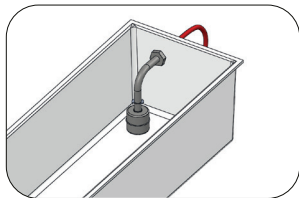
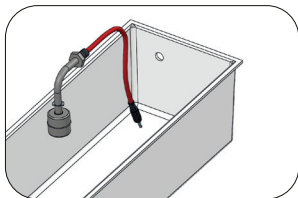

Assemble the trays and add them to the Wall Farm. Connect the water level sensor connectors. If the Wall Farm is plugged in then the lights will flash if there is no water in the trays or if the water level is too low.

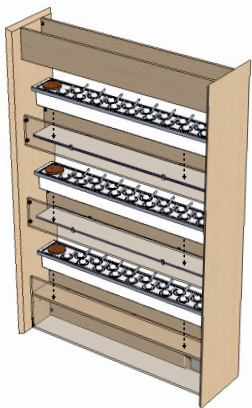
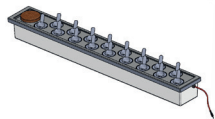
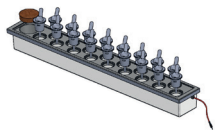

- 15 Install the wooden clamps to hold the wires in place.



x 1 (D) per clamp

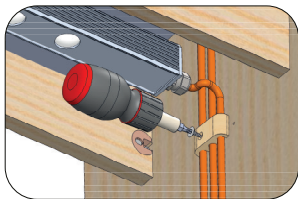

- 16 Add water, refills and plug it in. You are now ready to start growing your own **fresh food**.

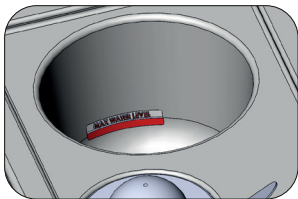
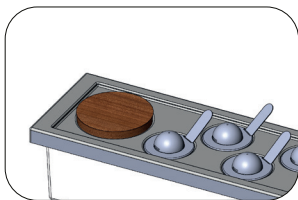
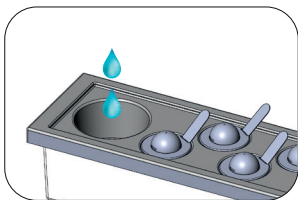

Add water until it reaches the marker. It's time to refill the tank once the lights start to flash.

# Our Selection

The user-logic of Click & Grow gardens is similar to that of Nespresso and Keurig capsule coffee machines only instead of coffee pods, we offer biodegradable pre-seeded plant pods through our website.

Head to our online store and choose from a variety of herbs, fruiting plants, salad greens, flowers and other decorative plants. We are constantly improving our selection. To be the first to know about upcoming plants and receive special offers, subscribe to our mailing list on our website.

Whenever you've used up your edibles, replanted your flowers or feel like it's time to try a new plant, head to [www.clickandgrow.com](http://www.clickandgrow.com) to order refills.



Wild Strawberry



Oregano



Chili Pepper



Yellow Tomato



Dwarf Pea



Yellow Sweet Pepper



Purple Chili



Petunia



Romaine Lettuce



Painted Nettle

*\*Just a few examples of the plants available.*

**The easiest way to always have plant pods on hand is to subscribe to automatic deliveries through our website. Save time and money!**



# Pro Tips for A Perfect Garden

**Salad greens** prefer growing at a temperature range of 64 to 72 °F (18 to 22 °C) for best performance. Higher temperatures will decrease germination. For best quality it is recommended to harvest greens 30 to 35 days after planting - all at once. If you prefer harvesting periodically by cutting off larger outer leaves first - do it within the first 40 days to avoid decreased plant quality. Tip for preventing food waste! Extend usage by wrapping harvested greens in a moist kitchen towel and storing in a fridge.

**Herbs** prefer growing at temperatures from 64 to 79 °F (18 to 26 °C). Herbs like to be cut! First harvest is usually feasible 3 weeks after planting the pods. It is a common rule to leave at least two pairs of true leaves to grow, soon there will be more to harvest. Use sharp scissors for a cut, don't tear the plant. Never allow herbs to grow so tall that they will reach the lamp. They might get burnt. Most herb pods will last at least for 10 weeks. Tip for preventing food waste! Extend usage by drying harvested herbs on a clean paper towel at room temperature, hidden from direct sunlight. Store it in a sealed jar until next cooking.

**Fruiting plants** prefer warmer temperatures up to 79 °F (26 °C). If multiple seeds germinate in a single pod, leave just one seedling to grow in that pod. This ensures there is enough space and nutrients for the plant. Once your plant is flowering, it needs to be pollinated by hand in order to produce fruits. Do this by gently shaking your plant or carrying pollen from one blossom to the next with your finger or a small brush.

**Flowers and other decorative plants** do not require much care. You only need to remove some withered leaves or flowers for more beautiful looking plants. Expect first flowers in about 50 days after planting the pods. Foliage decorative plants, except trees, can be trimmed in order to keep them full and low.

**You can expect sprouts to appear in 1–3 weeks.**

Different plants grow at different paces, so some of them will sprout within a week, while for others it may take up to 3 weeks. Be patient!

**Remember to:**

Remove the germination domes once the plants have sprouted.  
Keep the plastic plant cups and domes. They are reusable for your next growing experience.

# Our Community

## Find us on social media:

@clickandgrow     

## Click & Growers group.

Our unique Click & Growers community is the meeting place for indoor gardeners. See what other gardeners around the world are growing and learn new things about indoor gardening every day. Find Click & Growers on Facebook.

## Click & Growers 'Ask a Gardener' forum.

Start a conversation or ask any gardening related question - our own Click & Grow gardeners are always there to help!  
Head to [gardeners.clickandgrow.com](http://gardeners.clickandgrow.com)

Read the latest plant care tips & tricks on our blog.  
Head to [Blog - News - Click & Grow](#)

We would love to see how your plants are growing!  
Use **#clickandgrow** when you are posting photos on social media

For additional information, visit: <http://support.clickandgrow.com/>

CLICK <sup>A</sup><sub>N</sub><sup>D</sup> GROW™

Out of Plant Pods?

Head to **clickandgrow.com** to get some fresh ones.



@clickandgrow

**Find out more:**

[www.clickandgrow.com](http://www.clickandgrow.com)