

# SQUARE SHOWER DRAIN

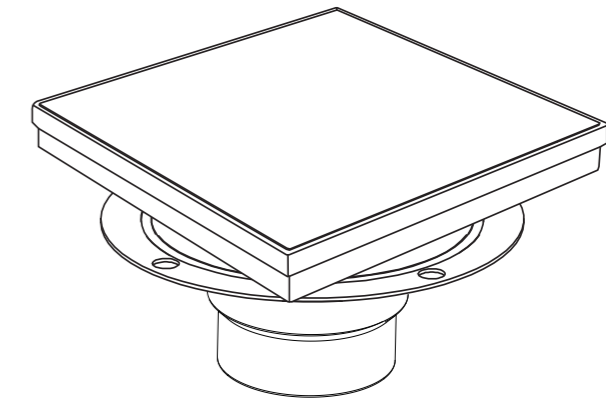

## PARTS INCLUDED



Adapter



Lifting Hook



Strainer

1

Make a tapered hole above the shower drain. The maximum diameter of the upper part of the tapered hole is about 6 1/2". Be careful to avoid the location of the wooden frame supported on the floor.

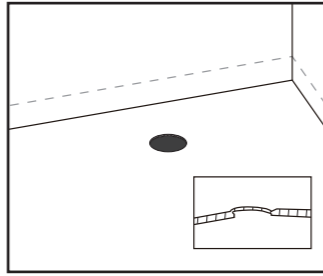

2

Evenly apply a waterproof sealant to the internal flange connected to the drain pipe and the following parts.

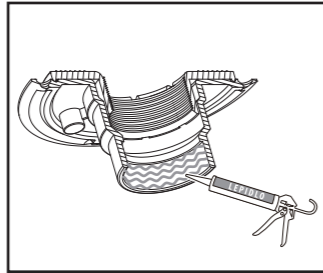

3

Connect the drainpipe to the flange. Drive wood screws into the four holes on the flange edge. The top of the flange should be flush with the top of the wooden floor.

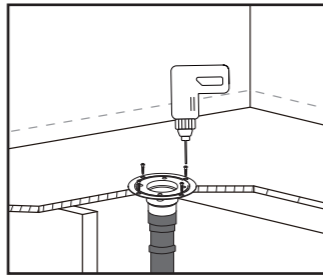

4

Apply sealant to the groove part of the flange and cover a waterproof membrane. Do not cut but fold at the corners of the wall. Extend to a height of at least 6" on the wall and fasten it to the wall.

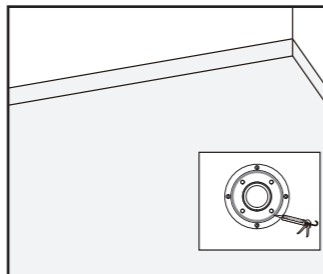

5

Use a utility knife to make an X-shaped cut in the waterproof membrane above the location of the four fixing holes of the clamping ring. In the center of the flanged drain, cut a round hole no larger than 2 inches in the waterproofing membrane. Preload the screws into the flange.

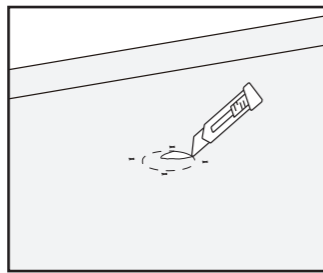

6

Install the clamping ring on the flange, and after rotating to a fixed position, tighten the screws.

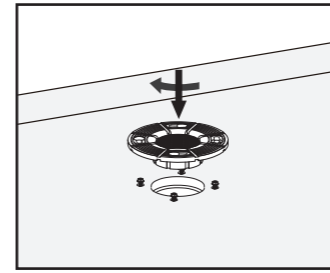

7

Connect the adapter and install it on the flange; (hexagonal thread adapter and rubber adapter are optional)

Lorem ipsum

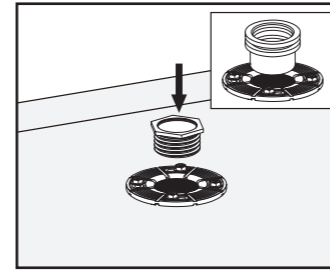

8

After the outer surface of the shower drainpipe is coated with a waterproof sealant, put it into the adapter, and keep it in the correct position and be level.

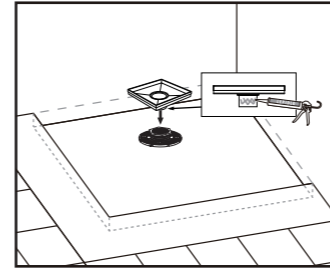

9

The height of the shower drain can be adjusted with the adapter of the shower drain. Make the shower drain slightly lower than the height of the bathroom edge and ensure that there is a slope of 1 degree in both directions (measured with a gradienter).

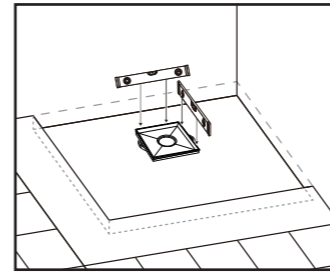

10

Pour water to check whether the connection between the shower drain and the drainpipe is sealed.

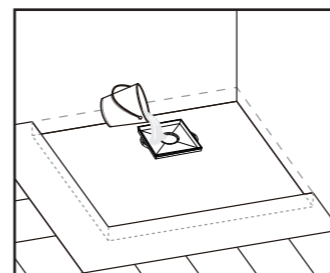

11

Protect the part of the shower drain sump tank to prevent any debris from entering.

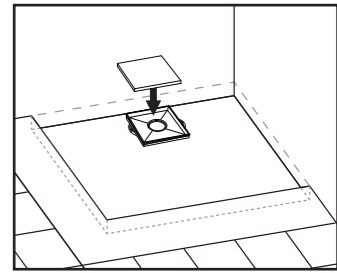

12

Pour the cement to maintain a two-way slope of 1° to ensure that the cement covers the edge of the shower drain.

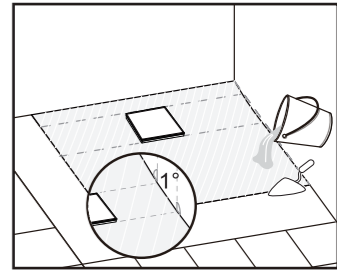

13

Lay the tiles on the shower floor and wait to be fully dry and fixed.

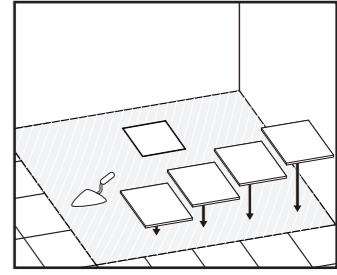

14

Remove protective materials and clean debris in the shower drain sump tank.

Then apply the silicone seal around the floor drain evenly. Wait for the sealant to dry.

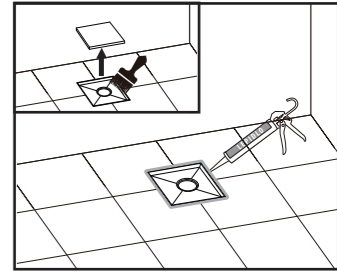

15

Place the shower drain cover in position on top of the drain and gently press it in.

