

King Crawler Creeper

Model 1-200

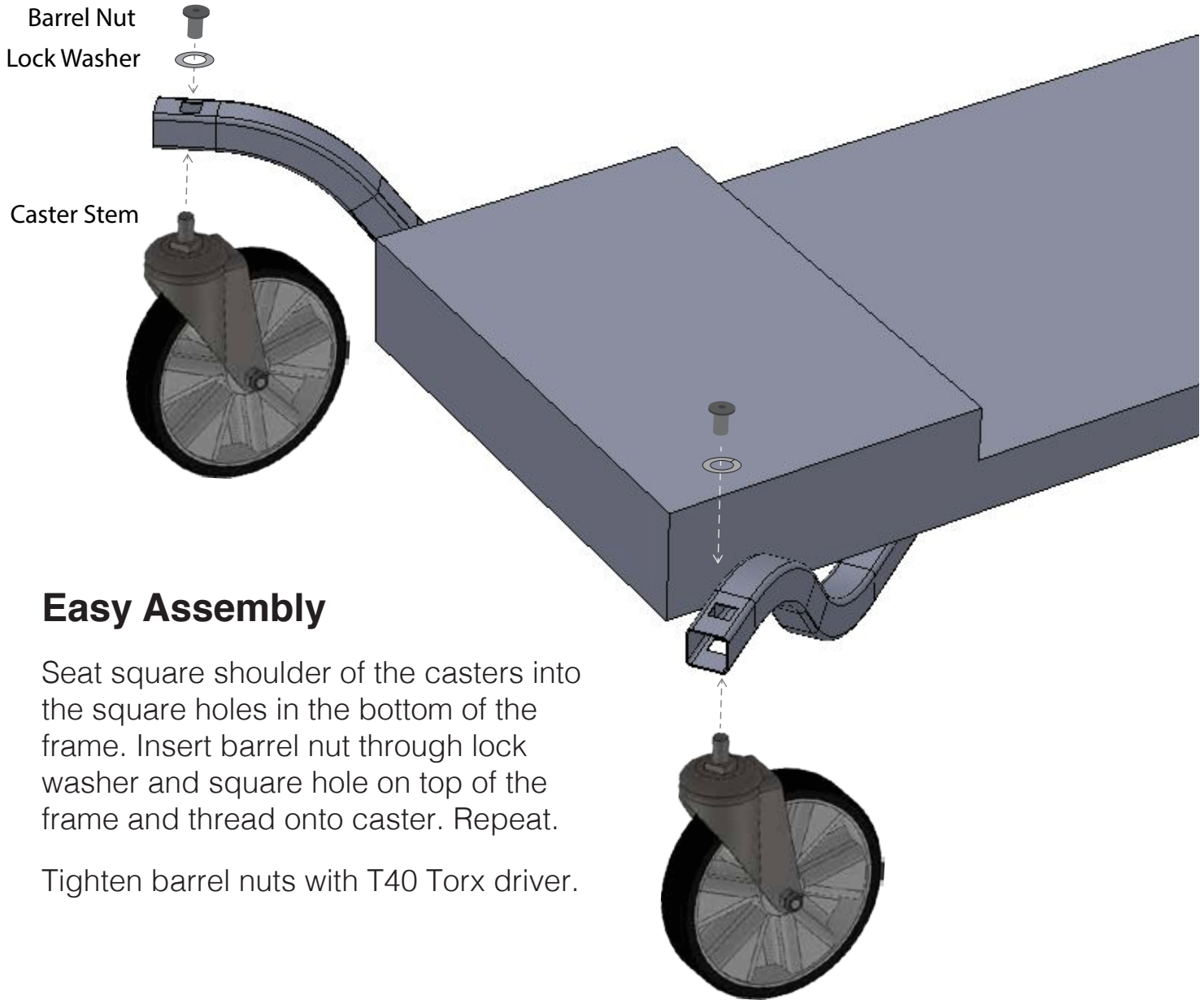

Easy Assembly

Seat square shoulder of the casters into the square holes in the bottom of the frame. Insert barrel nut through lock washer and square hole on top of the frame and thread onto caster. Repeat.

Tighten barrel nuts with T40 Torx driver.

If you have any questions please contact us at:

phone: 479-474-3460

email: service@traxionproducts.com

www.traxionproducts.com