

EXCEPT AS OTHERWISE PROVIDED BY CONTRACT, THIS DRAWING AND SPECIFICATIONS SHALL NOT BE REPRODUCED, COPIED OR USED AS THE BASIS FOR MANUFACTURE OR SALE OF MATTER DEPICTED HEREIN WITHOUT THE EXPRESSED WRITTEN PERMISSION OF THE CLAUDE LAVAL CORPORATION, OR ITS ASSIGNEES.

THIS DRAWING HAS BEEN GENERATED AND IS MAINTAINED BY A CAD SYSTEM. CHANGES SHALL ONLY BE INCORPORATED AS DIRECTED BY AN APPROVED ENGINEERING CHANGE ORDER (ECO). PAPER COPIES ARE UNCONTROLLED.

| REVISIONS | | | | |
|-----------|------|-------------|------|----------|
| ECN | REV. | DESCRIPTION | DATE | APPROVED |
| | | | | |

NOTES:

1. INLET & OUTLET ARE 3/4" MNPT PIPE.
2. MAXIMUM PRESSURE: 150 psi (10.3 bar).
3. MAXIMUM TEMPERATURE: 180°F (82.2°C).
4. PRESSURE LOSS: 5-12 psid (.3-.8 bar) AT RATED FLOW.
5. RATED FLOW: 10-20 gpm (2.5-4.5 m³/hr).
6. APPROXIMATE DRY WEIGHT: 23 lbs (10 kg).
7. FINISH: GLASS BLAST (EXTERIOR ONLY).

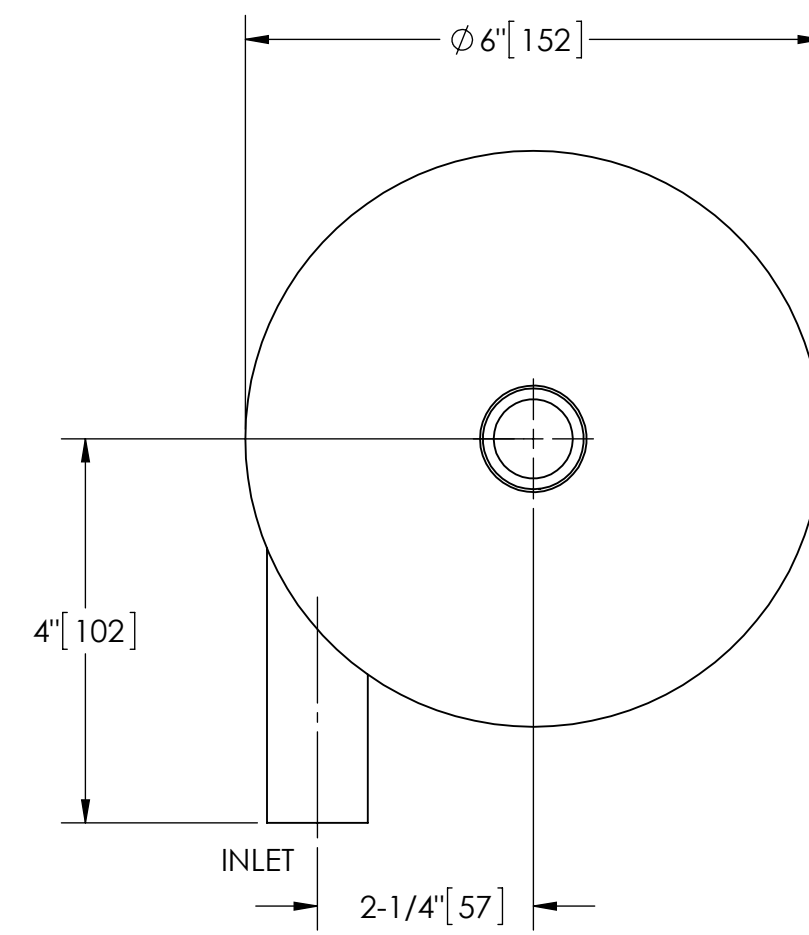
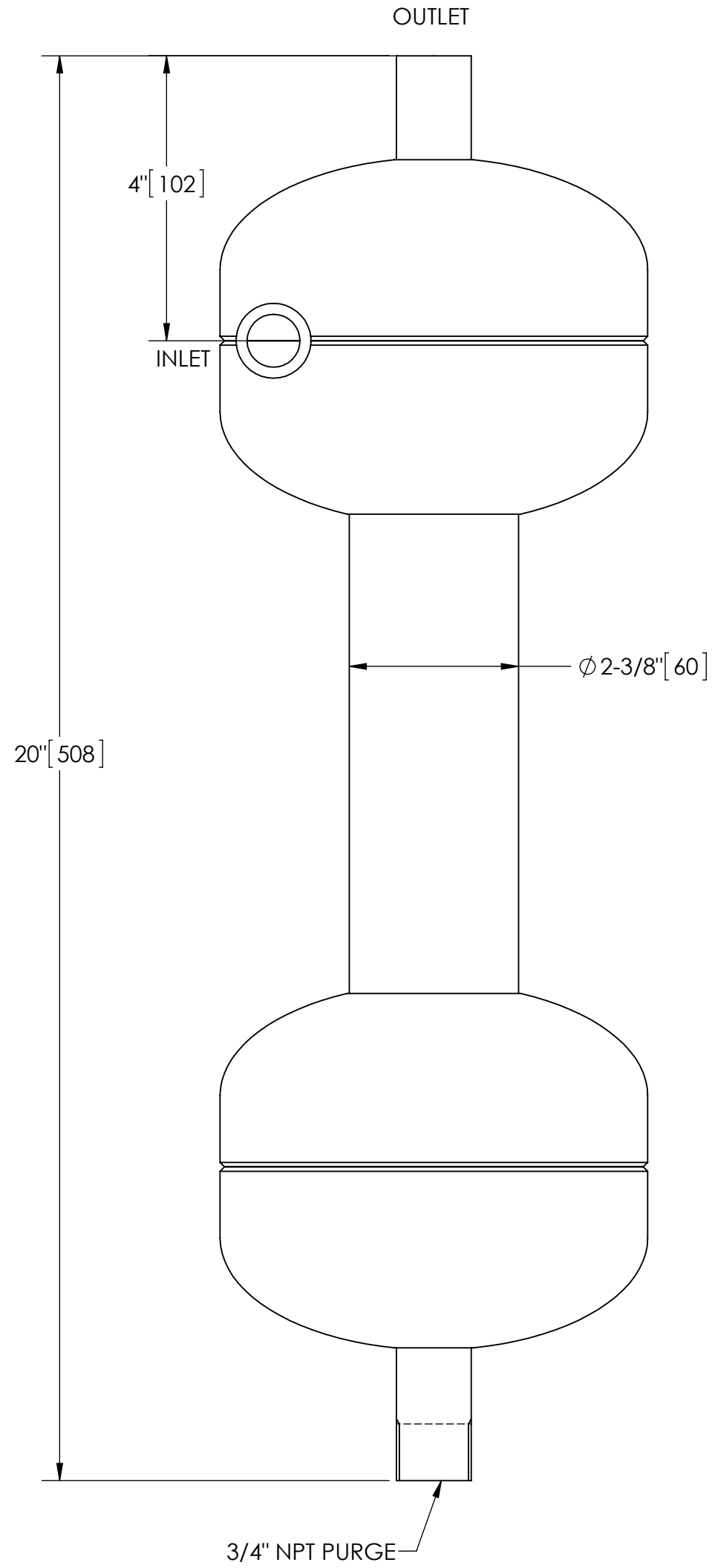

TOP VIEW

SUBMITTAL DRAWING

This drawing is submitted for spatial consideration only. Do not pre-plumb to these dimensions.

| | | | | | | | |
|--|---|------------------------------------|--|---|-----------|--|-------------------|
| UNLESS OTHERWISE SPECIFIED: DIMENSIONS ARE IN: INCHES [mm] TOLERANCES ARE: | | ENGINEERED FOR: STANDARD | | CLAUDE LAVAL CORP. FRESNO, CALIFORNIA 93727 WWW.LAKOS.COM | | LAVAL UNDERGROUND SURVEYS | |
| FRACTIONS ± 1/4" | DECIMALS .XX ± .01 .XXX ± .005 .XXXX ± .0005 | ANGLES ± 1/4° | | APPROVALS | DATE | TITLE | |
| DO NOT SCALE DRAWING | | | | DRAWN AMF | 2/17/09 | ILS-0075, SEPARATOR, 10-20 gpm, 316L SS | |
| MATERIAL TYPE 316L STAINLESS STEEL | | ENGR JBI | | 4/15/09 | SIZE C | | |
| FINISH GLASS BLAST | | MFG - | | - | MODEL NO. | | DWG NO. 100291 |
| WORK ORDER | | QTY. | | SCALE 1:2 | | EST. WT. 23 lb | SHEET 1 OF 1 |

DWG NO. 100291
SHEET 1
REV. C