

40-724-1

INSTALLATION TIP:
WHEN REMOVING OEM RUBBER BUSHING FROM STEEL
SLEEVE DRILL 1/8" HOLE THRU RUBBER AND KNOCK
OUT CENTER.

DO NOT REMOVE
OEM STEEL SLEEVE PRESSED
INTO REAR HOUSING. REMOVE
RUBBER FROM SLEEVE AND
REPLACE WITH POLY BUSHING

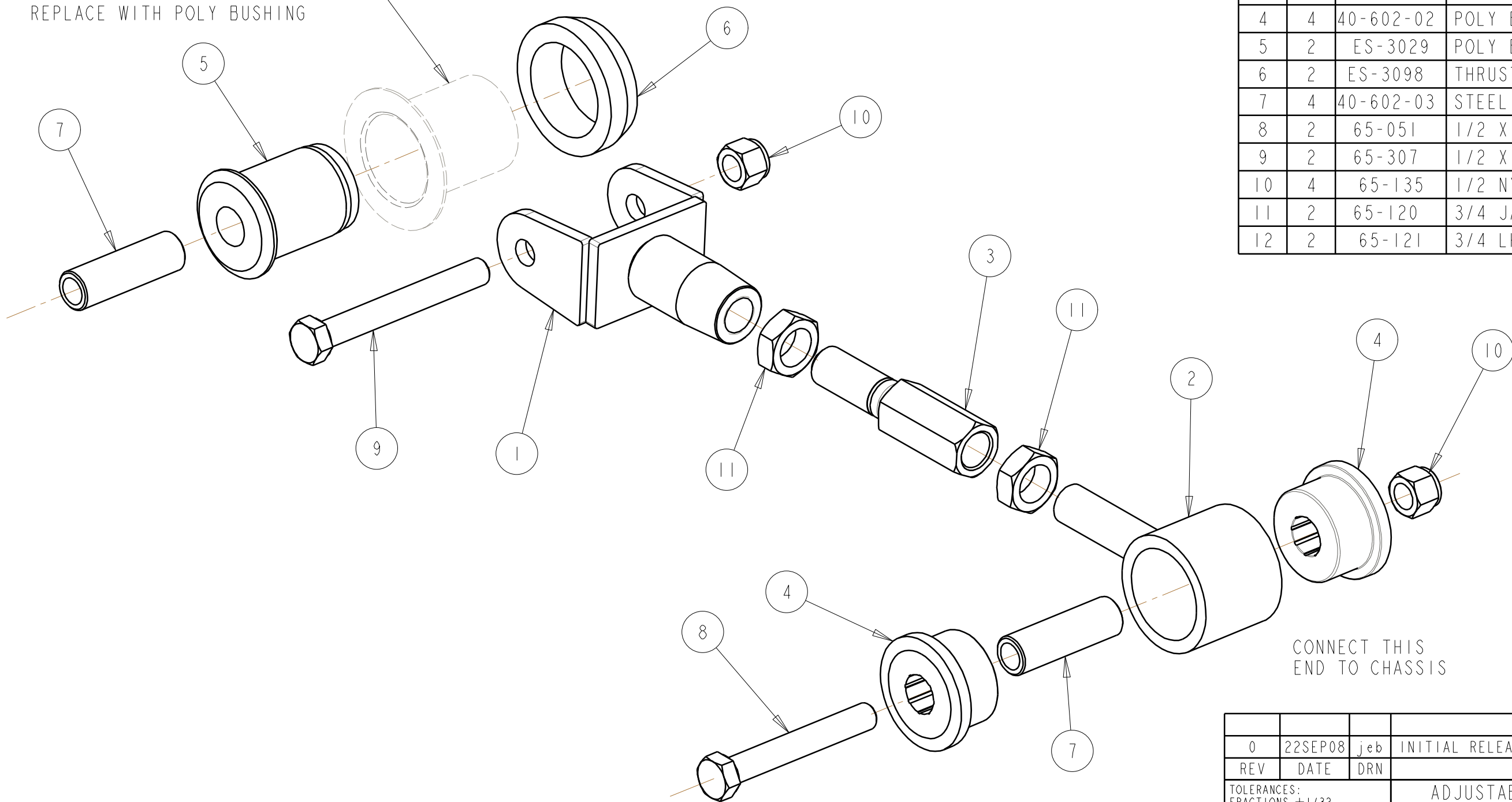

CONNECT THIS
END TO CHASSIS

BILL OF MATERIALS

ITEM	QTY	PART No.	DESCRIPTION
1	2	40-724-01	CONTROL ARM U-BRKT
2	2	40-724-02	OUTER SLEEVE w/THREADED STUD
3	2	65-1001	HEX ADJUSTER
4	4	40-602-02	POLY BUSHING
5	2	ES-3029	POLY BUSHING
6	2	ES-3098	THRUST WASHER
7	4	40-602-03	STEEL INNER SLEEVE
8	2	65-051	1/2 X 3 1/2" LG BOLT
9	2	65-307	1/2 X 4" LG BOLT
10	4	65-135	1/2 NYLOCK NUT
11	2	65-120	3/4 JAM NUT
12	2	65-121	3/4 LH JAM NUT

0	22SEP08	jeb	INITIAL RELEASE
REV	DATE	DRN	DESCRIPTION
TOLERANCES: FRACTIONS ±1/32 2 PLC DEC ±0.01 3 PLC DEC ±0.005 ANGLES ±0.5°			ADJUSTABLE UPPER CONTROL ARM 79-04 MUSTANG GENERAL ARRANGEMENT
MAT'L:			
PART No: 40-724			DRW No: 40-724 - 1

S & W RACE CARS
11 MENNONITE CHURCH RD
SPRING CITY, PA 19475

INSTALLATION INSTRUCTIONS

1. RAISE THE CAR AND SUPPORT THE FRAME AND REAR HOUSING SO THAT THEY CAN NOT MOVE WHEN THE CONTROLL ARMS ARE REMOVED.
2. REMOVE & INSTALL ONE UPPER CONTROLL ARM AT A TIME.
REMOVE ONE CONTROLL ARM.
3. ASSEMBLE THE U-BRACKET, HEX ADJUSTER & JAM NUTS. LIGHTLY GREASE O.D. OF FRONT POLY BUSHING IN INSTALL IN OUTER SLEEVEw/STUS, GREASE O.D. OF INNER STEEL SLEEVE AND PUSH INTO POLY BUSHINGS. SCREW OUTER SLEEVE & JAM NUT INTO HEX ADJUSTER. ADJUST THE NEW CONTROL ARM LENGTH THE SAME AS THE STOCK ARM (9 3/8" ON CENTERS). DO NOT TIGHTEN JAM NUTS AT THIS POINT.
4. THE NEW BUSHING SET FOR THE REAR HOUSING DOES NOT INCLUDE NEW SLEEL OUTER SHELLS. YOU MUST REUSE THE ORIGINAL SHELLS THAT ARE PRESSED INTO THE CAST LUGS ON YOUR REAR HOUSING. DO NOT PRESS OUT THE STEEL OUTER SHELLS. LEAVE THE SHELLS IN THE REAR HOUSING. REMOVE THE ORIGINAL RUBBER BUSHING AND STEEL INNER SLEEVE. MAKE SURE THE INSIDE SURFACE OF THE SHEEL IS FREE OF ALL OLD BUSHING MATERIAL. COAT THE INSIDE SURFACE OF THE SHELL WITH THE SUPPLIED GREASE.
COAT THE O.D. OF THE URETHANE BUSHING, O.D. OF STEEL INNER SLEEVE AND FLANGES OF BUSHING WITH THE SUPPLIED GREASE.
5. INSTALL THE NEW UPPER CONTROLL ARM. BOLT THE U-BRACKET TO THE REAR HOUSING. INSERT A SPACER BUSHING INTO EACH SIDE OF THE FRONT ROD END. SWING THE CONTROL ARM INTO PLACE. YOU MAY HAVE TO ADJUST THE LENGTH OR JACK THE REAR UP SLIGHTLY TO GET THE BOLT IN. DO NOT TIGHTEN THE BOLTS AT THIS TIME.
6. REPEAT THE ABOVE STEPS FOR THE OTHER SIDE.
7. WITH THE CAR AT RIDE HEIGHT AND ALL OF THE WEIGHT BEING SUPPORTED BY THE SUSPENSION CHECK THE PINION ANGLE. PINION ANGLE SHOULD BE 0° - 1 1/2° DOWN. TO ADJUST PINION ANGLE REMOVE ONE OF THE U-BRACKET BOLTS AND TURN THE HEX ADJUSTER ON THE OTHER CONTROL ARM. TIGHTEN THE JAM NUTS ON THE ARM YOU ADJUSTED. ADJUST THE OTHER LINK AND BOLT IT IN. TIGHTEN THE JAM NUTS. TIGHTEN THE FRONT AND REAR NUTS & BOLTS OF BOTH CONTROL ARMS.

REV	DATE	DRN	DESCRIPTION
0	22SEP08	JEB	INITIAL RELEASE
TOLERANCES: FRACTIONS ±1/32 2 PLC DEC ±0.01 3 PLC DEC ±0.005 ANGLES ±0.5°			ADJUSTABLE UPPER CONTROL ARM 79-04 MUSTANG GENERAL NOTES
MAT'L:			
PART No: 40-724			DRW No: 40-724 - 2

S & W RACE CARS
11 MENNONITE CHURCH RD
SPRING CITY, PA 19475