

40-622-1

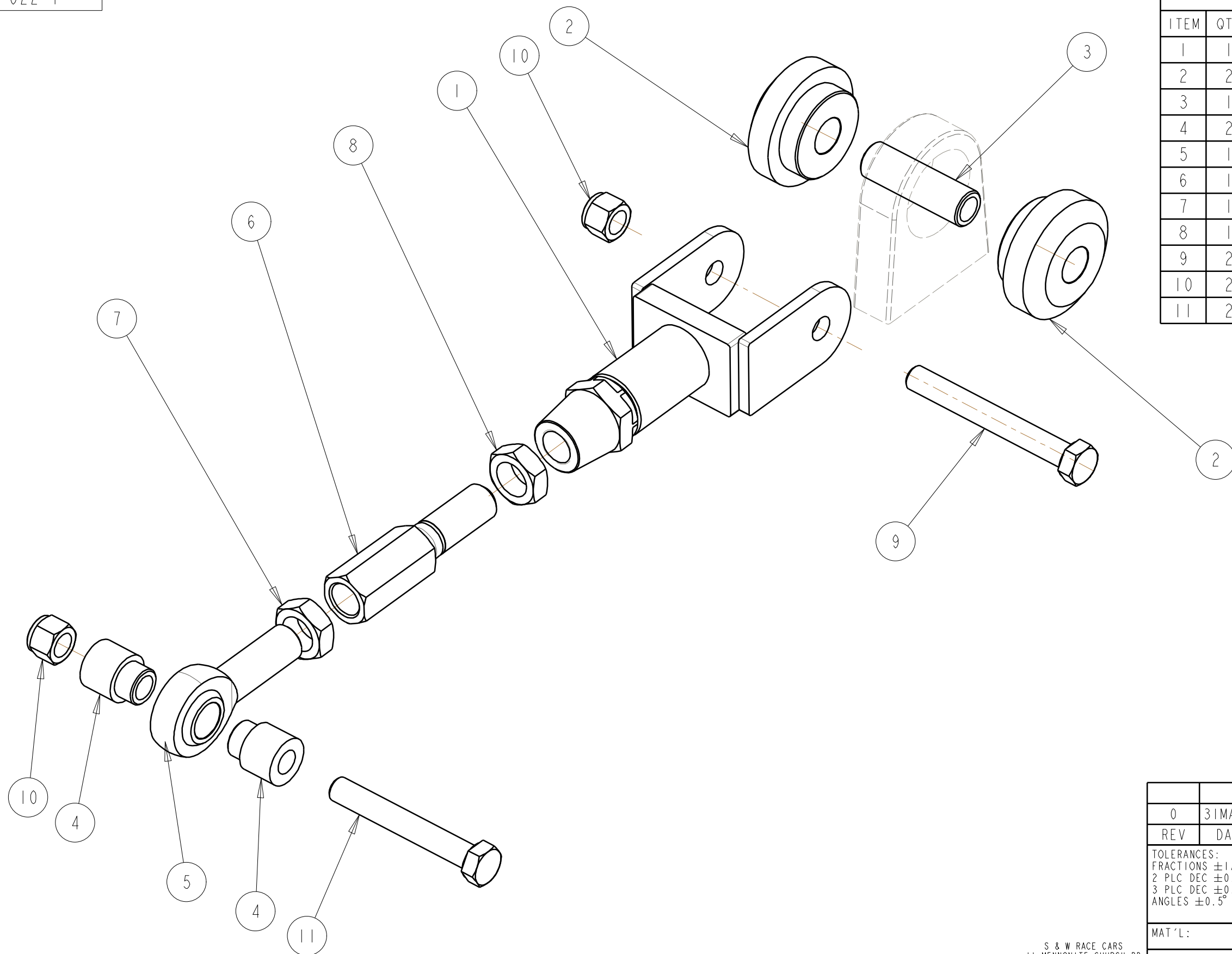

BILL OF MATERIALS

ITEM	QTY	PART No.	DESCRIPTION
1	1	40-622-01	HOUSING LINK
2	2	40-622-02	ALUM BUSHING - HSG LUG
3	1	40-602-03	STEEL SLEEVE-BUSHING
4	2	40-723-03	SPACER-BUSHONG
5	1	64-212	3/4 X 3/4 RHM ROD END
6	1	65-1001	HEX ADJUSTER
7	1	65-120	3/4 JAM NUT
8	1	65-121	3/4 LH JAM NUT
9	2	65-052	1/2 X 4" LG BOLT
10	2	65-135	1/2 NYLOCK NUT
11	2	65-051	1/2 X 3-1/2" LG BOLT

0	31MARIO	JEB	INITIAL RELEASE
REV	DATE	DRN	DESCRIPTION
TOLERANCES: FRACTIONS ±1/32 2 PLC DEC ±0.01 3 PLC DEC ±0.005 ANGLES ±0.5°			COMPETITION UPPER CONTROL ARM GENERAL ARRANGEMENT
MAT'L:			
PART No: 40-622			DRW No: 40-622 - 1

S & W RACE CARS  
 11 MENNONITE CHURCH RD  
 SPRING CITY, PA 19475

INSTALLATION INSTRUCTIONS

1. RAISE THE CAR AND SUPPORT THE FRAME AND REAR HOUSING SO THAT THEY CAN NOT MOVE WHEN THE CONTROLL ARMS ARE REMOVED. REMOVE & INSTALL ONE UPPER CONTROLL ARM AT A TIME.
2. REMOVE ONE CONTROLL ARM.
3. ASSEMBLE THE HOUSING LINK, HEX ADJUSTER, ROD END & JAM NUTS. ADJUST THE LENGTH OF THE NEW CONTROL ARMS TO BE THE SAME AS THE STOCK ARMS.
4. REMOVE THE ORIGINAL RUBBER BUSHING FROM THE LUG ON THE TOP OF THE REAR HOUSING. MAKE SURE THE INSIDE SURFACE OF THE LUG IS CLEAN & FREE OF ANY OLD BUSHING MATERIAL. COAT THE INSIDE SURFACE OF THE LUGS WITH NEVER SEEZE. INSERT THE ALUMINUM SPACERS INTO THE HOUSING LUG. COAT THE O.D. OF THE STEEL INNER SLEEVE WITH NEVER SEEZE AND INCERT INTO ALUMINUM SPACERS. COAT THE FACES OF ALUMINUM SPACERS.
5. INSTALL THE NEW UPPER CONTROLL ARM. BOLT THE U-BRACKET TO THE REAR HOUSING. INSERT A SPACER BUSHING INTO EACH SIDE OF THE FRONT ROD END. SWING THE CONTROL ARM INTO PLACE. YOU MAY HAVE TO ADJUST THE LENGTH OR JACK THE REAR UP SLIGHTLY TO GET THE BOLT IN. DO NOT TIGHTEN THE BOLTS AT THIS TIME.
6. REPEAT THE ABOVE STEPS FOR THE OTHER SIDE.
7. WITH THE CAR AT RIDE HEIGHT AND ALL OF THE WEIGHT BEING SUPPORTED BY THE SUSPENSION CHECK THE PINION ANGLE. PINION ANGLE SHOULD BE 0° - 1 1/2° DOWN. TO ADJUST PINION ANGLE REMOVE ONE OF THE U-BRACKET BOLTS AND TURN THE HEX ADJUSTER ON THE OTHER CONTROL ARM. TIGHTEN THE JAM NUTS ON THE ARM YOU ADJUSTED. ADJUST THE OTHER LINK AND BOLT IT IN. TIGHTEN THE JAM NUTS. TIGHTEN THE FRONT AND REAR NUTS & BOLTS OF BOTH CONTROL ARMS.

S & W RACE CARS  
11 MENNONITE CHURCH RD  
SPRING CITY, PA 19475

0	31MARIO	JEB	INITIAL RELEASE
REV	DATE	DRN	DESCRIPTION
		COMPITITION UPPER CONTROL ARM INSTALLATION NOTES	
		Part No: 40-622	DWR No: 40-622 - 2