



S&W Race Cars and Components, Inc.

11 Mennonite Church Road
Spring City, PA 19475

TECH & INFORMATION: 610-948-7303

ORDERS: 1-800-523-3353

FAX: 610-948-7342

CAUTION!!! - The most important requirement for a successful installation of this, or any, S&W chassis component is that you take your time and use good common sense. Check & recheck all measurements before cutting or welding. If at any time before or during the installation you have any questions - STOP - and call our tech line at 610-948-7303 and we will gladly explain in more detail any step in the installation.

Please read complete instructions thoroughly before beginning!

Installation Instructions for Aluminum Floor Kits Part # s 10-800 & 10-801

- 1) Before you begin the installation of your floor kit you must have the welded frame and wheel tubs completely installed.
- 2) The next step should be to install the four outer panels, these panels will be located against the quarter panels of the car, see diagram item #s 5 & 6.
- 3) To keep from damaging the aluminum panels make a cardboard template of each panel, trimming the cardboard to fit tight against the quarter panels and on top of the frame rails.
- 4) Trim the 4 aluminum panels using your cardboard templates to fit from the frame rails to the quarter panels. Use the 1/8" pop rivets to hold the panels to the frame rails.
- 5) Use a body sealer on the top-side and bottom-side of the 4 panels to seal them to the quarter panel.
- 6) Make 3 cardboard templates for the 3 middle panels. Make the templates so the panels will overlap the outer panels.
- 7) Using the templates you made in step # 5 trim the middle panels to fit, and use the 1/8" pop rivets to hold the panels to the frame rails. When trimming the panels, you should trim equal amounts off each side of the panel. Do not cut all the material off one side of the panels.

Note: if you choose to have your panels removable, you can use S&W Race Cars part number 10-803 Dzus fasteners kit to hold the panels in place instead of pop rivets.

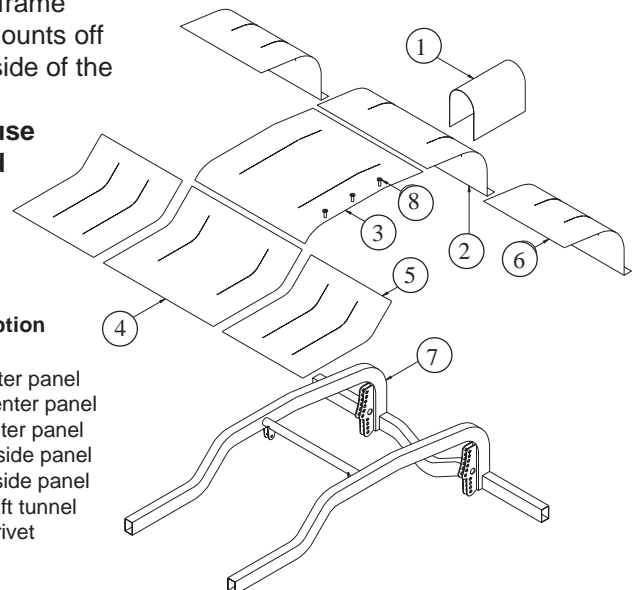
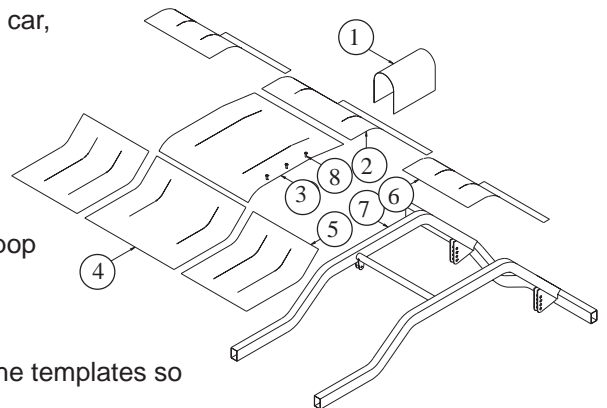

Parts list

item	For PT# 10-800			For PT # 10-801		
	Qty	PT #	Description	Qty	PT#	Description
4	(1)	10-800-1	Rear center panel	(1)	10-800-1	Rear center panel
3	(1)	10-800-2	Middle center panel	(1)	10-800-2	Middle center panel
2	(1)	10-800-3	Front center panel	(1)	10-801-3	Front center panel
6	(2)	10-800-4	Front out side panel	(2)	10-801-4	Front outside panel
5	(2)	10-800-5	Rear outside panel	(2)	10-800-5	Rear outside panel
1	(1)	10-800-6	Drive shaft tunnel	(1)	10-800-6	Drive shaft tunnel
8	(60)	65-801	1/8" pop rivet	(60)	65-801	1/8" pop rivet