

05-030 MOUNTING INSTRUCTIONS

1. CAR SHOULD BE IN RACE TRIM AND ON A LEVEL SURFACE.
2. ASSEMBLE WING, SPILL PLATES, FRONT & BACK UPRIGHTS AND AXLE MOUNTING TAB.
3. THE ROD END ON THE REAR UPRIGHT SHOULD HAVE 3 TO 4 THREADS SHOWING WITH THW JAM NUT AGAINST THE TUBE END.
4. PUT THE WING ASSEMBLY ON THE FRONT AXLE. CENTER THE WING BETWEEN THE FRONT TIRES. CHECK THAT THE SIDE TO SIDE ANGLE IS FLAT. POSITION THE WING SO THAT THE CORD ANGLE IS ZERO. THIS IS CHECKED BY PUTTING A LEVEL ON THE WING AND MOVING THE WING ASSEMBLY SO THAT THE LEVEL IS HORIZONTAL. DO NOT CHANGE THE LENGTH OF THE ROD ENDS WHEN SETTING THE INITIAL WING MOUNTING ANGLE.
NOTE; IF YOUR WIGN HAS A WICKER ON THE TRAILING EDGE DO NOT PUT THE LEVEL ON THE WICKER. THE BACK OF THE LEVEL SHOULD SIT ON THE WING SURFACE.
5. CHECK ALL MEASUREMENTS AND ANGLES. TACK WELD BRACKETS TO AXLE. TRIM 1/8" SPREADER PLATES TO FIT BETWEEN FRONT & BACK UPRIGHTS. LOCATE THEM APPROXIMATELY HALFWAY BETWEEN THE AXLE AND BOTTOM OF THE WING AND TACK IN PLACE.
6. REMOVE WING FROM CAR. WELD BOTH SIDE OF EACH BRACKET TO AXLE. WELD SPREADER PLATE TO UPRIGHTS.

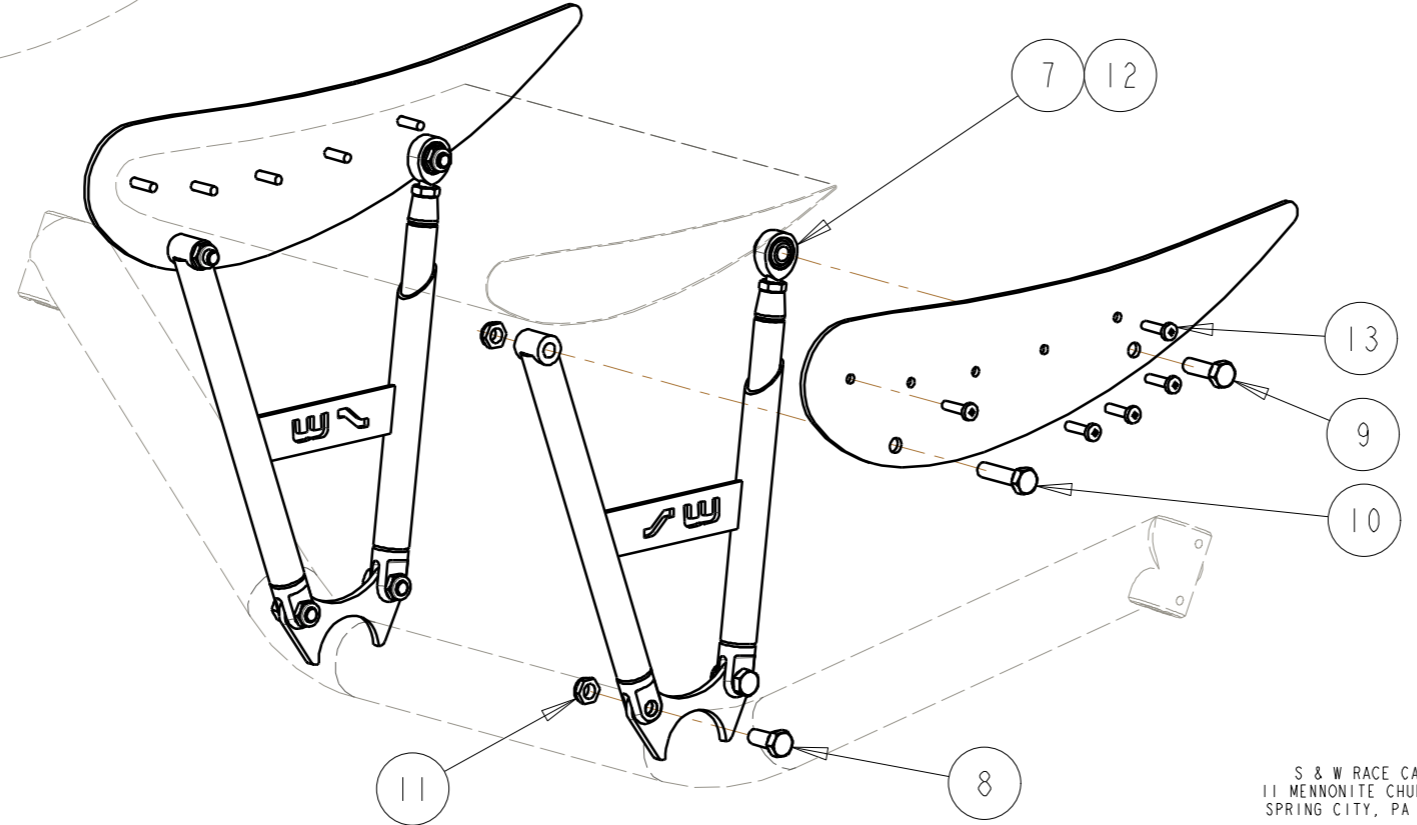

BILL OF MATERIALS

ITEM	QTY	PART No.	DESCRIPTION
1	1	05-226-12	FRONT WING
2	2	05-030-01	SPILL PLATE - FED WING
3	2	05-030-02	WING UPRIGHT - BACK
4	2	05-030-03	WING UPRIGHT - FRONT
5	2	05-030-04	SPREADER PLATE
6	2	60-340	WING MNT TAB - FED FRT AXLE
7	2	64-105	5/16 RHM STD ROD END
8	4	65-012	5/16 X 3/4" BOLT
9	2	65-013	5/16 X 1" BOLT
10	2	65-014	5/16 X 1-1/4" BOLT
11	8	65-142	5/16 NYLOCK HALF NUT
12	2	65-111	5/16 JAM NUT
13	10	65-524	10-24 X 3/4 SCREW

0	29MAR11	JEB	INITIAL RELEASE
REV	DATE	DRN	DESCRIPTION
TOLERANCES: FRACTIONS ±1/32 2 PLC DEC ±0.01 3 PLC DEC ±0.005 ANGLES ±0.5°			FED FRONT WING & MNTG KIT GENERAL ARRANGEMENT
MAT'L:			
PART No: 05-030			DRW No: 05-030 - 1