

		Display Technologies Ltd www.displaytechnologies.co.uk info@displaytechnologies.co.uk		SIZE <b>A4</b>	TITLE <b>DT-CM-XL FIXED PROJECTOR CEILING MOUNT</b>	
				SCALE <b>1:4</b>		
		UNLESS OTHERWISE SPECIFIED, DIMENSIONS ARE IN MILLIMETERS			QUOTE REF. <b>DT-CM</b>	
APPROVAL SIGNATURE	Approval Date	ALL DRAWINGS ARE SUBJECT TO CHANGE AS WE CONTINUALLY DEVELOP OUR PRODUCTS WHICH FROM TIME TO TIME WE WILL RELEASE AS PART OF OUR CONTINUAL IMPROVEMENT PROCESS. DRAWINGS ARE SUBJECT TO OUR NORMAL MANUFACTURING TOLLERANCE.			DATE 2022-05-20	SHEET <b>1 of 4</b>

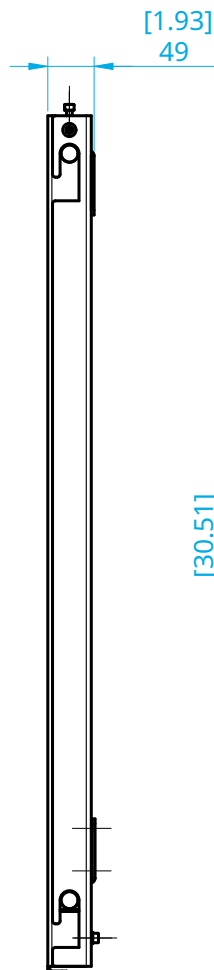

### Fixing locations

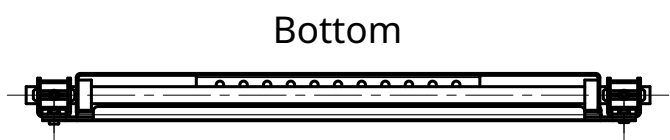
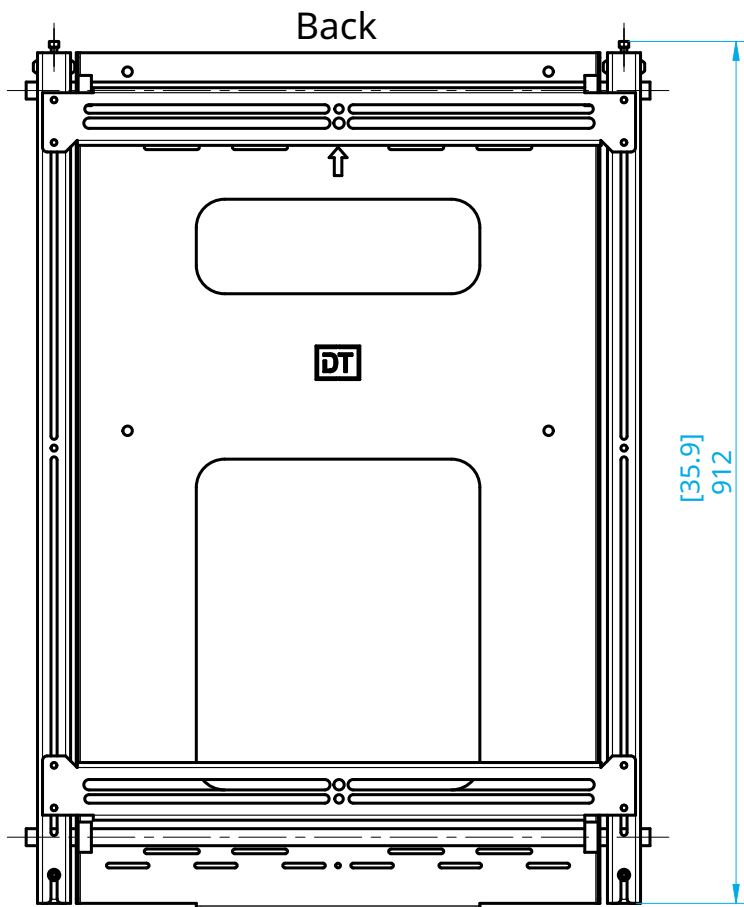
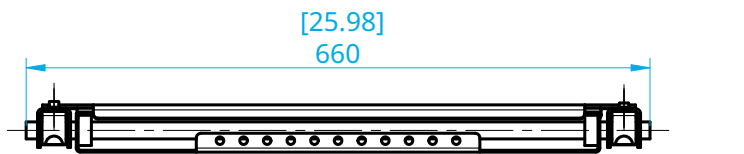
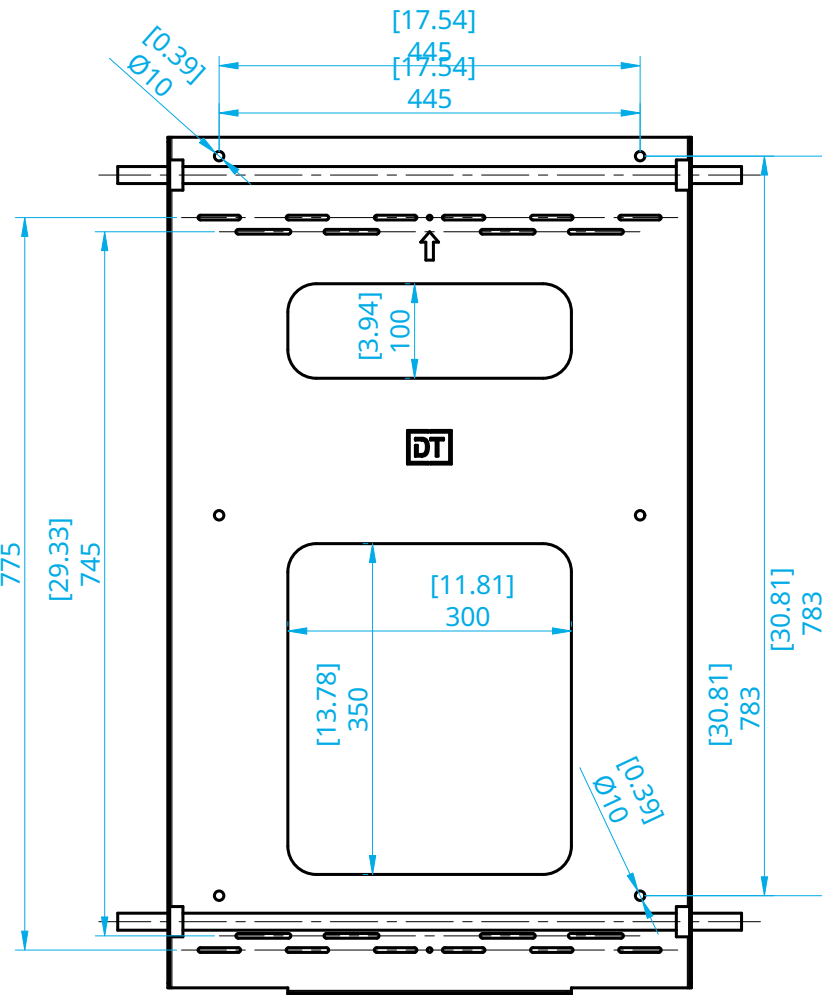

Back Plate Only

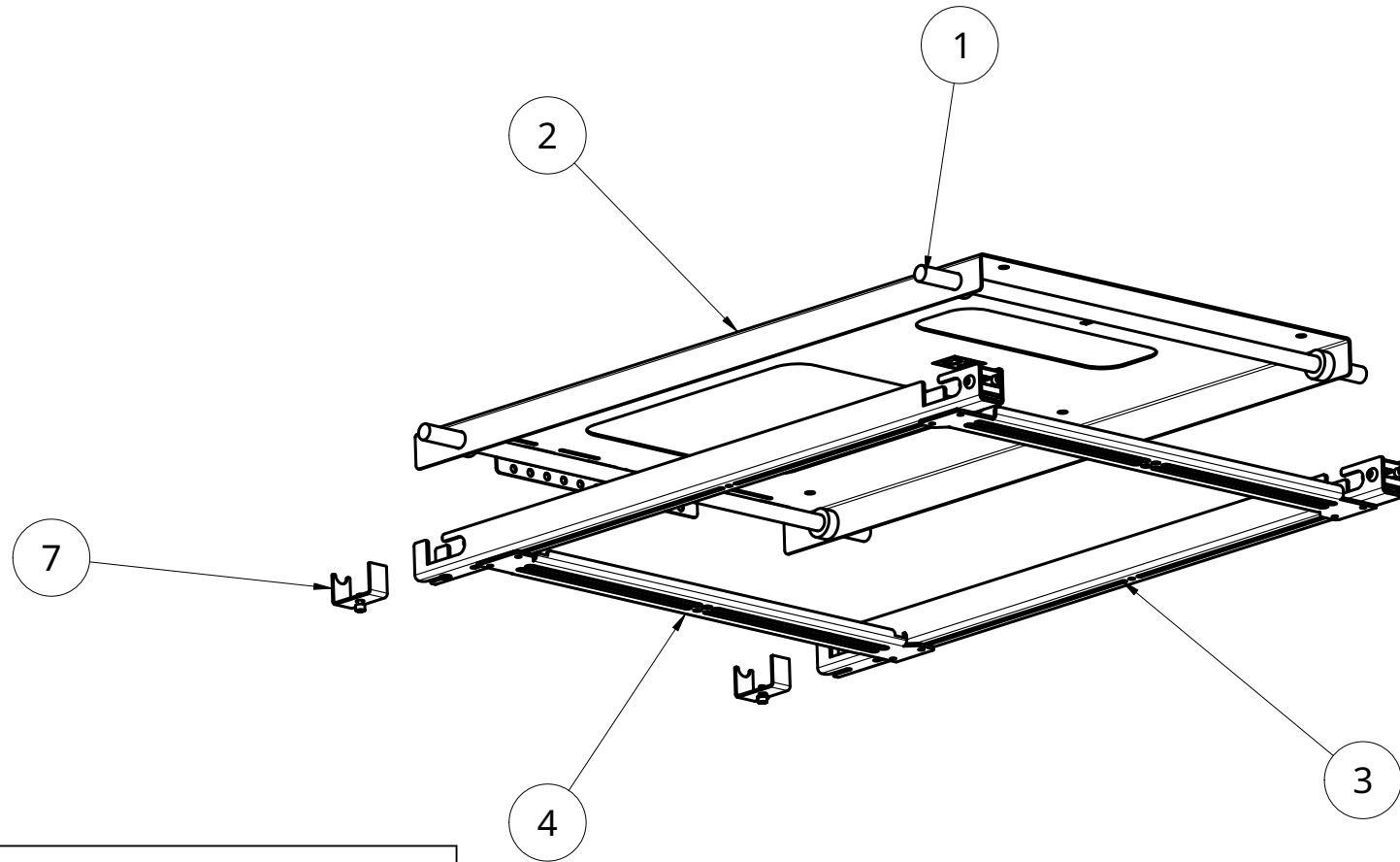

Item	Description
1	Hanging Shaft
2	Back Fixing Plate
3	Hanger
4	Projector Mount
5	Hanger
6	30x30 - 30mm
7	Lock Plate

Notes	
Max Projector Weight	75kg [165lbs]
Max Projector Fixing Dimensions	529mm x 700mm [20.83" x 27.56"] M12 (Max)
Rotation Ajustment	+/- 5 degrees
DWG NO.	DT-CM/3
SIZE	A4
SCALE	1:8
SHEET	3 of 4
REV.	C1

## Packaging

Type	Plywood Box
Recyclable	Yes
Gross Weight	22kg [48.5LBS]
Product Net Weight	15kg [33.07lbs]



## Dimensions

