

# JUST CALLING INTERACTIVE DIAL INSTRUCTIONS

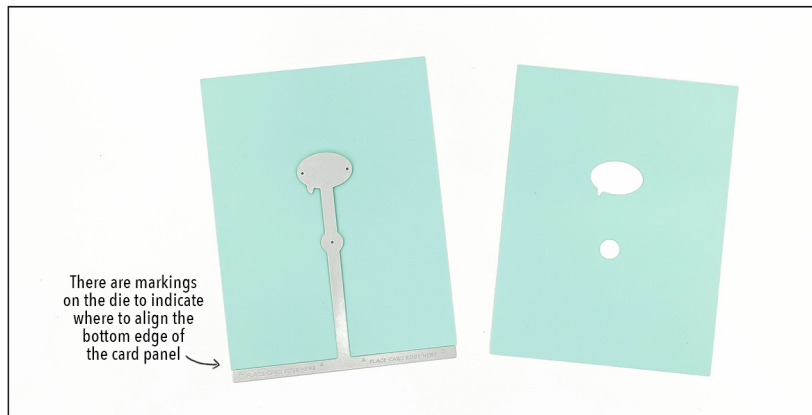

1. Cut a 5 1/2" x 4 1/4" panel and line it up with the talk bubble die and run through your die cutting machine. Set aside.



2. Die cut the spinner piece. You will see a score line outlining each bubble on the spinner piece. Stamp within each bubble. Use as many of the greetings and images as you would like.

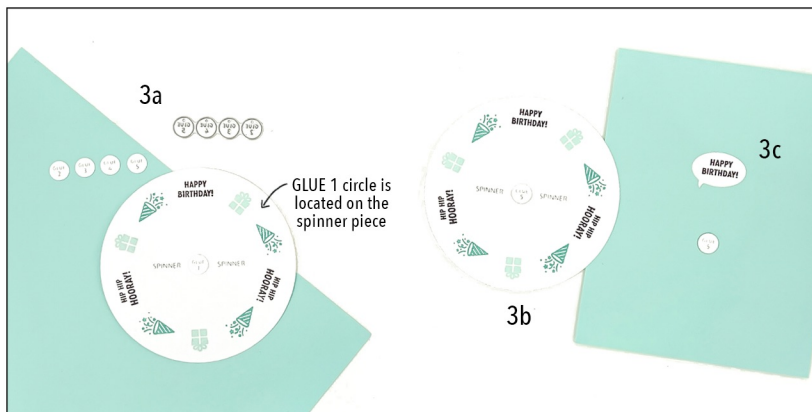

3a. Die cut the 4 circles die, each circle is numbered.  
 3b. Glue circles 1 - 2 - 3 - 4 - 5 on top of each other to create a spindle on the spinner piece.  
 3c. Take the card front and place it on top of the spinner piece so that the stacked spindle pokes through.

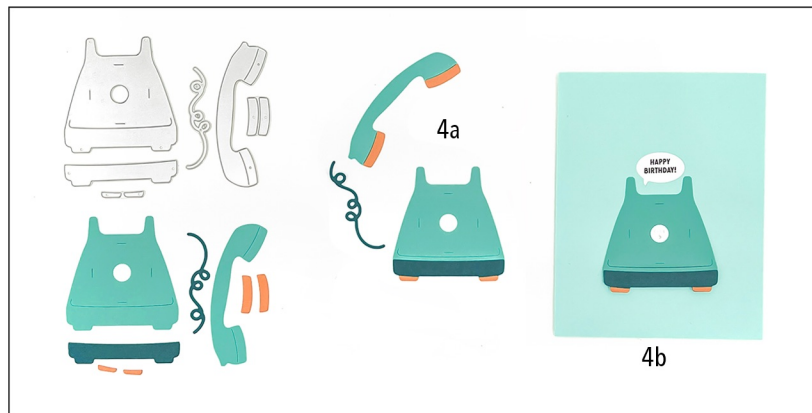

4a. Die cut the phone pieces and glue together. Set aside the handset and wire.

4b. Attach the phone base piece to your card so that the spindle is poking through the center of the phone.

NOTE: Do not use foam tape. The phone base needs to be flat so the spindle is elevated.

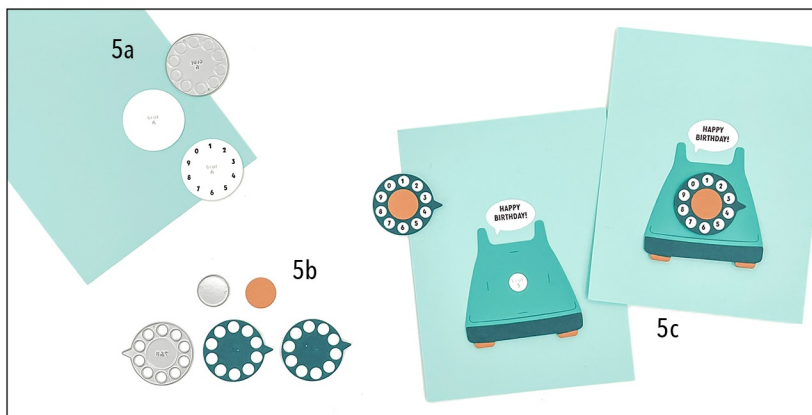

5a. Die cut the piece labeled glue 6 and stamp the numbers. Be sure to line up and stamp within the scored circles.

5b. Die cut the piece labeled 7 & 8 twice and the small circle. Glue dial pieces together for dimension and adhere over the numbered piece. Adhere small circle to center of the dial.

5c. Glue assembled dial to the top of the spindle, using the little markings on the base as a guide to make sure it's centered.



6. Adhere the handset and wire to card front. The interactive feature is now complete. Use the lever to spin the greetings through the talk bubble.

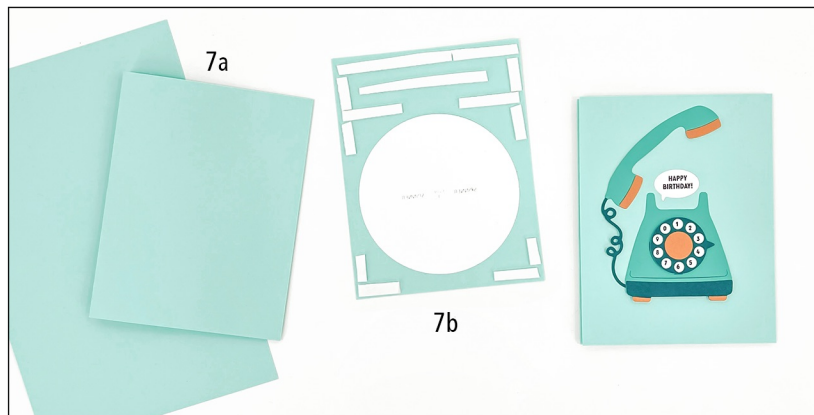

7a. Cut a card base. Score at 4 ¼" and fold in half.

7b. Apply foam tape to the back of the card front panel leaving room around the spinner piece, so it can spin freely. Attach to card and start spinning the dial!

TIP: If your dial isn't spinning easily, die cut and add more circles to the spindle in step 3.