



Startbox

01. General specifications



General specifications

This rotating case has been specially designed for the storage and winding of all self-winding watches. The Startbox rotating case is a perfect cube measuring 11 centimeters (4.3 inches) on each side.

Swiss-made, your Startbox rotating case has been crafted using top-quality materials. Both the direct mechanical drive and the electronic board, which counts a specific number of rotations per day, have been developed and tested using modern, innovative technologies, ensuring high operating reliability and long service life.

Your Startbox rotating case is programmed for a cycle of 1'200 rotations per day. i.e. 600 clockwise and 600 counter-clockwise rotations, which corresponds to the requirements of almost all mechanical self-winding watches currently available on the market.

02. User manual



User manual

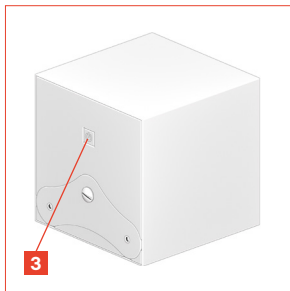
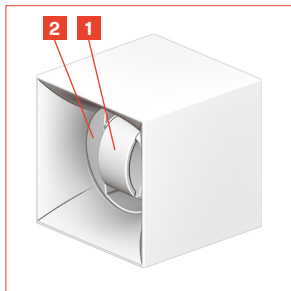

- 1** Watch holder
- 2** Rotating cylinder
- 3** Switch (on / off)

Mounting and removing the watch from the holder

To place the watch on the rotating box holder (3):

1. Set switch **(3)** to off (Fig. A)
2. Remove the watch holder **(3)** from the rotating box and place the watch on the holder with the strap closed (Fig. B).
3. Reposition the holder with the watch in the vertical position (Fig. C) in the rotating cylinder **(4)** pressing it to the stop.

To take the watch off of the rotating box holder (3):

1. Set switch **(3)** to off (Fig. A)
2. Remove the watch holder **(3)** with the watch from the rotating box and take the watch off the stand **(3)** by compressing it or opening the strap.
3. Reposition the stand **(3)** (Fig. C) in the rotating cylinder **(4)** pressing it to the stop.

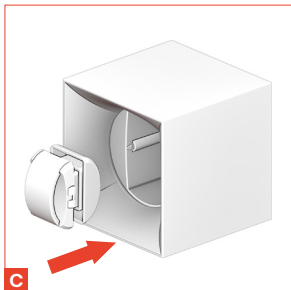
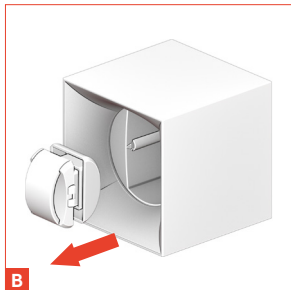

Positioning the rotating box

IMPORTANT: During use, the rotating box must imperatively be in the correct position (vertical watch), as shown in the images below.

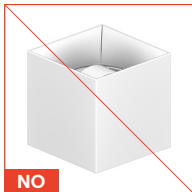
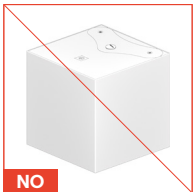

Starting and stopping the rotating box

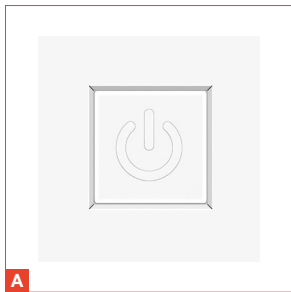

ON/OFF switch for the Startbox case

After briefly pressing the ON switch, a colored LED in the switch lights up once in red, then in green.

To switch off your Startbox, press the switch again. A colored LED in the switch lights up once in green, then in red.

The watch then performs 60 cycles of 20 rotations (10 clockwise and 10 anti-clockwise), for a total of 1'200 rounds every 24 hours. Between each rotation cycle, the watch stand automatically stops in its initial vertical position.

Indications given by the indicator light

Operating mode	Battery status: OK	Battery status: Low charge	Comment:
STANDARD	1 flash GREEN / 5 to 10 sec.	1 flash RED / 5 to 10 sec.	Operation: OK
ABNORMAL	3 flashes RED / 5 to 10 sec.		Abnormal operation of the revolution counting

Correct operation:

Correct operation of your rotating case is indicated by a green LED flashing at regular intervals every 5 to 10 seconds.

If the batteries are running low, the LED will flash red at regular intervals every 5 to 10 seconds. The batteries should be replaced within 3 months.

If you don't want to be disturbed by the indicator light flashing at night, you can switch it off. To do this, press the switch for 5 seconds when you switch the case ON.

Malfunction:

A malfunction of the lap counting system will be indicated by a red warning light flashing at a regular interval of three pulses approximately every 5 to 10 seconds.

Batteries

IMPORTANT:

- In order to guarantee the correct operation of the rotating box, it is recommended to always replace the 2 batteries at the same time by new batteries of the same type.
- Rechargeable batteries must not be used.

Battery type: Two 1.5-volt ALKALINE batteries

Dimensions:

- C (US)
- LR14 (IEC)
- Baby (DIN)
- AM2 (International)
- 14A (ANSI)

Recommended brands: Duracell®, Energizer®, Industrial®, Universal®, Varta®, Wonder®

To replace the batteries:

1. Unscrew the battery cover using a coin and remove it (**Fig. A**).
2. Remove the old batteries and put the two new batteries in the slots provided for this purpose (**Fig. B**). **IMPORTANT:** Make sure to respect the +/- polarities when positioning the new batteries so as not to damage the rotating box.
3. Reposition the battery cover and screw it back in with a coin (**Fig. C**).

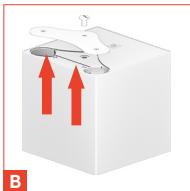
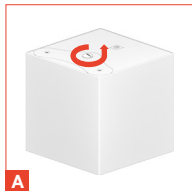

03. Precautions of use



Precautions of use

- It is recommended that you regularly clean/dust the rotating box with a soft, slightly damp cloth and then wipe it with a dry cloth.
- In order to avoid irreversible damage to the rotating box, it is important not to expose it to water, moisture, fire or other important heat sources such as radiators or in a parked vehicle in broad daylight. Direct sunlight and major sources of UV rays can fade the colours of lacquers and polymers. Areas subject to oscillating vibrations, as well as sandy or dusty areas, can also damage the rotating box's operation.
- The rotating box is designed for normal use within a temperature range of 10°C to 40°C (50°F and 104°F). Use of the box in low temperatures can significantly reduce battery life.
- The rotating box is not a toy. We therefore recommend storing it out of the reach of children.

- The rotating box, as well as new or used batteries, should not be disposed of with household waste. These items must be returned to an appropriate collection point for electrical, electronic and battery equipment recycling. By ensuring that these products are disposed of properly, potentially negative consequences for the environment and human health are prevented. Recycling materials will help conserve natural resources. For any additional information about recycling this product, we advise contacting your municipality of residence, garbage collection or the store where the product was purchased.



04.

Troubleshooting guide



Troubleshooting guide

In the event the rotating box stops or malfunctions, it is recommended that the following points be checked in this order:

1. Verify that the switch **(2)** is correctly positioned to ON.
2. Verify that the batteries are correctly positioned (+/- battery polarity respected). Also verify that the battery cover is in contact with the batteries, the contacts are clean and that the holding screw is correctly screwed down.
3. If the malfunction persists, replace the batteries with new batteries.
4. If the malfunction persists, or if the red indicator light flashes at a steady interval of three close pulses every 5 to 10 seconds, indicating a malfunction of the revolution counting system, please contact us at **contact@swisskubik.com** or return the rotary case to an official store or retailer, along with the purchase invoice.

05. Warranty conditions



Warranty conditions

The rotating box is guaranteed for a period of 3 years from the date of purchase mentioned on the invoice against any manufacturing defect.

Not covered by the warranty are:

- Damages due to normal wear and tear of the product, such as cracks, scratches, marks, cuts, colour changes, etc.
- Damages caused by misuse or improper use of the product such as incorrect battery polarity, non-compliant batteries, mishandling of the case, shocks, breakage, etc.

Damages caused by the use of the box in a harmful environment such as wet places, exposure to water, vibrations or significant heat sources, etc. If the defects are due to causes that are not covered by the warranty, an estimate of repair costs will be communicated to you as soon as possible. SwissKubik cannot be held responsible for damages caused by improper use of the rotating box, damages to watches or to any other property or person.

