



Owner's Manual
Product: Filter Gascolator
P/N: RR002

Rev: 05
Date: Mar. 2018

Fuel Filter Unit

P/n. RR002

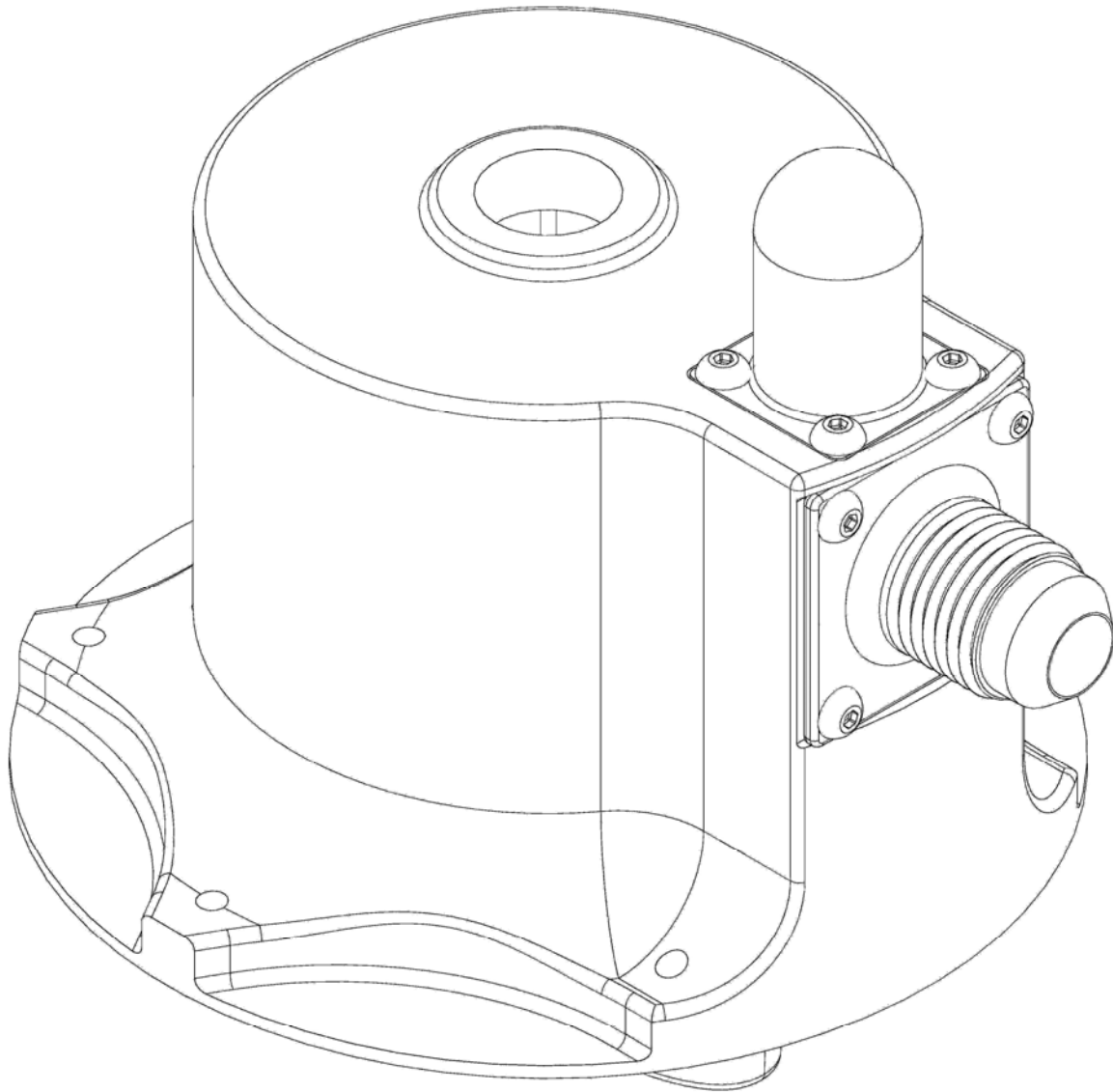

Owner's Manual



General Info:

- Total Weight (filter incl.): 310 g / 0.683 Lbs
- Max Operating Pressure: 0.7 MPa / 101 PSI
- Stainless Steel Filter Mesh: 50 μm
- Fuel Inlet Threading: 9/16-18" SAE
- Fuel Outlet Threading: 1/4-18" NPT

Special Devices:

- Fuel Automatic Shut-Off Valve that automatically shut-off the fuel coming from the tank when removing the bottom cap;
- Drain Valve, to drain water trapped by the unit or show the presence of contaminants inside the fuel;
- Safety notches on the bottom cap, to prevent the inadvertent opening of the cap in flight and allow the cap to be positioned parallel to the airstream;

Pressure Drop

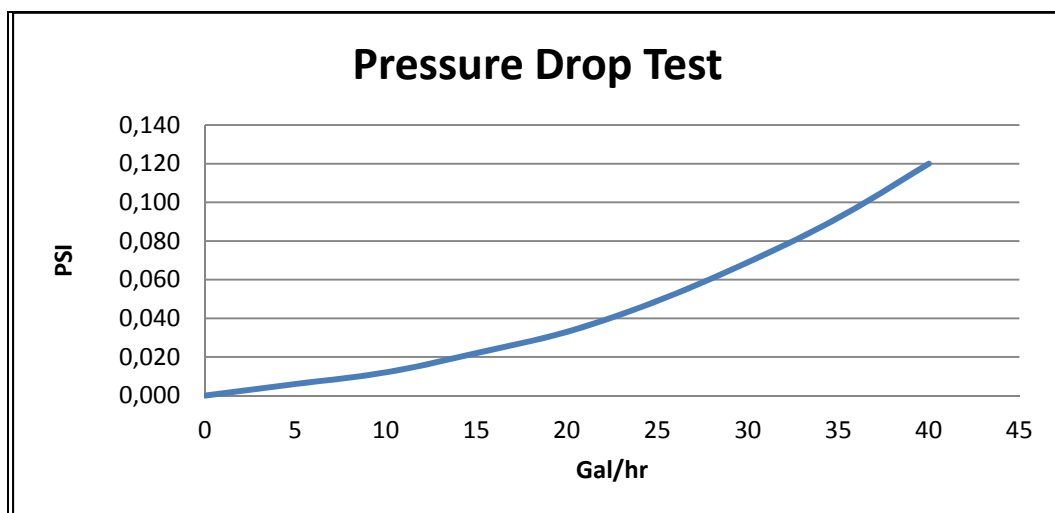



Normal Operations:

To open the unit:

1. Push the Safety Release Button (Red) firmly and turn counter-clockwise until the bottom cap has unscrewed;
2. Align the exit slot on the bottom cap with the Safety Release Button (Red);
3. Drain the internal residual fuel through the drain valve;
4. Slide the bottom cap down;

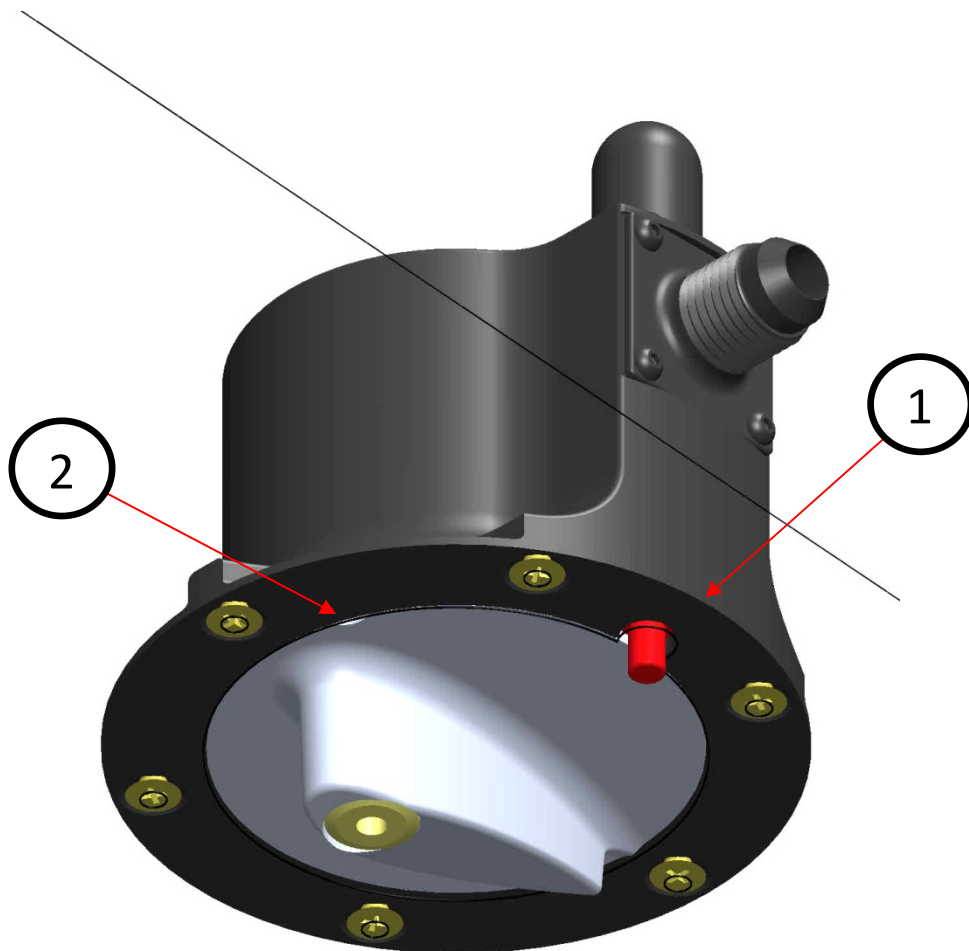



To Remove the filter from the bottom cap:

Hold the bottom cap with your hand and just pull the filtering element upward.





To drain the gascolator:

1. With a fuel tester gently push the drain valve on the bottom cap (according your tester you may insert the needle into the drain shaft hole, the result will be the same);
2. Collect some fuel according your tester's capacity;
3. Carefully check the drained fuel and positively check for:
 - Absence of impurities;
 - Absence of water;
 - Color of the fuel according to fuel spec/grade;(consider the possibility you drained 100% of water in your tester)

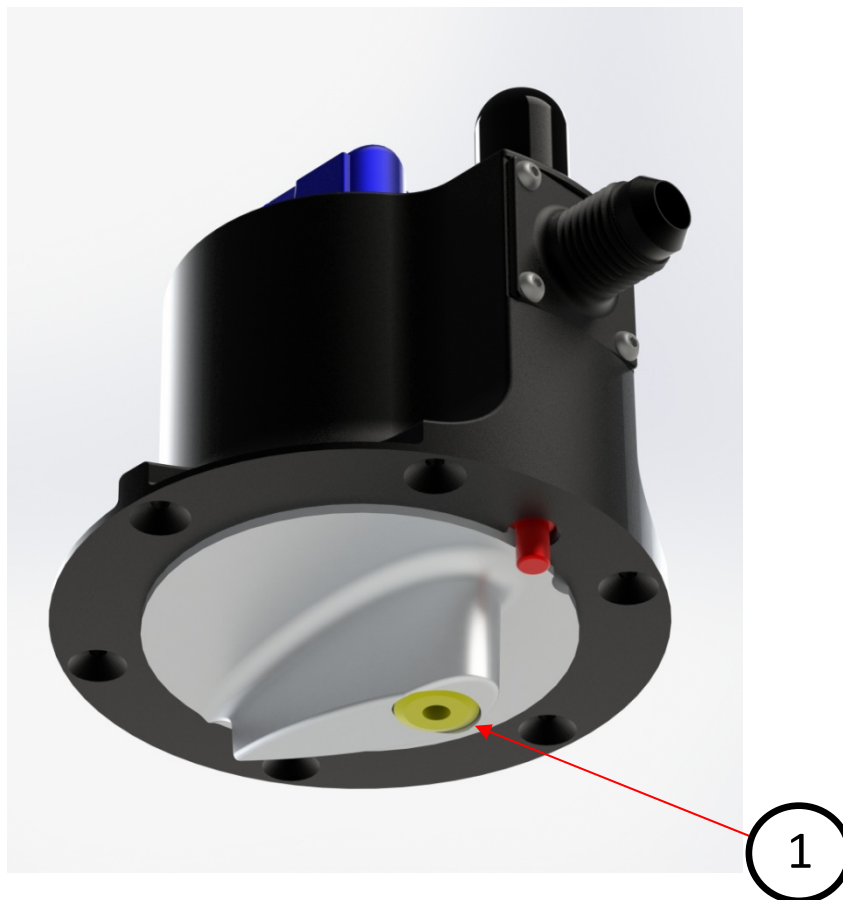



To insert the bottom cap:

1. Align the release slot with the Safety Release Button (Red);
2. Push the bottom cap upward toward the body of the filter unit;
3. Once the threads of the bottom cap touches the threads of the body of the filter unit, push firmly the Safety Release Button (Red) and turn the handle on the bottom cap clockwise until the end.
4. Once the maximum threading is achieved, release the Safety Release Button (Red) and step back to the next available stop notch, until the handle is aligned with the direction of the flight.

NOTE: The Safety Release Button (RED), when extended, automatically shut-off the fuel system, for maintenance purposes. During the aircraft pre-flight walk around check the button is in its recessed position. (Pic.3)



Pic. 1



Pic. 2



Pic. 3



Unit Details:

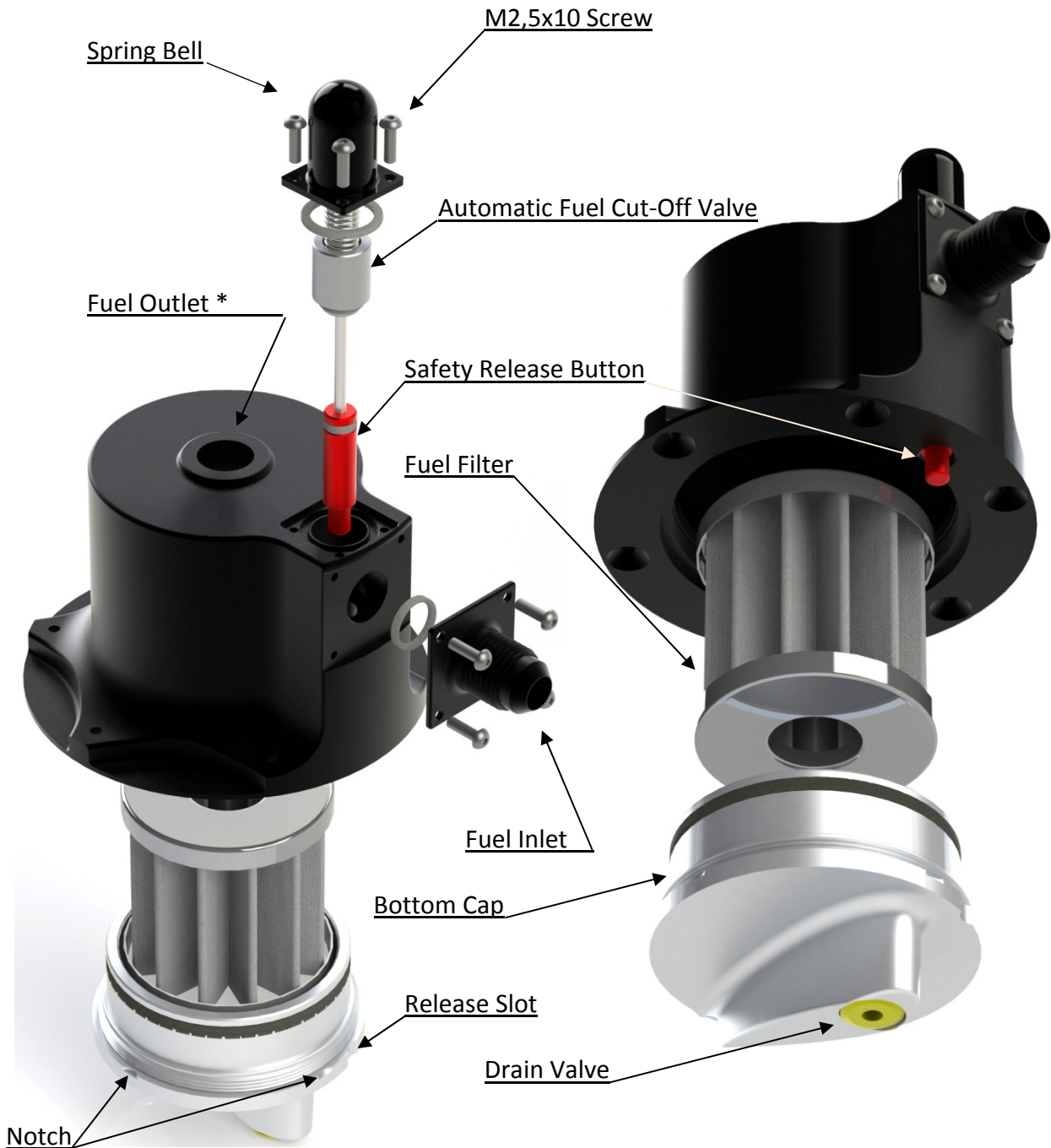

***NOTE**

In case of AN822-6D Elbow Fitting installation (or other aluminum fittings) please remember to use some anti-seizing compound, like Loctite Silver Grade, EZ Turn or similar.

In case of Spring Bell or Fuel Inlet removal, corresponding O Rings (AS568-014 and ORM090-15) shall always be replaced.



General Dimensions:

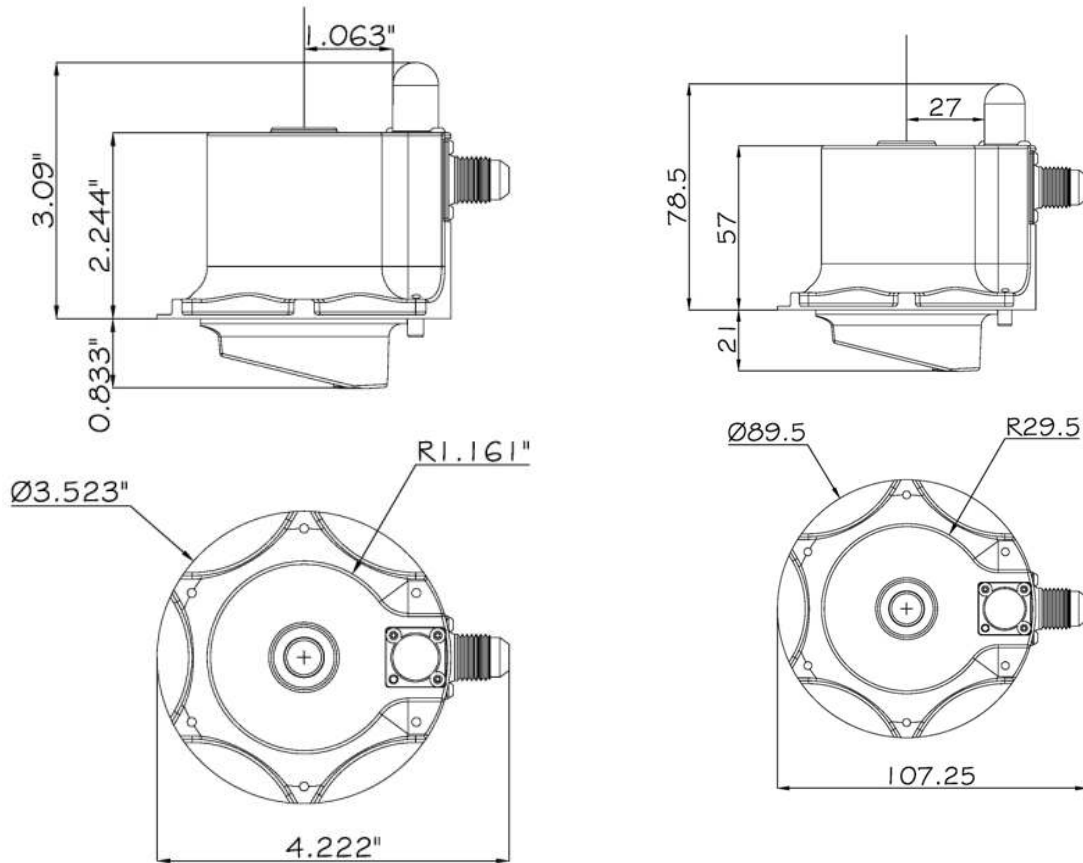

Inches

Millimeters



O Ring Identification Guide:

(Note: replace the O Ring set every 5 calendar years)

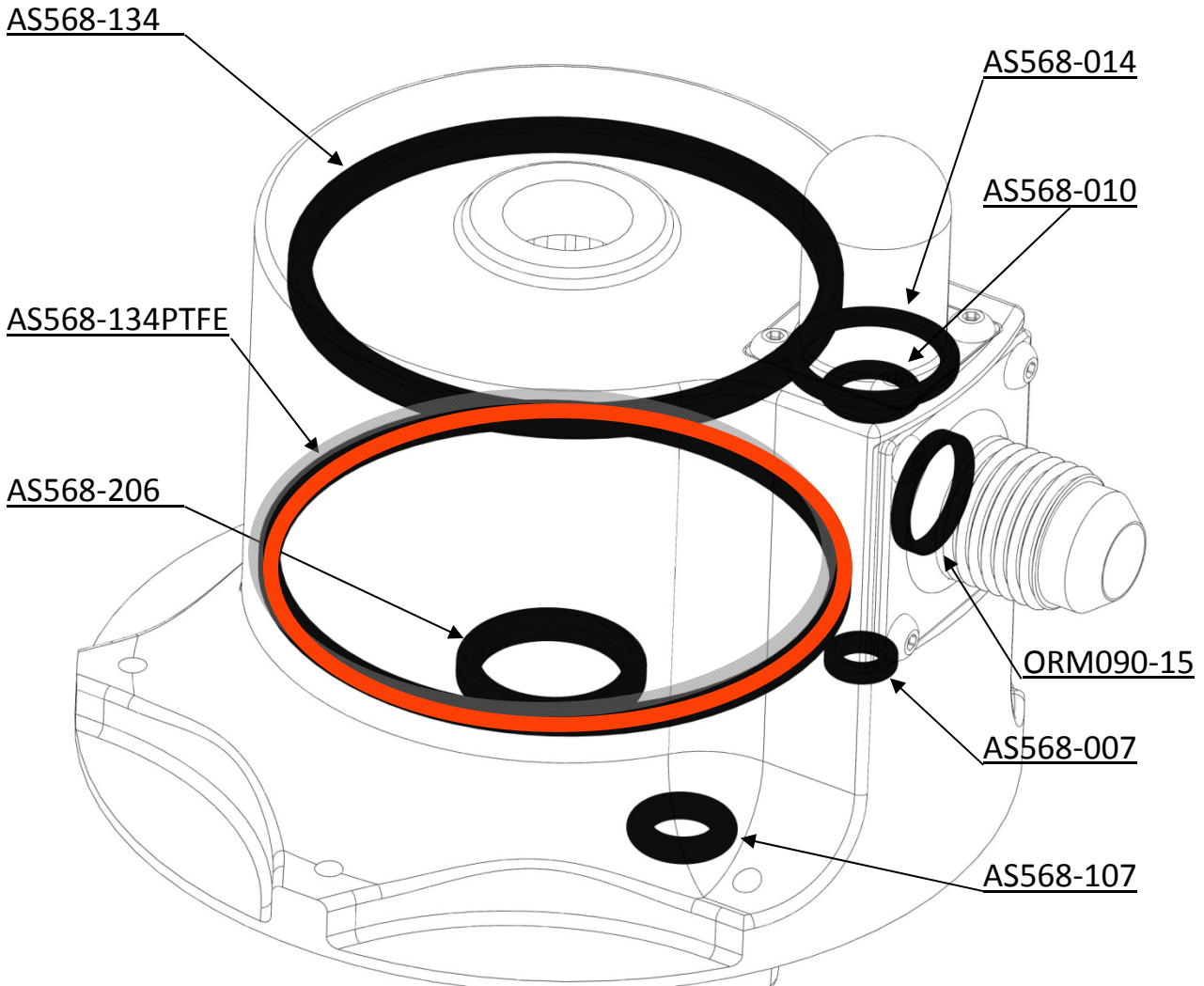

O rings are fuel resistant (Viton, FPM or similar) type (or PTFE when noted);

Part Number	Inside Ø (mm)	Cross Section Ø (mm)	Inside Ø (In)	Cross Section Ø (In)
AS568-007	3.68	1.78	0.145	0.070
AS568-010	6.07	1.78	0.239	0.070
AS568-014	12.42	1.78	0.489	0.070
AS568-107	5.23	2.62	0.206	0.103
AS568-134	47.29	2.62	1.862	0.103
AS568-206	12.29	3.53	0.484	0.139
ORM090-15	9.0	1.5	- -	- -
AS568-134PTFE	47.29	2.62	1.862	0.103