



DEEP SILENCE 3



Introduction

Congratulations on the purchase of your new Nanoxia Deep Silence 3 midi tower. We are confident that you will be delighted by your new PC case for many years to come.

Nanoxia's Deep Silence series have been designed and developed by an experienced team of developers in Germany. The silent optimized PC cases are of the highest quality and combine the best possible functionality with the highest level of flexibility.

The Deep Silence 3 Tower offers lots of space for long graphics cards and up to eight hard drives. The middle HDD cage of Deep Silence 3 is removable, allowing the easy installation of extra-long VGA cards.

The secondary mounting rail on the bottom makes it possible to maintain the number of mounting slots for hard drives. In addition the hard drive capacity can be expanded by purchasing optional HDD cages, optional available in stores.

Specifications

Dimensions:	456 x 207 x 520 mm (Height x Width x Depth)
Material:	0.6 mm steel
External drive bays:	2 x 5.25 inch (tool-free) 1 x 5.25 inch /w 3.5 inch adapter (tool-free)
Internal drive bay:	5 x 2.5/3.5 inch bays (decoupled) 3 x 2.5 inch bays

Accessories

Fan screws



Stand-offs for mainboard



Screws for mainboard mounting

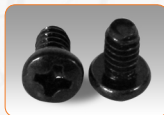

Mounting screws for 3.5 inch HDD/SSD



Mounting screws for 2.5 inch HDD/SSD



Screws for 3.5 inch mounting frame



Mounting screws for PSU



Thumbscrews



EPS-Extension



Features:

- **Complete soundproofing with high quality materials meeting industrial standards**
- **Tool-free mounting of optical drives**
- **Max. VGA length: 345 mm (up to 430 mm with the HDD cage removed)**
- **Room for CPU coolers with a maximum height of up to 162 mm**
- **Mounting hole for CPU cooler in the motherboard tray**
- **Cable management** with 6 rubberised holes in the motherboard tray
- **Nanoxia VentCover** (noise insulated): 2 x top cover
- **2 x USB 3.0, 1 x USB 2.0**
- **Freely-adjustable 2-channel fan control** for up to 6 fans

Noise Insulation:

The Nanoxia Deep Silence 3 has been developed with the aim to offer the buyer a low-noise case, while at the same time allowing for extremely low system temperatures. The sound insulation design of the Deep Silence 3 is based on multiple interacting design elements:

The most important part is the large scale lining of the case with sound-absorbing insulation materials. These materials are manufactured specifically to meet the requirements of the developers of the Nanoxia Deep Silence case series and act equally against airborne sound and structure-borne noise.

The removable Nanoxia VentCovers mask the 120/140 mm fan holes in the case top. They allow the user to choose between the least possible noise and improved case ventilation.

Another design element for optimum sound insulation is the use of two sound-insulated front doors. The doors are equipped with sound-absorbing foam. Hard drives and power supply are also decoupled mounted. The whole concept of sound proofing of the Deep Silence 3 meets the highest expectations.

Ventilation System:

The Nanoxia Deep Silence 3 has an integrated ventilation system consisting of three 120 mm Deep Silence fans and a built-in 2-channel fan controller. A total of up to six fans can be mounted.

The Deep Silence axial flow fans have been specifically optimised for very quiet operation. The range of fan speeds and controls was designed to enable each user to adjust the case ventilation to their own needs.

In the front and under the floor, there are removable, easy to clean dust filter.

Fans:

Front: 2 x 120 mm Nanoxia Deep Silence fans (max. 1,300 rpm)

Rear: 1 x 120 mm Nanoxia Deep Silence fan (max. 1,300 rpm)

Optional Equipment:

Top cover: 2 x 120/140 mm fans

Bottom: 1 x 120/140 mm fan (removal of the HDD-holder necessary)

On the next pages you can find some useful tips and explanations for the optimal use of your new case and for the installation of your hardware.

Please visit our website at www.nanoxia-world.com

1. Installation of the motherboard

You can mount ATX, M-ATX and Mini-ITX motherboards in the Deep Silence 3. In order to ensure an easy installation of your motherboard, we suggest the following procedure:

Please consult the following charts to find your motherboard form factor.

Attach the included EPS extension to your motherboard - do not connect it from to the power supply yet.

Mini-ITX Mainboard



Micro-ATX Mainboard

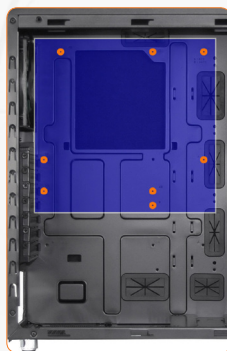

ATX Mainboard

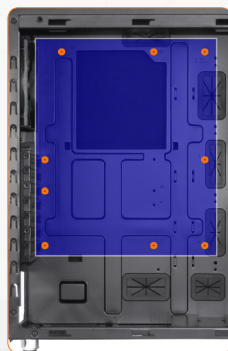

Next, mount the CPU cooler - for bulky coolers, the attachment of the EPS extension after installation can be difficult. Place the motherboard carefully into the case and thread while the EPS extension through the opening provided at the top of motherboard tray.

Then screw the motherboard to the motherboard standoffs. After installing the power supply, you can connect the EPS extension at the back of the motherboard tray with the EPS connector of the power supply.

2. Installation of external drives

You can install up to three external drives in the Deep Silence 3. An adapter frame for mounting a 3.5 inch drive is included.

2.1 Optical drives

To install the optical drives, please remove both side panels. The installation of optical drives is tool-free.

Remove the 5.25 inch cover by pulling the lateral tilting lever cautiously towards you and take out the cover.

Then loosen the lock on both sides by dragging the black slider backwards (1).

Next slide the drive into the desired position. Lock the holder by pushing the slider back to its original position (2).

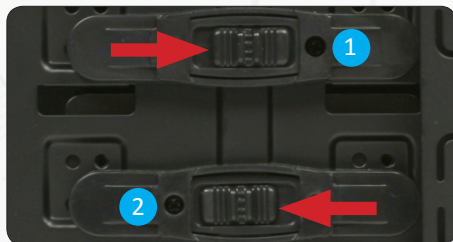

Please note that the two lower shafts are equipped with steel panels, which you have to remove when you want to use the lower drive bays. To do this, move the steel panels gently back and forth until you can remove them.

2.2 Utilizing the external 3.5 inch bay

If you for example desire to place a 3.5 inch card reader, you can use the internal adapter for this purpose.

Before you take out the internal adapter, please remove the 3.5 inch steel cover as shown on the picture.

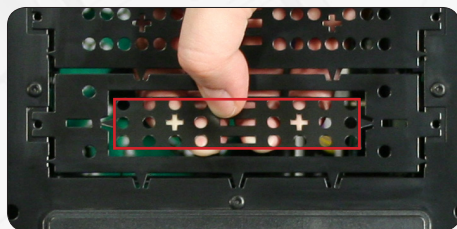

Open the two quick release locks of the 5.25 inch bay and remove the mounting frame. Then attach the card reader in the frame, as shown below. Then place the frame with the card reader back into the slot and lock the quick release. Finally, attach the included 3.5 inch adapter to the front cover over the card reader.

3. Installation options of HDD's

In the Deep Silence 3 you can mount up to five 3.5 inch hard drives (decoupled), as well as three 2.5 inch HDD / SSD in three HDD cages. The middle HDD cage is modular and can be removed or transferred to the secondary holder

3.1 Mounting of hard disk drives

Install the 2.5 or 3.5 inch hard drives in the illustrated mounting frames. In order to extract the frame, squeeze the protruding brackets and pull the slide out gently. This applies both to the 2.5 inch and the 3.5 inch drive sleds.

Mounting of 3.5 inch drives
(3.5 inch sled)



Mounting of 2.5 inch drives
(3.5 inch sled)



Mounting of 2.5 inch drives
(2.5 inch sled)



To lock the drive, push the bracket with the drive back into the slot until the bracket is re-engaged.



3.2 Conversion and removal of the HDD-cage

In order to enable the installation of extra-long VGA cards, the middle HDD cage of the Deep Silence 3 is modular. If you want to remove the hard drive cage to install a very long graphics card, please remove both side panels first.

In order to remove the cage, you have to simultaneously pull the lever at the back facing up and press the tab on the front down.; pull the cage gently outwards.



If necessary, you can attach the modular cage on the holder provided on the case bottom. Please slide the hard drive cage into it until it is secured by the lever.

4. Fan assembly

Three 120 mm fans are pre-installed in your Deep Silence 3. You can mount up to six fans in total.

We recommend the use of the 120 or 140 mm Nanoxia Deep Silence fans, available separately. These are technically and visually equivalent to the factory-installed case fans and will work in perfect harmony with the built-in fan control of your case.

You can, of course, connect the additional fans to the fan controller.

Front and bottom of the Deep Silence 3 are equipped with easy to clean dust filters.

We recommend that you clean them on a regular basis.

4.1 Fans in the case front

To switch the fans in the front or to clean the dust filters, please remove the front panel by holding the cutout at the bottom and pull it towards you with a firm tug.

Next, remove the four screws with which the dust filter is connected to the front and take it out.

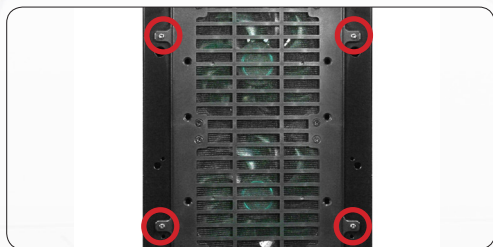

Please be advised that the fans are screwed to the dust filter.

The front dust filter allows the installation of either 2 x 120 mm or 1 x 140 mm fans.

Two 120 mm Deep Silence fans (1.300 rpm) are preinstalled.

4.2 Fans under the top cover

If you want to install additional fans at the top of the case, please remove the Nanoxia VentCovers first by removing the screws on the outside of the case. Next, hold the fans from the inside and secure them to the top by fastening the screws from the outside.

Case fans installed at the top of the case should exhaust air out of the case (fan rear side facing outwards).

4.3 Fans at the bottom of the case

If you want to mount a 120 or 140 mm fan on the case bottom, you must remove the hard drive cage mounting located at the bottom.

The rail is attached with four screws to the bottom.

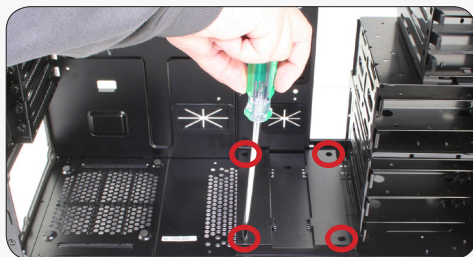

Additional case fans in the side panel and on the bottom of the Deep Silence 3 should be mounted so that cooler air is introduced into the case (fan rear side facing inwards).

5. The 2-channel fan controller

The Deep Silence 3 is equipped with a 2-channel fan control for up to six case fans. You can operate up to three fans per channel.

5.1 Connecting the fans to the fan control

The fan controller is powered by a 4-pin Molex connector that is connected directly to the power supply.

The controller has two channels (A and B), with each channel able to control up to three 3-pin fans, therefore a total of six fans can be controlled.

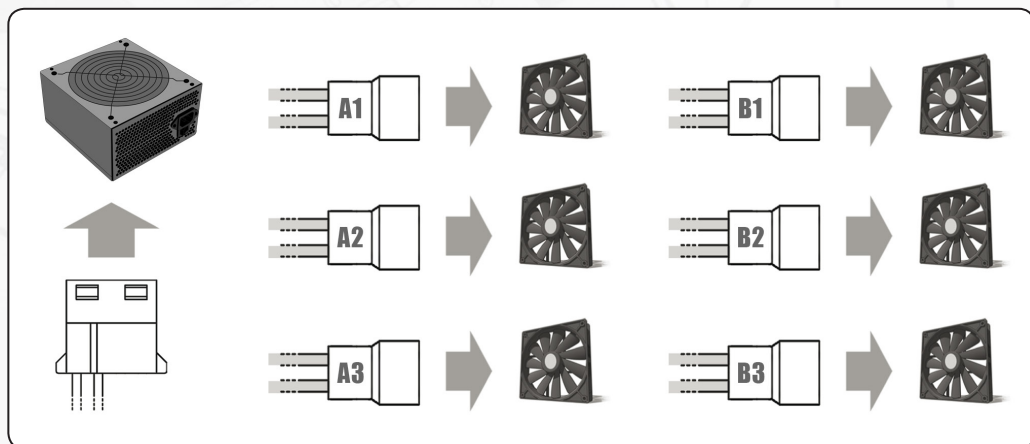

The fan controller is not designed for the operation of powerful fans. Please take this into account in particular when using fans from other manufacturers. The maximum power per channel must not exceed 18 watts.

5.2 Operation of the fan control

The sliders for controlling the fans controller can be found behind the upper front door. The upper slider controls channel A and the lower slider controls channel B.

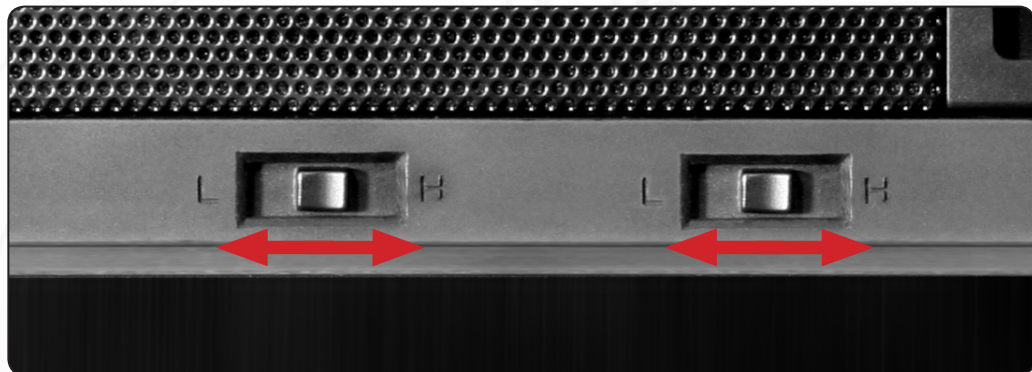

6. The I/O-Panel

The I/O panel includes connectors for external USB devices (1 x USB 2.0, 2 x USB 3.0), and the microphone and headphone ports.

The blue USB connectors are super-Speed USB 3.0, the USB 2.0 port is black. The left audio connector (when viewed from the front) is for headphones, the right is intended for a microphone.

The hard drive activity is indicated by flickering of the green illuminated power button.



7. Support

Dear customer,

The PC case you purchased has undergone a very thorough quality control.

Nevertheless, should there be any unexpected problems with your case we ask that you first approach the dealer where you purchased the product. They are prepared to assist you with competent and uncomplicated advice and practical support.

If perhaps a few screws were missing or you might have a question that can't be answered by this manual, please do not hesitate to contact us directly by e-mail.

Likewise, we would appreciate your suggestions and comments about our case very much. Our staff will respond to all inquiries quickly and professionally.

Customers from Germany and other European countries can use the following e-mail address for support questions, spare parts or warranty issues:

support@nanoxia-world.com

Customers from Africa, Asia, Australia as well as North and South America can use the following e-mail address for support questions, spare parts or warranty issues:

support.overseas@nanoxia-world.com

For general inquiries, comments, suggestions and the like please refer to:

info@nanoxia-world.com

We are sure that you will be satisfied with Nanoxia Deep Silence 3 for many years to come, so please enjoy your new PC case.

Your Nanoxia Support-Team