

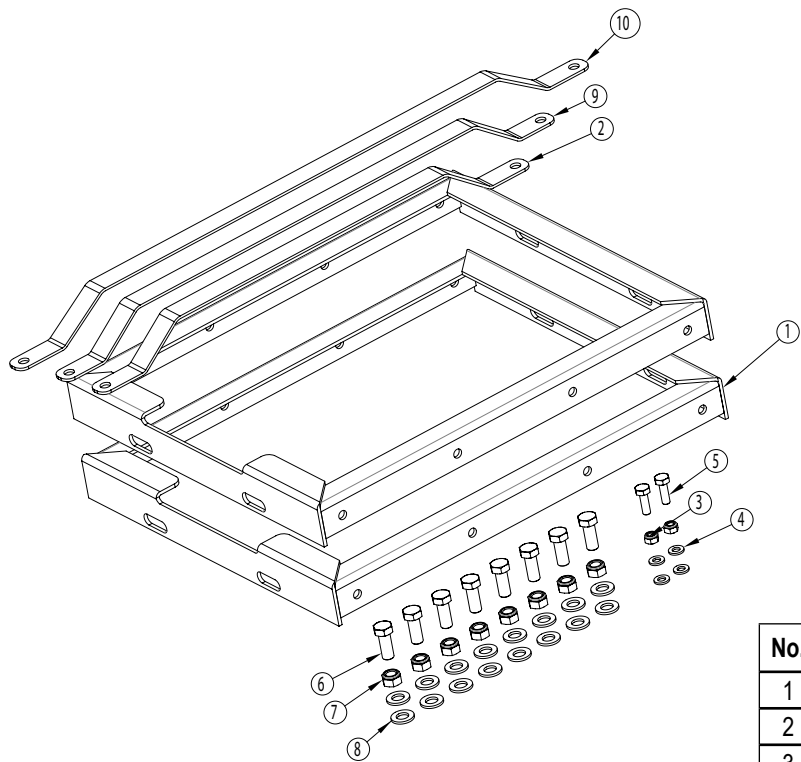

SPECIFICATIONS

- Kit fits DHRA50150, DHRA50300, and DHRA50450 (Hose Reels not included)
- Stack up to four high
- Stainless Steel hardware
- Durable powder coating
- Solid steel construction

PARTS LIST



2100437 PARTS LIST

| No. | Part No. | Description | QTY |
|-----|----------|----------------------|-----|
| 1 | 2103272 | ASSY, FRAME, KIT | 2 |
| 2 | 2540096 | BRACE, DIAGONAL, 150 | 1 |
| 3 | 2200053 | NUT, M8X1.25, SS | 2 |
| 4 | 2200013 | WASHER, M8, SS | 4 |
| 5 | 2200056 | HCS, M8X1.25X25 SST | 2 |
| 6 | 2200108 | HCS, M12 X 1.75 | 8 |
| 7 | 2203019 | NUT, M12, NYLOK, SST | 8 |
| 8 | 2203418 | WASHER, FLAT, M10 | 16 |
| 9 | 2540095 | BRACE, DIAGONAL, 300 | 1 |
| 10 | 2540105 | BRACE, DIAGONAL, 450 | 1 |

ASSEMBLY / OPERATING INSTRUCTIONS

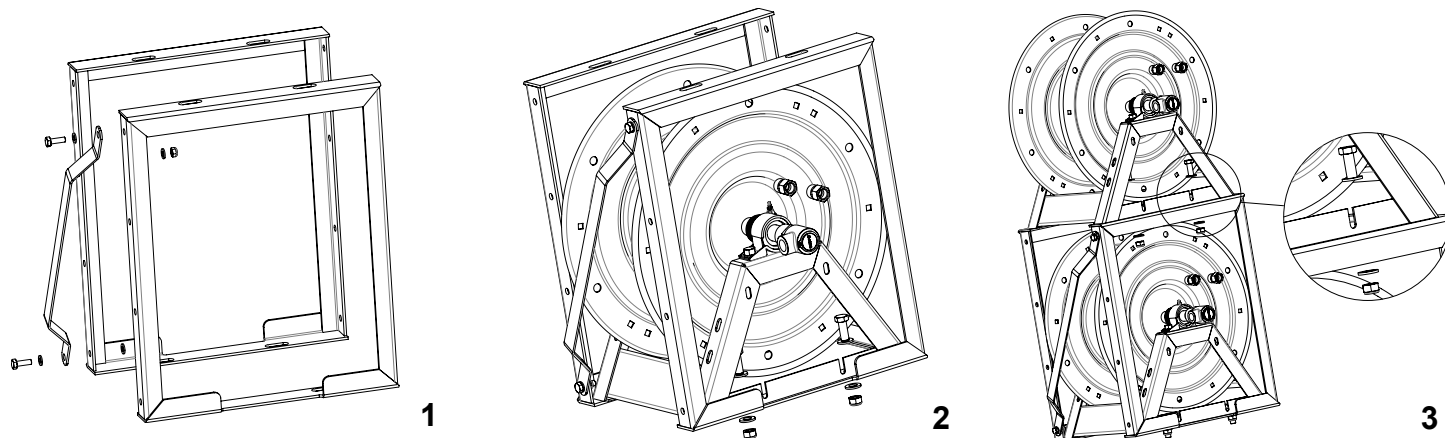

1) It's easiest if the BRACE is bolted to the ASSEMBLY FRAME first. If you have a DHRA50300 use the brace p/n 2540095; if you have a DHRA50150 use the brace p/n 2540096, if you have a DHRA50450 use the brace p/n 2540105. Do not tighten these bolts yet. Use (2) M8 nuts and bolts and (4) M8 washers. Be sure the cutout in the frame is on the bottom.

2) Bolt your hose reel to the ASSEMBLY FRAME/BRACE assembly. Use (4) M10 nuts and bolts and (8) M10 washers. Make sure the hose reel outlet (where the hose connects) faces away from the BRACE.

3) Bolt your second hose reel to the ASSEMBLY FRAME/BRACE/HOSE REEL assembly. Again, use (4) M10 nuts and bolts and (8) M10 washers.

4) Go back and tighten the BRACE bolts.

5) If you have three hose reels to stack, set the second ASSEMBLY FRAME on top of the bottom frame, then attach the hose reel to that frame.

6) Repeat step five for stacking four hose reels.

SAFETY / WARNING

SAFETY PRECAUTIONS

1. Make sure incoming pressure does not exceed the rated pressure.
2. Use proper eye protection when assembling and using hose reels.
3. Assemble the hose reel kit on a clean workbench free of debris and moisture.
4. Use soap and water when checking for air leaks.
5. Keep children away from work area.

WARNING!

Exposure of skin directly to pressurized air or fluids could result in severe bodily injury!