

**GENERAL PUMP THERMOSTAT**

For regulating the temperature on heated, high pressure washers.

**SPECIFICATIONS**

Part Number	100272
Flow Rate	1 - 35 GPM
Ports	1/2" NPT
Maximum Pressure	5000 PSI
Temperature Range	Ambient to 200°F
Electric Load	120VAC @ 10 amps
Non-inductive	240VAC @ 5 amps
Approvals	UL, CSA (Thermoswitch only)

**PARTS LIST**

No.	Part Number	Description	Qty.
1.	530012	Thermostat Block	1
2.	620017	Thermoswitch	1
3.	540012	Clip	1
4.	701009	O-ring	1
5.	202005	Screw	6
6.	540011	Cover	1
7.	660012	Knob	1
8.	400047	Label	1
9.	620012	Conduit Connector	1
10.		Wire, 14 AWG	
11.	620105	Terminal Ring	2

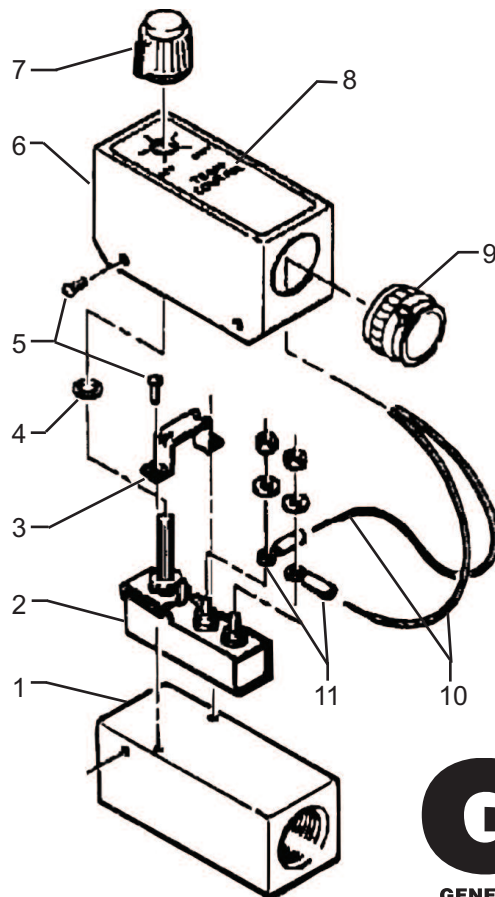

General Pump  
is a member of  
the Interpump Group



# 100272 Thermostat

## Pressure Relief Procedure

To reduce the risk of serious bodily injury, including fluid injection and splashing in the eyes or on the skin, always follow this procedure before installing or servicing the temperature control.

1. Engage the gun trigger safety latch.
2. Turn the gas engine or electric motor OFF.
3. On a gas engine, remove the ignition cable from the spark plug. On electric powered equipment, disconnect the power supply.
4. Shut off the water supply.
5. Disengage the gun trigger safety latch and trigger the gun to relieve pressure. Then engage the safety latch again.
6. Before long term (overnight) storage or transporting of unit, disconnect the water supply and turn off all fuel supply valves.

## Installation

Install the temperature control between the heater outlet and the gun inlet. Use pipe thread sealant or teflon tape on all fluid connections.

The temperature control can be electrically connected in a variety of ways. Use the wiring diagram to determine the correct wiring closest to your application. Connect the wires on the temperature control as shown, being sure to comply with all local electrical codes. Always use flexible conduit over wires. (The conduit and connector are not supplied with the temperature control.)

## Warning

To reduce risk of electric shock, the two temperature control wires must be protected from damage by placing flexible conduit over the wires.

## Replacing the Thermostat

1. Shut off the electrical power.
2. Follow the Pressure Relief Procedure
3. Remove the knob by loosening the knob's two setscrews with a 1/16" allen wrench.
4. Remove the four screws and the cover.
5. Remove the two wire connectors from the thermostat, with a 5/16" socket wrench.
6. Remove the two screws and the clip.
7. Remove the old thermostat, and install a new one.
8. Reassemble the temperature control in reverse order from disassembly.

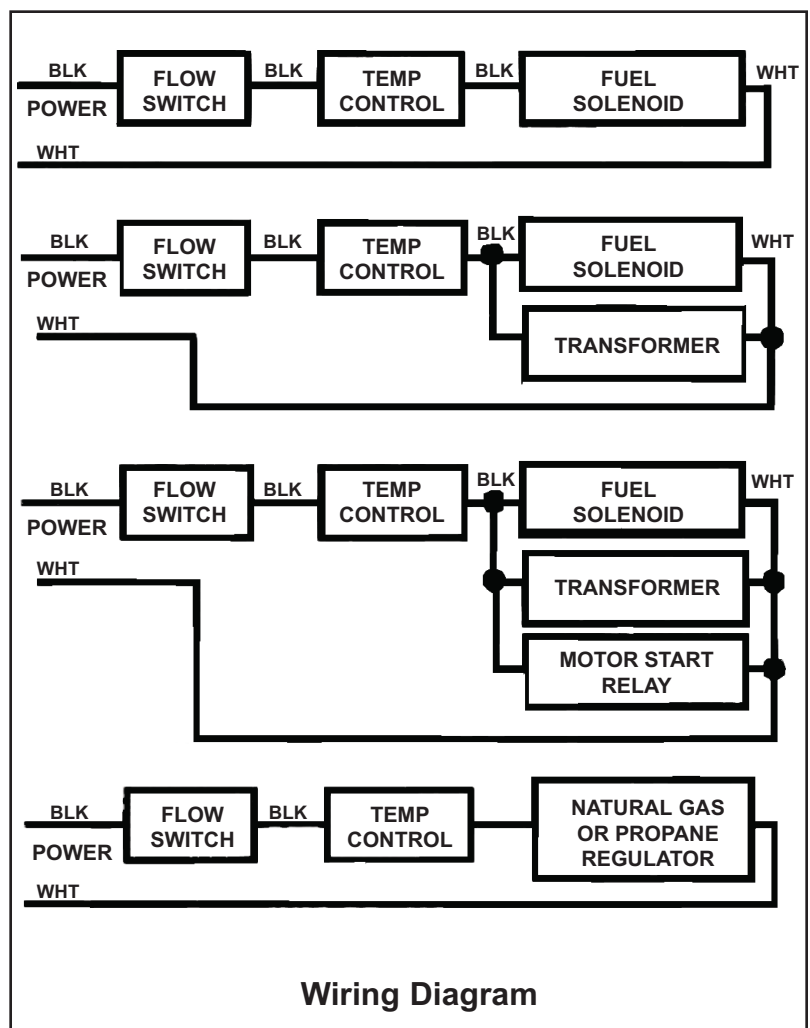
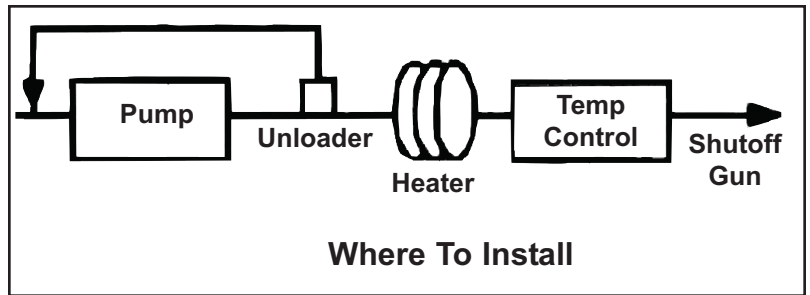

Ref 300044 Rev. C  
07-09