

PART #: 10-1002

Vehicle Application

- YEAR: 2000-2010
- MAKE: Ford
- MODEL: F-350, F-450, and F-550
Cab & Chassis
- ENGINE: 7.3, 6.0, 6.4 Diesel

Tools Required

- 15mm Socket
- 19mm Socket
- Ratchet
- 10" or 12" driver extension
- Flathead Screwdriver or 8mm Nut
Driver
- Mallet or Hammer
- Transmission or Floor Jack

Optional Tools

- Vehicle Lift
- Precision Pick
- Pry Bar

Before You Start

- Please read the entire product guide before proceeding
- Ensure all parts are present.
- If you are missing any parts, please call or text us at (909)-675-1313
- Do not work on your vehicle while the underbody components are hot.
- Make sure the vehicle is in park or the parking brake is set if you plan on working on the ground. If working on a lift, make sure the vehicle is lifted safely and securely.

Before You Start

Drain your original fuel tank before beginning the S&B Installation process. S&B Tanks recommends removing only an empty or near empty tank for your safety. We recommend using a siphon or electronic transfer pump.

Disconnect and isolate both of the negative battery cables

Before installing S&B Tank, conduct pressure test to ensure o'ring is properly seated.

In-bed Auxiliary Fuel Tanks will void the Lifetime Warranty.

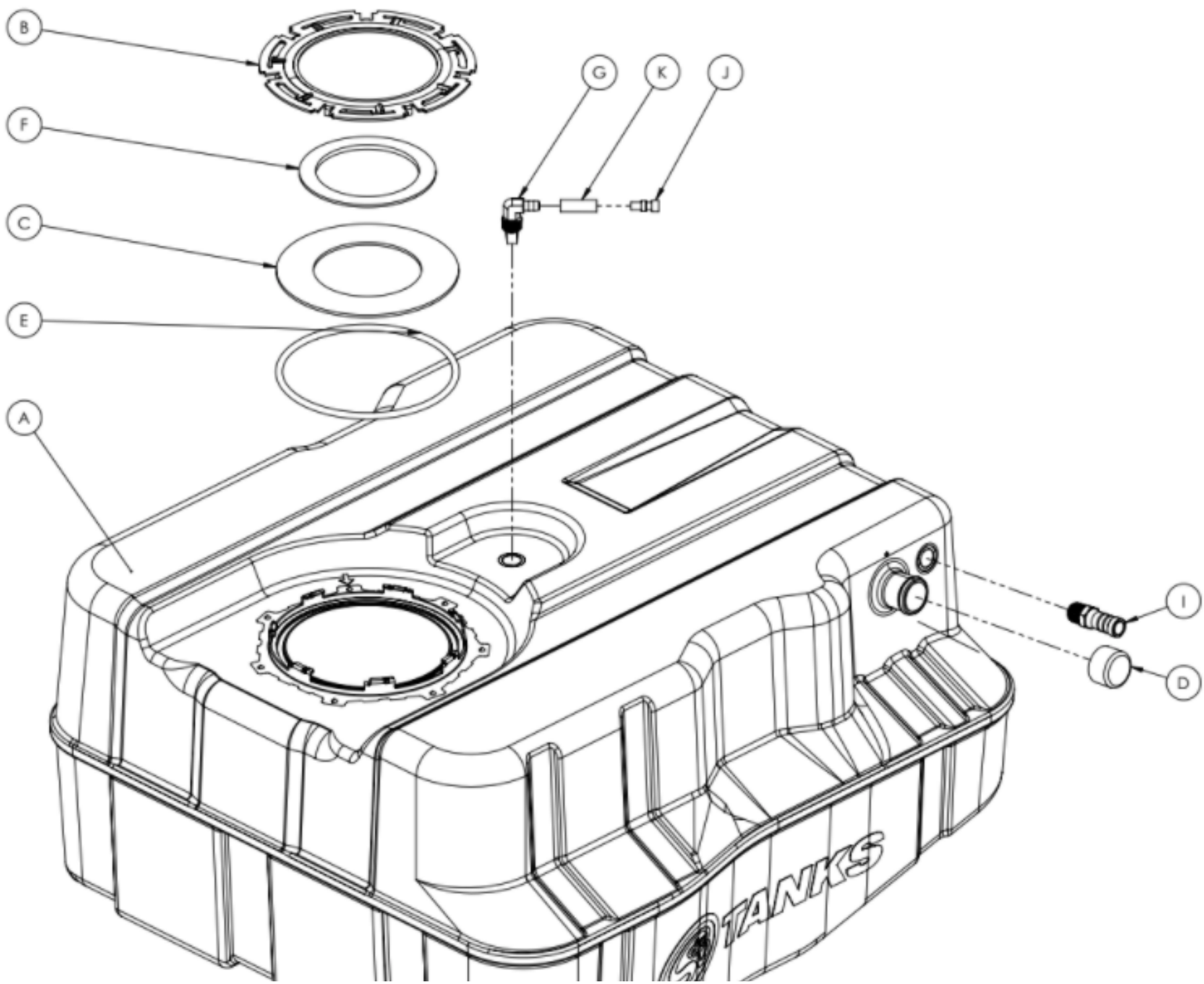

ITEM NO.	PART NUMBER	DESCRIPTION	QTY.
A	10-1002	HIGH CAPACITY REPLACEMENT TANK	1
B	TI0005-00	LOCKING RING FOR 10-1002	1
C	TI0006-00	ADAPTOR ROUND PLATE	1
D	TI1092-00	TANK FILLER COVER	1
E	TI1103-00	22.25" VOR-N50.275X6.999	1
F	TI1120-00	ADAPTOR RING GASKET	1
G	TI1122-00	ROLL OVER VENT FITTING, 1/2" NPT	1
H	TI1125-00	.5" PIPE PLUG	1
I	TI1128-00	BARBED VENT FITTING, STRAIGHT, 3/4" BARB TO 1/2" NPT	1
J	TI1141-00	ROLLOVER VENT CAP	1
K	TI1169-02	5/16" FUEL HOSE 2"	1

INSTALLATION INSTRUCTIONS

STEP 1

Raise the vehicle up on a lift to working height.

- Installation can be completed without a lift. Make sure the vehicle is safely parked with the parking brake set.



STEP 2

Disconnect the vent and fill hose from the filler/vent neck assembly.

- Flathead Screwdriver or Nut Driver



STEP 3

Center the hydraulic jack underneath the fuel tank and raise

STEP 4

Remove the 4 bolts that fasten the skid plate to the frame.

