

Assembly instructions for Small and Medium Pop-up Frames

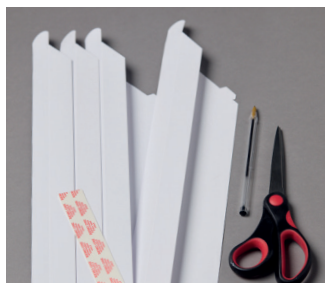

In each pack you'll find 4 side pieces and 5 sticky pads. You'll need a pen or pencil and pair of kitchen scissors as well as a flat clean surface and clean hands.

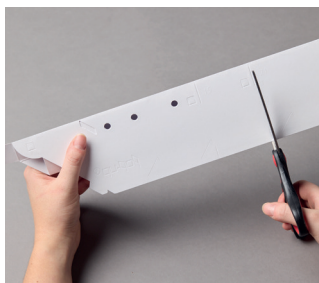

Measure whatever it is you're framing and use the table below or our online *Sizing Calculator* to decide where to cut each side. Use the numbers and cutting guides to cut to the required size.



Position the 4 cut pieces in to the shape of the final frame - just so you don't join the wrong sides together - it happens!

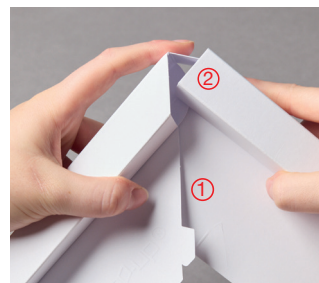

Take two of the sides and, making sure that the diagonal end of one side sits on top of the squared end of the other, ① gently slide the corners together while tucking in the corner tab with your finger. ②



Use your thumbs to slide the linking tab into the corresponding *diagonal slit*. ③



Holding the two sides in place carefully flip the frame over so the backs face upwards. Square-up the corner before using a pen or pencil to firmly push in the *corner anchor tab* to lock the corners.



Carefully flip the two sides back over again and check they're squared-up. Peel off a sticky pad from the strip and stick it down across the diagonal, as shown, with the removable side facing upwards. Don't peel off the cover yet.



Add the next side repeating the same instructions. When adding the final side, first slide *both* corners together and tuck in the *corner flaps*, then lock the corners and add the sticky pads. Remember that the diagonal ends always sit on top of the square ends.



Centre the remaining sticky pad on the back, as shown, to hang your frame. Press firmly against the wall for a few seconds. You can remove or reposition it without damaging the wall by gently rotating. Or use the centred holes to hang on a small nail or even a push pin.

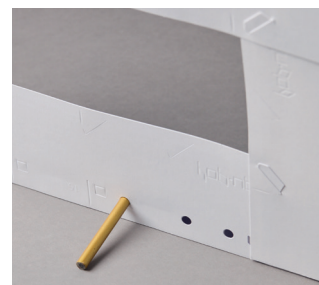

If you'd prefer a free-standing frame you can just stick a short pencil in one of the hanging holes.

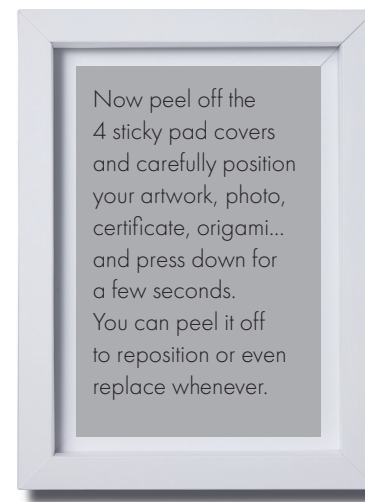

Now peel off the 4 sticky pad covers and carefully position your artwork, photo, certificate, origami... and press down for a few seconds. You can peel it off to reposition or even replace whenever.



Watch the assembly video or access the *Sizing Calculator*.

Artwork size and cutting guide for SMALL Pop-up Frames

A4* - Cut two sides at '21'

21x21cm* - Cut all four sides at '21'

A5* - Cut two sides at '21' and two at '15'

15x15cm* - Cut all four sides at '15'

30x30cm* - No cutting needed

30x15cm* - Cut two sides at '15'

Artwork size and cutting guide for MEDIUM Pop-up Frames

A4* - Cut two sides at '21' and two at '30'

21x21cm* - Cut all four sides at '21'

A3* - Cut two sides at '30' and two at '42'

50x42cm* - Cut two sides at '42'

50x50cm* - Cut all four sides at '50'

50x30cm* - Cut two sides at '30'

42x42cm* - Cut all four sides at '42'

50x21cm* - Cut two sides at '21'

30x30cm* - Cut all four sides at '30'

42x21cm* - Cut two sides at '42' and two at '21'

* All measurements indicate the maximum size of artwork BUT there's a sneaky extra 5mm to allow for encapsulation and canvases. Your artwork can be up to 10cm shorter than any of these frame sizes as it can sit within the area - see examples on our website.