



Assembly Instructions

Poly 33" Square or Round Dining/Bar Table



*Thank you for choosing **A&L Furniture Co.***

We hope that this piece brings you many years of enjoyment!

For help with assembling your furniture,
or if you have missing hardware, please email us at
help@aandlfurniture.com or call us at 866-896-5747

PARTS (included)

(A) Square or Round Top (1)

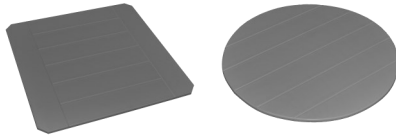

(B) Pedestal (1)

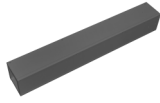

(C) Table Feet (4)

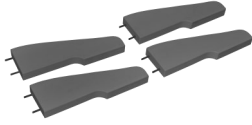

HARDWARE (included)

2" Screws (4)

(a)



Flange Nuts (8)

(b)



Square Drive Bit (1)

(c)



TOOLS NEEDED

$\frac{7}{16}$ " Wrench or Socket

Screwdriver or Drill

STEP 1

Lay table top upside down on a clean surface that won't scratch top. Insert the end of the pedestal that does not have the predrilled holes into the square in the center of the top. Push all the way down against the top then fasten with the 2" screws in the predrilled holes. (Pedestal does not have predrilled holes as screws are self drilling.)

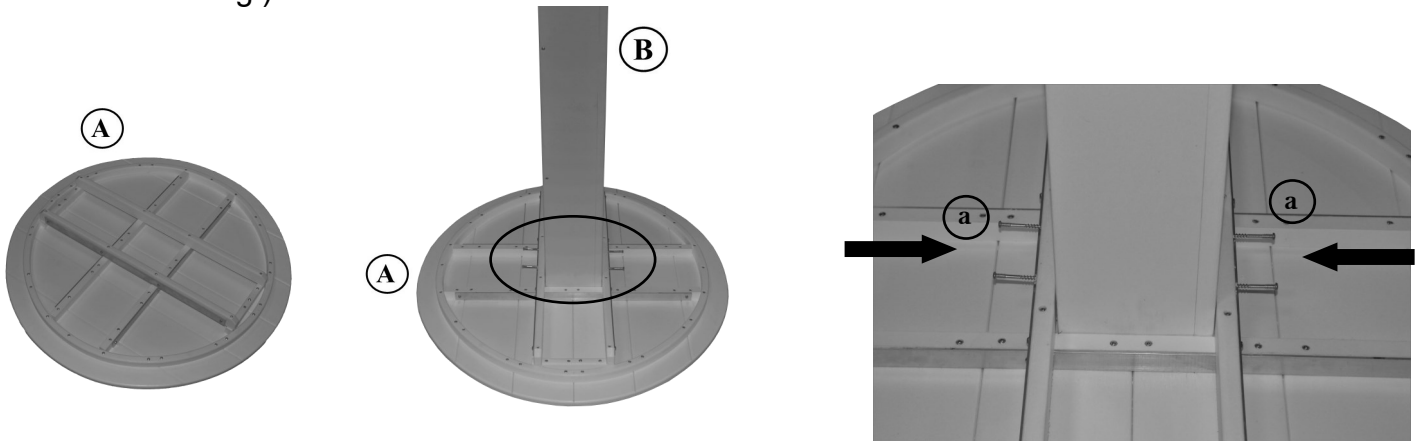

STEP 2

Insert the bolts in the ends of the table feet into the predrilled holes in the bottom of the pedestal. Put flange nuts on the inside & tighten with the $\frac{7}{16}$ " wrench or socket. Make sure feet are turned like photo shows.

