

# FireSafe<sup>®</sup>

OUTLETS



## OUTLET HEAT DETECTOR

# OWNER'S MANUAL



**FireSafe Outlets Duplex Cover**  
Model: DU1001, DU1002 & DU1003



**FireSafe Outlets Decora Cover**  
Model: DE2001, DE2002 & DE2003

### **IMPORTANT! PLEASE READ CAREFULLY AND SAVE.**

This user's manual contains important information about the operation of your FireSafe Outlets. Please take a few minutes to thoroughly read this user's manual which should be saved for future reference.

# Instructions for FireSafe Outlets

## Installation and Use



### WARNING

**DO NOT WORK ON LIVE ELECTRICAL OUTLETS:** Failure to turn OFF electrical power prior to installing or removing FireSafe Outlets can result in serious harm.

**CAUTION: Please read all instructions and warnings before installing FireSafe Outlets!**

- FireSafe Outlets are designed for dry location use only. Not intended for outdoor use or near water.
- Install FireSafe Outlets in accordance with all applicable electrical codes and regulations.
- FireSafe Outlets are designed for compatibility with permanently installed standard 15amp and 20amp duplex or decora receptacles with side terminal screws. FireSafe Outlets will not work with GFI outlets, light switches, combination light switches, USB outlets, or other outlet families.
- When installing FireSafe Outlets, ensure that area surrounding receptacle is free of any materials and obstructions that could cause a fire hazard.
- Do not install FireSafe Outlets near any heat sources such as radiators, heat registers, stoves or other apparatus (including amplifiers) that produce heat.
- Ensure any objects and/or furniture is a minimum of 5 inches away from FireSafe Outlets to allow for maximum alarm output. Alarm speaker opening should not be impeded by any items.
- Do not place any objects such as candles or items on FireSafe Outlets.
- Plastic contact arms must always fit inside the outlet box. There must be enough clearance between the sides of the receptacle and the outlet box for the contact plates on the product to slide into the outlet box and around both sides of the receptacle. Improper installation can result in damage to the product, arcing, fire and/or malfunction of your electrical system.
- If you are unsure about the instructions or require additional assistance, please consult a licensed electrician.



### CAUTION

**Before installing your FireSafe Outlets please ensure the outlet has been properly installed. Please consult a licensed electrician for additional information.**

# FireSafe Outlets Features

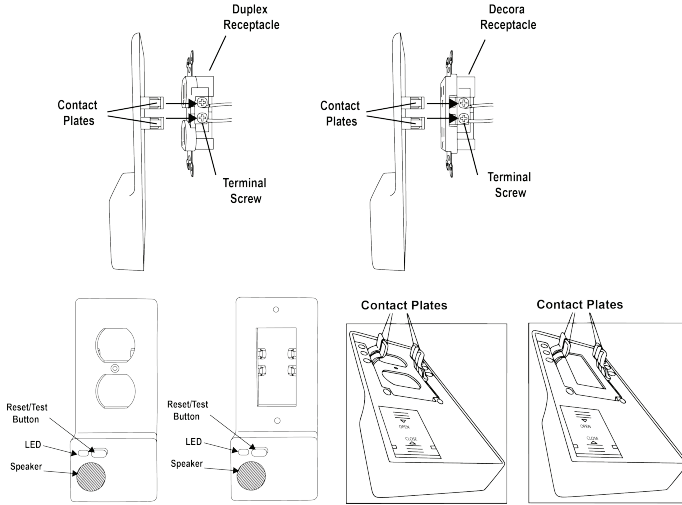

## How FireSafe Outlets Work

FireSafe Outlets are designed as an early warning heat-detecting device that monitors your outlet for any increase in temperature outside the normal range. FireSafe Outlets have four heat-detecting contact plates that slide on top of the terminal screws of the receptacle, either making contact or getting in close proximity to the terminal screws. These contact plates monitor the temperature of the receptacle. If for any reason the temperature rises above a safe range, an alarm will sound to alert you of the possible danger.

## Installation Instructions

### STEP 1:

Ensure the receptacles are compatible with FireSafe Outlets. Please refer to “Non-compatible outlets” section or consult a licensed electrician.

Duplex      Decora

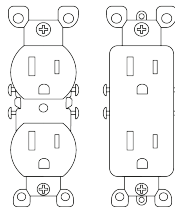

### STEP 2:

Slide battery door down to remove completely. Install one 9volt battery from package to battery connector. Once connected, LED will turn GREEN for 5 seconds to ensure the product works properly. Place battery door into battery door opening and slide up to lock into position.

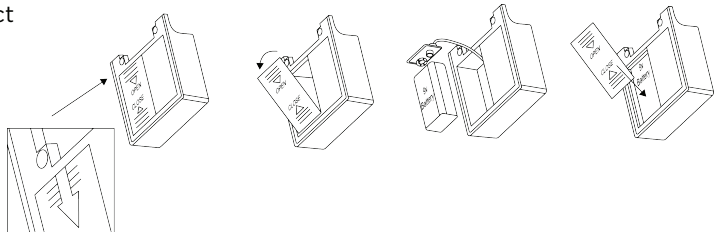

### STEP 3:

To test product before installing, press and hold the Reset/Test button for 3 Seconds. The LED will turn RED and the alarm will beep 3 times.

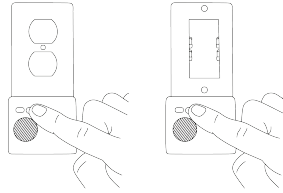

### STEP 4:

Turn OFF POWER at the circuit breaker and TEST that the power is off at the receptacle before removing the existing outlet cover.



### STEP 5:

Remove existing outlet cover.

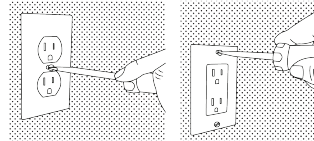

### STEP 6:

Ensure the area around the terminal screws of the receptacle is clear from any obstructions. This area must be clear for the contact plates to properly connect to the terminal screws of the receptacle. If there is an obstruction, please review the "Troubleshooting" section or consult a licensed electrician.

These areas must be clear of any obstructions

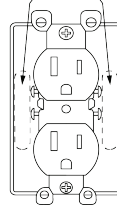

These areas must be clear of any obstructions

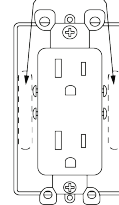

### STEP 7:

Before installing the product, make sure that the housing unit (location of LED, Reset/Test Button, and Speaker) of the product is lined up below the ground pin. For more information please read "Troubleshooting Type 8 and 9" for correct orientation/placement of product on receptacle with or without ground pin.

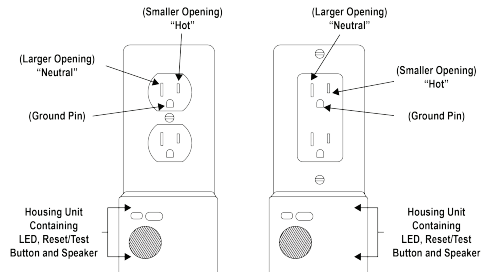

## STEP 8:

Place FireSafe Outlets over the receptacle. The contact plates should slide around the receptacle into the outlet box. Please read "Troubleshooting Type 10" for additional help.

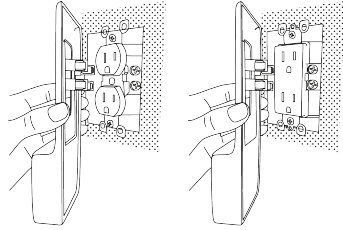

## STEP 9:

FireSafe Outlets must be flush against the receptacle and wall before securing into place with screw.

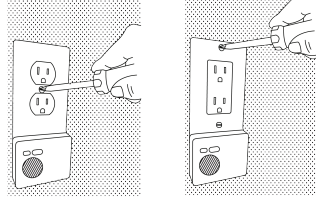

## STEP 10:

Turn power back ON at circuit breaker.

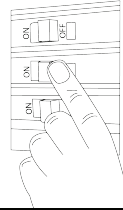

# Troubleshooting

**Troubleshooting:** The way your receptacle was initially installed can create a number of obstructions that prevent FireSafe Outlets from being properly installed and/or operating correctly. Always turn off electrical power before working around outlets. If you are unsure about the instructions or require additional assistance, please consult a licensed electrician.

## Need Help with Troubleshooting?

CONTACT: FireSafe Outlets at [support@firesafeoutlets.com](mailto:support@firesafeoutlets.com)

## Troubleshooting Type 1: Extended Terminal Screw

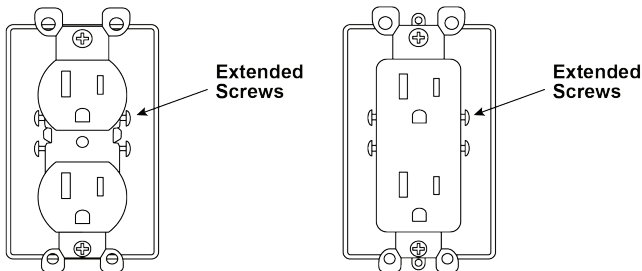

Terminal Screws may extend from receptacle preventing contact plates being properly installed. These terminal screws must be tightened for the contact plates to fit in the outlet box. If you are unsure about the instructions or require additional assistance, please consult a licensed electrician.

## Troubleshooting Type 2: Wires in the Way

Excess wire near terminal screws

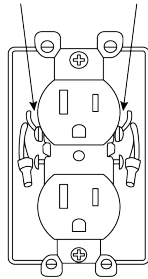

Excess wire near terminal screws

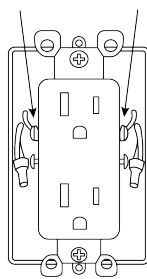

If wire excess is near the terminal screws this may prevent the contact plates from touching the terminal screws. Wire excess will need to be moved for the contact plates to properly fit in the outlet box. If you are unsure about the instructions or require additional assistance, please consult a licensed electrician.

## Troubleshooting Type 3: Excess Drywall

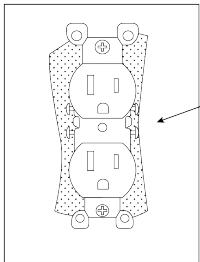

Drywall (Sheetrock)

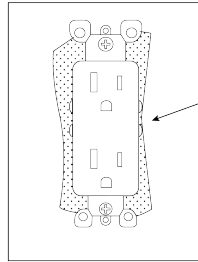

Drywall (Sheetrock)

Drywall or sheetrock may prevent the contact plates from properly connecting; remove the excess drywall near the terminal screws. If you are unsure about the instructions or require additional assistance, please consult a licensed electrician.

## Troubleshooting Type 4: Receptacle Not Centered Correctly

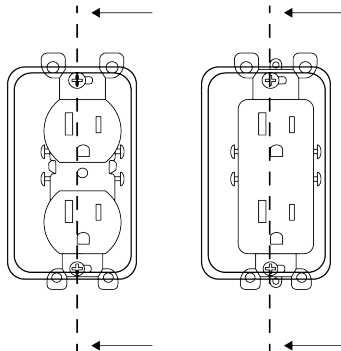

A receptacle that is not properly centered in the outlet box may prevent contact plates from being properly installed. You may need to adjust your receptacle so it is centered in the outlet box. If you are unsure about the instructions or require additional assistance, please consult a licensed electrician.

## Troubleshooting Type 5: Electrical Tape

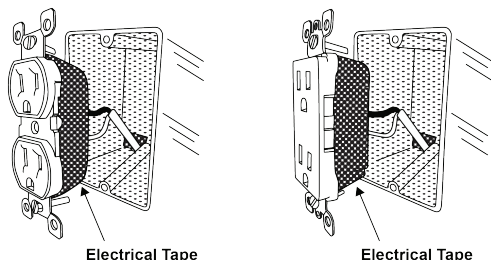

If electrical tape is around your receptacle it will prevent an accurate reading of the terminal screws. Remove the tape to enhance accuracy in monitoring possible heat build-up. If you are unsure about the instructions or require additional assistance, please consult a licensed electrician.

## Troubleshooting Type 6: Recessed Outlet Box

Receptacle extends outside the outlet box

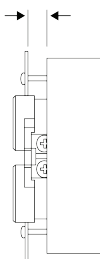

Receptacle extends outside the outlet box

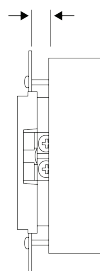

If the receptacle is recessed or extends outside the outlet box please take extra care during installation. You may need to adjust the receptacle to ensure FireSafe Outlets are flush to the outlet box. If you are unsure about the instructions or require additional assistance, please consult a licensed electrician.

## Troubleshooting Type 7: Excess Paint

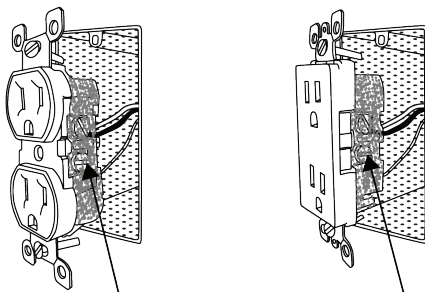

**Excessive Paint Covering Terminal Screws**      **Excessive Paint Covering Terminal Screws**

Excessive paint may coat the sides of the receptacle and prevent accurate temperature readings of the outlet. Any excess paint will need to be removed from the terminal screws for FireSafe Outlets to properly monitor your outlet. If you are unsure about the instructions or require additional assistance, please consult a licensed electrician.

## Troubleshooting Type 8: Correct Orientation/Placement of Product on Receptacle with NO Ground Pin:

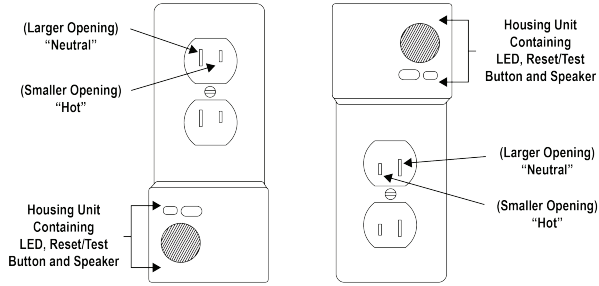

Please note that the orientation of the receptacle in the outlet box determines how FireSafe Outlets should be positioned during installation. If the receptacle has no "ground pin", install FireSafe Outlets with the housing unit (location of the LED, Reset/Test Button and Speaker are located) aligned to the same side of the larger "neutral" opening of the receptacle. If you feel resistance while installing FireSafe Outlets recheck orientation for proper installation. If you are unsure about the instructions or require additional assistance, please consult a licensed electrician.

## Troubleshooting Type 9: Correct Orientation/Placement of Product on Receptacle with Ground Pin

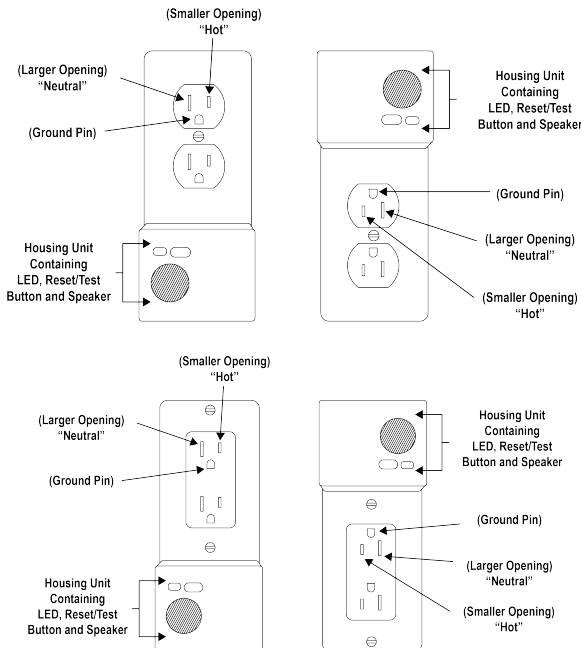

Please note that the orientation of the receptacle in the outlet box determines how FireSafe Outlets should be positioned during installation. When the receptacles "ground pin" is located below the "neutral" and "hot" opening, install FireSafe



Outlets with the housing unit (location of LED, Reset/Test Button and Speaker are located) positioned below the “ground pin”. If the receptacles “ground pin” is located above the “neutral” and “hot” opening, install FireSafe Outlets with the housing unit (location of LED, Reset/Test Button and Speaker are located) positioned above the “ground pin”. If at any time you feel resistance while installing FireSafe Outlets recheck the orientation for proper installation. If you are unsure about the instructions or require additional assistance, please consult a licensed electrician.

## Troubleshooting Type 10: Installation of FireSafe Outlets Option

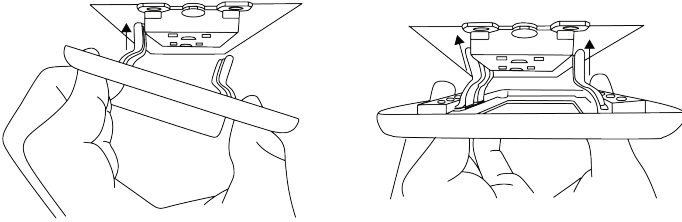

Angle one side of the contact plates into the outlet box past the receptacle. The contact plates should now be in the outlet box against the receptacle. Now slide the contact plates on the other side into the outlet box past the receptacle. Finally slide FireSafe Outlets flush against the outlet.

## Non-Compatible Outlets

**Types Of Non-Compatible Outlets:** FireSafe Outlets work on all standard duplex and decora receptacles that have side terminal screws. The majority of homes in the U.S. have these types of receptacles in their home. Listed below are examples of outlets that are non-compatible with FireSafe Outlets.

### NON-COMPATIBLE OUTLETS

**Do Not Install FireSafe Outlets On The Outlet Types Shown Below**

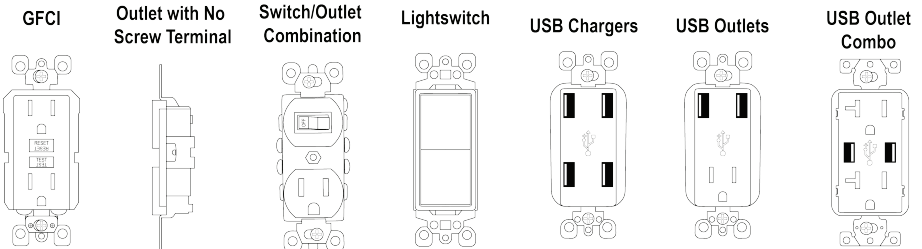

## Types of Non-Compatible Duplex and Decora Outlets:

Company	Outlet Style	Receptacle Type	Amps	Barcode
Legrand	Decora	Commercial Back and Side Wire Tamper Resistant (Receptacle 304B)	15	785007055214
Legrand	Decora	Commercial Back and Side Wire Tamper Resistant (Receptacle 304B)	20	785007015591

## Operations Mode

**Operations Mode:** Please familiarize yourself with the following modes that may be activated on your FireSafe Outlets.

Mode	LED Operation	Speaker
Power On; When Battery Attaches to Battery Connector	LED Turns Solid Green for 5 Seconds, Then Turns Off	No Audible Alarm
Normal Operation	LED Off	No Audible Alarm
Heat Detected	LED Turns Solid Red	Alarm Will Repeat Cycle of Beeping for One Second, Pause, Beep for One Second
Low Battery	LED Flashes Once Every 5 Seconds	1 Beep Every 45 Seconds
Test Alarm; (Press and Hold the Reset/Test Button for 3 Seconds)	LED Will Turn Solid Red for 5 Seconds, Then Turns Off	1 Beep Per Second for 3 Times
Silence Alarm; (Press Reset/Test Button Once While Alarm is Sounding)	LED Will Stay Solid Red Until Heat Drops Back Into Normal Range and LED Will Turn Off	Alarm Will Become Silent

### WHAT TO DO WHEN MY ALARM IS ACTIVATED:

#### Alarm is Activated:

Alarm activation is caused by excessive heat build-up at your receptacle. This can be due to many different factors that could result in a fire. When alarm is activated, evacuate the structure immediately and call the fire department.

#### Low Battery Alarm Activated:

The low battery alarm activation means that your battery voltage is depleted beyond the point of having the capacity to operate FireSafe Outlets. THE BATTERY MUST BE CHANGED IMMEDIATELY! Before changing the existing battery, you MUST

TURN OFF POWER at the circuit breaker. Remove FireSafe Outlets from the receptacle. Replace battery with one 9volt battery. Install FireSafe Outlets onto receptacle. Turn power back on at circuit breaker. If you are unsure about any of these instructions, please consult a licensed electrician.

#### **Maintenance of FireSafe Outlets:**

- Clean only with a dry cloth and vacuum alarm cover slats once a month to remove any accumulated dust.
- Replace 9volt battery every 6 months.
- Test alarm once a month by holding the Reset/Test Button for 3 seconds.
- Refer all servicing questions to FireSmart Technology Inc. personnel. Servicing is required when FireSafe Outlets have been damaged in any way, liquid has been spilled or objects have fallen into the product, the product has been exposed to rain or moisture, does not operate normally, or has been dropped.

## **Warnings and Disclaimers**



- FireSafe Outlets are intended as an early warning outlet heat-detecting device to notify present occupants that their outlet is starting to overheat beyond the normal temperature range. FireSmart Technology Inc. makes no claim that their products will stop outlets from catching fire or prevent fires from occurring.
- Alarm may not be heard due to a sound sleeper or someone under the influence of medication, drugs or alcohol. Closed or partially closed doors, far distances, and excessive furniture or objects in front of the product can block sound output. This alarm is not designed for the hearing impaired.
- Do not stand too close to alarm when the alarm is sounding. Exposure to the alarm at a close range can cause hearing problems. FireSmart Technology Inc. is not responsible for any hearing problems as a result of the alarm.
- Product will not work without a 9volt battery installed properly.
- When Low Battery mode is occurring, please change battery immediately. Failure to do so will result in the battery being depleted and the product will not function. FireSmart Technology Inc. is not responsible for any damages as a result of a depleted, malfunctioning, or improperly installed battery. Attention should be drawn to the environment aspect of battery disposal.
- Never remove the battery to stop an unwanted alarm. Removing the battery will disable the product from working.
- FireSafe Outlets ONLY monitor the heat temperature of the receptacle that the product is installed to.
- FireSafe Outlets ONLY monitor the temperature of the receptacle, **NOT** the appliances that are plugged into the outlet.
- A faulty appliance could catch fire despite being plugged into the same receptacle that FireSafe Outlets is installed to without activating the alarm. FireSafe Outlets makes no claim to prevent fires due to faulty appliances.
- In no event will FireSmart Technology Inc. or any of its affiliates, retailers, or resellers be liable for incidental damages relating to the product, its use, or its installation, including but not limited to: damage to, or loss of use of, any equipment.
- FireSafe Outlets could have false activations due to excessive ambient heat temperatures.

# Product Warranty

## FIRESAFE OUTLETS LIMITED WARRANTY 120 DAYS FROM PURCHASE DATE

### What does the limited warranty cover and for how long:

The limited warranty covers FireSafe Outlets (except battery) that have a manufacturing defect limited to speaker, LED, reset/test button, battery cover, electronics, heat-sensor, contact plate and outer plastic shell of product for a period of 120 days from the date of original purchase as shown on your invoice or sales receipt. This warranty extends only to the original consumer of the product from FireSmart Technology Inc. or from an authorized reseller.

### What isn't covered under limited warranty:

Limited warranty does not apply to defects resulting from improper installation resulting in contact plates becoming broken or any other part of the product becoming broken, improper handling or maintenance, normal wear and tear; and any use that is not under normal operating conditions or not in accordance with any product packaging, warnings, or instructions for use. Some states, provinces or jurisdictions do not allow the exclusion or limitation on how long an implied warranty lasts, so the above limitations or exclusion may not apply to you. This warranty gives you specific legal rights, and you may also have other rights that vary from state to state or province to province.

### Warranty disclaimer:

In no event should FireSmart Technology Inc. or the manufacturer be liable for loss of use of FireSafe Outlets or for any indirect, incidental or consequential damages, or costs, or expenses incurred by the consumer or any other user of this product. FireSmart Technology Inc. or the manufacturer shall have no liability for any personal injury, property damage or any special, incidental, contingent or consequential damage of any kind.

### If FireSafe Outlets has a defect:

FireSmart Technology Inc. apologizes for the inconvenience. If FireSmart Technology Inc. determines there is a defect covered by the limited warranty, FireSmart Technology Inc. will repair and replace the product.

### How to replace a defected product under limited warranty:

To make a claim under the limited warranty you must first contact FireSmart Technology Inc. within the limited warranty period. Please write to: FireSmart Technology Inc. PO Box 30656, Staten Island, NY 10303 or email support@firesafeoutlets.com. You must provide proof of purchase in the form of your original sales receipt in order to obtain limited warranty coverage. After FireSmart Technology Inc. receives an email or letter with all the appropriate information regarding the product, FireSmart Technology Inc. will notify you via email or letter with a confirmation number and address to mail the defected product back. FireSmart Technology Inc. will perform the warranty obligations, if any, within 30 days of the owner's submission of the warranty claim if deemed that the product is defective.

FireSafe Outlets® is a registered trademark of FireSmart Technology Inc.

  
**FireSmart Technology Inc.**  
PO Box 30656  
Staten Island, NY 10303



CONFORMS TO  
UL STD. 62368-1&514D

CERTIFIED TO  
CSA STD C22.2 NO. 62368-1  
CSA STD C22.2 NO. 42.1

Copyright © 2020 FireSmart Technology Inc.

#### Follow Us:

 firesafe\_outlets  FireSafe Outlets  
Internet: www.firesafeoutlets.com