

The Wood Pellet Patio Heater
By Wood Pellet Products, PO Box 761 Mt. Angel, OR 97362

Owner's manual
Lil' Timber Patio Heater
Model: WPPHLT2.5LS

WARNING

Do not store or use gasoline or other flammable vapors and liquids, solid combustibles in the vicinity of this appliance. Keep a safe distance away from the heater as it is extremely hot during operation.

FOR OUTDOOR USE ONLY

This outdoor patio heater must be used outdoors only in a well-ventilated area and is not to be used in a vehicle or any enclosed building.



IMPORTANT

Your safety is very important to us, please read this manual thoroughly before you install, operate and maintain this heater. Retain this manual for future reference. If you have questions about assembly, operation, servicing or repair of this heater please call us directly at **877-347-2848**

California Proposition 65 Warning:

This product can expose you to chemicals including carbon monoxide, which is known to the State of California to cause cancer, birth defects and/or other reproductive harm. For more information, go to www.p65warnings.ca.gov

Table of Contents

Important Warnings.....	2
Introduction.....	3
Specifications.....	3
Important Safety Precautions.....	3
Assembly.....	4
Unpacking.....	4
Installation.....	8
Operation.....	8
Storage.....	9
Maintenance.....	9
Troubleshooting.....	9
Service and Warranty Information.....	10

IMPORTANT WARNING

- Sharp contents, assemble with care. Wear gloves when assembling stove pipe.
- Improper installation, adjustment, alteration, service or maintenance can cause injury or property damage from hazards of fire, explosion, burn, asphyxiation, and carbon monoxide poisoning. Please be sure you understand all installation, operation, and service instructions before using this heater.
- Handle metal parts with care to avoid injuries. Never allow children to operate this heater.
- Do not store or use gasoline, other flammable vapors and liquids, and solid combustibles in the vicinity of this appliance.
- Maintain a safe distance away from the heater as it is extremely hot during operation.
- Your heater requires periodic maintenance and cleaning (see “maintenance”). Failure to maintain your stove may lead to improper and/or unsafe operation.
- Do not operate your stove with the viewing door open. The stove will not function properly with the door open and will possibly allow sparks and fumes to dispel from the firebox.
- Allow the stove to cool before performing any maintenance or cleaning. Ashes must be disposed of in a metal container with a tight-fitting lid. The closed container of ashes should be placed on a non-combustible surface and away from all combustible materials.
- The stove pipe should be checked monthly for any build-up of soot or creosote, and properly cleaned if build-up has occurred.
- Never block free airflow through the open vents of the unit.
- CAUTION: Burning fuel creates carbon monoxide and can be hazardous to your health if not properly vented.

Introduction: Thank you for choosing the Wood Pellet Patio Heater. Please take the time to read these instructions and follow each step carefully for safe operation. Retain this manual for future reference. If you have any questions regarding these instructions or operation of this heater, please contact us directly for assistance at 877-347-2848.

Specifications

Model	
No.....	WPPHLT2.5LS
Type of Fuel.....	1/4" diameter by 1/2" long wood pellets
Input rating	72,000 BTU/HR
Overall Height.....	84 Inches
Reflector Diameter.....	18 Inches
Ignition System.....	manually light with a match and alcohol gel firelighter
Electrical connections	None Required
Net Weight.....	70 IBS

FOR OUTDOOR USE ONLY.

DO NOT USE THIS UNIT IN A CLOSED SPACE.

Alert both children and elders to the hazard of high surface temperatures.

Your children and pets should be supervised when they are in area of heater.

This outdoor patio heater must be used for outdoors only in a well-ventilated area and not be used in a vehicle or any enclosed building or space.

Always place the heater on a level stable surface.
Do not move or touch the heater while it is hot or burning.

Do not alter or modify the heater in any manner.

Always keep at least 36 inches of clearance from the stove to any combustible material.

Do not use the heater if the wind velocity is greater than 10 miles per hour.
Do not spray aerosols near the heater while in use.

Do not clean heater with combustible or corrosive cleaners. Use warm, soapy water.

Do not hang clothing or flammable materials either on or near heater

Allow 45 minutes for the heater to cool down after use before attempting to move your heater.

Do not operate a damaged heater.

Never use petroleum based flammable vapors or liquids in or near this heater.

Warning:

When the heater is to be operated in the presence of other people, the owner/purchaser is required to inform people unfamiliar with the operation of the patio heater of the instructions, and of the hazards involved of operation. If this heater is used in a commercial or rental installation, it is the responsibility of the purchaser to check with the local codes for properly acquainting users with the safety precautions and instructions.

Failure to comply with the precautions and instructions provided with this heater can result in death, serious bodily injury and property loss or damage from hazards of fire, explosion, burn, asphyxiation, or carbon monoxide poisoning. Be sure you understand all operation instructions before attempting to operate or service this heater.

Fuel Considerations:

Your pellet stove is designed and tested with premium grade pellets that comply with Pellet Fuels Institute standards. You can only burn premium grade pellets in this heater (minimum 40 lbs density per cubic feet, 1/4" to 5/16" diameter, with a length no greater than 1.5", not less than 8,200 BTU/lb, moisture under 8% by weight, ash under 1% by weight, and salt under 300 parts per million). Pellets that are soft, contain excessive amounts of loose sawdust, have been, or are wet, will result in reduced performance and may cause damage to your heater. Store your pellets in a dry place. DO NOT over-fire or use volatile fuels or combustibles to increase heat output, doing so may cause personal and property damage hazards.

For help with assembly, visit our YouTube channel: Wood Pellet Products and find our timber heater assembly - Big Timber & Lil Timber Models. You will also find a maintenance video we recommend you watch as well.

1. Assembly

Note: Partial assembly has been done for you. Use this assembly guide as an example for the remaining parts. The assembly of this heater requires basic mechanical skills. Proper assembly is the responsibility of the purchaser. All service and repairs should be done by a qualified person.

Tools required for assembly are:

Phillips Screwdriver / Drill with Philips bit.
Crescent Wrench

1.1 Unpacking

Carefully remove all parts from the box. The paint on the heater is not fully cured until after you fire the unit on its initial firing, so use care when handling painted parts.

Find and identify the following parts:

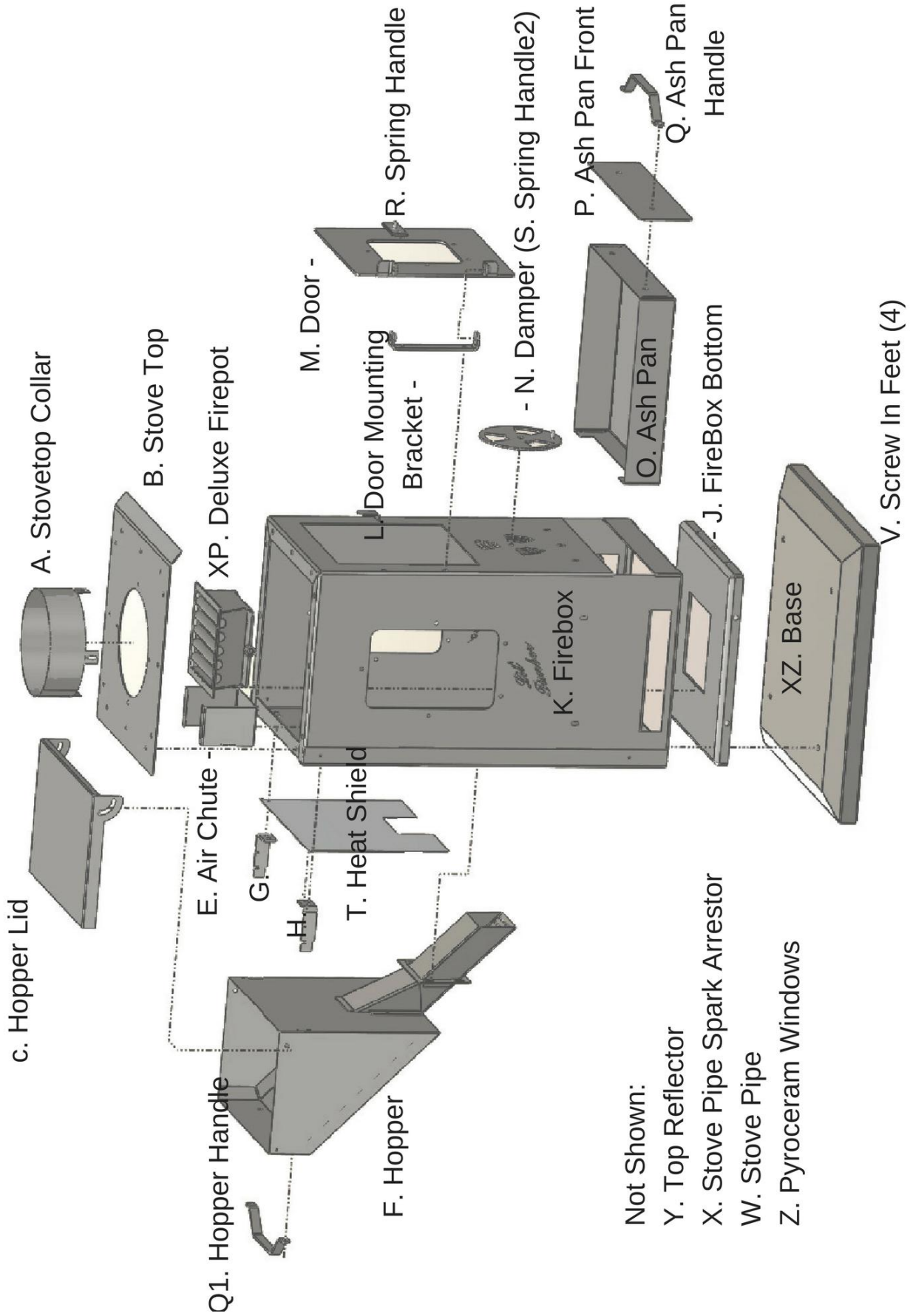

Included in the box is a hardware bag that contains:

Count	Part	Application
32	10/32 x 1/2" Bolts	<ul style="list-style-type: none"> ● Attaching (B) Stove top to (K) Firebox - Uses 12 ● (J) Firebox Bottom to (K) Firebox - 9 ● (A) Stove top collar to (B) Stove top - 4 ● (Y) Top Reflector to (X) Stove Pipe Spark Arrestor – 3 ● (L) Door Mounting Bracket to (K) Firebox - 2
6	1/4- 20 x 1/2" Bolts	<ul style="list-style-type: none"> ● (XZ) Base to (K) Firebox – 4 ● (M)Door to (L) Door Mounting Bracket – 2
6	1/4 x 7/8" Bolts	<ul style="list-style-type: none"> ● (Q) and (Q1) handles to (F) hopper and (O) ashpan - 2 for each handle. 2 for wheel kit that attaches to the stainless base.
7	10/32" Nuts	<ul style="list-style-type: none"> ● (A) Stove top collar to (B) Stove top - 4 ● (Y) Top Reflector to (X) Stove Pipe Spark Arrestor - 3
4	1/4" Nuts	<ul style="list-style-type: none"> ● (Q) and (Q1) handles to (F) hopper and (O) ashpan - 2 for each handle
10	Lock Washers	<ul style="list-style-type: none"> ● (XZ) Base to (K) Firebox - 4 ● (Q) and (Q1) handles to (F) hopper and (O) ashpan - 2 for each handle ● 2 for wheel kit
2	Spring Handles	<ul style="list-style-type: none"> ● (R) Door Spring Handle and (S) Damper Spring Handle
4	Feet Glides	<ul style="list-style-type: none"> ● (V) Feet Glides to (XZ) Base – 4
9	Self Tapping Screws	<ul style="list-style-type: none"> ● Self tapping screws are included to secure the stove pipe. Secure using 3 screws in each pipe section. (Optional)

1.2 Assembly Instructions

Some parts are covered in protective vinyl. Peel this off prior to burning.

Step 1 - Attach Stove Base: Attach wheel kit to base with (2) 1/4 20 x 7/8 bolts and (2) 1/4" lock washers. Lay (K) firebox upside down on a piece of foam provided. Align (XZ) Base holes with the underside of the firebox (wheels in the rear). Place one lock washer on each 1/4 x 1/2" bolt and screw the bolts into the threaded holes of the firebox. Screw In the four feet glides using (4) 5/16" lock washers to the bottom corners of the base. If you purchased casters, screw in place of the glides with the large lock-washers provided. Return stove to the upright position.

Step 2 - Installing the Fire Box Bottom Plate: The (J) Firebox Bottom is installed with the flat surface facing up (1/2" flanges face down), inside of (K) Firebox. The side of the Firebox Bottom with 3 threaded holes faces the front of the stove. Attach the Firebox bottom using nine 10/32" bolts inserted through slotted holes that are located just below the damper (N). The slotted holes are on all four sides of the firebox.

Installing the Deluxe Fire Pot:

Insert (XP) the Firepot into the square cutout on the firebox bottom. The 3/8" nut on the bottom of the fire pot will face towards the rear of the firebox. Make sure the fire pot sits flush with bottom. Place large washer onto the pull rod. Insert the Pull rod from rear and align with nut on firepot bottom. Turn clockwise until tight. **The pull rod should be pushed in during operation.**

Step 3 - Assembling the Ash Pan: Place the (P) Ash Pan Front (with the holes closer to the top) onto the (O) Ash Pan. Insert two 1/4 x 7/8" bolts into the (Q) Ash Pan Handle. Position handle onto the front of ash pan with the bolts going through the holes. Secure the bolts on the inside with a lock washer and a 1/4" nut each on the inside. Slide completed ash pan into the front of the firebox.

Step 4 - Installing the Door Mounting Bracket/Door: Mount (L) Door Mounting Bracket to (K) Firebox using two 10/32 x 1/2" bolts. Attach the door (M) using two 1/4 -20 x 1/2" bolts. Twist on the spring handles to the door latch and damper dial.

Step 5 - Installing the Stove Top Collar onto the Stove Top: Slip the Stove Top Collar (A) up from underside of the Stove Top (B) through the center hole. the flange holes need to be aligned with the holes on the Stove Top. Insert four 10/32" bolts from the top into the holes on the center of the stove top and fasten with four 10/32" nuts on the underside.

Step 6 - Installing the Stove Top: Place (B) Stove Top on top of (K) Firebox with the beveled edge facing down on the front of the heater. Secure with twelve 10/32" bolts.

Step 7 - Attaching Hopper Handle and Shut-Off Key (mushroom shaped with wire loop): Place the shut-off key loop around one handle. Using two 1/4 x 7/8" bolts Align the (Q1) hopper handle with holes on backside of hopper and secure with a lock washer and a 1/4" nut for each bolt from the inside of the hopper.

Step 8 - Installing the Hopper Heat Shield: Install (T) Heat Shield by sliding heat shield in between the hopper and fire box so that the tabs are inserted into the slots located on the (G) and (H) hopper brackets. Insert from Top down.

Step 9 - Attaching the Spark Arrester to Top Reflector: Attach the (X) Stove Pipe Spark Arrester (stove pipe piece with logo) to the (Y) Top Reflector using three 10/32" nuts and 10/32" bolts. First, bend the tabs on the top of the spark arrestor 90 degrees out. Position over holes on the top reflector and bolt together.

Step 10 - Assembling Stove Pipe and Installing on Stove: Place (W) Stove Pipe on the ground (on a nonabrasive surface like carpet or rug). Start on the bottom end and gradually connect two sides of locking pipe. Attach one (W) Stove Pipe to (A) Stove Top Collar with the **crimped end up**. It's easiest to place lock side on to the back of the collar and pull the stove pipe forward then down over the collar. Place second piece of stove pipe onto the first piece with the **crimped end up**. Push down until secure. Place the Stove Pipe Spark Arrestor (connected to the top reflector) onto the top of the second stove pipe section. Push down until secure. Self-tapping screws included to secure stove pipe if needed.

Shutoff Key – The stove is supplied with a hopper shutoff key and attachment rope. Hang the key from the hopper handle. This shutoff key gets inserted into the slot located at the bottom of the hopper chute on the **outside** of the firebox. Ensure the key sits level with the ground when in place. If not, lift up on the key until it is level. Insert all the way until the keys edge makes contact with the hopper back. Pull out when you want to use the heater.

2. Installation

This heater is intended to be used outdoors only! It should never be used in an enclosed area or a confined space.

2.1 Installation warning

The installation must conform with local, state and federal codes. In absence of such codes, install in accordance with the current American National Standard (ANSI) / National Fire Protection Association (NFPA) codes. Please check local EPA laws to conform with local regulations.

2.2 Minimum clearances

A minimum 36" clearance from this heater and all its parts to combustible materials must be maintained at all times while the heater is in operation.

2.3 This Heater is to be used on a flat level non-combustible surface only.

Install on flat level non-combustible surface (concrete, tile, stone, etc.).

3. Operation

3.1 Preparation before lighting

3.1.1 Check any possible shipping damage of the heater. If any is found, call us directly.

3.1.2 Please review thoroughly and be sure you understand all of the "safety precautions and warnings".

3.1.3 Make sure the firepot is in its proper position with the firepot rod pushed in.

3.1.4 Pour pellets into the hopper with the shut-off key inserted into the slot located at the bottom backside of the hopper.

INITIAL FIRING OF THE HEATER: On initial firing fill the hopper $\frac{3}{4}$ full. This one time initial firing needs to be done to cure the paint on the unit. Open the damper on the heater and leave it open for the entire initial burn period. Having the damper closed on initial firing will result in very high temperatures and potentially damage your heater voiding your warranty. Fire the unit and let it burn through all of the pellets and then let the heater cool. You will now be free to use the unit according to the remainder of these directions. On your first firing, the high temperature paint on the unit will cure. When curing, the paint gives off smoke. This will happen for about the first 15 minutes of operation. Do not breath these fumes.

3.1.5 Pull the shutoff key all the way out when ready to burn. Do not attempt to regulate the flow of pellets with the shutoff key.

3.2 Lighting

- 3.2.1 Open the door and squirt about two tablespoons of alcohol fire gel on the mound of wood pellets in the middle of the firebox. Pellets will have funneled down from the hopper chute.
- 3.2.2 Light the alcohol fire gel with a match and close the door.
- 3.2.3. Open the (N) Damper below the door for the first ten minutes of a burn.
- 3.2.4 Standard burn time for the heater on one full hopper (12lb) is about 1.5 hours. You can extend this burn time by adding pellets to the hoppers during the burn.
- 3.2.5 This stove is supplied with a slanted firepot to help burn hotter and longer reducing the ash content while burning. Clean grate and slots by pulling the pull rod from the back of stove and pushing it back in. The rod should always be in fully closed position while in operation.

Damper Control is both temperature control as well as combustion efficiency control. To reduce temperature of stove by 250 degrees open damper to see slots. To increase temperature by 250 degrees close damper fully seeing no slots. Opening damper will also clean up particulates (smoke) by increasing oxygen to fire.

If the heater runs out of fuel, do not attempt to refuel and light the heater before it has fully cooled down (approx. 30 min). The unit will smoke excessively if attempted.

4. Storage

- 4.1 When you are finished using the Heater you should make sure that the fire is completely out. Allow at least 45 minutes for the heater to cool down before transporting.
- 4.2 Store the heater upright in a sheltered area away from inclement weather such as rain, snow and dust.
- 4.3 This unit is manufactured as an "Outdoor Unit" from steel. If you leave it in the weather it will accumulate rust. This is normal and can be treated by using touch up paint in spray cans available from Wood Pellet Products. We Recommend purchasing a cover if you live in a particularly wet climate.

5. Maintenance

- 5.1 To obtain the best performance from your heater make sure you perform the following maintenance activities on a regular basis:
- 5.2 After a burn and once the heater is completely cooled, clean out any remaining ashes from on top of the firepot, in-between the bars and in the ash pan.
- 5.3 Keep exterior surfaces clean. Use warm soapy water for cleaning.
- 5.4 Never use flammable or corrosive cleaning agents on or near this Heater.
- 5.5 Airflow through the spark arrester must be unobstructed, clean regularly with canned air.

Glass Cleaning

Only clean stove glass when the heater is off and fully cooled. Should a buildup of creosote or carbon accumulate, we recommend wiping the windows down with a wet rag. If the glass still appears foggy, a razor blade can be used to scrape away what remains. DO NOT operate the stove if the glass is broken.

Caution:

Never burn stick wood or plastic or other combustibles in this heater. Burn only 1/4" diameter wood pellets. Never spray any cleaning product on or into any of the doors, air intakes, or dampers.

6. Trouble Shooting

	Solution
The stove is not burning hot	<p>Usually, the cause of poor performance of the heater is the fuel. Make sure you are using high grade pellets with a BTU rating of at least 8,200/Hr.</p> <p>Proper maintenance of the stove is essential for maximum heat output. Make sure to clean out the firebox and scrape in-between the firepot bars. Clear the spark arrestor with compressed air or with a brush.</p>
Smoke/Burning Dirty	A well-maintained stove with high grade pellet fuel will burn the cleanest. More oxygen to the fire will produce a cleaner burn which can be achieved by opening the damper slightly. You should instantly be able to tell a difference after opening the damper.

7. Temperature Control:

To maximize heat output, close the damper dial completely by turning it until all slots are no longer visual. To decrease temperature open damper to allow air to move through the unit and cool it down.

8. Service and warranty Information

To learn how to service and procure parts for worn out, defective or damaged components, please call us directly for assistance. Warning: Use our original equipment replaced parts only. Use of unauthorized parts or modification of parts will void warranty and create an unsafe condition. For warranty information please see the Limited Warranty page provided in the packet.

Patent Pending: woodpelletproducts.com
Copyright 2021, All Rights Reserved

www.woodpelletproducts.com