

We recommend installation of crash bars by a qualified workshop.

Tips:

- you need a second person for installation
- make sure all motorcycle components are cool before working
- Follow the instructions
- use glue for bolted connections

*Mount every crash bars separately, don't unscrew all the mounting points at the same time.*

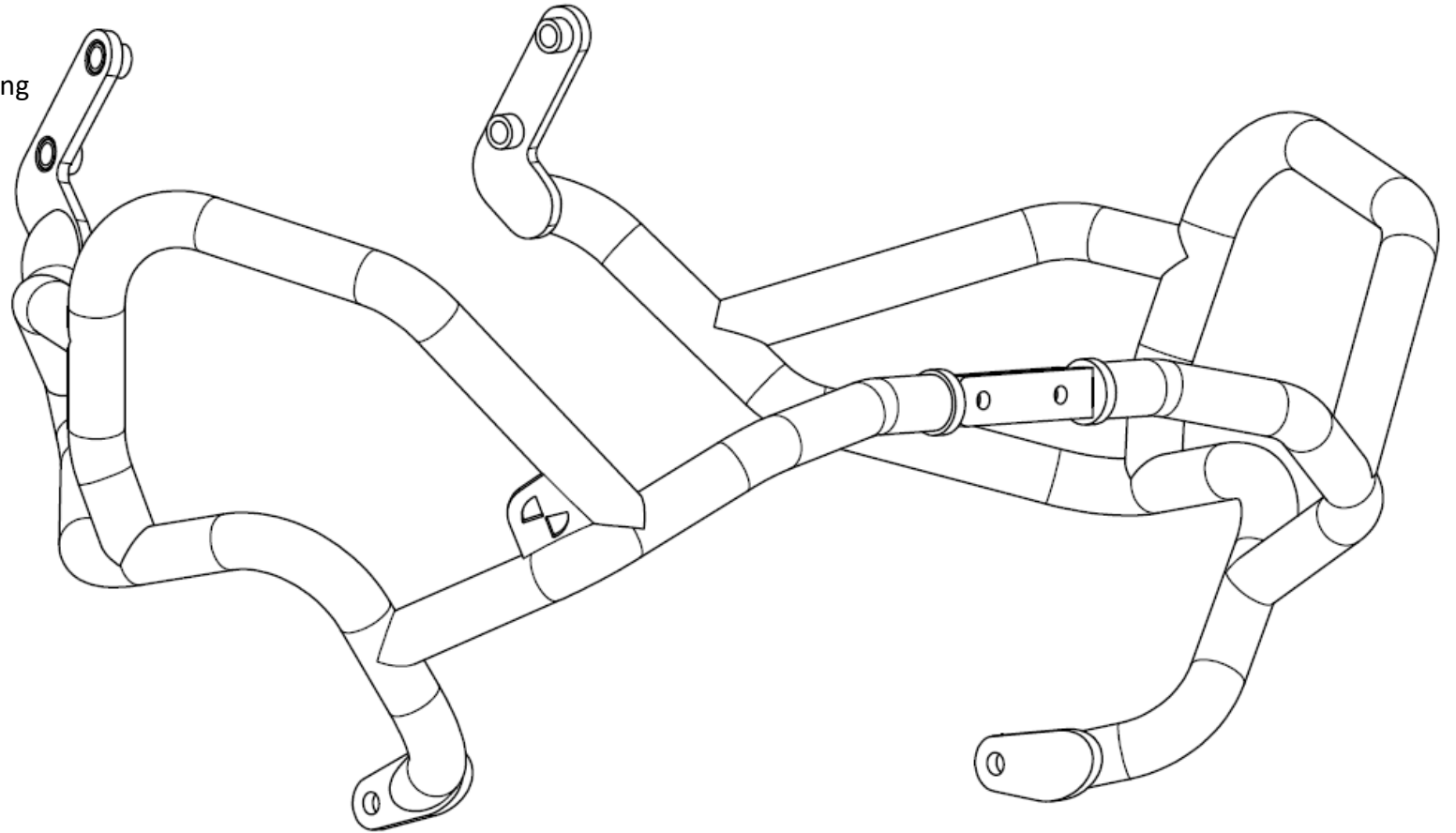

## CRASH BARS GARDA PRO FOR TENERE 700 WR INSTALLATION MANUAL

## RIGHT CRASH BAR

1. Remove the original bolts and install the crash bar according to the diagram and photos leaving a delicate clearance on the screws.

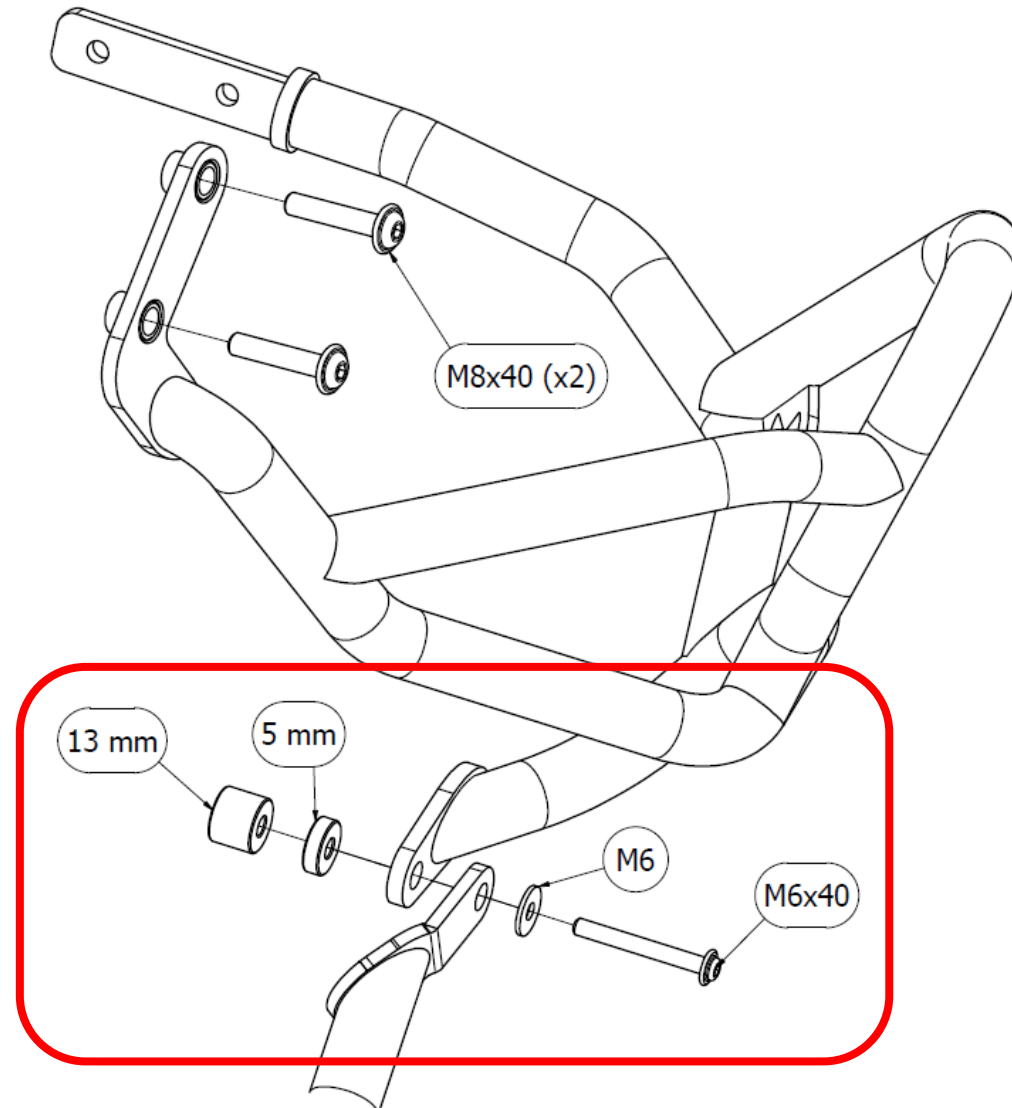

**This marked area has four variants of assembly. All of them will be shown on the next page.**



**Right side of the Garda Pro and Low crash bars with original skid plate**

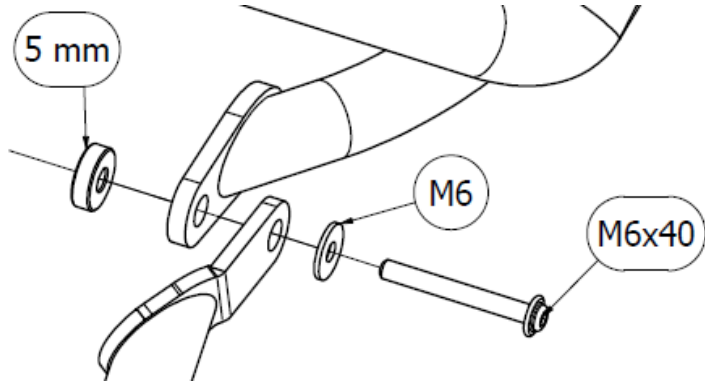

**Right side of the Garda Pro and Low crash bars with Garda skid plate**

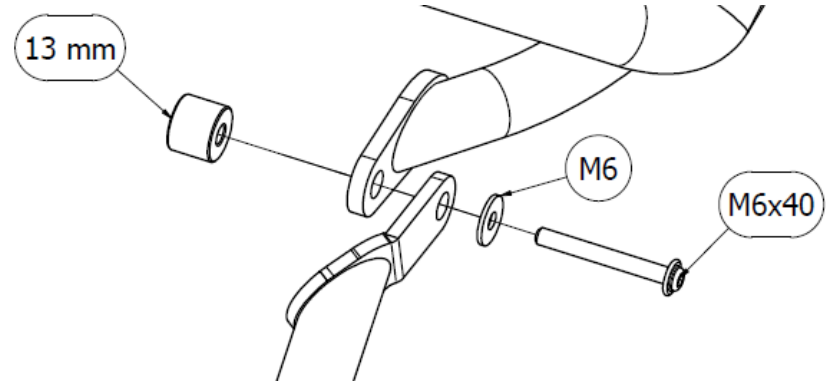

**Right side of the Garda Pro crash bar with original skid plate**

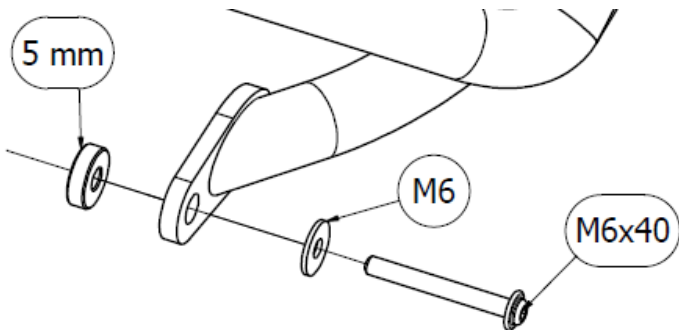

**Right side of the Garda Pro crash bar with Garda skid plate**

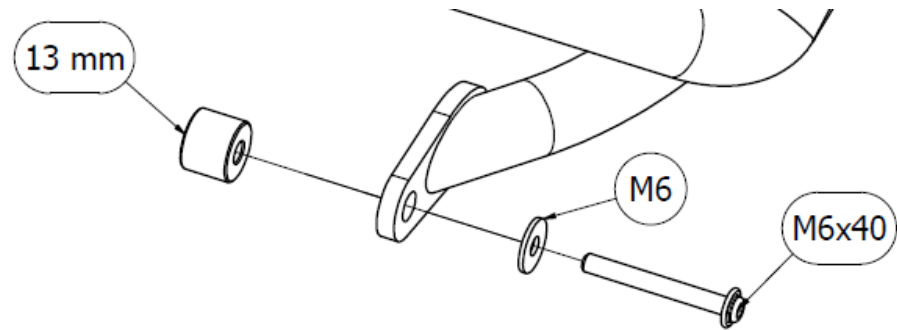

## LEFT CRASH BAR

2. Remove the original bolts and install the crash bar according to the diagram and photos leaving a delicate clearance on the screws.

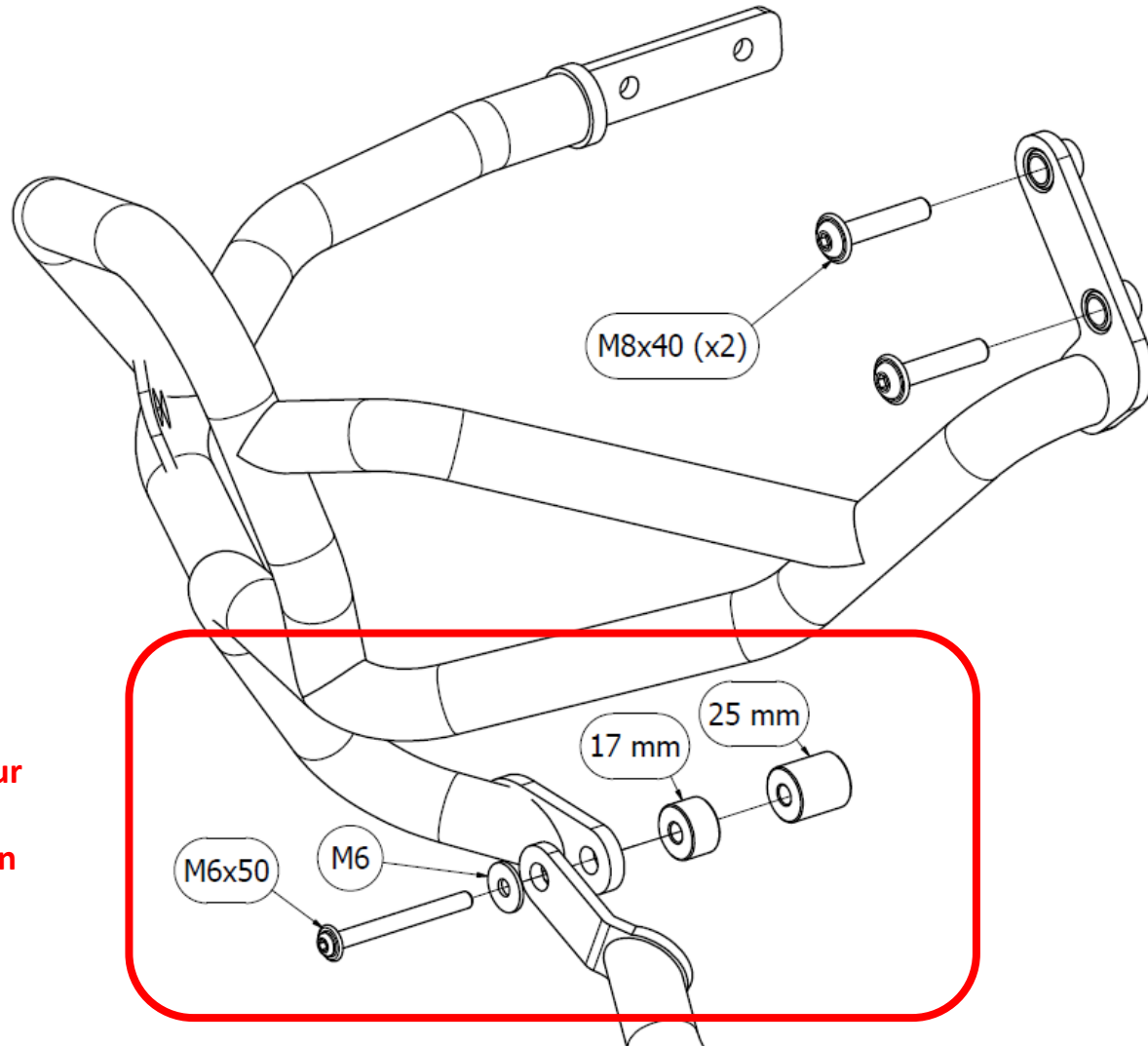

**This marked area has four variants of assembly. All of them will be shown on the next page.**



**Left side of the Garda Pro and Low crash bars with original skid plate**

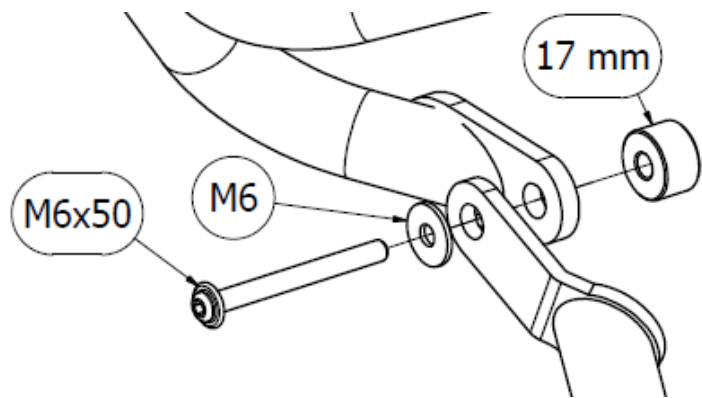

**Left side of the Garda Pro and Low crash bars with Garda skid plate**

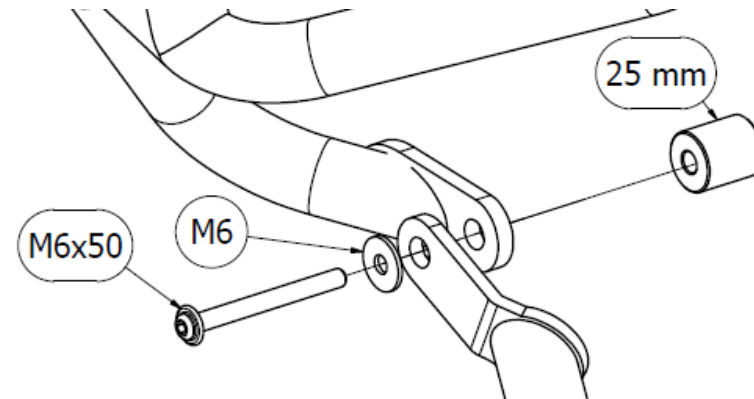

**Left side of the Garda Pro crash bar with original skid plate**

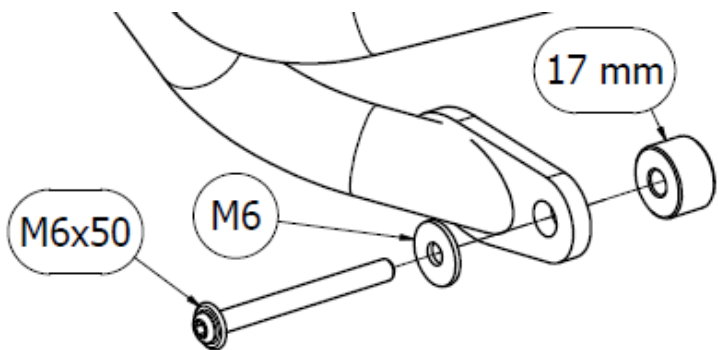

**Left side of the Garda Pro crash bar with Garda skid plate**

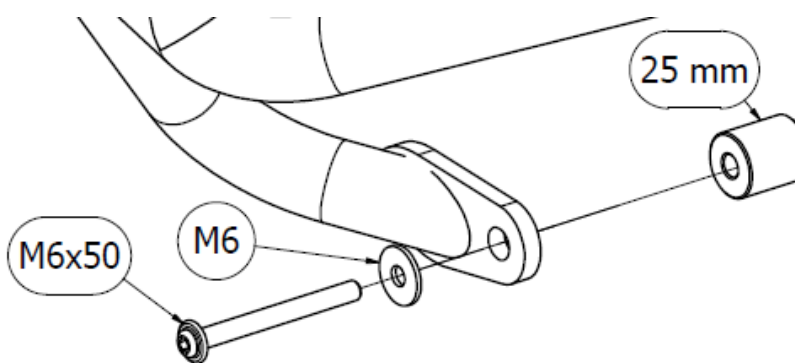



## FINAL MOUNTING

3. Screw the top mounting points of both crash bars together according to the diagram below

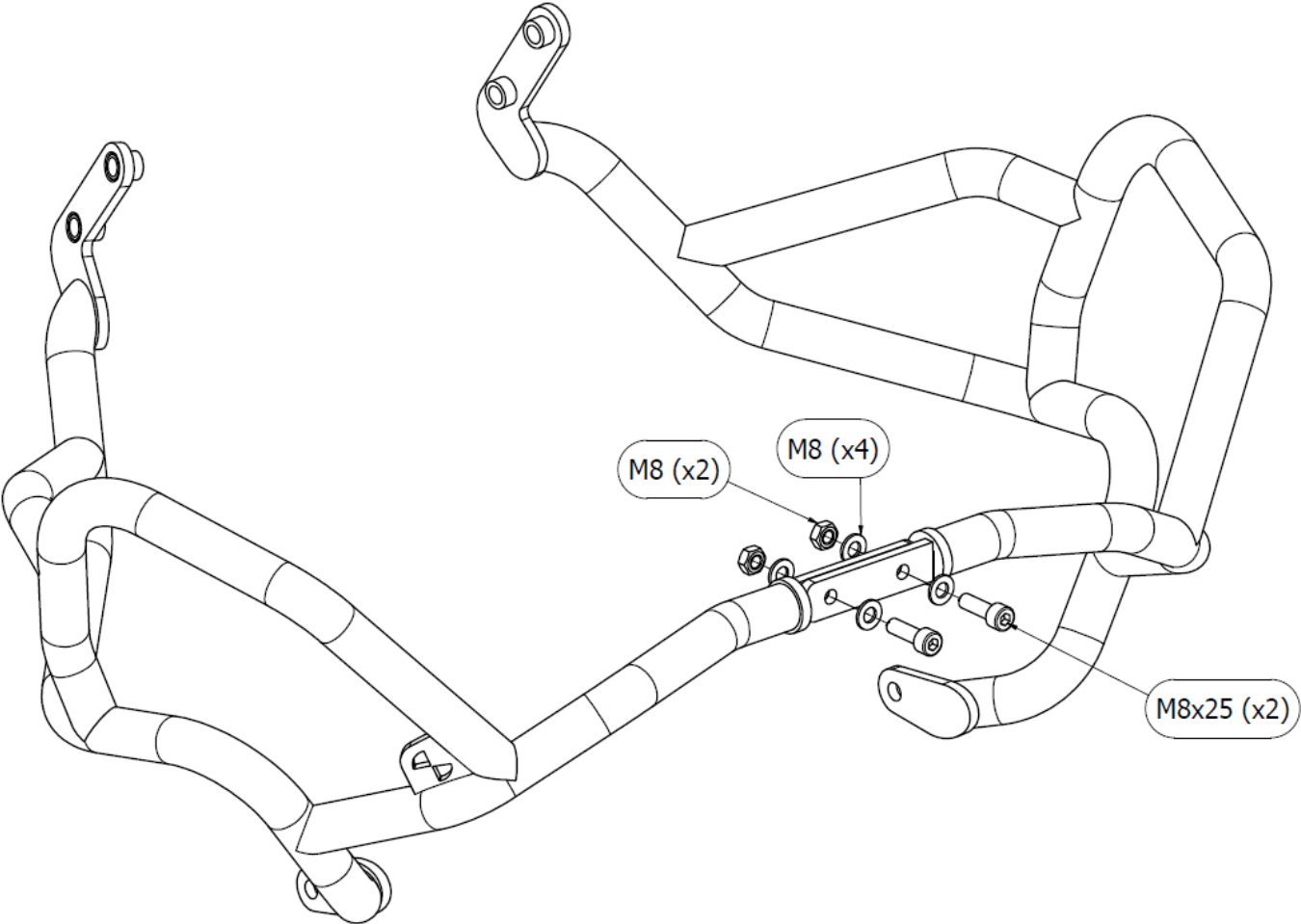

4. Tighten all the bolts in the crash bar.

Bolt tightening torque values: M6 – 10Nm, M8 – 24Nm, M10 – 38 Nm, M12 – 58 Nm