

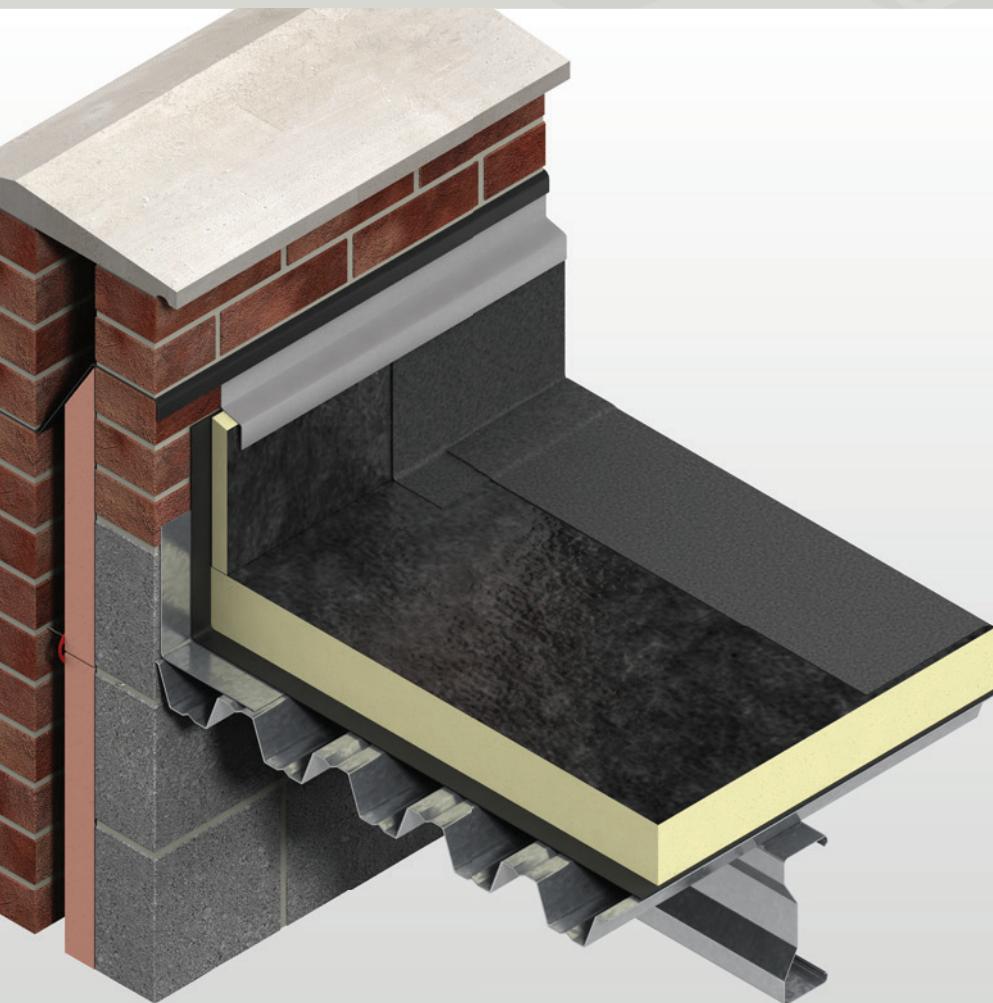

Thermarroof® TR24

INSULATION FOR FLAT ROOFS WATERPROOFED WITH PARTIALLY BONDED TORCH APPLIED MULTI-LAYER BITUMINOUS WATERPROOFING



- High performance rigid thermoset insulation – thermal conductivity 0.024 – 0.026 W/m·K
- Compatible with majority of torch applied waterproofing systems
- Resistant to the passage of water vapour
- Easy to handle and install
- Ideal for new build and refurbishment
- Non-deleterious material
- Manufactured with a blowing agent that has zero ODP and low GWP

Fibre-free
Core

Kingspan®

*Low Energy –
Low Carbon Buildings*

Typical Constructions and U-values

Assumptions

The U-values in the tables that follow have been calculated, under a management system certified to the BBA Scheme for Assessing the Competency of Persons to Undertake U-value and Condensation Risk Calculations, using the method detailed in BS EN ISO 6946: 2017 / I.S. EN ISO 6946: 2007 (Building components and building elements. Thermal resistance and thermal transmittance. Calculation methods), and using the conventions set out in BR 443 (Conventions for U-value calculations). They are valid for the constructions shown in the details immediately above each table.



These examples are based on **Kingspan Thermaroof® TR24**, waterproofed using partially bonded torch applied multi-layer bituminous waterproofing. The insulation board is fully bonded to a sealed metal deck, or a vapour control layer, which has itself been fully bonded to the type of deck stated for each application. The ceiling, where applicable, is taken to be a 3 mm skim coated 12.5 mm plasterboard with a cavity between it and the underside of the deck.

NB For the purposes of these calculations the standard of workmanship has been assumed good and therefore the correction factor for air gaps has been ignored.

NB The figures quoted are for guidance only. A detailed U-value calculation together with condensation risk analysis should be completed for each individual project.

NB If your construction is different from those specified and / or to gain a comprehensive U-value calculation along with a condensation risk analysis for your project please consult the Kingspan Insulation Technical Service Department for assistance (see rear cover).

U-value Table Key

Where an **X** is shown, the U-value is higher than the worst of the maximum new build area weighted average U-values allowed by the:

- 2013 editions of Approved Documents L to the Building Regulations for England;
- 2014 editions of Approved Documents L to the Building Regulations for Wales; and
- 2015 editions of Technical Handbooks Section 6 to the Building Standards for Scotland.

Concrete Deck

Dense Concrete Deck with Suspended Ceiling

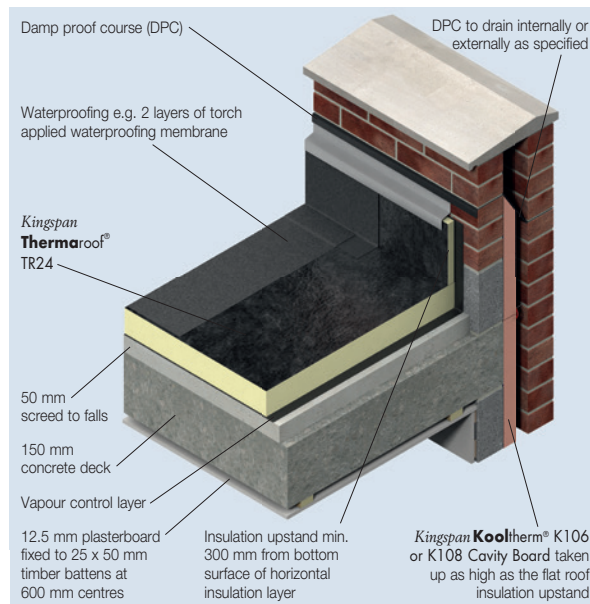

Figure 1

Packer Board* Thickness (mm)	Product Thickness of Kingspan Thermaroof® TR24	U-value (W/m²·K)
0	80	X
0	100	0.22
0	120	0.18
0	130	0.17
0	140	0.16
0	150	0.15
80	80	0.14
90	100	0.12
100	120	0.10

* The packer board is taken to be Kingspan Thermaroof® TR27 LPC/FM. Please refer to the relevant Kingspan Insulation literature for details of this product.

NB Refer to local distributor or Kingspan Insulation price list for current stock and non-stock sizes. Please contact sales@kingspaninsulation.co.uk for lead times as these may vary dependent on current stock profile.

Timber Deck

Timber Deck with Plasterboard Ceiling

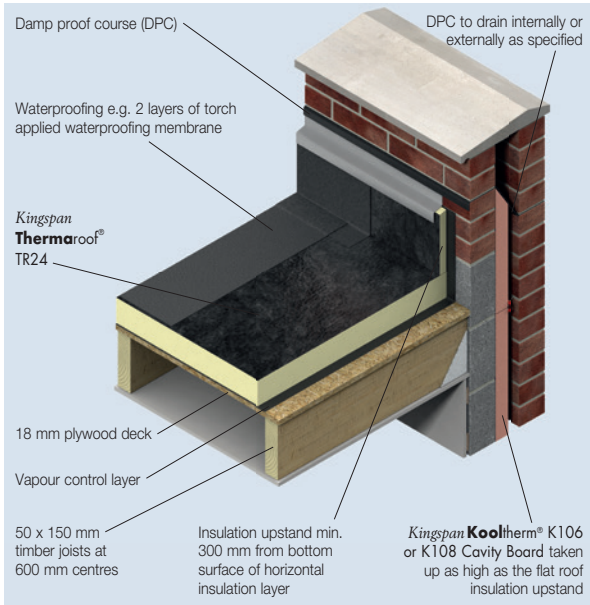

Figure 2

Packer Board* Thickness (mm)	Product Thickness of Kingspan Thermaroof® TR24	U-value (W/m ² ·K)
0	80	X
0	100	0.22
0	120	0.18
0	130	0.17
0	140	0.16
0	150	0.15
80	80	0.14
90	100	0.12
100	120	0.10

* The packer board is taken to be Kingspan Thermaroof® TR27 LPC/FM. Please refer to the relevant Kingspan Insulation literature for details of this product.

NB Refer to local distributor or Kingspan Insulation price list for current stock and non-stock sizes. Please contact sales@kingspaninsulation.co.uk for lead times as these may vary dependent on current stock profile.

Metal Deck

Metal Deck with No Ceiling

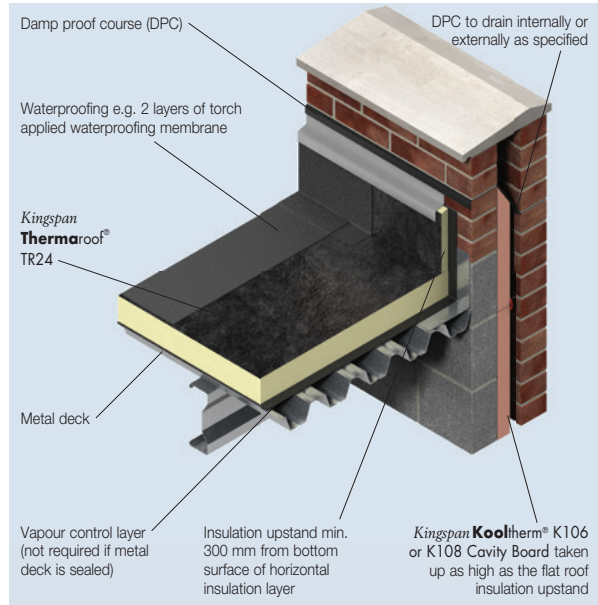

Figure 3

Packer Board* Thickness (mm)	Product Thickness of Kingspan Thermaroof® TR24	U-value (W/m ² ·K)
0	80	X
0	100	0.24
0	120	0.20
0	130	0.18
0	140	0.17
0	150	0.16
80	80	0.15
100	100	0.12
110	120	0.10

* The packer board is taken to be Kingspan Thermaroof® TR27 LPC/FM. Please refer to the relevant Kingspan Insulation literature for details of this product.

NB Refer to local distributor or Kingspan Insulation price list for current stock and non-stock sizes. Please contact sales@kingspaninsulation.co.uk for lead times as these may vary dependent on current stock profile.

Design Considerations

Linear Thermal Bridging

Basic Principles

Linear thermal bridging describes the heat loss / gain that occurs at junctions between elements e.g. where an external wall meets the roof, or at junctions around openings in the building fabric where the thermal insulation layer is discontinuous e.g. sills, jambs and lintels.

Interruptions within the insulation layer by materials with poorer insulating properties can result in a thermal bridge, which in turn can lead to problems of condensation and mould growth, especially if there is a drop in surface temperature.

The heat flow at these junctions and opening locations, over and above that through the adjoining plane elements, is the linear thermal transmittance of the thermal bridge: measured in W/m-K; referred to as a 'psi-value'; and expressed as a 'ψ-value'.

The lower the ψ-value, the better the performance. ψ-values are taken into account in the calculation methodologies e.g. the Standard Assessment Procedure (SAP) that are used to assess the operational CO₂ emissions and, where applicable, the fabric energy efficiency of buildings.

ψ-values can comprise either, or a combination of, approved, calculated or assumed values.

Reducing Linear Thermal Bridging

Detailing at junctions to minimise the effects of thermal bridging and the associated risk of condensation or mould growth is important and there are some simple design considerations that can be adopted to help mitigate the risks and to reduce heat losses.

- Care is required to ensure continuation of insulation wherever possible between the wall and roof for best thermal performance. Where this is not possible, the roof and wall insulation should be overlapped and ideally, insulation material introduced between.
- Parapet detailing can represent a good, low heat loss approach, with insulation continuity maintained using an insulated upstand to reduce cold bridging. A minimum 30 mm thick **Kingspan Thermaroof® TR24** upstand should be used around the perimeter of the roof on the internal façade of parapets. The upstand should extend a minimum of 150 mm above the roof insulation and achieve a minimum distance of 300 mm between the top of the insulation upstand and the bottom of the horizontal roof insulation. Wall insulation should be carried up into parapets at least as high as the flat roof insulation upstand.
- Lightweight aggregate blockwork to the inner leaf of wall constructions can help to improve thermal performance at junctions generally and where used for the inner leaf of parapet walls it can help to reduce losses.
- Where a parapet construction is not used, to achieve best performance, the roof insulation should be carried over the wall plate to meet and extend past the wall insulation layer. For a timber warm roof construction, the first joist zone above the wall plate can be filled with insulation for best performance and to maintain thermal continuity.

- For best thermal performance, roof-lights and ventilator kerbs should be insulated with the same thickness of **Kingspan Thermaroof® TR24** as the general roof area.
- Where guttering is incorporated within a flat roof construction, this should be accounted for within the overall thermal design of the roof via an area-weighted calculation for the whole roof; the risk of localised interstitial condensation from reduced insulation provision at the gutter should be considered.

Environmental Impact & Responsible Sourcing

Green Guide Rating

An Ecoprofile, certified by BRE Certification to the 2008 BRE Environmental Profiles Methodology, has been created for **Kingspan Thermaroof® TR24** produced at Kingspan Insulation's British manufacturing facilities. The BRE has assigned the product a 2008 Green Guide Summary Rating of A.



Environmental Profiles Scheme
Certificate Number ENP 500

Responsible Sourcing

Kingspan Thermaroof® TR24 produced at Kingspan Insulation's Pembridge and Selby manufacturing facilities is certified to BES 6001 (Framework Standard for the Responsible Sourcing of Construction Products) 'Excellent'.



NB The above information is correct at the time of writing. Please confirm at the point of need by contacting Kingspan Insulation's Technical Service Department (see rear cover), from which copies of Kingspan Insulation's certificates can be obtained.

Sustainability & Responsibility

Kingspan Insulation has a long-term commitment to sustainability and responsibility: as a manufacturer and supplier of insulation products; as an employer; as a substantial landholder; and as a key member of its neighbouring communities.

A report covering the sustainability and responsibility of Kingspan Insulation Ltd's operations at its Pembridge, Herefordshire and Selby, North Yorkshire manufacturing facilities is available at www.kingspaninsulation.co.uk/sustainabilityandresponsibility.

Specification Clause

*Kingspan Therma*roof® TR24 should be described in specifications as:–

The roof insulation shall be *Kingspan Therma*roof® TR24 _____mm thick: comprising a high performance rigid thermoset insulation core faced with a bitumen coated glass tissue finished with a thermofusible polypropylene fleece on its upper surface and a mineralised glass tissue on its lower surface. The product shall be manufactured: with a blowing agent that has zero Ozone Depletion Potential (ODP) and low Global Warming Potential (GWP); in accordance with the requirements of BS 4841–3; under a management system certified to ISO 9001: 2008, ISO 14001: 2004, BS OHSAS 18001: 2007 and ISO 50001: 2011; by Kingspan Insulation Limited; and installed in accordance with the instructions issued by them.

NBS Specifications

Details also available in NBS Plus.

NBS users should refer to clause(s):
J41 420 (Standard and Intermediate)
J41 10 (Minor Works)



Wind Loadings

Wind loadings should be assessed in accordance with BS / I.S. EN 1991–1–4: 2005 + A1: 2010 (National Annex to Eurocode 1 Actions on Structures. General Actions. Wind Actions) taking into account:

- length / width / height of the building;
- orientation of the building;
- wind speed; aspect (e.g. on a hill side); and
- topographical value of the surrounding area.

Falls

The fall on a flat roof, constructed using *Kingspan Therma*roof® TR24, is normally provided by the supporting structure being directed towards the rainwater outlets. The fall should be smooth and steep enough to prevent the formation of rainwater pools. In order to ensure adequate drainage, BS 6229: 2003 (Flat roofs with continuously supported coverings. Code of practice) recommends uniform gradients of not less than 1 in 80. However, because of building settlement, it is advisable to design in even greater falls. These can be provided by a *Kingspan Therma*aper® tapered roofing system (see below).

Tapered Roofing

*Kingspan Therma*roof® TR24 is also available in a tapered version, *Kingspan Therma*aper® TT44, comprising a high performance fibre-free rigid thermoset insulation core, manufactured with a blowing agent that has zero Ozone Depletion Potential (ODP) and low Global Warming Potential (GWP), faced on the underside with a mineralised glass tissue autohesively bonded to the insulation core during manufacture. The top surface is finished with a bitumen coated glass tissue finished with a thermofusible polypropylene fleece. *Kingspan Therma*aper® TT44 comes with a supporting design service. This ensures that the most cost-effective solution for a roof is identified and that the end result is a tapered system design which meets a roof's rainwater run-off and insulation requirements. Further details of *Kingspan Therma*aper® TT44 are available from the Kingspan Insulation Tapered Roofing Department (see rear cover), which should be consulted as early as possible in the process of designing a roof.

Roof Waterproofing

*Kingspan Therma*roof® TR24 is designed for use in conjunction with most partially bonded torch applied multi-layer bituminous waterproofing. When applying waterproofing, torch with minimum heat at all times. Torch the roll of waterproofing felt using flame/edge guards at all times.

Do not directly apply the torch to the insulation facing. The waterproofing membrane should be installed in accordance with the membrane manufacturer's instruction. For further advice please contact the Kingspan Insulation Technical Service Department (see rear cover).

Water Vapour Control

*Kingspan Therma*roof® TR24 should be installed over a separate vapour control layer, in new build roofs, unless it is being used in conjunction with a sealed metal deck. Regardless of the deck type it is recommended that a condensation risk analysis is carried out for every project.

For refurbishment projects, involving the addition of insulation to existing insulated flat roofs, or roofs constructed of insulated steel faced composite panels, it is imperative that a U-value calculation and condensation risk analysis is carried out for every project, in order to ensure that the correct thickness of insulation is installed to achieve the required thermal performance, whilst avoiding interstitial condensation.

Design Considerations

In refurbishment projects, where *Kingspan Thermaroof*[®] TR24 is to be installed over an existing bituminous waterproofing membrane, the membrane can be used as a vapour control layer, as long as it is in a good water-tight condition. Where this is not the case, a separate vapour control layer should be installed.

The type of separate vapour control layer required will be dependent upon the chosen method of fixing the insulation boards.

For mechanically fixed applications, a minimum vapour control layer should consist of a 1000 gauge (250 micron) polythene sheet, with all joints lapped and then sealed with double-sided self adhesive tape.

For applications where the insulation boards are to be bonded to the vapour control layer, a minimum vapour control layer should consist of a coated roofing felt complying with Type 3B to BS EN 13707: 2013 (Flexible sheets for waterproofing. Reinforced bitumen sheets for roof waterproofing. Definitions and characteristics), or S1P1 to BS 8747: 2007 (Reinforced bitumen membranes (RBMs) for roofing. Guide to selection and specification), or any appropriate metal-cored vapour control layer.

Where the separate vapour control layer is to be bonded, allowance should be made for adequate bonding of the vapour control layer to the substrate, so as to provide a suitable surface upon which to lay the insulation boards and sufficient resistance to wind up-lift (see 'Wind Loading').

Roof Loading / Traffic

Kingspan Thermaroof[®] TR24 is suitable for use on access roof decks subject to limited foot traffic. Where inappropriate foot traffic is liable to occur, it is recommended that the roof surface is protected by promenade tiles. For further advice on the acceptability of specific foot traffic regimes, please contact the Kingspan Insulation Technical Service Department.

Spanning on Metal Decks

Insulation boards should comply with the minimum thicknesses shown in the table below, when used over metal decks with trough openings.

Trough Opening (mm)	Minimum Insulant Thickness (mm)
≤ 75	25
76–100	30
101–125	35
126–150	40
151–175	45
176–200	50
201–225	55
226–250	60

Sitework

Installing over Metal Decks

- Metal decks should be clean, dry, without large projections, steps or gaps, and should be graded to allow correct falls to all rainwater outlets.
- If using a sealed metal deck there is no requirement for a separate vapour control layer.
- If the metal deck is not sealed, and the insulation boards are to be bonded down, in order to ensure an adequate bond between the metal deck and the vapour control layer, the metal deck should be suitably primed, in accordance with the primer manufacturer's instructions, prior to the application of the hot bitumen, or suitable alternative proprietary adhesive system, used to bond the vapour control layer to the deck.
- If the metal deck is not sealed, and the insulation boards are to be mechanically fixed, the vapour control layer should be loose-laid.
- Where one run of the specified vapour control layer laps another, there should be minimum 150 mm side and end overlaps, which should be adequately sealed.
- Turn up the vapour control layer at the edge of the roof to a height appropriate to the specified waterproofing membrane.
- Boards of *Kingspan Thermaroof*[®] TR24 should be secured to the deck using mechanical fixings e.g. telescopic tube fasteners (see 'Mechanical Fixings').
- Alternatively, the insulation boards should be bonded down by laying into hot bitumen (max. temperature 240°C) mopped or poured over the vapour control layer / sealed metal deck, or with the use of a suitable alternative proprietary adhesive system.
- Insulation boards should always be laid break-bonded, either with their long edges at right angles to the trough openings, or diagonally across the corrugation line, and with joints lightly butted. There should be no gaps at abutments.
- Roof-light or ventilator kerbs etc. should always be insulated with the same thickness of *Kingspan Thermaroof*[®] TR24 as the roof area.
- A 30 mm thick *Kingspan Thermaroof*[®] TR24 upstand should be used around the perimeter of the roof on the internal façade of parapets.
- A minimum distance of 300 mm should be maintained between the top of the insulation upstand and the bottom of the horizontal roof insulation.
- The waterproofing membrane is installed in accordance with the membrane manufacturer's instructions, over the whole insulated area including any insulation upstands, as soon as possible after laying the insulation boards.

Installing over Concrete Decks

- Concrete decks should be clean, dry, without large projections, steps or gaps, and should be graded to allow correct falls to all rainwater outlets.
- If the insulation boards are to be bonded down, in order to ensure an adequate bond between the vapour control layer and the concrete deck, the concrete or screeded surface should be suitably primed, in accordance with the primer manufacturer's instructions, prior to the application of the hot bitumen, or suitable alternative proprietary adhesive system, used to bond the vapour control layer to the deck.
- If the insulation boards are to be mechanically fixed, the vapour control layer should be loose-laid.
- Where one run of the specified vapour control layer laps another, there should be minimum 150 mm side and end overlaps, which should be adequately sealed.
- Turn up the vapour control layer at the edge of the roof to a height appropriate to the specified waterproofing membrane.
- Boards of *Kingspan Thermaroof*[®] TR24 should be bonded down by laying into hot bitumen (max. temperature 240°C) mopped or poured over the vapour control layer, or with the use of a suitable alternative proprietary adhesive system.
- Alternatively, the insulation boards should be secured to the deck using mechanical fixings e.g. telescopic tube fasteners (see 'Mechanical Fixings').
- Insulation boards should always be laid break-bonded, either with their long edges at right angles to the edge of, or diagonally across the roof, and with joints lightly butted. There should be no gaps at abutments.
- Roof-light or ventilator kerbs etc. should always be insulated with the same thickness of *Kingspan Thermaroof*[®] TR24 as the general roof area.
- A 30 mm thick *Kingspan Thermaroof*[®] TR24 upstand should be used around the perimeter of the roof on the internal façade of parapets.
- A minimum distance of 300 mm should be maintained between the top of the insulation upstand and the bottom of the horizontal roof insulation.
- The waterproofing membrane is installed in accordance with the membrane manufacturer's instructions, over the whole insulated area including any insulation upstands, as soon as possible after laying the insulation boards.

Installing over Existing Flat Roofs

- The existing waterproofing membrane surface should be clean, dry, without large projections, steps or gaps, and should be graded to allow correct falls to all rainwater outlets.
- Where the existing waterproofing membrane is not fit for purpose as a vapour control layer, and the new insulation boards are to be bonded down, a separate vapour control layer should be bonded to it with hot bitumen, or suitable alternative proprietary adhesive system. If the insulation boards are to be mechanically fixed, the vapour control layer should be loose-laid.
- Where one run of the specified vapour control layer laps another, there should be minimum 150 mm side and end overlaps, which should be adequately sealed.
- Turn up the vapour control layer at the edge of the roof to a height appropriate to the specified new waterproofing membrane.
- Boards of *Kingspan Thermaroof*[®] TR24 should be bonded down by laying into hot bitumen (max. temperature 240°C) mopped or poured over the vapour control layer, or with the use of a suitable alternative proprietary adhesive system.
- Alternatively, the insulation boards should be secured to the deck using mechanical fixings e.g. telescopic tube fasteners (see 'Mechanical Fixings').
- Insulation boards should always be laid break-bonded, either with their long edges at right angles to the edge of, or diagonally across the roof, and with joints lightly butted. There should be no gaps at abutments.
- Roof-light or ventilator kerbs etc. should always be insulated with the same thickness of *Kingspan Thermaroof*[®] TR24 as the general roof area.
- A 30 mm thick *Kingspan Thermaroof*[®] TR24 upstand should be used around the perimeter of the roof on the internal façade of parapets.
- A minimum distance of 300 mm should be maintained between the top of the insulation upstand and the bottom of the horizontal roof insulation.
- The waterproofing membrane is installed in accordance with the membrane manufacturer's instructions, over the whole insulated area including any insulation upstands, as soon as possible after laying the insulation boards.

Sitework

Mechanical Fixings

- The number of mechanical fixings required to fix *Kingspan Thermaroof*® TR24 will vary with the geographical location of the building, the local topography, and the height and width of the roof concerned along with the deck type.
- A minimum of 4 fixings are required to secure 1.2 x 0.6 m boards of *Kingspan Thermaroof*® TR24 to the deck.
- The requirement for additional fixings should be assessed in accordance with BS / I.S. EN 1991–1.4: 2005 + A1: 2010 (National Annex to Eurocode 1. Actions on structures, General Actions, Wind Actions).
- Mechanical fixings must be arranged in an even pattern.
- Fasteners at insulation board edges must be located > 50 and < 150 mm from edges and corners of the board and not overlap board joints.
- Please refer to page 9 for recommended fixing patterns.
- Each fixing should incorporate a square or circular plate washer (min. 50 x 50 mm or 50 mm diameter).
- If two layers of insulation are to be installed, the base layer should be mechanically fixed with minimum 1 No. fixing in the centre of the insulation board before fixing the top layer as described above.
- Where alternative mechanical fixing systems are specified, such as bar fixing systems, the specified system must give similar restraint to the insulation board as would be attained by the use of conventional telescopic tube fasteners.

Installing in Two Layers

- In situations where two layers of insulation are required, both layers should be installed in the same manner, as detailed in the preceding sections. However, if mechanical fixing methods are to be employed, refer to 'Mechanical Fixings' for guidance on the number of fixings to be used in each layer.
- In all cases, the layers should be horizontally offset relative to each other so that, as far as possible, the board joints in the two adjacent layers do not coincide with each other (see Figure 4).

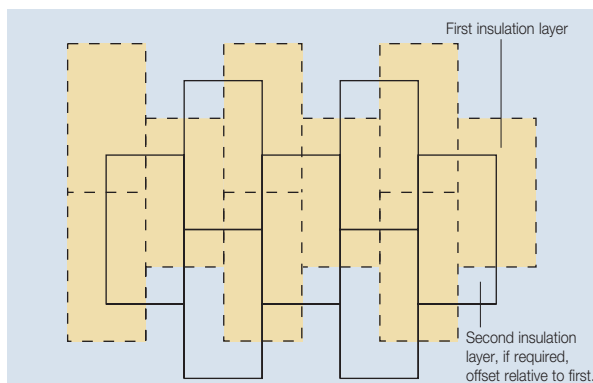

Figure 4

General

Following Trades

- The roof must be adequately protected when building works are being carried out on or over the roof surface. This is best achieved by close boarding. The completed roof must not be used for the direct storage of heavy building components such as bricks or air conditioning equipment.

Daily Working Practice

- At the completion of each day's work, or whenever work is interrupted for extended periods of time, a night joint must be made in order to prevent water penetration into the roof construction.

Cutting

- Cutting should be carried out either by using a fine toothed saw or by scoring with a sharp knife, snapping the board over a straight edge and then cutting the facing on the other side.
- Ensure accurate trimming to achieve close-butting joints and continuity of insulation.

Availability

- *Kingspan Thermaroof*® TR24 is available through specialist insulation distributors and selected roofing merchants throughout the UK.

Packaging and Storage

- The polyethylene polythene packaging of Kingspan Insulation products, which is recyclable, should not be considered adequate for outdoor protection.
- Ideally, boards should be stored inside a building. If, however, outside storage cannot be avoided, then the boards should be stacked clear of the ground and covered with an opaque polythene sheet or weatherproof tarpaulin. Boards that have been allowed to get wet should not be used.

Health and Safety

- Kingspan Insulation products are chemically inert and safe to use.
- A Safety Information Data Sheet for this product is available from the Kingspan Insulation website www.kingspaninsulation.co.uk/safety.

Warning – do not stand on or otherwise support your weight on this product unless it is fully supported by a load bearing surface.

Mechanical Fixing Patterns

Recommended Fixing Patterns

Alternatively, the insulation boards should be secured to the deck using mechanical fixings. The recommended fixing patterns for *Kingspan Thermaroof*[®] TR24 are shown below. The number of fixings necessary should also be assessed in accordance with BS / I.S. EN 1991-1.4: 2005 + A1: 2010 (National Annex to Eurocode 1. Actions on structures, General Actions, Wind Actions).

The images below show the minimum recommended fixing patterns, the number of fixings used and the resulting fixing density (number of fixings per m²).



4 No. per board
(1.2 x 0.6 m board – 5.55 fixings / m²)

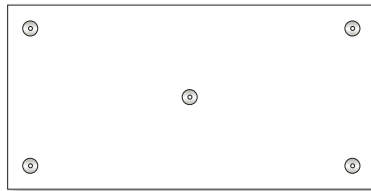

5 No. per board
(1.2 x 0.6 m board – 6.94 fixings / m²)

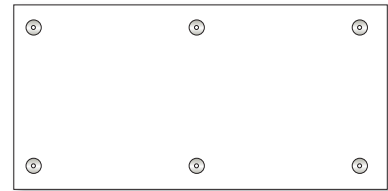

6 No. per board
(1.2 x 0.6 m board – 8.33 fixings / m²)

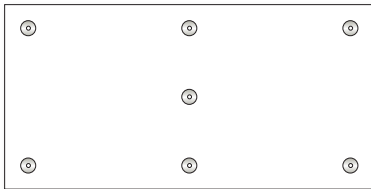

7 No. per board
(1.2 x 0.6 m board – 9.72 fixings / m²)

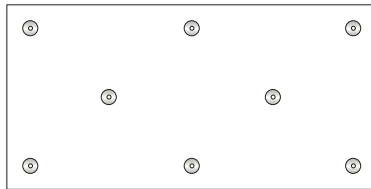

8 No. per board
(1.2 x 0.6 m board – 11.11 fixings / m²)

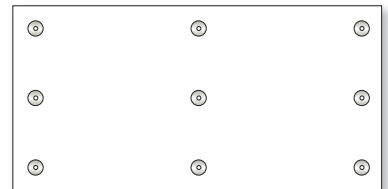

9 No. per board
(1.2 x 0.6 m board – 12.50 fixings / m²)

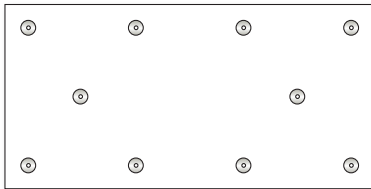

10 No. per board
(1.2 x 0.6 m board – 13.88 fixings / m²)

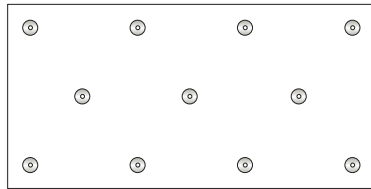

11 No. per board
(1.2 x 0.6 m board – 15.27 fixings / m²)

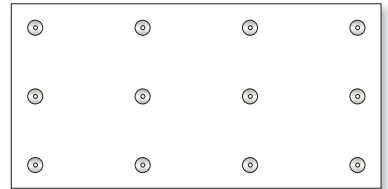

12 No. per board
(1.2 x 0.6 m board – 16.66 fixings / m²)

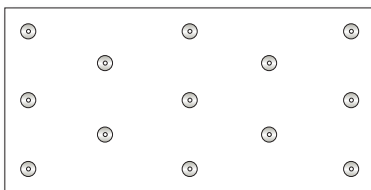

13 No. per board
(1.2 x 0.6 m board – 18.05 fixings / m²)

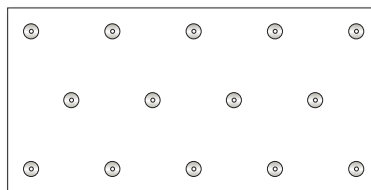

14 No. per board
(1.2 x 0.6 m board – 19.44 fixings / m²)

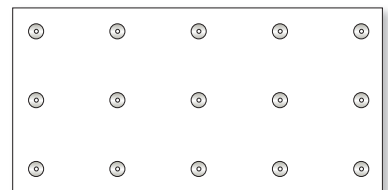

15 No. per board
(1.2 x 0.6 m board – 20.83 fixings / m²)

Product Details

The Upper Facing

The upper facing of *Kingspan Thermaroof*[®] TR24 is bitumen coated glass tissue finished with a thermofusible polypropylene fleece, autohesively bonded to the insulation core during manufacture.

The Core

The core of *Kingspan Thermaroof*[®] TR24 is manufactured with **Nilflam**[®] technology, a high performance fibre-free rigid thermoset polyisocyanurate (PIR) insulant manufactured with a blowing agent that has zero Ozone Depletion Potential (ODP) and low Global Warming Potential (GWP).



The Lower Facing

The lower facing of *Kingspan Thermaroof*[®] TR24 is a mineralised glass tissue autohesively bonded to the insulation core during manufacture.

Standards & Approvals

Kingspan Thermaroof[®] TR24 is manufactured to the highest standards under a management system certified to ISO 9001: 2008 (Quality Management Systems. Requirements), ISO 14001: 2004 (Environmental Management Systems. Requirements), BS OHSAS 18001: 2007 (Occupational Health and Safety Management Systems. Requirements) and ISO 50001: 2011 (Energy Management System. Requirements with Guidance for Use).

The use of *Kingspan Thermaroof*[®] TR24 is covered by LABC Registered Details Certificate No. EWS548E. An LABC Registered Detail can significantly reduce the time and costs associated with a construction project. Contact the Kingspan Insulation Technical Service Department for further information.



Standard Dimensions

Kingspan Thermaroof[®] TR24 is available in the following standard size:

Nominal Dimension	Availability
Length (m)	1.2
Width (m)	0.6
Insulant Thickness (mm)	Refer to local distributor or Kingspan Insulation price list for current stock and non-stock sizes

Compressive Strength

The compressive strength of *Kingspan Thermaroof*[®] TR24 typically exceeds 150 kPa at 10% compression, when tested to BS / I.S. EN 826: 2013 (Thermal insulating products for building applications. Determination of compression behaviour).

Water Vapour Resistivity

The product typically achieves a resistivity greater than 300 MN.s/g.m, when tested in accordance with BS EN 12086: 2013 (Thermal insulating products for building applications. Determination of water vapour transmission properties). *Kingspan Thermaroof*[®] TR24 should always be installed over a vapour control layer or sealed metal deck (see 'Water Vapour Control' on page 5).

Durability

If correctly installed, *Kingspan Thermaroof*[®] TR24 can have an indefinite life. Its durability depends on the supporting structure and the conditions of its use.

Resistance to Solvents, Fungi & Rodents

The insulation core is resistant to short-term contact with petrol and with most dilute acids, alkalis and mineral oils. However, it is recommended that any spills be cleaned off fully before the boards are installed. Ensure that safe methods of cleaning are used, as recommended by suppliers of the spilt liquid. The insulation core is not resistant to some solvent based adhesive systems, particularly those containing methyl ethyl ketone. Adhesives containing such solvents should not be used in association with this product. Damaged boards or boards that have been in contact with harsh solvents or acids should not be used.

The insulation core and facings used in the manufacture of *Kingspan Thermaroof*[®] TR24 resist attack by mould and microbial growth and do not provide any food value to vermin.

Fire Performance

*Kingspan Thermo*roof® TR24, when assessed to the British Standard fire test specified in the table below, can achieve the result shown, when waterproofed with 2 layer built-up felt and a loading coat of 12.5 mm chippings. For specifications without the chippings please consult the manufacturer of the mineral surfaced cap sheet for their fire classification details.

Test	Result
BS 476-3: 2004 (External fire exposure roof test)	FAA Rating

Further details on the fire performance of Kingspan Insulation products may be obtained from the Kingspan Insulation Technical Service Department (see rear cover).

Thermal Properties

The λ -values and R-values detailed below are quoted in accordance with BS EN 13165: 2012 + A2: 2016 (Thermal insulation products for buildings. Factory made rigid polyurethane foam (PU) products. Specification).

Thermal Conductivity

The boards achieve a thermal conductivity (λ -value) of:
 0.026 W/m·K (insulant thickness < 80mm)
 0.025 W/m·K (insulant thickness 80 – 119 mm)
 0.024 W/m·K (insulant thickness \geq 120 mm)

Thermal Resistance

Thermal resistance (R-value) varies with thickness and is calculated by dividing the thickness of the board (expressed in metres) by its thermal conductivity. The resulting number is rounded down to the nearest 0.05 (m²·K/W).

Product Thickness (mm)	Thermal Resistance (m ² ·K/W)
30	1.15
50	1.90
80	3.20
100	4.00
120	5.00
130	5.40
140	5.80
150	6.25

NB Refer to local distributor or Kingspan Insulation price list for current stock and non-stock sizes.

Insulation Product Benefits

Kingspan OPTIM-R® Vacuum Insulation Panel (VIP) Products

- With a declared value thermal conductivity of 0.007 W/m·K, these products provide an insulating performance that is up to five times better than commonly used insulation materials.
- Provides high levels of thermal efficiency with minimal thickness.
- Over 90% (by weight) recyclable.

Kingspan Kooltherm® Range Products

- With a thermal conductivity of 0.018–0.023 W/m·K these are the most thermally efficient insulation products commonly used.
- The thinnest commonly used insulation products for any specific U-value.
- Manufactured with a blowing agent that has zero Ozone Depletion Potential (ODP) and low Global Warming Potential (GWP).

Kingspan Thermo™ Range Products

- With a thermal conductivity of 0.022–0.028 W/m·K these are amongst the more thermally efficient insulation products commonly used.
- Manufactured with a blowing agent that has zero Ozone Depletion Potential (ODP) and low Global Warming Potential (GWP).

Kingspan Styrozone® Range Products

- Rigid extruded polystyrene insulation (XPS) has the necessary compressive strength to make it the product of choice for specialist applications such as heavy duty flooring, car park decks and inverted roofing.
- Manufactured with a blowing agent that has zero Ozone Depletion Potential (ODP).

All Products

- Unaffected by air infiltration – a problem that can be experienced with mineral fibre and which can reduce thermal performance.
- Safe and easy to install.
- If installed correctly, can provide reliable long term thermal performance over the lifetime of the building.
- Each product achieves the required fire performance for its intended application.

Contact Details

Customer Service

For quotations, order placement and details of despatches please contact the Kingspan Insulation Customer Service Department on the numbers below:

Tel: +44 (0) 1544 388 601
Fax: +44 (0) 1544 388 888
email: customerservice@kingspaninsulation.co.uk

Literature & Samples

Kingspan Insulation produces a comprehensive range of technical literature for specifiers, contractors, stockists and end users. The literature contains clear user friendly advice on typical design; design considerations; thermal properties; sitework and product data.

For copies please contact the Kingspan Insulation Marketing Department, or visit the Kingspan Insulation website, using the details below:

Tel: +44 (0) 1544 387 384
Fax: +44 (0) 1544 387 484
email: literature@kingspaninsulation.co.uk
www.kingspaninsulation.co.uk/literature

Tapered Roofing

For technical guidance, quotations, order placement and details of despatches please contact the Kingspan Insulation Tapered Roofing Department on the numbers below:

Tel: +44 (0) 1544 387 383
Fax: +44 (0) 1544 387 483
email: tapered@kingspaninsulation.co.uk

Technical Advice / Design

Kingspan Insulation supports all of its products with a comprehensive Technical Advisory Service. Calculations can be carried out to provide U-values, condensation / dew point risk, required insulation thicknesses etc...

U-value calculations can also be carried out on the Kingspan Insulation U-value Calculator, available for free online at www.uvalue-calculator.co.uk or downloaded as an App.



The Kingspan Insulation Technical Service Department can also give general application advice and advice on design detailing and fixing etc... Site surveys are also undertaken as appropriate.

The Kingspan Insulation British Technical Service Department operates under a management system certified to the BBA Scheme for Assessing the Competency of Persons to Undertake U-value and Condensation Risk Calculations.



Please contact the Kingspan Insulation Technical Service Department on the numbers below:

Tel: +44 (0) 1544 387 382
Fax: +44 (0) 1544 387 482
email: technical@kingspaninsulation.co.uk

General Enquiries

For all other enquiries contact Kingspan Insulation on the numbers below:

Tel: +44 (0) 1544 388 601
Fax: +44 (0) 1544 388 888
email: info@kingspaninsulation.co.uk

Kingspan Insulation Ltd. reserves the right to amend product specifications without prior notice. Product thicknesses shown in this document should not be taken as being available ex-stock and reference should be made to the current Kingspan Insulation price-list or advice sought from Kingspan Insulation's Customer Service Department (see above left). The information, technical details and fixing instructions etc. included in this literature are given in good faith and apply to uses described. Recommendations for use should be verified for suitability and compliance with actual requirements, specifications and any applicable laws and regulations. For other applications or conditions of use, Kingspan Insulation offers a Technical Advisory Service (see above), the advice of which should be sought for uses of Kingspan Insulation products that are not specifically described herein. Please check that your copy of this literature is current by contacting the Kingspan Insulation Marketing Department (see left).



Kingspan Insulation Ltd
Pembridge, Leominster, Herefordshire HR6 9LA, UK
www.kingspaninsulation.co.uk