

Roofing installation guide

Box Profile 34/1000

Before you get started

Working out the sheets, flashings, fixing screws and fillers that are needed for a job can be difficult. If you let us know the details of your roof we can help you figure out what you need and ensure that you place the right order. Remember that sheets and flashings are often fabricated to order and it could be 1 to 2 weeks before you take receipt of your order. Make sure your plans allow for a suitable lead time prior to delivery.

UK law requires employers and self-employed contractors to formally assess the risks associated with each roofing job and, before starting their work, to plan and organise their work so that it is carried out in a safe manner. Further information on this and working at heights, other applicable legislative requirements can be found by visiting the Health and Safety Executive's website www.hse.gov.uk. Receipt of goods sheets and flashings are bundled together and shipped in packs that are heavy and awkward to handle making delivery worth the extra expense. Upon receipt of your order, check that it's correct and consistent with the accompanying delivery note. Any issues should be reported to us immediately by phoning our **Customer Service Team** on **01837 659901**. Two people may be able to lift a single sheet at a time off a delivery truck, depending on their own physical ability and weather conditions. This will also depend on the length of sheet and weight. The weight of sheets are given on the website. Extra care should be taken in windy or exposed areas. The edges of sheets and flashings can be sharp so remember to wear protective gloves with rubber palms for grip.

For your safety

Roofing work can be hazardous. Caution should be exercised and appropriate safety precautions taken including the wearing of suitable protective gloves, clothing, footwear and hard hat.

Care should be taken when handling sheets to prevent damage and injury during installation. If possible, mechanical handling equipment should be used. Dragging one sheet's edge across another when unloading may cause scratching of the sheet below, so make sure the sheet is lifted clear and not dragged. Any packaging should be removed before lifting sheets onto a roof.

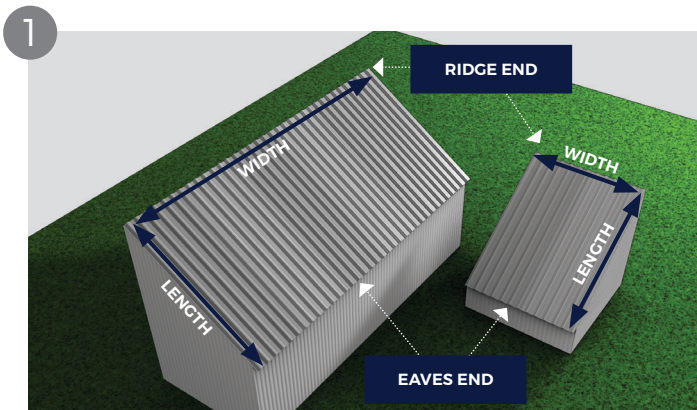

A single slope roof sometimes referred to as mono pitch or lean to roof. When working out your sheeting requirements, we require the length and width as shown in the diagram for us to be able to help you with a quotation. A width measurement is used to calculate the number of sheets required. The length measurement is used to calculate the length of sheets required.

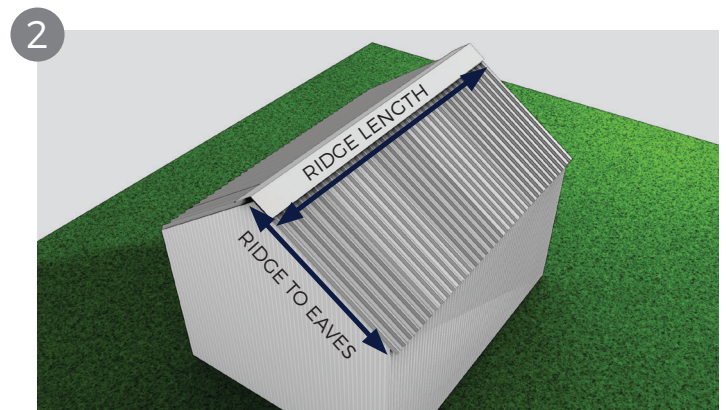

Apex roofs are separated by a central ridge. As per the diagram we require the length of sheet from ridge to eaves and the ridge length to calculate your requirements. You will need to measure both sides of the roof as the building/roof can vary in size from side to side. If the apex is uneven ridge to eaves will need to be taken on both sides.

TOP TIP

When measuring your roof always measure in more than one place to ensure your roof is square. If you find you have different measurements always order your sheets to the longest length.



Order online at www.cladco.co.uk
Call us on 01837 659901

Please always consult a professional before installing Cladco products

CLADCO
ROOFING

3

-- SEQUENCES HAVE BEEN SPEEDED UP -- VISUAL GUIDE ONLY --



The minimum pitch needed for box profile sheet is 4 degrees. If in doubt consult an engineer. The purlin spaces on average should be a maximum of 1.2m apart, however if using 0.5mm for the roof (which is normally used for side sheeting) you would need to reduce purlin spaces to no more than 1m apart. Please note, these are recommended spacings but always seek advise from a structural engineer before installing.

4

-- SEQUENCES HAVE BEEN SPEEDED UP -- VISUAL GUIDE ONLY --



When installing the box profile sheeting you may wish to lay the sheets on the roof before fixing to ensure the overlap is sufficient. Sheets should be overlapped by a minimum of one box profile when laid side by side. Colour caps can be used to cover the silver screw head and matched to the roofing sheet colour.

5



When fixing your box profile sheeting it's imperative they are fixed at the valley point, we recommend using TF32-S19 screws which are self drilling and self sealing. Please see image above.

6



TOP TIP Do not over-tighten or under-tighten your screws as this can affect the performance of the washer and prevent it from sealing correctly. See diagram above.

7

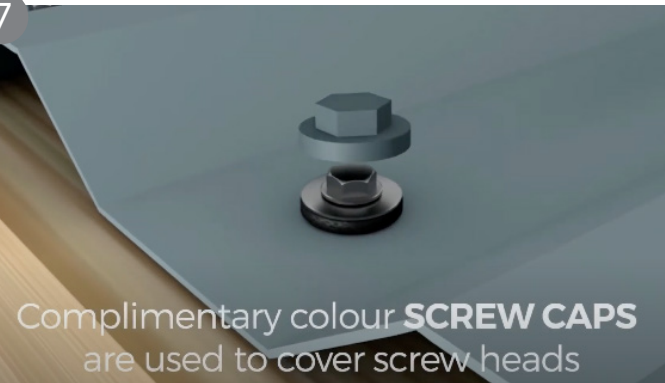

Colour caps can be used to match or contrast with the roof sheeting you are using. Its an effective way of hiding the silver screws from view.

8

-- SEQUENCES HAVE BEEN SPEEDED UP -- VISUAL GUIDE ONLY --



Once you have installed the final sheet you can use Cladco flashings for the sides and apex. Barges are used on the edges to help seal the building and provide an aesthetically pleasing affect. Please note when joining / laying these there is a minimum overlap of 200mm on barges. Our 22mm stitcher screws are advised for securing flashings in place.



Order online at www.cladco.co.uk
Call us on 01837 659901

Please always consult a professional before installing Cladco products

CLADCO
ROOFING



Ridge Flashings are used for the ridge on an Apex roof, where as for a single slope roof you may need to use a custom flashing. To fit the ridge use stitcher screws into the flashing and onto the sheets. Lay ridge caps from the opposite end of the roof to the direction of prevailing winds. Each ridge should be overlapped by a minimum of 200mm.

We usually recommend ridge caps are fixed using selfdrilling TEK type stitching screws to the high point of each profile they cover and through the appropriate ridge filler if one is being used. This helps ensure a weather resistant seal, to prevent birds and vermin as well as water from entering the building. Ridge and Barge flashings can be made to match your Cladco roofing sheets.

Commerical Building and two sheet runs



On a two sheet run remember to have a purlin under the overlap as shown. These are guides and it depends on your roof construction and pitch. If in doubt consult an engineer. Purlin Spaces using 0.7mm thickness sheet should be approximately 1.2m apart. Purlin spaces using 0.5mm thickness sheet should be approximately 1m apart. The minimum pitch needed for box profile sheet is 4 degrees.

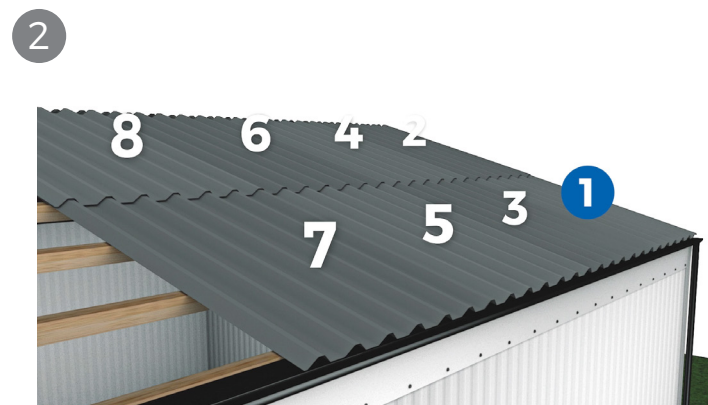

For a two sheet run, sheets should be laid in a particular order to the prevailing wins. Start at the eaves and in the corner away from the direction of the prevailing wind (this will help to prevent side laps facing into the wind and water ingress). If the first sheet is not laid perpendicular to the eaves and ridge, adjustments will have to be regularly made when laying other sheets and a 'saw tooth' effect at the eaves will be seen.



Custom flashings can be made for projects to match the steel sheeting we offer. Flashings can provide weatherproofing to the building particularly at the ridge where two sheets meet.



Sheets must be overlapped by a minimum of 250mm where the two sheets meet. Roof lights can be installed between the sheets but must have sheets either side for support. Sheets should overlap side by side by at least one profile.



Order online at www.cladco.co.uk
Call us on 01837 659901

Please always consult a professional before installing Cladco products

CLADCO
ROOFING

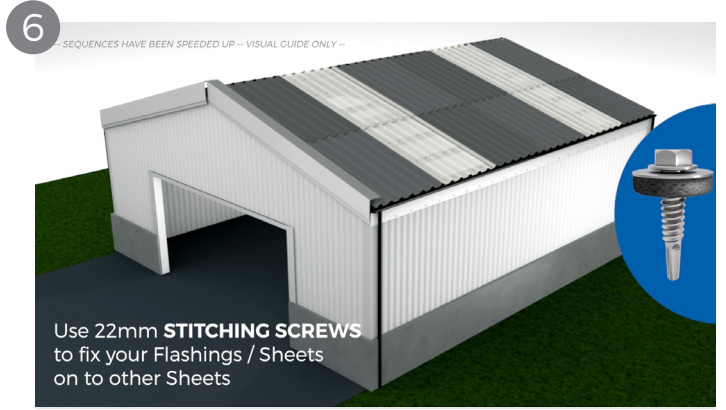

Sheets should be overlapped by the next sheet in the run by at least one profile or corrugation ('side laps'). Adjacent runs of sheets should overlap each other by at least 250mm ('end laps'). Please note, we can only supply a maximum of 9m. If you require a longer length, its recommended to do a two sheet run.

Barge flashings can be used to seal and finish off the ends of your roofing project. Flashings can ensure the building is watertight and prevent birds and water from entering the building. It is good practice to use mastic lapping tape and stitching screws to ensure a robust weather resistant joint on side laps.



Stitcher screws are recommended to secure flashings. Screws should be no more than 400mm apart when securing the flashing. Colour caps can be used to conceal the top of the screw head.

Fillers can help ensure a robust weather resistant seal, to prevent birds and vermin as well as water from entering the building. An eaves filler strip is designed to go under a sheet, while an opposite ridge filler strip is designed to go over a sheet. All foam filler strips should be bonded to the pans or valleys of the sheeting with a flexible, waterproof silicone sealant and should be continuous over the entire width of the sheeting.

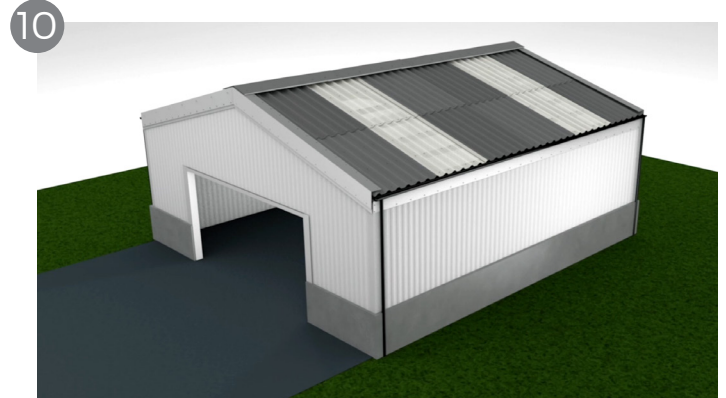

Rooflights can be added to a project to increase the natural light coming into a building. Rooflights have a translucent rate of 80% and can be used between roofing sheets. Please note roofing sheets must be supported either with steel sheets and appropriate purlin supports.

Finish your project by installing the ridge flashing along the centre where two sheets meet. You can then install guttering or fascia as required.

TOP TIP Clean the roof of any debris whilst fixing the sheets down. This will prevent it from burning through the coating on the sheet



Order online at www.cladco.co.uk
Call us on 01837 659901

Please always consult a professional before installing Cladco products

CLADCO
ROOFING