

RESTRAINING A BOWED SOLID WALL USING HEAVY DUTY LATERAL RESTRAINT TIES HDS INTO THE SIDE OF UNBOARDED ROOF SPACE JOISTS

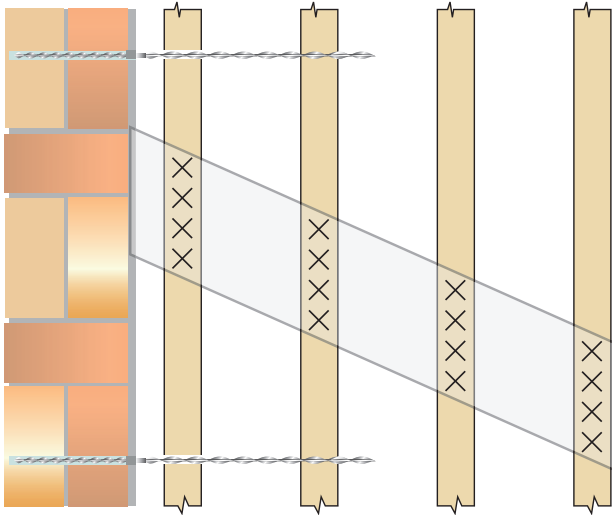

Recommended Tooling

- ▣ For drilling and insertion of Lateral Restraint Ties: SDS rotary hammer drill 650 / 700w.
- ▣ For installation of Lateral Restraint Ties: Lateral Restraint Tie HD driver.
- ▣ For injection of StrucSol Resin: Applicator gun.
- ▣ For Injection of the StrucSol Crack Filler: A 400ml Mastic Gun is required.
- ▣ PPE Clothing and Protection.

General Notes

If you require specific advice on your project, please call the StrucSol technical help line 0116 2375082. We can supply a full support service which includes:

- ▣ Advice and assistance on all structural matters.
- ▣ Preparing repair proposals for specific projects.

Method Statement:

1. Position the softwood brace as shown, to link at least four ceiling joists.
2. Use a minimum of 2 screw fixings per joist to secure the bracing.
3. Mark the positions for the Lateral Restraint Tie clearance holes on the external wall.
4. Drill a 12mm diameter clearance hole through the masonry to line up with the joist in the middle third of the timber away from the edges.
5. Clean out the hole to clear any dust or debris.
6. Fit the driver into an SDS hammer drill, set to rotary only. Insert the Lateral Restraint Tie into the driver.
7. Drive the Lateral Restraint Ties into and through the timber joists until you hit the shoulder of the Lateral Restraint Tie Power Support Tool. Ensuring that you have gone through at least 2 joists.
8. Inject StrucSol Resin into the hole, filling it completely to the face of the outer leaf masonry.
9. Allow the resin to gel (normally 15 to 20 minutes).
10. Make good all the holes at the surface using StrucSol TE resin or StrucSol Crack Filler and leave ready for decoration. To achieve a near perfect look, use StrucSol Stain Colour Matching mortar.
11. Clean the tools and brickwork with a suitable polyester resin cleaner.

▣ Ensure ceiling void is free of pipes and cables.

SPECIFICATION NOTES

The following criteria are to be used unless specified otherwise.

- | | |
|----------|--|
| A | Lateral Restraint Tie HD penetration into the side grain of the last timber joist MUST be a minimum of 75mm or the tie should be driven through the joist. |
| B | The maximum horizontal spacing between Lateral Restraint Ties is 600mm. |
| C | Typical bracing to be 25mm x 150mm softwood. |
| D | Bracing to be used at 1.2m horizontal spacing. |

The above specification notes are for general guidance only and StrucSol reserve the right to amend as necessary.

JT Consulting, Unit 5Q, Sibley Road Industrial Estate, Barrow Upon Soar, LE12 8LP
 Tel 0116 2375082, Email: sales@strucsol.com, www.strucsol.co.uk
 Company Reg 09707405 V.A.T Reg. GB230398223