

## RECONNECTING A CRACKED INTERNAL WALL TO AN EXTERNAL CAVITY WALL USING GROUT TIES

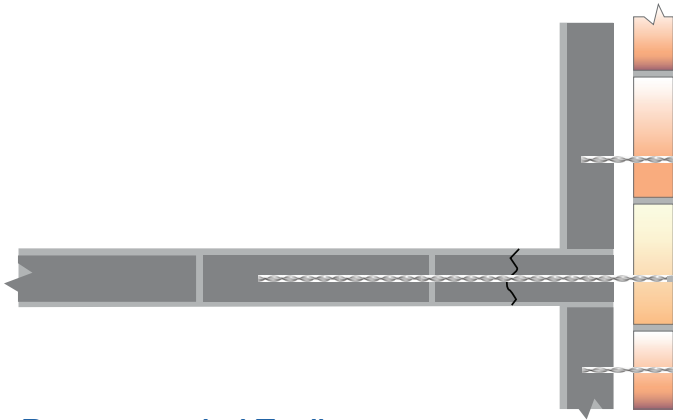

### Recommended Tooling

- ▣ For drilling: SDS rotary hammer drill 650 / 700w.
- ▣ For mixing StrucSol HSGrout: SDS Rotary percussion 3-jaw chuck drill with mixing paddle.
- ▣ For insertion of Grout Ties: Grout Tie Pointing Gun + Grout Tie Pinning Nozzle.
- ▣ For Injection of the StrucSol Crack Filler: A 400ml Mastic Gun is required.
- ▣ PPE Clothing and Protection.

### General Notes

If you require specific advice on your project, please call the StrucSol technical help line 0116 2375082. We can supply a full support service which includes:

- ▣ Advice and assistance on all structural matters.
- ▣ Preparing repair proposals for specific projects.

### Method Statement:

1. Remedial Wall Ties should be fitted first, as shown on method statement SWM06
2. Mark the positions for the holes on the outer face of the wall.
3. Drill a 16mm clearance hole at the required location through the outer wall to the required depth.
4. Clean out all dust from the holes and slots and thoroughly flush with water. Ensure the holes and slots are damp prior to commencing step 8.
5. Attach the required length of the Grout Tie Pinning Nozzle to the gun.
6. Mix StrucSol HSGrout using a power mixer and load into the Grout Tie Pointing Gun.
7. Pump grout to fill the nozzle.
8. Wind the Grout Tie into the nozzle and ensure that it is fully covered in grout.
9. Make good all the holes at the surface and cracks using StrucSol TE resin or StrucSol Crack Filler and leave ready for decoration. To achieve a near perfect look, use StrucSol Stain Colour Matching mortar.
10. Make good all holes at the surface with matching mortar or leave ready for any decoration.
11. Tie inner and outer leaves together using appropriate StrucSol Wall Ties.
- 12 Clean tools with clean, fresh water.

- ▣ *Making good the holes and pointing of the slots may be carried out as soon as is convenient.*

### SPECIFICATION NOTES

The following criteria are to be used unless specified otherwise.

<b>A</b>	Grout Ties are to be installed at a vertical spacing of 450mm.
<b>B</b>	Grout Ties are to extend at least 500mm past the crack.
<b>C</b>	Depth of hole to be Grout Tie length +25mm.
<b>D</b>	Grout Ties are to be installed within the centre third of the wall.
<b>E</b>	Grout Ties should not extend back into the outer leaf as they will be covered in grout and could form a cavity bridge.
<b>F</b>	Wall Ties to be installed at 225mm vertical spacing, 225mm back from the junction, and staggered on alternate sides of the junction.
<b>G</b>	In hot conditions, ensure the masonry is well wetted or primed to prevent premature curing of the StrucSol HSGrout due to rapid de-watering
<b>H</b>	Do not use StrucSol HSGrout when the air temperature is 4°C and falling, or apply over ice. In all instances, the hole MUST be thoroughly damp or primed prior to injection of the StrucSol HSGrout.

The above specification notes are for general guidance only and StrucSol reserve the right to amend as necessary.

JT Consulting, Unit 5Q, Sibley Road Industrial Estate, Barrow Upon Soar, LE12 8LP  
 Tel 0116 2375082, Email: sales@strucsol.com, www.strucsol.co.uk  
 Company Reg 09707405 V.A.T Reg. GB230398223

Please always wear the appropriate safety and protective clothing when installing fixing and anchor products. Always observe the necessary Health & Safety guidelines.

© All text copyright. Above information is given as guidance only and should always be verified by a suitable engineer.  
 The above information is given in good faith, and may be subject to alteration at any time without prior notification.