

aLLreLi M5 Wireless Microphone



USER MANUAL

Product Introduction

Thank you for choosing our M5 wireless lavalier microphone. This guide will help you get started and make the most of your new microphone for activities like live streaming, vlogging, interviews, and more.

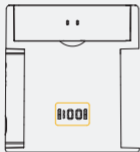

Magnetic Charging station



Microphone



1 x USB C Receiver
1 x Lightning Receiver

What's in the Box?

- 2 x lavalier microphone
- 1 x USB-C Receiver
- 1 x Lightning Receiver (for older iPhone & iPad models like iPhone 14, 13, 12)
- 1 x Magnetic Charging Station
- 1 x Charging Cable
- Manual

Getting Started

1. Set Up: Remove the microphone and your choice of receiver from the charging station.

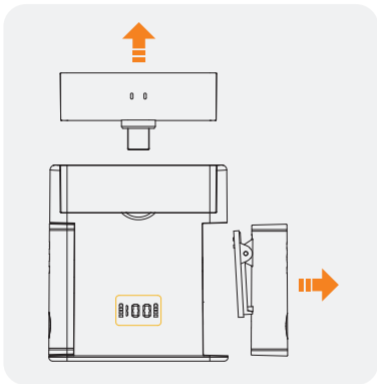

Note

1. Lightning receiver is for Previous iPhone models e.g. iPhone 14 13 12.
2. It does not work if you insert the usb c receiver and the lightning receiver to 2 phone at the same time. The microphones will pair one receiver at single use. If you would like to switch the receiver, simply put the other receiver back the charging station

Getting Started

2. Connect:

Plug the receiver into your phone, tablet, or laptop. A steady green light on both devices indicates a successful connection.

Normally, the microphone will turn on automatically when you take it out of the charging station (you will see a green light on the microphone). If not, press and hold the multifunction button on the microphone for 5 seconds to turn it on manually.

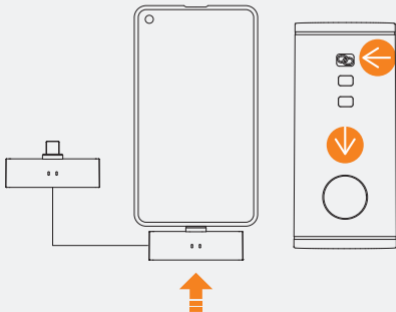

Microphone - Button



Turn On/Off -

Press and hold the multifunction button on the microphone to turn it on or off.

Noise reduction -

Press the multifunction button once to activate.

Reverb (Echo) -



Press the multifunction button twice quickly.

multifunction button

Microphone - Lights & Indicator

Lights & Indicators

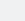
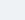
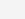

-  Pairing: Slowly flashing blue light.
-  Paired: Steady blue light.
-  Charging: Steady green light.
-  Fully Charged: Light off
-  Low Battery: Red light.

 Noise Reduction On: Steady blue light.

 Reverb On: Steady blue light.

Receiver - Volume Adjustment



Volume Adjustment

Increase/Decrease Volume: Tap the volume button. The cycle repeats.



Microphone volume indicator light

80% •

90% ••

100% •••

Receiver- indicator light



Paired

Steady Blue light
paired

Pairing:

Slowly flashing blue light.

Charging station

Digital display screen

 Microphone charging indicator

 Charging station charging indicator



Charging port

Using Your Microphone

Live Streaming: You can charge your phone through the receiver while streaming.

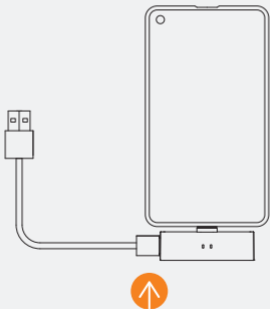

Troubleshooting

1. Why can't I record normally after connecting to my phone?

*If you encounter issues, check the connection lights and battery level first. Some devices may require enabling OTG settings or updating the phone software.

*Some Android phones may need to update their software. Go to **Settings > My Device > Version > Check for updates**.

*Certain Android phones require the OTG function to be enabled, along with external recording devices:

*Step 1: Enable the OTG function. Navigate to Settings > Other Settings > OTG. Toggle OTG to 'On' or use the search box in the settings to find and enable OTG.

*Step 2: Enable the external device. Go to Settings > Sound and Vibration > More Sound Settings > Default Recording Device > External Device.

2. Why doesn't the microphone record with the device's camera app?

Some mobile phone brands impose strict system restrictions that prevent the microphone from obtaining audio permissions. This issue is not related to the microphone's quality. If this occurs, please contact the phone's manufacturer.

This product works with most apps available on the market. Try using an alternative app if you encounter issues.

3. Is there noise in the recorded sound?

Check if the microphone is in noise reduction mode (the second indicator light should be continuously on). Press the multifunction button to activate noise reduction.

Troubleshooting

4. Is the recorded sound too low?

Try positioning the microphone closer to the sound source to prevent sound distortion.

Increase the volume by pressing the volume button on the receiver.

5. What should I do if there is wind noise?

If your model came with a windshield, please attach it to the microphone to reduce wind noise.

6. What should I do if the connected phone has low battery during recording?

Connect the charging cable to the port on the receiver to charge your phone.

7. What should I do if there is an echo?

Check if the reverb function is activated (indicated by a light on the microphone). To disable reverb, double-click the multifunction button.

8. What should I do if there is an echo during the live broadcast?

Turn off the sound on your phone during the live broadcast to prevent echoes. Phones in the same space should be muted to avoid this issue.

Attention:

Product details and manual may be updated periodically. This manual is a guide and does not constitute a warranty.

Real-time updated online electronic manual: <https://e.allreli.com/m5>

Technical Specifications

Wireless transmission: 2.4GHz

Sound delay:<20ms

Frequency response: 20Hz-20KHz

Sensitivity: -35dB

Signal to noise ratio: -65dB

Transmission distance: 20 meters (turning) -40 meters (visible)

Microphone: 360 degree omnidirectional

Range: Microphone: 7H

Paired with charging compartment: 15H

Battery capacity: Microphone: 80mAh

Charging compartment: 240mAh

Input voltage: DC4.5-5.2V

Adapter: 5V/1A

Weight: Microphone: 8 grams

Receiver: 6g

Charging Station: 32g

Size: Microphone: 40*18.2*11mm

Receiver: 47*14.8*7.6mm

Charging Station: 60*54*18.5mm

Safety Precautions

1. Avoid contact with magnets and keep away from water and high temperatures.
2. Use only in environments between -10°C and 45°C.
3. Do not disassemble or expose the product to mechanical shocks.
4. Use only the provided charging equipment to avoid hazards.

Maintenance

Store the microphone in a dry place.

Do not leave the battery fully discharged for long periods.

Quick Support:

Whatsapp: +1 (917) 7656278

Email: support@allreli.com

