



Disc Golf Smart Tag

USER GUIDE

Please read carefully the important safety information and user guide before starting to use the GameProofer™ Disc Golf Smart Tag.

DISCLAIMER

Information in this document is believed to be accurate as of the date of publication and is subject to change without notice.

This document and the information contained herein do not represent either a commitment or any guarantee on the part of GameProofer regarding the reliability, fitness, or compatibility of the products and procedures described.

While every reasonable effort is made to ensure the accuracy and completeness of this document, GameProofer assumes no responsibility or liability for any damages that may be directly or indirectly attributed to the use of the information contained within or to any errors or omissions.

No part of this document may be reproduced or transmitted in any form or by any means—electronic or mechanical, including photocopying and recording—for any purpose without the expressed consent of GameProofer.

Copyright © GameProofer 2024



Manufacturer
GameProofer Oy
Visiokatu 4
33720 TAMPERE
Finland

Business ID: FI32812775
Email: info@gameproofer.com

<https://www.gameproofer.com/>
<https://shop.gameproofer.com/>

Table of Contents

SAFETY REQUIREMENTS	3
REGULATORY INFORMATION MENTIONS RÉGLEMENTAIRES	7
PRODUCT INFORMATION INFORMATIONS SUR LE PRODUIT	7
EUROPEAN UNION	7
UNITED STATES OF AMERICA	8
CANADA.....	8
INTRODUCTION	9
BEFORE THE USE	10
HOW TO MOUNT THE TAG ON THE DISC	10
GETTING STARTED	11
CLEANING, MAINTENANCE, AND STORAGE	11
GAMEPROOFER™ APPLICATION	12
INSTALLATION OF THE GAMEPROOFER™ APPLICATION	12
LAUNCH THE GAMEPROOFER™ APP AND REGISTER THE USER ACCOUNT.....	12
PAIR DEVICES	14
YOUR LATEST CHUCKS	15
<i>Throw modes</i>	15
YOUR PROFILE.....	16
YOUR DISCS.....	16

Safety Requirements



DANGER

Failure to comply with the safety warnings and regulations could result in serious injury or death.

The Disc Golf Smart Tag is intended to be used as a training tool, attached to a disc golf disc.

Use the device at your own risk. Manufacturer cannot be held liable for any accidents, injuries, or illnesses that may occur.

The smart tag is delivered with a magnet.

Keep the magnet away from credit cards, implanted medical devices, and other devices that may be affected by magnets. Keep the magnet more than 15cm away from the medical devices. Stop using the smart tag if you suspect that the magnet needed to start the smart tag is interfering with your medical device and contact your doctor or medical device manufacturer immediately.

Do not use damaged power cords or plugs, or poorly attached sockets

Unprotected connections may result in electric shock or fire.

Do not touch the smart tag, wireless charging base, electrical cords, plugs, or wall outlets with wet hands or other wet body parts

Otherwise, electric shock may follow.

Do not pull the power cord too hard when unplugging it

Otherwise, electric shock or fire may result.

Do not fold or damage the power cord

Otherwise, electric shock or fire may result.

Do not use the smart tag with wet hands while the device is charging

Otherwise, electric shock may follow.

Do not use the smart tag outdoors during a thunderstorm

Failure to do so may result in electric shock or damage to the smart tag.

Using charger(s)

- The use of wrong type of chargers can shorten the life of the device or cause the device to malfunction. They can also cause a fire or battery to explode.
- Use only a wireless charger and cable specially designed for charging mobile devices. An incompatible charger or cable can cause serious personal injury or damage to the smart tag.

Protect your smart tag from falls and hard impacts

- A fall or hard impact can damage the smart tag or its battery, malfunction, or shorten its lifespan.
- In addition, overheating, fire or other dangerous situations may follow. Handle and dispose of smart tags and chargers with care.
- Never dispose of a battery or smart tag by burning. Never place a battery or smart tag on or inside heating devices such as microwaves, ovens, or radiators. The smart tag battery may overheat and explode. When disposing of a battery or smart tag, follow all applicable local regulations.
- Never crush or pierce a smart tag.
- Avoid exposing the smart tag to high external pressure, which can lead to internal short circuit and overheating.

Protects smart tag, battery and charger from damage

- Avoid exposing the smart tag and battery pack to extremely cold or hot temperatures.
- Exposure to extremes temperatures can damage the smart tag, reduce its battery capacity, and shorten its lifespan.
- Do not use a cable with loose or damaged insulation, and do not use a charger or battery that is damaged or defective.

Do not store the smart tag near or inside heaters, microwave ovens, hot cooking utensils, or pressure vessels

- The battery may leak.
- The smart tag can overheat and cause a fire.

When using a wireless charger, do not place any extra material, such as metal objects, magnets, or magnetic cards, between the smart tag and the wireless charger

This can prevent the smart tag from charging properly or cause it to overheat

Do not eat, bite or suck the smart tag

- Otherwise, the smart tag may malfunction or explode, or an explosion or fire may occur.
- Children or animals may choke on small parts.
- If children use a smart tag, make sure they use it appropriately.

Do not insert the smart tag or any part of it into your eyes, ears, mouth, or other body openings

Failure to do so may result in suffocation or serious injury.

Do not handle a damaged or leaking lithium battery

To ensure safe disposal of the lithium battery, contact the smart tag vendor or manufacturer.

Use the device shall only be used for its intended purpose.



WARNING

Failure to comply with the safety warnings and regulations could result in injury or material damage.

Do not use the smart tag for anything other than its intended purpose

The smart tag may fail

Do not use the smart tag near other electrical devices

Most electrical appliances use radio frequency signals. Your smart tag can interfere with other electronic devices.

Do not touch the smart tag if it is hot. Otherwise, your skin may experience mild burns, redness or pigmentation

- Be careful not to overheat the smart tag during a long period of use, and avoid prolonged skin contact with the device.
- Do not sit on the smart tag or touch it with exposed skin for a long time while it is charging or plugged into a power source.
- The heat tolerance of different individuals is different. Particular monitoring of the use of smart tags by children, the elderly and people living in specialized institutions

Do not use the smart tag in hospitals, airplanes, or vehicles that may be disturbed by radio frequency signals

- Use the smart tag only at a distance of more than 15cm from the pacemaker, as the smart tag can interfere with the pacemaker.
- Minimize potential pacemaker interference by using a smart tag on the opposite side of the pacemaker on the body.
- If you are using a medical device, ask the manufacturer of that device before using this device whether radio frequency signals emitted by the smart tag affect that device.
- The use of electronic devices on board an aircraft may interfere with the electronic navigation equipment of the aircraft. Follow airline rules and staff instructions.
- Electronic equipment in the car may malfunction due to radio interference generated by this device. Contact the manufacturer for more information.

Do not expose the smart tag to heavy smoke or steams

Otherwise, the outer surface of the smart tag may be damaged or the smart tag may malfunction.

If you are wearing a hearing aid, ask the manufacturer about radio frequency interference

Radio frequency signals emitted by this smart tag may interfere with the operation of some hearing aids. Before using the smart tag, ask the hearing aid manufacturer if the radio frequency signals emitted by the smart tag affect the hearing aid.

Do not use the smart tag near sound systems, radio masts, or other devices that transmit radio signals

Radio frequencies can cause the smart tag to malfunction.

If any part of the smart tag is broken, smoke or emits a burnt odor, stop using the smart tag immediately and contact the smart tag vendor or manufacturer

If the smart tag smokes or emits a burnt odor, the result may be an explosion or fire in the battery.

Regulatory information | Mentions réglementaires

Product information | Informations sur le produit



GameProofer Smart Tag

- Product Type: Disc Golf Smart Tag
- Model name: DGT4G
- FCC ID: 2BE7W-DGT4G
- IC: 32115-DGT4G
- Brand: GameProofer
- Wireless Protocol: Bluetooth Low Energy
- Operating frequency: 2,4MHz
- Max. output power: 4dBm
- Battery: 80mAh LiPo battery
- Operating Temperature: -10°C ... +40°C / +14°F ... +104°F
Battery Charging only above +0°C / 32°F
- Ingress Rate: IP67 (dust and waterproof)
- Dimensions: diameter: 39mm/1.53in | thickness: 6,9mm / 0.27in
weight: 9g/0.32oz

European Union

2014/53/EU

Hereby GameProofer Oy declares that the radio equipment in GameProofer Tag is in compliance with Radio Equipment Directive (RED) 2014/53/EU.

2014/30/EU

In order to satisfy the essential requirements of Electromagnetic Compatibility Directive 2014/30/EU, the product is compliant with the following standards:

- ETSI EN 300 328 V2.2.2 (2019-07)
- ETSI EN 303 413 V1.2.1 (2021-04)
- ETSI EN 301 489-1 V2.2.3 (2019-11)
- ETSI EN 301 489-17 V3.2.6 (2023-06)
- ETSI EN 301 489-19 V2.2.1 (2022-09)
- EN IEC 62368-1:2021
- EN IEC 62311:2020

2011/65/EU



This product is compliant with the Directive 2011/65/EU: Restriction of the use of certain Hazardous Substances in electrical and electronic equipment (RoHS). Please dispose used electrical and electronic equipment (WEEE) according to national laws and regulations with electrical waste. It should not be mixed with general household waste.

United States of America

Changes or modifications made to this equipment not expressly approved by GameProofer Oy may void the FCC authorization to operate this equipment.

FCC Regulatory Information

This device (FCC ID: 2BE7W-DGT4G) complies with Part 15 of the FCC Rules. Operation is subject to the following two conditions: (1) this device may not cause harmful interference, and (2) this device must accept any interference received, including interference that may cause undesired operation.

Canada

Innovation, Science and Economic Development Canada (ISED) regulatory information | Avis de conformité aux normes d'Innovation, Sciences et Développement économique Canada (ISED)

NOTICE:

This device complies with license-exempt transmitter(s)/receiver(s) that comply with Innovation, Science and Economic Development Canada's licence-exempt RSS standard(s).

Operation is subject to the following two conditions:

- (1) this device may not cause harmful interference, and
- (2) this device must accept any interference received, including interference that may cause undesired operation.

L'émetteur/récepteur exempt de licence contenu dans le présent appareil est conforme aux CNR d'Innovation, Sciences et Développement économique Canada applicables aux appareils radio exempts de licence.

L'exploitation est autorisée aux deux conditions suivantes:

- (1) l'appareil ne doit pas produire de brouillage, et
- (2) l'appareil doit accepter tout brouillage radioélectrique subi, même si le brouillage est susceptible d'en compromettre le fonctionnement

Introduction

Are you ready to take your disc golf game to unprecedented heights? Prepare to experience a groundbreaking evolution in the world of disc golf with **GameProofer™** – the ultimate game-changer that's set to redefine how you play, practice, and excel on the course.

GameProofer™ isn't just another ordinary accessory – it's a game-enhancing marvel designed to unlock the full potential of every throw. Imagine attaching a sleek, state-of-the-art smart tag to your disc and instantly immersing yourself in a realm of precise performance metrics and invaluable insights. With the **GameProofer™** mobile application at your fingertips, you'll embark on a journey of discovery, fine-tuning every aspect of your game with unprecedented accuracy and efficiency.

Say goodbye to guesswork and hello to precision. With **GameProofer™**, you'll gain access to a comprehensive array of real-time measurements, including speed, arm speed, wobble, spin, and much more. Whether you're honing your skills in the comfort of your backyard net or perfecting your technique on the practice field, **GameProofer™** empowers you to elevate your game like never before.

But that's just the beginning. With built-in GPS functionality, **GameProofer™** ensures that you'll never lose track of your discs again. Effortlessly locate your errant throws with pinpoint accuracy, saving time and frustration while maximizing your time on the course.

Crafted by Finnish experts in collaboration with passionate disc golfers, **GameProofer™** represents the pinnacle of innovation and performance. Immerse yourself in a world where cutting-edge hardware and software converge to deliver unparalleled insights and actionable data, all geared towards helping you unleash your full potential on the course.

Embrace a new era of disc golfing excellence with **GameProofer™**. From analyzing your drive to perfecting your upshots, hyzers, rollers, and beyond, **GameProofer™** empowers you to achieve new heights of success with every throw. Discover your strengths, identify your areas for improvement, and embark on a journey towards mastery with **GameProofer™** by your side.

Thank you for joining the revolution of the disc golf – one throw at a time.

GameProofer™ - Meet Your Skills -

Before the use

General

Check that the smart tag is intact when taken out of the box and has no external cracks or dents. Shake the smart tag. No sounds should be heard from the smart tag. If you notice any of the above on the smart tag, please take a photo and/or video and send it to us at feedback@gameproofer.com.

Smart tag can be used both indoors and outdoors. The tag is water and dust resistant so it can be used even if it rains. When throwing a disc with smart tag outdoors, make sure that the disc does not hit solid structures when thrown. Sharp hits on metal poles, rocks, walls, etc. may damage the tag and cause it to detach from the disc.

Smart tag and disc combination

Check that the smart tag is securely attached to the disc. You can grab the smart tag and see if it moves. A properly attached smart tag does not move and does not rattle when the puck is moved.

Smart tag only

Follow the instructions to attach the smart tag that carefully. By following the instructions, the smart tag attaches to the disc properly and does not detach easily. Do not use your own cleaning products to clean the disc or your own tapes to attach the smart tag.

NOTE! The mounting adhesive requires 24h to reach 90% bonding strength, so do not use the smart tag prior to that. 100% strength is achieved after 72h, but it's safe to start using the device after 24h.

How to mount the tag on the disc

Step by step mounting ([view also the video in GameProofer's Youtube channel](#)):

1. Use some kind of knife to remove the left-over plastic in the middle of the disc, which might have been left from the injection molding process.
2. Use the piece of sandpaper to smoothen the surface of the disc underneath the tag placement. Make sure that the potentially "oily" surface is removed.
3. Clean the surface with the alcohol wet wipe (delivered in the package).
4. Use the applicator and ballpen (or similar), and draw the lines to mark the center of the disc.
5. Remove the tape cover from the tag and put it aside.
6. Align the middle hole of the applicator with the center marking.
7. Hold the edges of the applicator steadily in place and remove the center part of the applicator by utilizing for example scissors.
8. While holding the applicator in place, install the tag inside of the hole.
9. Press and hold the tag in place for minimum of 15s.
10. Let it dry for minimum of 24h to achieve proper bonding strength with the adhesive. The adhesive will reach 100% strength in 72h, but it's safe to start using it after 24h.

Getting started

1. Charge the smart tag before use



Please note that center point of charging in the smart tag is not exactly in the middle of the tag, but at the point of the marking on left hand side picture. This is the point, where the center of the wireless charge should be aligned with.

Wireless charging supports the most common Qi compatible mobile phone chargers. Smart watch chargers are typically not working as the charging coil is too small.

NOTE: Do not use wireless charges which has magnets on them, e.g. Apple MagSafe or similar. This due the fact that the Smart tag is turned ON and rebooted by hovering a magnet on top of it. If the wireless charge has a magnet, it will cause the smart tag to go into a “rebooting loop”.

2. Download the GameProofer™ mobile application from Google Play Store (Android) or App Store (iOS).

NOTE: The application needs first two permissions to work properly:

- Nearby device should be set to “Allowed”
- The location should be set at least to “Allow only during use”
- It is also highly recommended to allow “Notifications” for Find-My-Disc info

3. GameProofer™ smart tag is turned ON by hovering the magnet on top of the tag.
4. Pair the device in the GameProofer™ Mobile Application and follow the instructions of the app. More detailed instructions about using the app are further down in this document.
5. When you have stopped throwing, the smart tag should be turned OFF from the application.

Cleaning, maintenance, and storage

Clean the tag from dirt, dust, and other contaminants after each use. Wipe the smart tag with a damp of cloth (do not use detergents or solvents) and dry it well.

If the smart tag gets wet, dry it with a towel. Prolonged exposure to water and/or moisture may damage the tag, or cause it to malfunction.

Store the device in dry and cool place. Do not store it near magnets or magnetic fields. The smart tag may malfunction or the battery may be discharged.

GameProofer™ Application

Installation of the GameProofer™ application

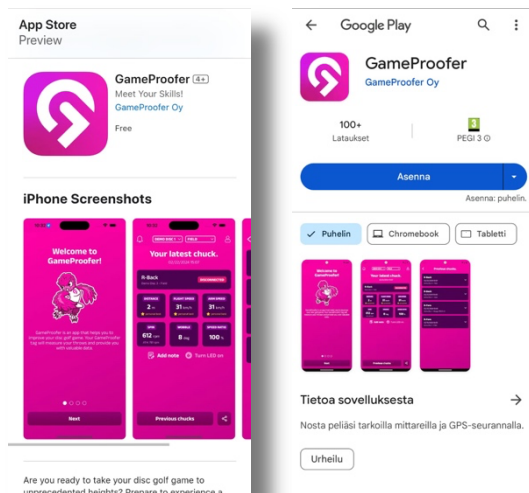

Download and install the application from the App Store for iOS devices and from Google Play Store for Android devices.

Launch the GameProofer™ app and register the user account

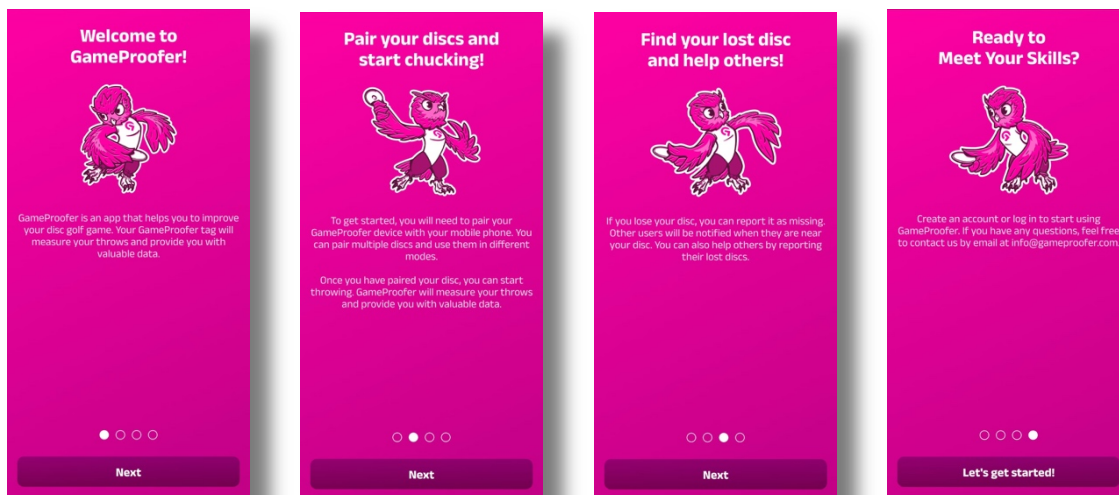

Introductions of the app, which appears only when launching the application for the first time

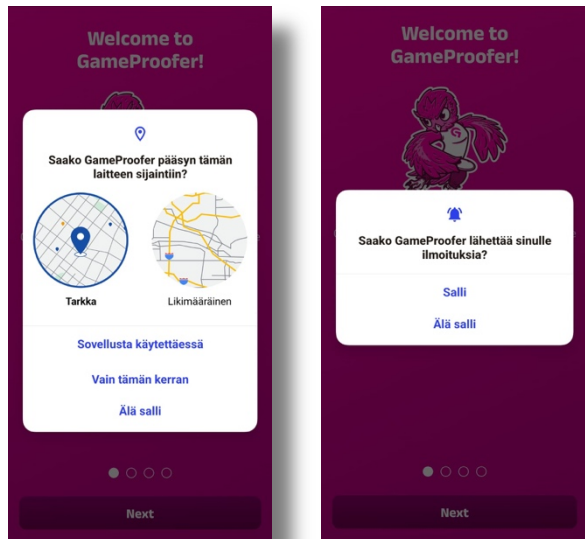

Upon the first launch of the application, it will request certain permissions on your mobile device.

Pictures from the application (in Finnish).

Grant permission for Location data, as well as for Nearby Devices which is requested a bit later. It is also highly recommended to accept “Notifications”, which are used to for example alert users about lost discs nearby (Find-My-Disc function).

In the “Create an account” section, enter a valid email address and password with at least eight (8) characters, including at least one number and one special character.

In the “Verify your account”, check your inbox for an email “GameProofer account verification” from noreply@gameproofer.com. It includes an eight-digit verification code which you must enter in the app to verify your user account.

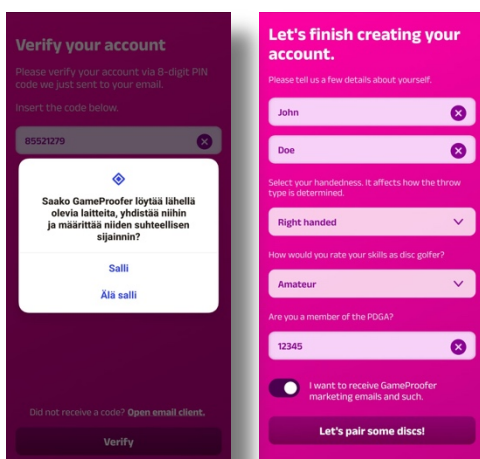
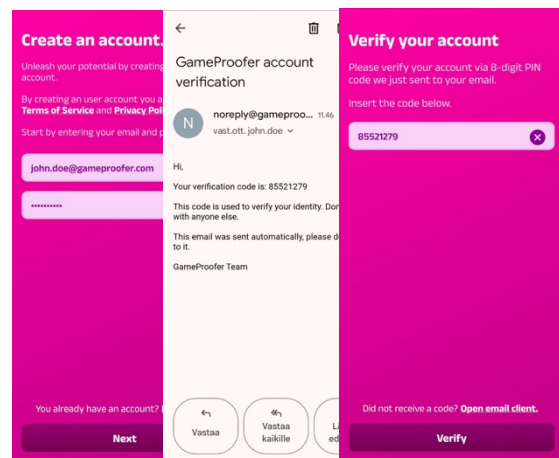

After you verify the account, the app will request to discover nearby devices, connect to them, and determine relative location. Using the app will require granting permission.

In the “Let’s finish creating your account”, fill in the requested information, such as name, handedness, skill level, and PDGA number (if you have one), and then press “Let’s pair some discs!” button to continue.

Pair devices

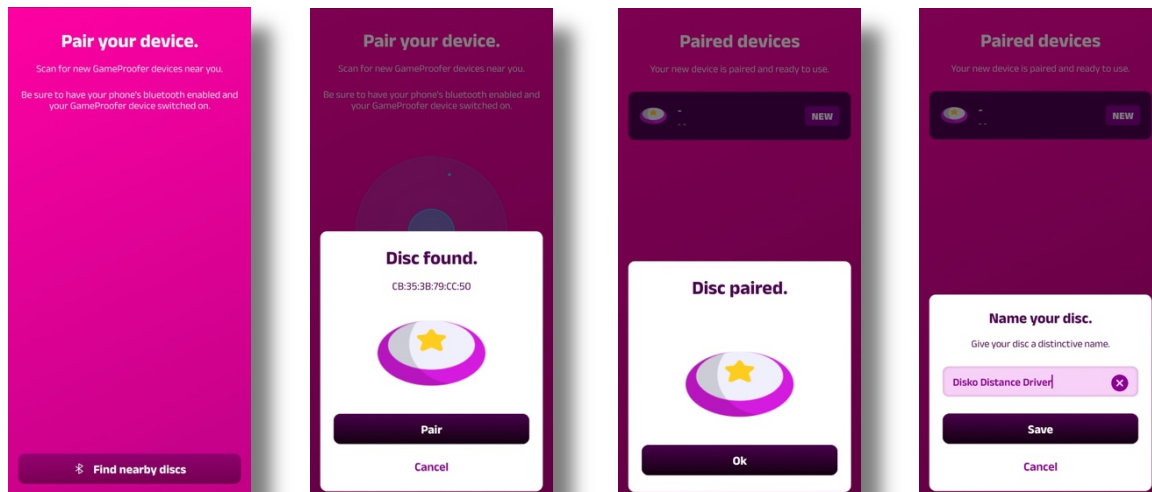

In the “Pair your device” section, activate the fully charged GameProofer tag by hovering a magnet on top of it. The tag will flash blue LED to indicate it’s ON. Then press “Find nearby discs” button.

A “Disc found” notification window will appear on the screen, showing the MAC address of the discs. If this is your disc, press “Pair” button.

Upon successful pairing, a “Disc paired” pop-up will appear. Press “Ok” to continue.

The app will then prompt you to name the disc. The name can be freely selected, and when done, press “Save” button to save the name and continue. Please note that the name of the disc can be changed any time.

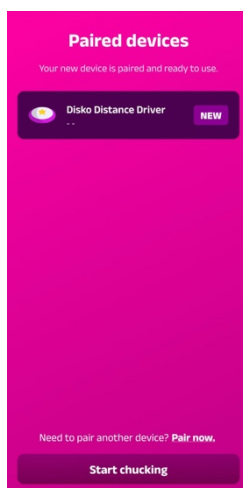

The app will now show you the newly added disc(s) in the “Paired devices” window. Press “Start chucking” button on the bottom to continue.

Your latest chucks

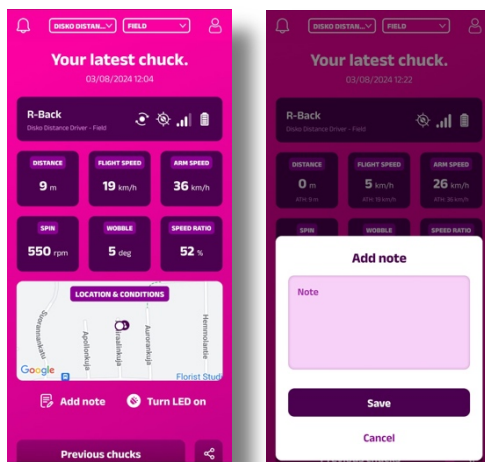

In the "Your latest chuck" section, you will see the data and parameters of your latest throw.

NOTE: When entering this section for the first time, all fields will be empty.

At the top, in between the bell and the profile icons, there are two separate dropdown menus. The left dropdown menu shows the connected discs. The right dropdown menu is where you select the "Throw" mode.

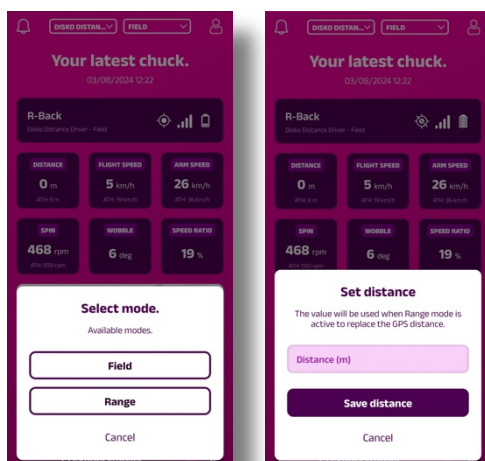

Throw modes

Field – Default throw mode for outdoor use, GPS enabled. This mode is used for measuring throws in the open field. All sensors of the tag are utilized, providing maximum amount of throw data.

Range – Throw mode for limited distance throwing to the net (indoor/outdoor), GPS disabled. This mode requires setting the distance from the tee to the net, e.g. 6m / 30ft. We recommend to use a minimum distance of 6m/30ft in the Range mode.

When throwing the disc, a minimum of 300RPM spin is required to start recording the throw. During the throw, tag's LED will light up in **GameProofer™** color. After the flight, when disc has landed, a green LED light will indicate a successful throw.

After the throw, you will see data such as Distance, Arm Speed, Flight Speed, Spin, Wobble, and Speed ratio in "Your latest chuck" section. In Field mode, you will also see the location of the thrower and the disc on the map.

In the "Previous chucks" view, you can review all the past throws measured with the GameProofer™ tag.

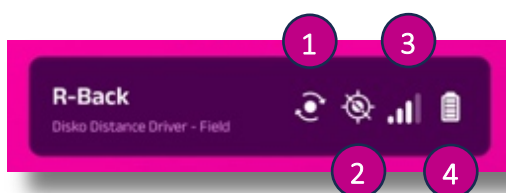

Disc Icons above the throw data are following:

- (1) Shows, when the selected disc is moving
- (2) GPS connectivity icon
- (3) Bluetooth signal strength
- (4) Battery charge status

Your Profile

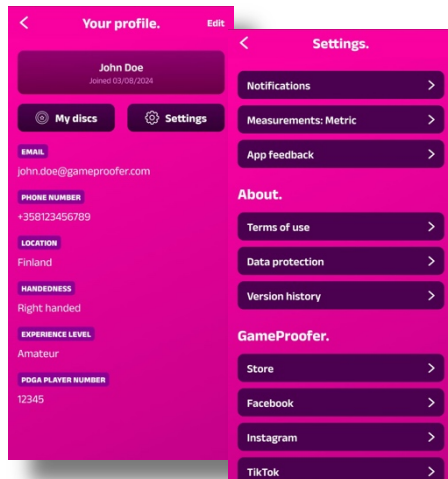

In “Your profile” section, you can view and edit your personal information.

In the “Settings” section, you can manage app notifications, units of measurement, and provide feedback directly to the app developers and GameProofer customer service.

From here, you can also “log out” from the app, and if necessary, delete your user account and all stored data. Deleting a user account cannot be undone, and the data will be permanently erased. Therefore, use this feature with caution!

Your Discs

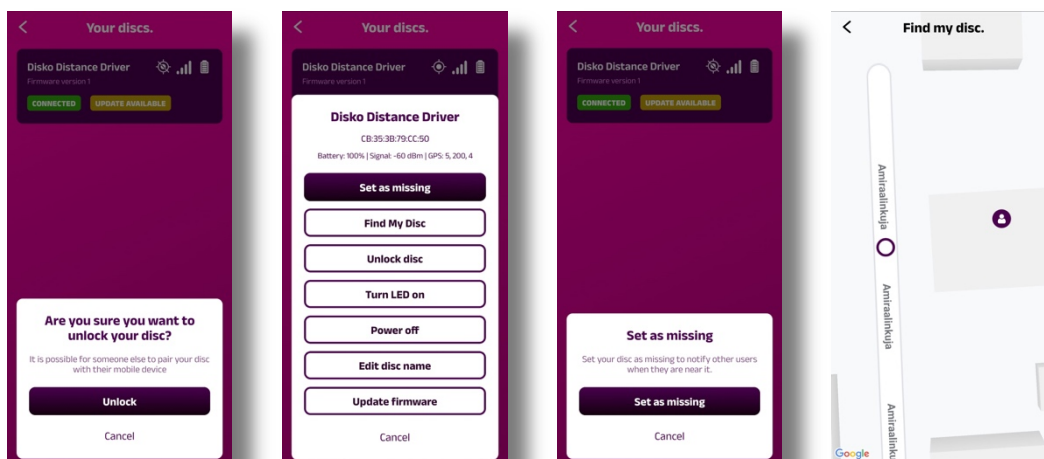

In the "Your discs" section, view the GameProofer™ tags/discs connected to your user account. By pressing on a disc in the "Your Discs" section, a popup window with disc management functions will appear.

“Set as missing” – If you lose a disc equipped with a GameProofer™ tag, you can activate this function and set the disc as missing. If other people with GameProofer™ application are moving close by, this will allow them to get a notification about a missing disc somewhere close.

“Find My Disc”- Easily locate your disc with this feature. You will see the precise GPS location of the disc on a map, in addition to your location.

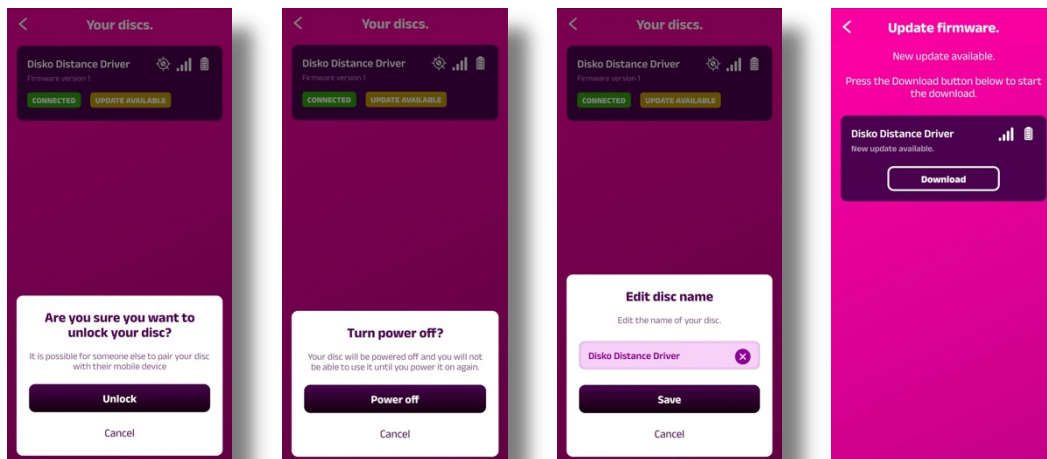

"Unlock Disc" – A tag can only be used with one user account at a time. If you want to lend your GameProofer™ tag to a friend and your friend wants to save the throw data, the tag must be released by using the "Unlock disc" function before adding the tag to another user account.

"Turn LED on" – Activate the LED light on the disc.

"Power off" – turn off the tag.

"Edit disc name" – change the name of the disc.

"Update firmware" – update the firmware of the tag.