



POCKET WIFI PLUS USER MANUAL

Read this user manual carefully prior to use.

Installation



Ensure all power has been turned off at least 5 minutes prior to installation.

1 Unscrew and remove the WiFi/Lan/GPRS or WiFi port at the bottom of the inverter.

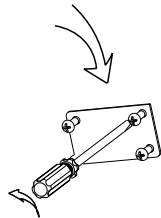
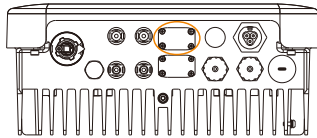

01

2 Connect the antenna to the end of the Pocket WiFi and tighten it. Then place screws at the four corners on the bottom of the Pocket WiFi.
(Antenna type is divided into original antenna and extension antenna. It is already selected when you purchase Pocket WiFi.)

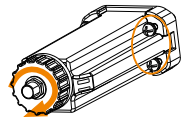

Original antenna

OR



Extension antenna

02

3 Insert the Pocket WiFi and tighten the screws with a small Phillips screwdriver.

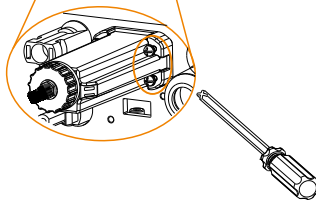
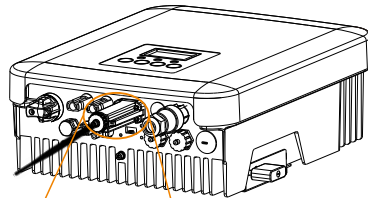

Do not plug Pocket WiFi into the "RF" jack or the "Upgrade" jack.

03

4 Power inverter on, then set the WiFi.

Step 1: Use a laptop/smartphone to search for WiFi signal from the inverter system. (SSIDL Wifi_SWxxxxxxx)

Step 2: Connect to WiFi signal.

Step 3: Open a browser (Internet Explorer, Firefox, Chrome) and type in <http://5.8.8.8/>.

Step 4: Type in username and password. (Username: admin / Initial password: admin)

Step 5: Enter setting page.

5.1 Connect to the home router by clicking "Find AP" or by manually inputting the home router's SSID.

5.2 Input the home router's password as the "Key".

5.3 Click "Save".

Step 6: Re-enter <http://5.8.8.8/> and confirm your IP address has been obtained successfully.

SETTING PAGE



5.2

5.1

5.3

04

Monitoring

1 Monitoring Website

Step 1: Ensure that your computer or laptop is connected to a network.

Step 2: Open a browser and enter <https://www.solaxcloud.com>

Step 3: Select your display language and read the User guide, then sign up.

User guide



Step 4: Complete registration, login, add sites and other related operations according to the guidelines of the User guide.

05

2 Monitoring App

Use your mobile phone to scan the QR code or use the browser to search for the keyword "SolaxCloud" to download Monitoring App.



IOS



Google

Open the Monitoring App and click the "Sign up" button on the login screen to bring up the registration box. Enter the SN number of the Pocket WiFi device and complete the registration.

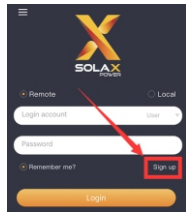

Sign up

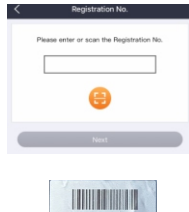

(Registration No. example)

3 Local Mode

To access the Local Mode on the Monitoring App, you will need a password. It is the same as the login password of the 5.8.8.8 site (initially: admin). It can be changed on the System page of 5.8.8.8 site. (≤10 characters)

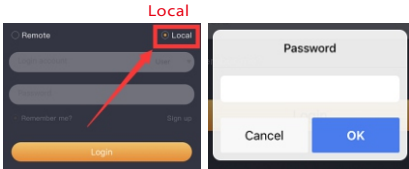

The standby password for logging into the local mode of Monitoring App and the 5.8.8.8 site is shown on the right side of the monitoring website's Inverter page. It is usually a six-digit number.

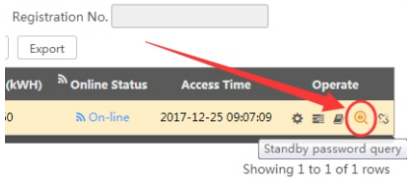

Introduction

The Pocket WiFi makes the long-term monitoring of PV systems feasible and efficient by collecting information from the inverter including status and performance to update the monitoring website.

- Quick installation with "Plug & Play" function
- IP 65 dust prevention water proofing designs
- Stable data transmission and good reliability
- Low profile and nice exterior
- Increased external antenna for stronger signal

Safety Instructions

- Prior to installation, ensure all power going to the inverter has been cut off.
- Keep away from flammable, explosive materials.
- Do not dismantle or scrap by force.
- Children should be supervised to ensure that they do not play with this appliance.



Indicates that the product must not be processed with household waste. It must be brought to an electric and electronic waste collection point for recycling and disposal. By ensuring the appropriate disposal of this product you also help in

preventing potentially negative consequences for the environment and human health. The recycling of materials helps preserve our natural resources. For further information regarding the recycling of this product, please contact your municipality, local waste disposal centre or the store where the products was purchased.

Appearance and Dimension

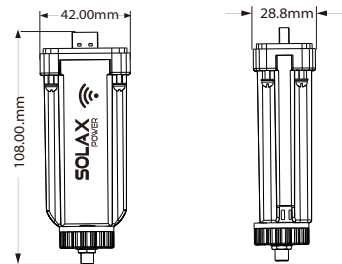

Technical Data

Product Name	Pocket WiFi
Model	Pocket WiFi Plus
Supply Voltage	3.3V DC
Rated Power	0.9W
EIRP Power	17.46dBm (Measured Max. Average)
Frequency	2.412~2.472GHz
Antenna Gain	3dBi
Antenna Type	IPEX (PCB antenna is not enabled)
Interface	UART/USART
Degree of Protection	IP65
Operating Temperature	-40~65°C
Wireless Mode	802.11b/g/n
Dimension	108*42*28.8mm
Weight	34g

Warranty Regulation and Liability

Terms and Conditions

Solax grants a standard 12-month warranty. The terms of this warranty begin from the date marked on the purchase invoice. Solax will only perform warranty service when the faulty unit is returned to Solax along with a copy of the invoice and warranty card issued by the dealer. In addition, the type label of the unit must be fully legible. If these requirements are not fulfilled, Solax reserves the right to deny warranty service.

Exclusion of Liability

Warranty claims are excluded for direct or indirect damage due to:

- 1: Use of unit in ways not intended, improper installation and installation that does not comply with standards, improper operation and unauthorized modification to the units, or repair attempts.
- 2: Missing warranty card and serial number.
- 3: Operating the units with defective protective equipment.
- 4: Influence of foreign objects and force majeure.
- 5: Inadequate ventilation.
- 6: Non-observance to relevant safety instructions.



Warranty Registration Form

Please retain this page as proof of your purchase and your guarantee.

Name Country

Phone Number..... Zip Code

Email

Address

Product Serial Number.....

Date of Commissioning

Installation Company Name

Date of Delivery

Signature

Contact us

ADD: Room 506, West Building A Sci. and Tech Park of Zhejiang University No.525, Xixi Road, Hangzhou Zhejiang Province, China 310007

Tel: +86 571 56260011 Fax: +86 571 56075753

Email: service@solaxpower.com

Web: <http://solaxpower.com>