

COMMERCIAL PIVOT DOOR PARTS



Available Colours: SF



SINGULAR 1027
SATIN FINISH

HYDRAULIC PATCH DOOR KIT

SPECIFICATIONS

1. Open Angle: 140° double action
2. Door hold section: 90° and 140° - 120° (optional)
3. Two speeds adjustable
4. For 10-15 mm glass door
5. Max door weight 100 kgs
6. Stainless Steel
- Valve 1: 90° - 0°
- Valve 2: 30° - 0°

TECHNICAL DATES

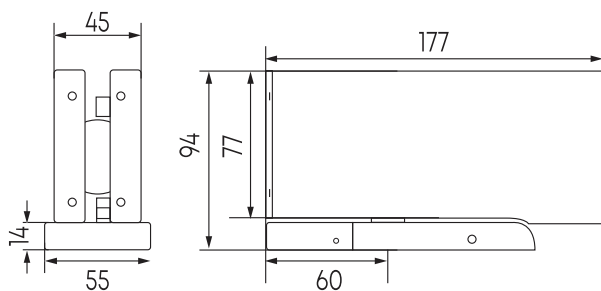

GLASS CUTTING

